



# Installation Instructions

Thank you for purchasing this anti-sway bar kit. Please read through these instructions before installation.

## Factory Replacement Front Anti-Sway Bar Kit for Chevy/GMC 1500 2WD/4WD

part #1109-207  
1-3/8" diameter



## INTRODUCTION

Thank you for purchasing this anti-sway bar kit. This kit is designed to improve the handling characteristics of your vehicle by reducing the body roll and balancing the weight transfer during cornering. The anti-sway bar kit is engineered for long life and trouble-free performance.

All the hardware needed for installation is included in this kit. Refer to the PARTS LIST in these instructions to identify the parts.

## SUGGESTED TOOLS

The following tools are suggested to complete the installation procedures:

- 15mm Socket
- 10mm Socket
- 5/8" Socket Wrench and wrench

### **⚠ WARNING**

**Failure to follow these instructions can result in property damage, personal injury or even death.**

- If raising the vehicle to install the anti-sway bar, always support the vehicle with jack stands at both frame rails or at the rear axle before working underneath. Ensure that the jack stands are securely positioned, and are rated at or above the weight of the vehicle.
- The installer must read the instructions and use all bolts and parts supplied. Use only the parts supplied by ROADMASTER to install this kit.
- Minor modifications are sometimes necessary due to slight vehicle variations, even for the same year, make and model.
- Regardless of year, make and model, a wide range of options for specific applications may or may not interfere with the installation. It is the installer's responsibility to make certain that equipment is not damaged once the suspension solution travels through the full range of motion. Failure to ensure adequate clearance could result in non-warranty property damage, personal injury or even death.

- If running changes were made by the manufacturer after this kit was designed, there may be weldments, braces, gussets, or other structural items which interfere with the installation. It is the installer's responsibility to allow for these running changes without sacrificing the structural integrity of the anti-sway bar. Failure to securely fasten the anti-sway bar could result in property damage, personal injury or even death.
- ROADMASTER will not be responsible for any damage or injury resulting from any modification or alteration.
- Check ALL the fasteners for tightness before and after road testing the vehicle.
- Do not use this document for custom fabrication, as it may not show all parts or structural components.
- Do not use an air impact wrench when re-installing bolts, as stripped threads may result.
- This anti-sway bar is only warranted for the original installation. Installing a used anti-sway bar on another vehicle is not recommended and will void the warranty.

# PARTS LIST

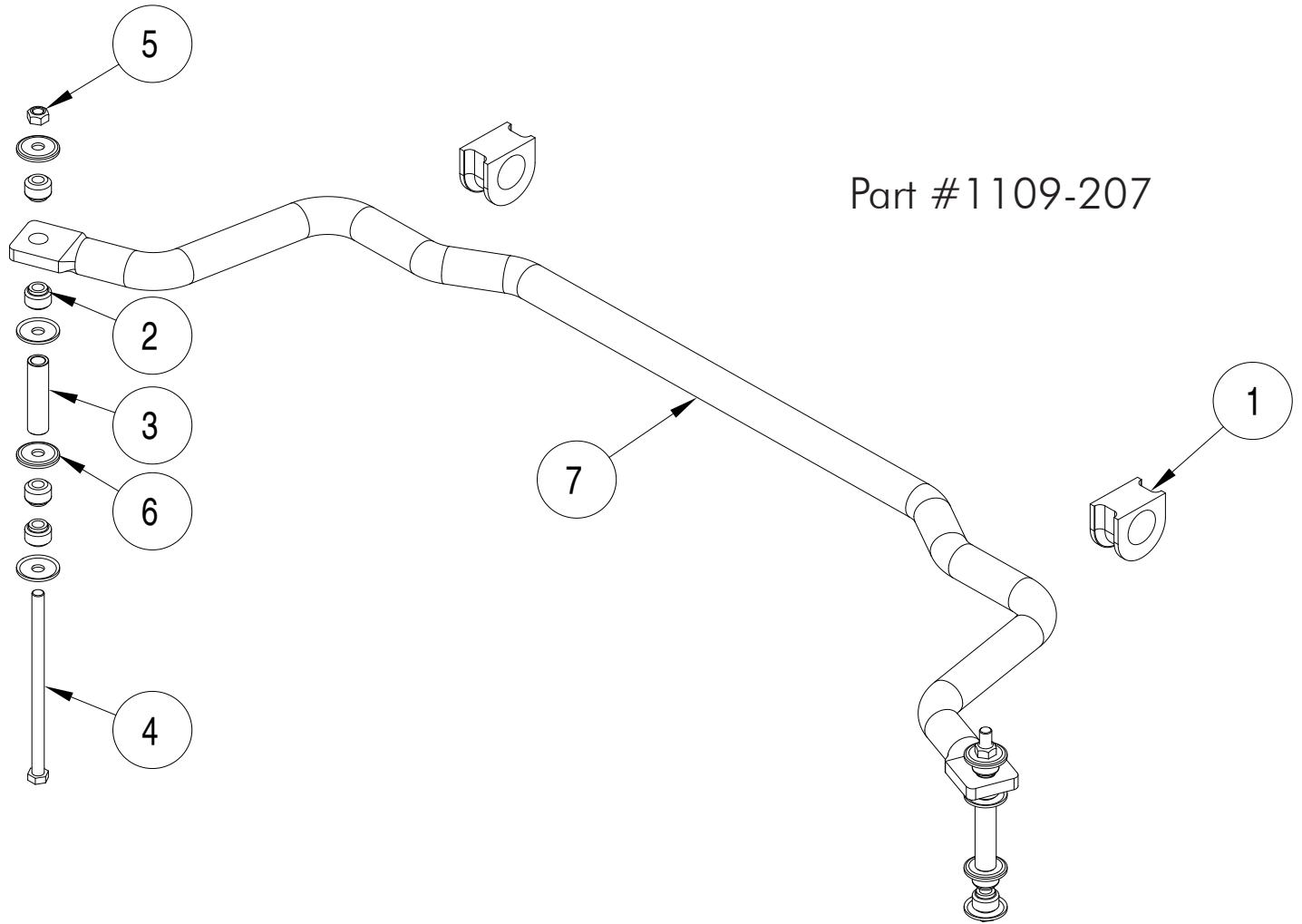

ITEM	QTY	DESCRIPTION	PART NUMBER
1.....	2.....	BUSHING.....	205214-10
2.....	8.....	BUSHING.....	205393-00
3.....	2.....	SLEEVE.....	205512-00
4.....	2.....	7/16-14 x 8" BOLT - GRADE 8.....	350089-00
5.....	2.....	7/16-14 LOCK NUT.....	350256-02
6.....	8.....	CUP WASHER.....	357434-00
7.....	1.....	ANTI-SWAY BAR.....	580468-00
8.....	1.....	LOCTITE.....	200544-00
9.....	1.....	AQUALUBE.....	400011-30

# INSTALLATION

The following instructions must be followed in the order listed to ensure a proper installation and to preserve the ROADMASTER warranty.

**NOTE: THIS ANTI-SWAY BAR WILL BE MOST EASILY INSTALLED WITH THE VEHICLE'S SUSPENSION IN A LOADED STATE. ALLOWING THE SUSPENSION TO HANG DURING THE INSTALLATION MAY MAKE THE INSTALLATION MUCH MORE DIFFICULT.**

## 1. Remove the factory anti-sway bar:

**A)** Remove the top nut on the factory endlink assembly that attaches the anti-sway bar and lower control arm to the endlink.

**B)** Remove the bolts holding the bushing clamps to the frame, and carefully remove the factory sway bar.

## WARNING

The anti-sway bar is heavy, and may cause property damage or personal injury if it falls on equipment, engine components or any part of your body. Ensure that the anti-sway bar is supported and that you are out of the way when removing the brackets.

Failure to follow these instructions may cause property damage, personal injury or even death.

## 2. Prepare the new sway bar for installation:

**A)** Grease the inside of the provided saddle bushings that fit around the anti-sway bar with the provided grease.

**B)** Position the bushings on the sway bar by comparing their position to the factory unit you removed from the vehicle.

## 3. Mount the new sway bar:

**A)** Place the sway bar ends over the endlink bushings. Have an assistant bolt the anti-sway bar in place using the factory bushing clamps and bolts in the factory mounting points (Figure 1). *Note: Due to manufacturing variances, your application may bolt into a slightly different position. Ensure that, no matter the application, that you use the factory mounting holes.*

**B)** Once the anti-sway bar is bolted in place, assemble the new endlinks and install them through the lower control arm and sway bar end (Figure 2).

**C)** Tighten the bushing clamps to factory specifications. Figure 3 shows the finished installation.

**4. Test drive the vehicle. Listen for unusual noises. After the test drive, ensure all fasteners are properly tightened.**

Figure 1



Figure 2



Figure 3

