

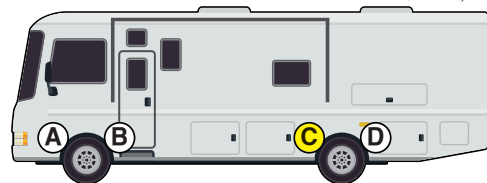

85-6460 rev. 06 12/25

Thank you for purchasing our anti-sway bar kit. Please read through these instructions before installation.



Installation Instructions

Rear Anti-Sway Bar Kit for the Ford F600 (Thor Outlaw only)

part #1139-221

1 $\frac{3}{4}$ " diameter — Heat-treated

Designed for heavy-duty applications

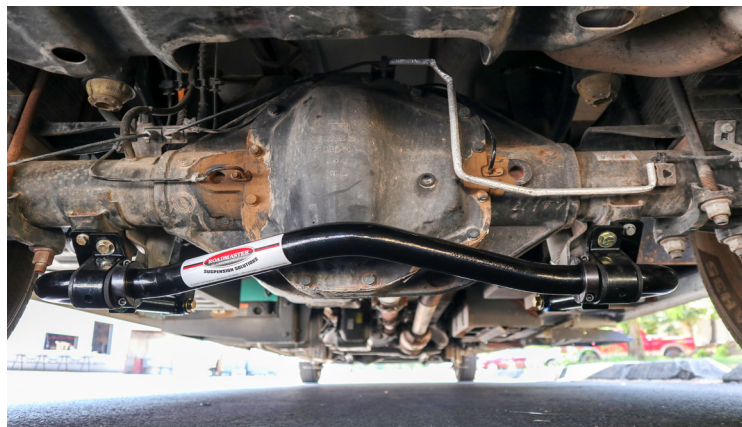

INTRODUCTION

Thank you for purchasing this anti-sway bar kit. This kit is designed to improve the handling characteristics of your vehicle by reducing the body roll and balancing the weight transfer during cornering. The anti-sway bar kit is engineered for long life and trouble-free performance. For maximum suspension control, use this kit along with our front anti-sway bar kit.

All the hardware needed for installation is included in this kit. Refer to the PARTS LIST in these instructions to identify the parts.

SUGGESTED TOOLS

The following tools are suggested to complete the installation procedures:

- Assorted wrenches and sockets
- General hand tools

WARNING

Failure to follow these instructions can result in property damage, personal injury or even death.

- If raising the vehicle to install the anti-sway bar, always support the vehicle with jack stands at both frame rails or at the rear axle before working underneath. Ensure that the jack stands are securely positioned, and are rated at or above the weight of the vehicle.
- The installer must read the instructions and use all bolts and parts supplied. Use only the parts supplied by ROADMASTER to install this kit.
- Minor modifications are sometimes necessary due to slight vehicle variations, even for the same year, make and model.
- Regardless of year, make and model, a wide range of options for specific applications may or may not interfere with the installation. It is the installer's responsibility to make certain that equipment is not damaged once the suspension solution travels through the full range of motion. Failure to ensure adequate clearance could result in non-warranty property damage, personal injury or even death.
- If running changes were made by the manufacturer after this kit was designed, there may be weldments, braces, gussets, or other structural items which interfere with the installation. It is the installer's responsibility to allow for these running changes without sacrificing the structural integrity of the anti-sway bar. Failure to securely fasten the anti-sway bar could result in property damage, personal injury or even death.
- ROADMASTER will not be responsible for any damage or injury resulting from any modification or alteration.
- Check ALL the fasteners for tightness before and after road testing the vehicle.
- Do not use this document for custom fabrication, as it may not show all parts or structural components.
- Do not use an air impact wrench when re-installing bolts, as stripped threads may result.
- This anti-sway bar is only warranted for the original installation. Installing a used anti-sway bar on another vehicle is not recommended and will void the warranty.

PARTS LIST

Part #1139-221

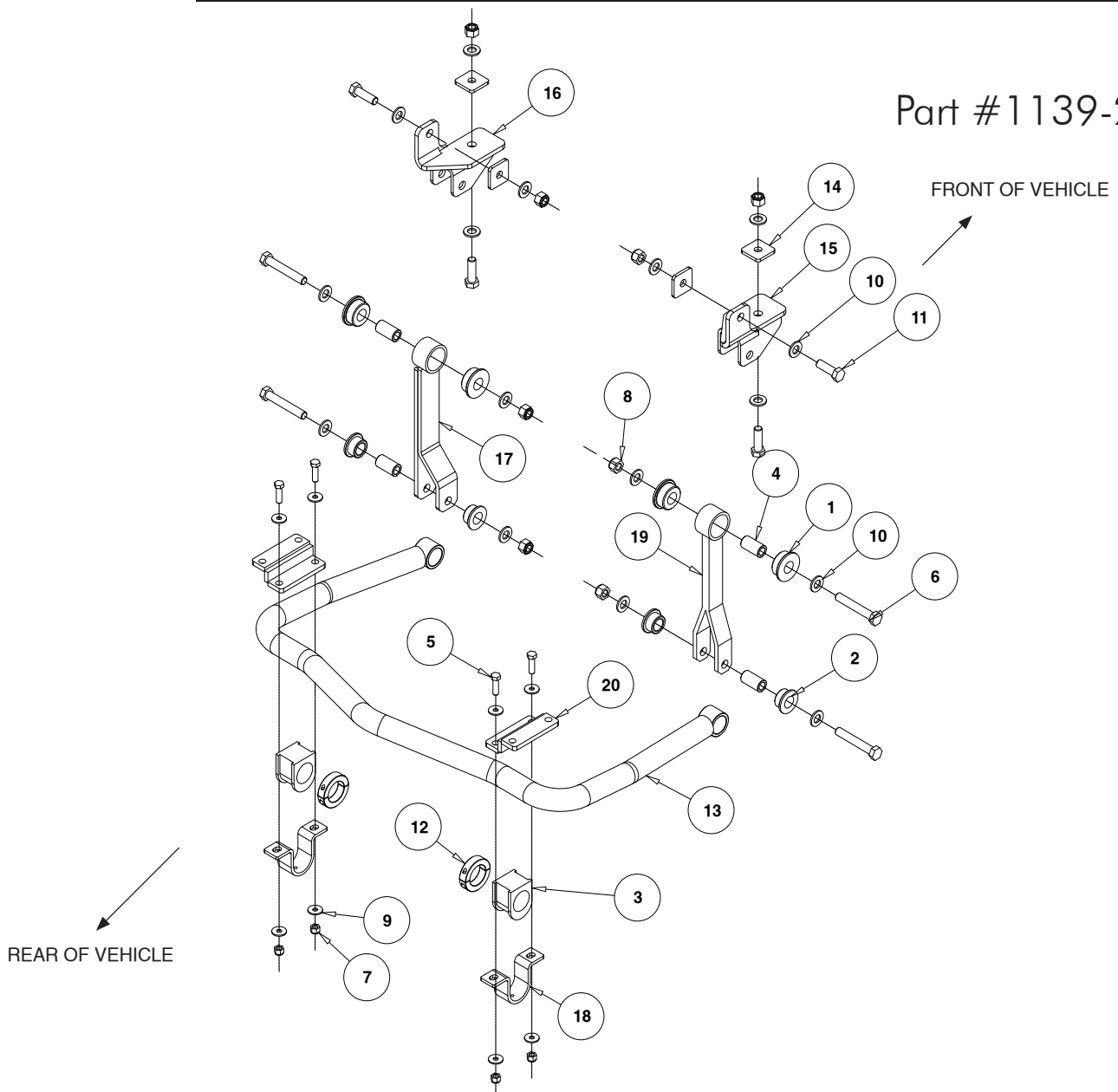

ITEM	QTY	DESCRIPTION	PART
1	4	BUSHING	205202-10
2	4	BUSHING	205209-00
3	2	BUSHING	205220-20
4	4	BUSHING SLEEVE	205503-00
5	4	7/16-14 x 1 1/2" BOLT - GRADE 8	350074-50
6	4	5/8-11 x 4" BOLT - GRADE 8	350158-50
7	4	7/16-14 NYLON INSERT LOCK NUT - GRADE 8	350257-50
8	8	5/8-11 NYLON INSERT - GRADE 8	350263-20
9	8	3/8" HARDENED WASHER	350304-80
10	16	5/8" SAE WASHER	350348-80
11	4	5/8-11 x 2" BOLT - GRADE 8	350453-00
12	2	SPLIT COLLAR	350530-75
13	1	ANTI-SWAY BAR	580506-00
14	4	2" X 2" BACKING PLATE	A000188
15	1	FRAME BRACKET	B1053
16	1	FRAME BRACKET	B1129
17	1	END LINK	B1168
18	2	BUSHING CLAMP	B141
19	1	END LINK	B404
20	2	AXLE BRACKET	B992
21	1	AQUALUBE	400011-30
22	1	THREADLOCKER	200544-00

INSTALLATION

⚠ WARNING

The anti-sway bar is heavy, and may cause property damage or personal injury if it falls on equipment, engine components or any part of your body. Ensure that the anti-sway bar is supported and that you are out of the way when removing the brackets.

Failure to follow these instructions may cause property damage, personal injury or even death.

1. Remove the factory endlinks.

On each side, disconnect the endlink from the frame rail.

2. Remove the factory anti-sway bar from the axle.

Remove two bolts attaching the bushing clamps to the anti-sway bar and axle.

⚠ WARNING

Removing the bushing clamps will release the anti-sway bar. The anti-sway bar is heavy, and may cause property damage or personal injury if it falls on equipment, engine components or any part of your body. Ensure that the anti-sway bar is supported and that you are out of the way when removing the brackets.

Failure to follow these instructions may cause property damage, personal injury or even death.

3. Install the frame bracket on each side.

Use the 5/8" x 2" bolts and 5/8" washers to bolt the frame bracket to the frame rail on each side. Then, finish each bolt with Loctite, a 2" x 2" backing plate, 5/8" washer and 5/8" Nyloc nut (Figure 1).

4. Install the endlink to the frame bracket on each side.

Using the remaining 5/8" x 4" bolts and 5/8" washers, attach the endlink to the frame bracket on each side. Finish each bolt with a 5/8" washer and 5/8" nuts (Figure 1).

5. Connect the endlinks to the bar.

Assemble the side-specific endlinks as depicted on page 2. Then, attach the endlinks to the outside of the bar using the supplied 5/8" x 4" bolts (Figure 2 — driver's side; Figure 3 — passenger side). Leave the bolts finger-tight for now.

Figure 1



Figure 2



Figure 3



INSTALLATION

6. Lubricate the new bushings with the supplied grease.

Put a thorough coating of grease on the inside of each saddle bushing (Figure 4).

7. Place the bushings, clamps and axle plates on the anti-sway bar and lift it into place.

Lift the anti-sway bar into place, centering the bushing clamps over the bushings and align them with the included, side-specific axle brackets. On each clamp, place the supplied 7/16" lock nuts over the included 7/16" x 1 1/2" bolts. Finish with Loctite, 3/8" washers and 7/16" Nyloc nuts. Ensure the bar is centered side-to-side and then tighten the bolts to 50 ft.-lbs (Figure 5).

8. After road testing, re-check all fasteners for proper tightness.

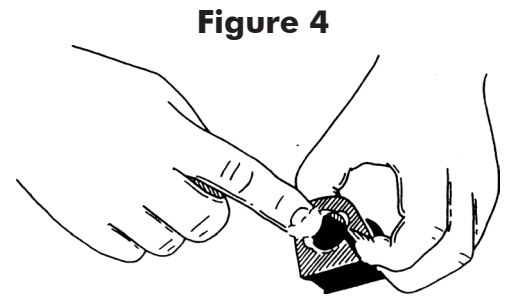

Figure 4



Figure 5

WARNING

The anti-sway bar is not a load-bearing component

Do not tow or hoist the vehicle using the anti-sway bar or its mounting brackets as attachment points. The anti-sway bar is not designed to carry the weight of the vehicle and may collapse, which will damage the anti-sway bar components, the suspension, or other components. The vehicle will detach or fall, which may cause severe personal injury.

Failure to follow these instructions may result in property damage, personal injury or even death.