

single-hook and double-hook Safety Cables



Connection instructions and diagrams

Time Tested • Time Proven

Using your safety cables

Safety cables are a secondary safety device, required by law in many states. To ensure your safety and that of your passengers, follow these instructions to use them properly:

- The safety cables must connect the motorhome to the towed vehicle, frame to frame.
- **The weight of the towed vehicle, including all its contents, cannot exceed the weight capacity of the safety cables or the safety cables will fail.**
- Pull the safety cables so that all the slack is at the motorhome. **Be certain there is enough slack in the cables at the motorhome to allow for sharp turns** – if there is not enough slack, the towing system will be severely damaged when the motorhome turns.
- The safety cables must be the correct length...
 - Make certain the cables are not too short – if you use a receiver hitch extension or other equipment that extends the distance between the towed vehicle and the motorhome, the standard cables may be too short. If the cables are too short, the towing system will be severely damaged when the motorhome turns a sharp corner. Safety cable extensions (or longer safety cables) may be necessary for use with accessories which extend the length of the towing system.

- Make certain the cables are not too long – the cables should not hang down to the extent they may catch on obstructions or drag on the ground. This much slack could cause damage to the towing system, the towed vehicle or the motorhome.

If the cables are too long, wrap the excess cable around the tow bar to take up the slack. **The last pass must be to the inside**, to allow the towed vehicle to track in line behind the motorhome (Refer to the accompanying diagrams.). **Be certain there is enough slack in the cables at the motorhome to allow for sharp turns.**

- Always cross the cables under the hitch receiver, as shown in the diagrams on pages two, three and four. In the unlikely event the tow bar separates from the motorhome, crossing the cables will help prevent the tow bar from dragging on the ground, which can cause the tow bar to “pole vault” the towed vehicle.



WARNING

Failure to follow these instructions may cause property damage, personal injury or even death.

Connection instructions

For all towing systems...

Use the built-in cable guides and cross the safety cables under the hitch receiver, as shown in the diagrams on pages 2, 3, 4 and 5.

Unscrew the connecting nuts on each quick link to connect the safety cable loops. Finger-tighten the nuts firmly, until the loop is completely closed, to secure the attachment. Do not substitute carabiners or other devices for the quick links – the quick links are designed to hold the weight of a towed vehicle; carabiners are not.

Connect the snap hooks to the safety cable anchors built into the baseplate.



WARNING

The safety cables must be carefully routed so that they cannot become pinched, frayed, scraped or otherwise damaged, and so they will not drag when going over dips or low spots. Do not use the cables if they show any signs of wear or damage – immediately discontinue towing and replace the cables.

Failure to follow these instructions will result in cable failure, which may cause property damage, personal injury or even death.



WARNING

If the quick links are not completely tightened, with the loop closed, the safety cables may detach. In the event of a towing system failure, the towed vehicle will detach, which may cause property damage, personal injury or even death.

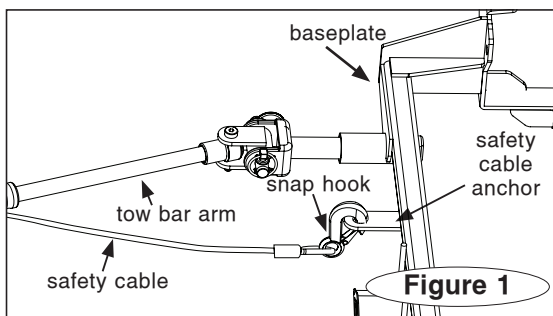

StowMaster™ and Tracker™ tow bars

(Shown with straight safety cables; connect coiled cables to the same attachment points.)

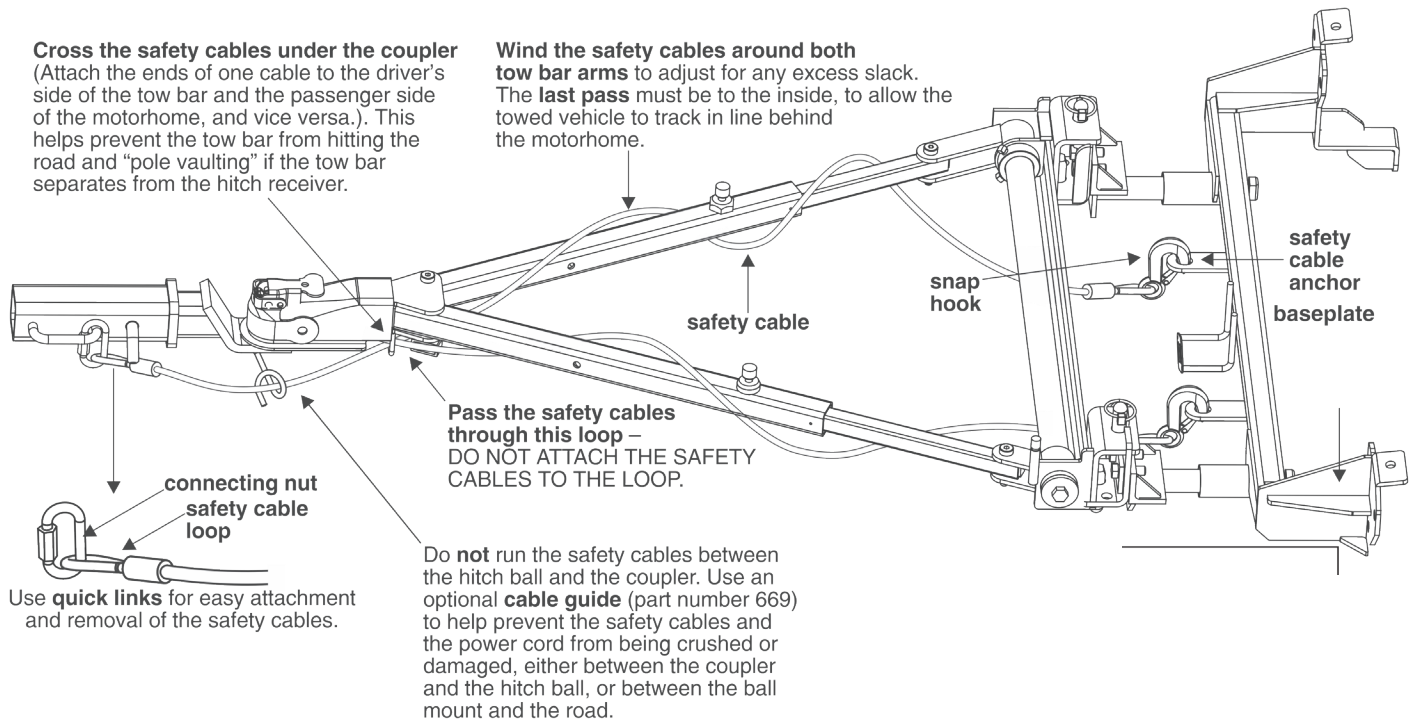

See page one for detailed connection information.

Falcon™ and Falcon 2™ tow bars

(Shown with straight safety cables; connect coiled cables to the same attachment points.)

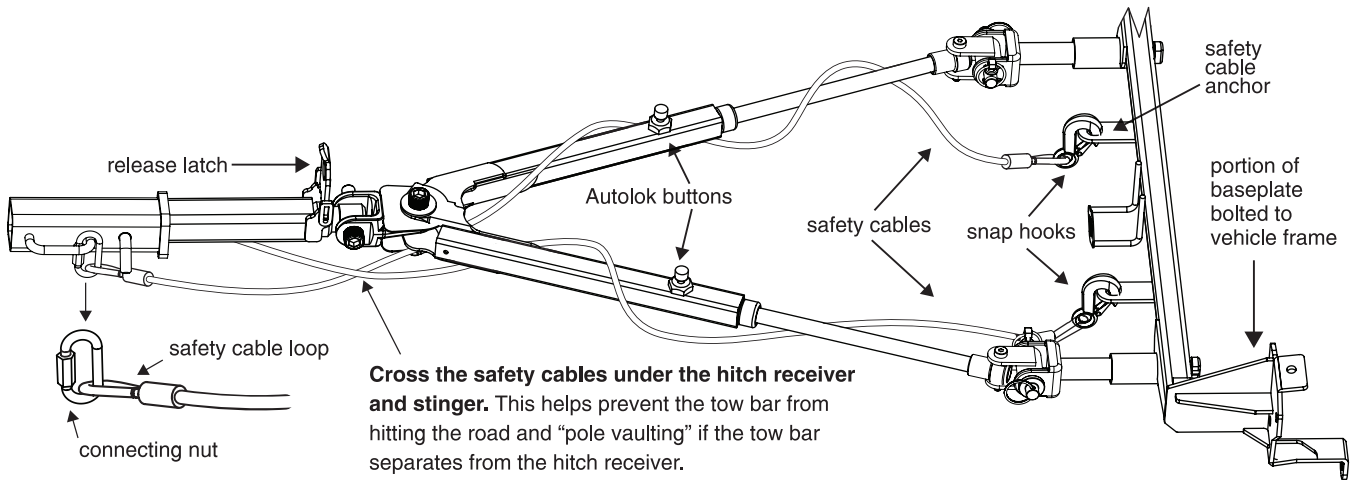

Blackhawk™, Blackhawk All-Terrain™ and Blackhawk 2 All-Terrain tow bars

(Shown with straight safety cables; connect coiled cables to the same attachment points.)

Use the built-in **cable guides** to help prevent damage to the safety cables and electrical cord and for a clean, uncluttered appearance.

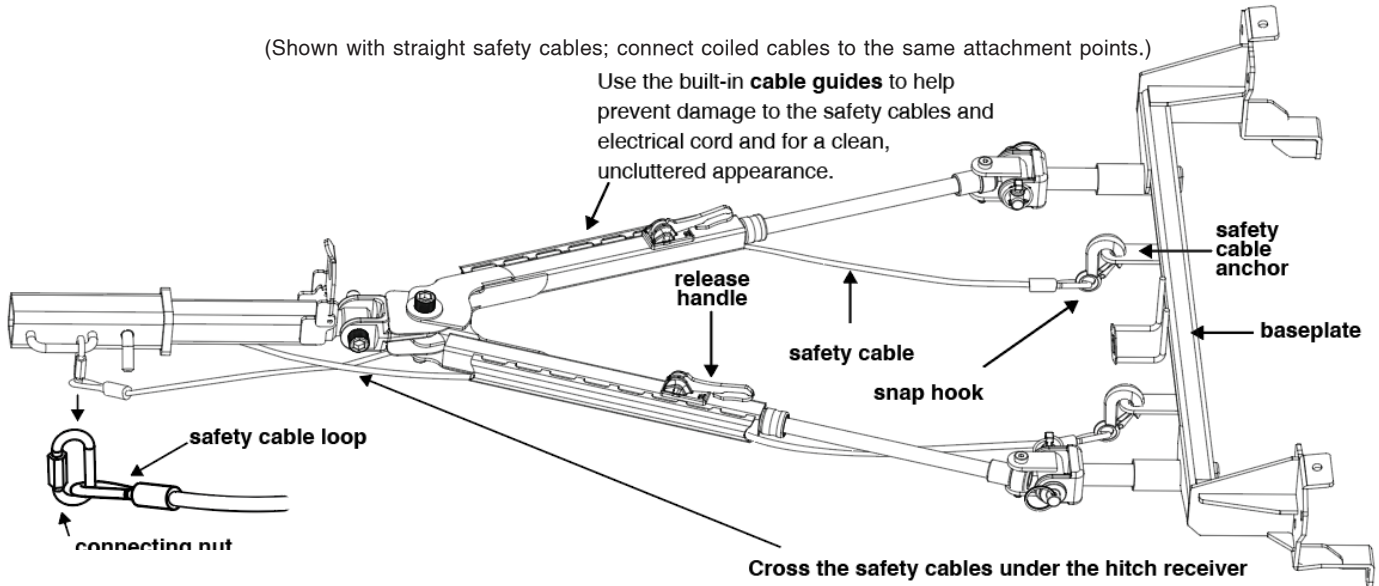

Cross the safety cables under the hitch receiver and stinger. This helps prevent the tow bar from hitting the road and "pole vaulting" if the tow bar separates from the hitch receiver.

See page one for detailed connection information.

Nighthawk™ and Falcon All-Terrain tow bars

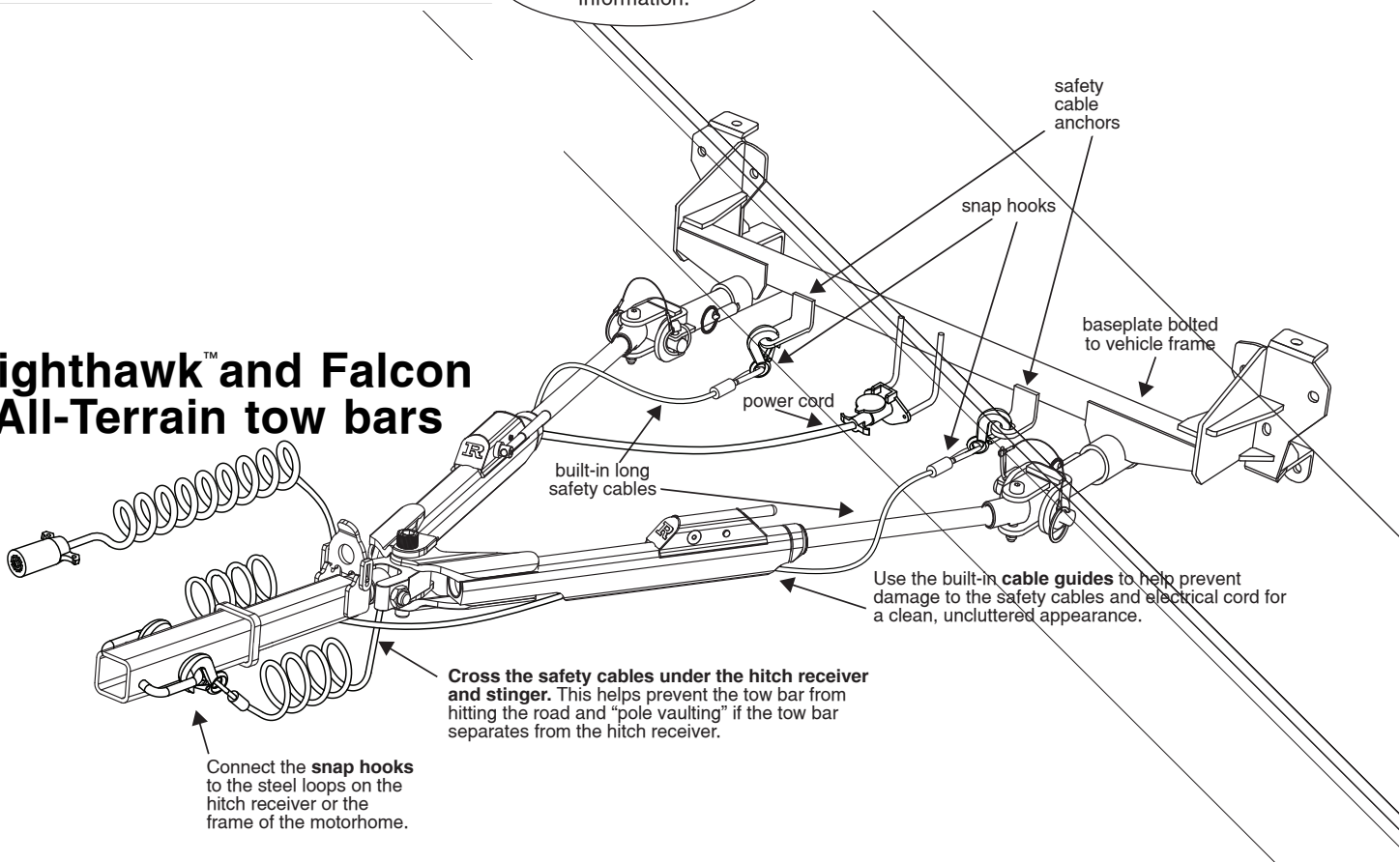

Use the built-in **cable guides** to help prevent damage to the safety cables and electrical cord for a clean, uncluttered appearance.

Cross the safety cables under the hitch receiver and stinger. This helps prevent the tow bar from hitting the road and "pole vaulting" if the tow bar separates from the hitch receiver.

Connect the **snap hooks** to the steel loops on the hitch receiver or the frame of the motorhome.

Sterling™ and Sterling All-Terrain™ tow bars

The Sterling and Sterling All-Terrain come with safety cables.

See page one for detailed connection information.

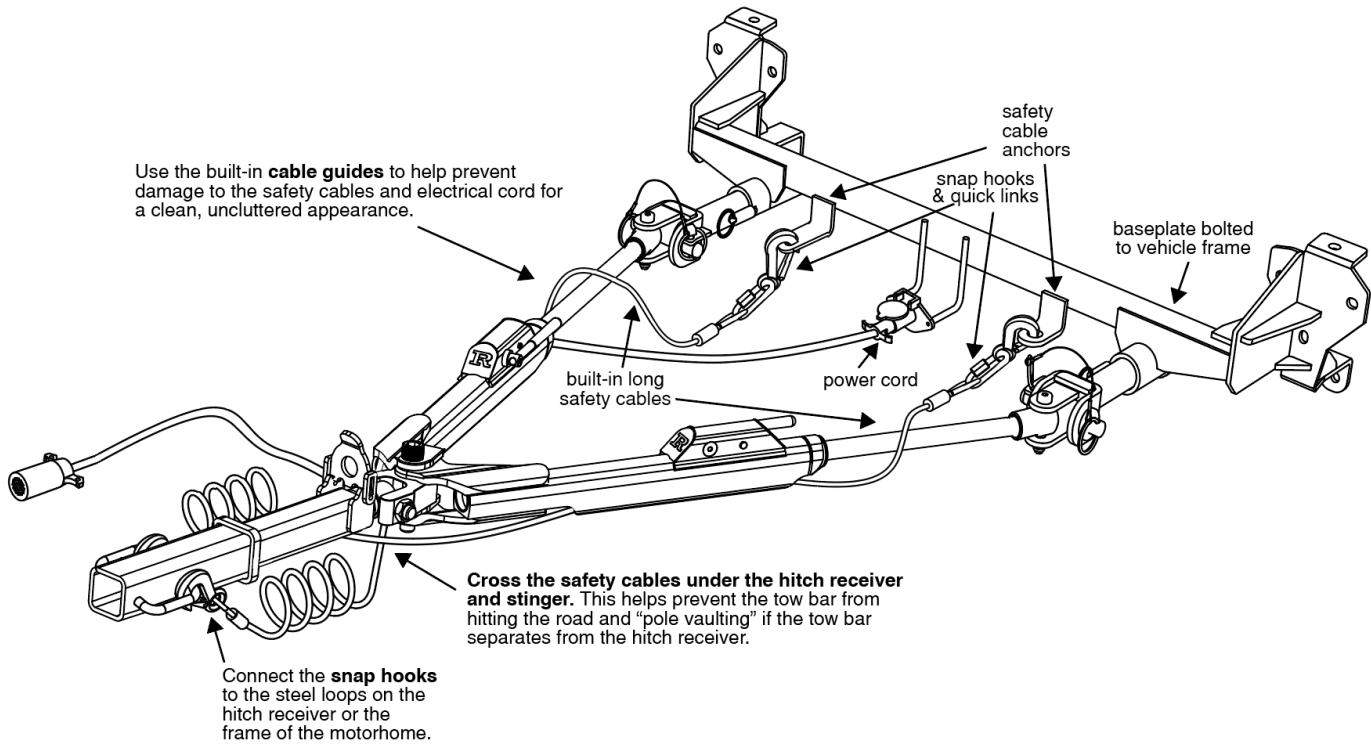

Time Tested • Time Proven

ROADMASTER, Inc. • 6110 NE 127th Ave. • Vancouver, WA 98682
 800-669-9690 • Fax 360-735-9300 • www.roadmasterinc.com