

BASEPLATE KIT INSTALLATION INSTRUCTIONS

ROADMASTER, Inc. 6110 NE 127th Ave. Vancouver, WA 98682 1-800-669-9690 fax 360-735-9300 www.roadmasterinc.com

PARTS LIST:

- 1- FACE PLATE (A)
- 1- MAIN BRACE (B) - Passenger side
- 1- MAIN BRACE (C) - Driver's side
- 1- RECTANGULAR BACKING PLATE (D)
- 1- MIDDLE BAR (E)
- 1- RECTANGULAR BACKING PLATE (F)

KIT NO. 1003-1

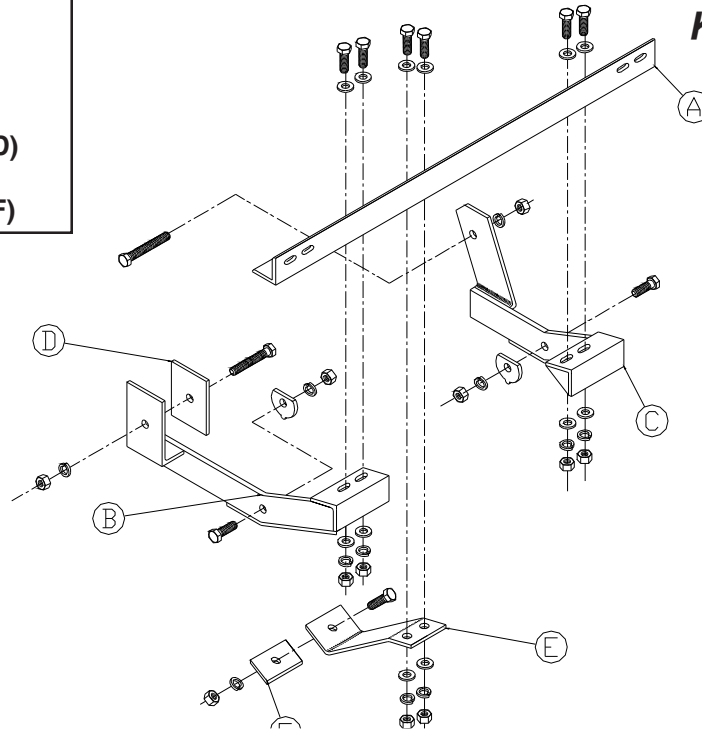

7/14/99

IMPORTANT: All baseplates **must** be assembled with all the bolts left loose for final adjustment and positioning (before tightening) unless otherwise instructed. All bolts **must** be torqued for proper strength. If more than one bolt is used per fastening point, the diagram may only show one. Use flat washers over all slotted holes and lock washers on all fasteners.

WARNING

Failure to heed these warnings or follow the installation instructions may result in a voided warranty, loss of towed vehicle, personal injury or death.

- Do not weld or modify this baseplate or its components. Welding or modification will void the warranty.
- Do not use this document as a basis to design/fabricate a baseplate, as it may not show all parts or structural components.
- We strongly recommend professional installation.
- If the towed vehicle has been in an accident, it must be properly repaired before attaching the baseplate. **Do not install the baseplate if any structural frame damage is found.**
- The installer must use all bolts and parts supplied. If running changes were made by the vehicle manufacturer after this kit was designed, some bolts or other fasteners may no longer be the correct size. **It is the installer's responsibility to verify this kit is securely fastened to the vehicle.**
- Use **Loctite® Red on all bolts used to secure this baseplate.** Torque all bolts to the specifications found at the end of these instructions. **Do not over-torque the bolts or failure may occur.**
- The installer must inspect the baseplate to ensure adequate clearance, particularly around hoses, air conditioner lines, radiators, etc. or non-warranty failure may result.
- Roadmaster manufactures many styles of baseplates. **If your baseplate has removable arms, they must be removed before driving the vehicle, unless the arms can be pinned or padlocked in place.** If not secured, the arms could vibrate out.
- Some motorhome chassis have such a tight turning radius that you can damage your motorhome, towed vehicle, tow bar or baseplate while turning sharply. **Before getting on the road, test your turning radius in**

an empty parking lot. Turning too sharply could result in non-warranty damage to your towing system, motorhome and/or towed vehicle.

- Do not back up with the towed vehicle attached or non-warranty damage will occur to your towing system or vehicles.
- The safety cables must connect the towing vehicle to the towed vehicle frame to frame, with the cables crossed, with enough slack for sharp turns. See cable instructions for proper routing. Failure to do so will result in non-warranty damage and/or the loss of the towed vehicle.
- This kit is designed for use with ROADMASTER tow bars and ROADMASTER adapters only. **Using this kit with other brands, without an approved ROADMASTER adapter, may result in non-warranty damage or injury.**
- Receiver extensions and out-of-level towing situations of 3 inches or more. This can cause the system to swing much higher and lower, causing excessive strain on the tow bar, baseplate and frame. That can cause the towing system to fail, causing property damage, personal injury or even death. **If you must use a receiver extension or drop hitch to tow, it will reduce your receiver's weight capacity by 1/3 to avoid damaging your system. Never use more than one extension and/or drop hitch, as this will void your warranty.**
- Every 3,000 miles, the owner must inspect all mounting points for cracks or fatigue, and check the fasteners for proper torque, according to the bolt torque requirements chart on the last page of these instructions.
- The owner must follow the vehicle manufacturer's instructions to prepare the vehicle for towing. Failure to do so may cause severe damage to the vehicle.
- This baseplate is only warranted for the original installation. Installing a used baseplate on another vehicle is not recommended and will void the warranty.

BASEPLATE KIT INSTALLATION INSTRUCTIONS

ROADMASTER, Inc. 6110 NE 127th Ave. Vancouver, WA 98682 1-800-669-9690 fax 360-735-9300 www.roadmasterinc.com

KIT NO. 1003-1

1. **Important:** please use all supplied bolts and parts and read all instructions carefully before beginning this installation. The majority of questions you may have can be answered within the text, and proper installation will ensure safe and secure travel.
Now, begin the installation by removing the four bolts on the front torsion bar mounts and then let the stabilizer bar hang loose. This will have clearance needed to position the main braces. Remove the rear mounting bolt from the steering box on the driver's side. It will not be replaced.
2. Position main brackets by inserting them through the space created between the frame and the stabilizer bar. Insert from the rear and position against the frame with the middle hole in the brackets in line with the tie down loops.
3. Using 1/2" x 1 1/2" bolts, insert the bolt through the middle hole of the bracket then through the passenger side tie down loop and finish off with a clipped plate washer, lock washer and nut. Hand tighten only at this time.
4. Insert a 7/16" x 4" bolt through the rear steering mount (replacing the bolt removed in step #1) through the frame on the driver's side and hand tighten. Now, position and hand tighten the passenger side main bracket.
5. Using 1/2" x 1 1/2" bolts, insert the bolt through the middle hole of the bracket then through the driver side tie down loop and finish off with a clipped plate washer, lock washer and nut. Hand tighten only at this time.
6. Mount and align the face plate on the main braces. Now, tighten all bolts to the bolt torque requirements below.
7. Using the rear hole in the main brace, drill a 7/16" hole all the way through the frame. Insert a 7/16" x 4" bolt through the bracket, the frame and the larger rectangular backing plate. Finish off with a lock washer and nut torqued down as per chart.
8. Take middle brace and loosely bolt on top of the tow hook using a 1/2" x 1 1/2" bolt and smaller square backing plate. *Note:* the bolt must be inserted first through the plate, tow hook then through brace. Bolt the other end of brace to the face plate.
9. Replace the stabilizer bar mounts and tighten all bolts to the bolt torque requirements below.

HARDWARE LIST:

2-7/16" X 4" BOLTS	1- 1/4" x 2" x 3" BACKING PLATE
2-1/2" CLIPPED PLATE WASHERS	1- 1/4" x 3" x 4" BACKING PLATE
9-1/2" NUTS	9-1/2" X 1 1/2" BOLTS
9-1/2" LOCK WASHERS	2-7/16" LOCK WASHERS
12-1/2" FLAT WASHERS	2-7/16" NUTS

7/14/99

BOLT TORQUE REQUIREMENTS

Note: The torque values represented below are intended as general guidelines. Torque requirements for specific applications may vary. Roadmaster does not warrant this information to be accurate for all applications and disclaims all liability for any claims or damages which may result from its use.

STANDARD BOLTS			METRIC BOLTS			METRIC BOLTS		
Thread Size	Grade	Torque	Thread Size	Grade	Plated/Unplated	Thread Size	Grade	Plated/Unplated
5/16	5	13 ft./lb.	8mm-1.0	8.8	20 ft./lb. 18 ft./lb.	12mm-1.25	8.8	70 ft./lb. 65 ft./lb.
3/8	5	23 ft./lb.	8mm-1.25	8.8	19 ft./lb. 18 ft./lb.	12mm-1.5	8.8	66 ft./lb. 61 ft./lb.
7/16	5	37 ft./lb.	10mm-1.25	8.8	38 ft./lb. 36 ft./lb.	12mm-1.75	8.8	65 ft./lb. 60 ft./lb.
1/2	5	56 ft./lb.	10mm-1.5	8.8	37 ft./lb. 35 ft./lb.	14mm-2.0	8.8	104 ft./lb. 97 ft./lb.
5/8	5	150 ft./lb.						

All illustrations and specifications contained herein are based on the latest information available at the time of publication approval. ROADMASTER, INC. reserves the right to make changes at any time without notice in material, specification and models or to discontinue models.