

BASEPLATE KIT INSTALLATION INSTRUCTIONS

ROADMASTER, Inc. 6110 NE 127th Ave. Vancouver, WA 98682 1-800-669-9690 fax 360-735-9300 www.roadmasterinc.com

PARTS LIST:

- 1- RECEIVER BRACE (A)
- 1- FRONT BRACE (B) - Passenger side C001804
- 1- FRONT BRACE (C) - Driver's side C001803
- 1- FRONT BRACE (D) - Passenger side
- 1- FRONT BRACE (E) - Driver's side

KIT NO. 1009-1

File #1298

IMPORTANT: All brackets *must* be assembled with all the bolts left loose for final adjustment & positioning (before tightening) unless otherwise instructed. All bolts *must* be torqued for proper strength. If more than one bolt is used per fastening point, the diagram may only show one.

- Use flat washers over all slotted holes
- Use lock washers on all fasteners

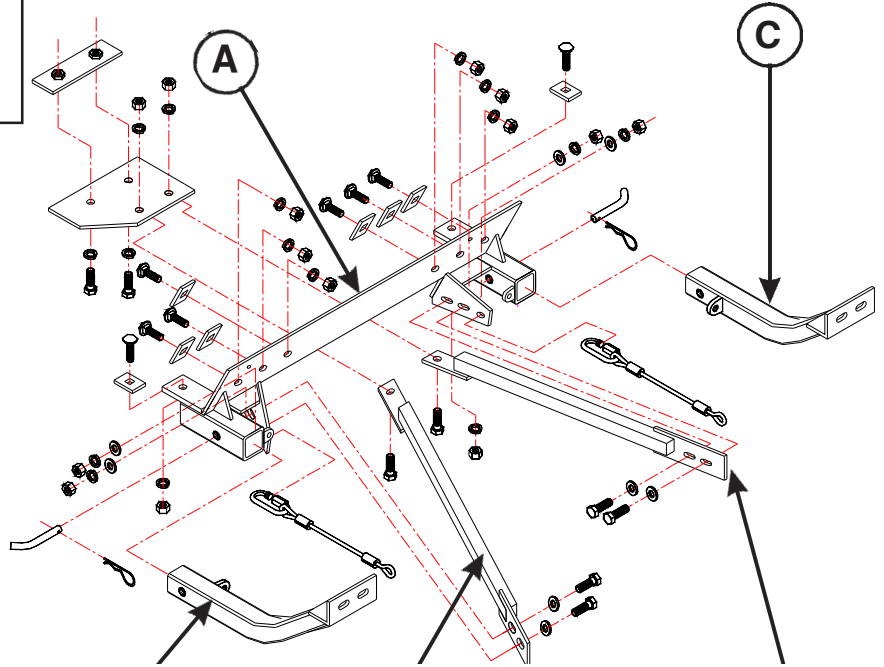

IMPORTANT: All baseplates *must* be assembled with all the bolts left loose for final adjustment and positioning (before tightening) unless otherwise instructed. All bolts *must* be torqued for proper strength. If more than one bolt is used per fastening point, the diagram may only show one. Use flat washers over all slotted holes and lock washers on all fasteners.

WARNING

Failure to heed these warnings or follow the installation instructions may result in a voided warranty, loss of towed vehicle, personal injury or death.

- Do not weld or modify this baseplate or its components. Welding or modification will void the warranty.
- Do not use this document as a basis to design/fabricate a baseplate, as it may not show all parts or structural components.
- We strongly recommend professional installation.
- If the towed vehicle has been in an accident, it must be properly repaired before attaching the baseplate. Do not install the baseplate if any structural frame damage is found.
- The installer must use all bolts and parts supplied. If running changes were made by the vehicle manufacturer after this kit was designed, some bolts or other fasteners may no longer be the correct size. It is the installer's responsibility to verify this kit is securely fastened to the vehicle.
- Use Loctite® Red on all bolts used to secure this baseplate. Torque all bolts to the specifications found at the end of these instructions. Do not over-torque the bolts or failure may occur.
- The installer must inspect the baseplate to ensure adequate clearance, particularly around hoses, air conditioner lines, radiators, etc. or non-warranty failure may result.
- Roadmaster manufactures many styles of baseplates. If your baseplate has removable arms, they must be removed before driving the vehicle, unless the arms can be pinned or padlocked in place. If not secured, the arms could vibrate out.
- Some motorhome chassis have such a tight turning radius that you can damage your motorhome, towed vehicle, tow bar or baseplate while turning sharply. Before getting on the road, test your turning radius in

an empty parking lot. Turning too sharply could result in non-warranty damage to your towing system, motorhome and/or towed vehicle.

- Do not back up with the towed vehicle attached or non-warranty damage will occur to your towing system or vehicles.
- The safety cables must connect the towing vehicle to the towed vehicle frame to frame, with the cables crossed, with enough slack for sharp turns. See cable instructions for proper routing. Failure to do so will result in non-warranty damage and/or the loss of the towed vehicle.
- This kit is designed for use with ROADMASTER tow bars and ROADMASTER adapters only. Using this kit with other brands, without an approved ROADMASTER adapter, may result in non-warranty damage or injury.
- Receiver extensions and out-of-level towing situations of 3 inches or more. This can cause the system to swing much higher and lower, causing excessive strain on the tow bar, baseplate and frame. That can cause the towing system to fail, causing property damage, personal injury or even death. If you must use a receiver extension or drop hitch to tow, it will reduce your receiver's weight capacity by 1/3 to avoid damaging your system. Never use more than one extension and/or drop hitch, as this will void your warranty.
- Every 3,000 miles, the owner must inspect all mounting points for cracks or fatigue, and check the fasteners for proper torque, according to the bolt torque requirements chart on the last page of these instructions.
- The owner must follow the vehicle manufacturer's instructions to prepare the vehicle for towing. Failure to do so may cause severe damage to the vehicle.
- This baseplate is only warranted for the original installation. Installing a used baseplate on another vehicle is not recommended and will void the warranty.

BASEPLATE KIT INSTALLATION INSTRUCTIONS

ROADMASTER, Inc. 6110 NE 127th Ave. Vancouver, WA 98682 1-800-669-9690 fax 360-735-9300 www.roadmasterinc.com

KIT NO. 1009-1

1. **Important:** please use all supplied bolts and parts and read all instructions carefully before beginning this installation. The majority of questions you may have can be answered within the text, and proper installation will ensure safe and secure travel.

Now, begin the installation by locating the steering pump cooler lines running in front of the front cross member. Pull the cooler lines forward enough to release them from the two plastic clips. Remove the plastic clips and save.

2. Hold or clamp the receiver brace in the front of and below the front frame member. It should be positioned in the middle of the vehicle with the lower mounts underneath the frame member. *Note:* the brace slopes under the cooler lines.

3. Fishwire, or insert through the large lower frame access holes, 1/4" x 1 1/2" x 2" backing plates and 1/2" x 1 1/2" carriage bolts into the bolt holes in the receiver brace. Install 1/2" nuts and lock washers and tighten to hold the brace.

4. Mount the rear brace plate to the engine mount cross member by sliding the 1/4" x 2" threaded backing plate into the cross member and bolting through the plate and cross member holes with 1/2" x 1 1/2" bolts and lock washers. Install so that the 45-degree corner is forward and toward the passenger side for differential clearance.

5. Bolt the lower braces to the rear mounting plate with 1/2" x 1 1/2" bolts, lock washers and nuts, bolt the front of the rear braces to the receiver brace using two 1/2" x 1 1/2" bolts, flat washers, lock washers and nuts. *Note:* the passenger side rear brace is slightly longer than the driver's side rear brace.

6. Make sure the receiver brace is aligned correctly, then using the brace as a drill template, drill one 1/2" hole per side into the bottom of the cross member.

7. Fishwire a 1/2" x 1 1/2" carriage bolt and a 1/4" x 1 1/2" x 1 3/4" backing plate into the two remaining holes in the brace. Finish with 1/2" nuts and lock washers.

8. Torque all bolts to the torque specifications below.

9. Reinsert the small plastic keepers for the steering pump line into the holes provided in the receiver brace and insert the steering pump line into the keepers.

10. Insert the front braces into the receiver tubes and pin using the supplied 5/8" draw pins and 1/8" spring clips.

11. Mount the tow bar according to the manufacturer's instructions.

12. Connect the provided 15" safety cables to the lower receiver braces using the provided cable links, then connect the safety cables to the tow vehicle's safety cables.

Hardware:	8- 1/2" flat washers	1- 1/4" rear plate	02/24/09
8- 1/2" x 1-1/2" carriage bolts	6- 1/4" x 1-1/2" x 2" backing plates	2- 1/8" spring pins	
14- 1/2" nuts	2- 1/4" x 1-1/2" x 1-3/4" backing plates	2- 15" safety cables	
10- 1/2" x 1-1/2" bolts	1- 1/4" x 2" x 6-5/8" threaded backing plate	2- cable connectors	
16- 1/2" lock washers	2- 5/8" draw pins		

BOLT TORQUE REQUIREMENTS

Note: The torque values represented below are intended as general guidelines. Torque requirements for specific applications may vary. Roadmaster does not warrant this information to be accurate for all applications and disclaims all liability for any claims or damages which may result from its use.

STANDARD BOLTS			METRIC BOLTS			METRIC BOLTS		
Thread Size	Grade	Torque	Thread Size	Grade	Plated/Unplated	Thread Size	Grade	Plated/Unplated
5/16	5	13 ft./lb.	8mm-1.0	8.8	20 ft./lb. 18 ft./lb.	12mm-1.25	8.8	70 ft./lb. 65 ft./lb.
3/8	5	23 ft./lb.	8mm-1.25	8.8	19 ft./lb. 18 ft./lb.	12mm-1.5	8.8	66 ft./lb. 61 ft./lb.
7/16	5	37 ft./lb.	10mm-1.25	8.8	38 ft./lb. 36 ft./lb.	12mm-1.75	8.8	65 ft./lb. 60 ft./lb.
1/2	5	56 ft./lb.	10mm-1.5	8.8	37 ft./lb. 35 ft./lb.	14mm-2.0	8.8	104 ft./lb. 97 ft./lb.
5/8	5	150 ft./lb.						