

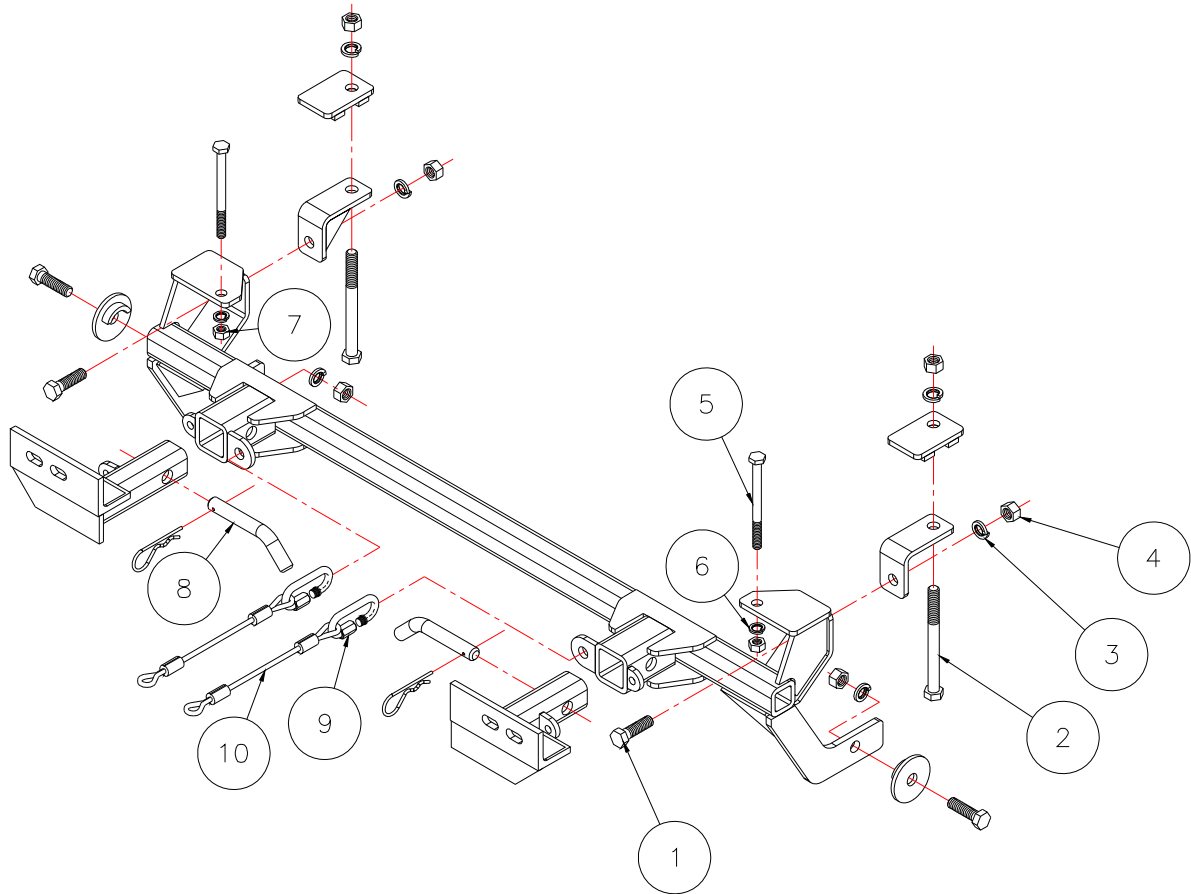

# BASEPLATE KIT INSTALLATION INSTRUCTIONS

**KIT# 1017-1**  
06/21/04

ROADMASTER, Inc. 6110 NE 127th Ave. Vancouver, WA 98682 1-800-669-9690 fax 360-735-9300 www.roadmasterinc.com



Item	Qty.	Length	Width	Hardware	Part No.
1	4	1 3/4"	1/2"	1/2" x 1 3/4" BOLT	350096-00
2	2	5 1/2"	1/2"	1/2" x 5 1/2" BOLT	350108-00
3	6		1/2"	LOCK WASHER	350309-00
4	6		1/2"	NUT	350258-00
5	2	120mm	10mm	10mm x 1.25 x120mm BOLT	356210-00
6	2		10mm	LOCK WASHER	355715-00
7	2		10mm	NUT	356220-00
8	2		5/8"	DRAW PIN, SPRING PIN	357035-00
9	2			CABLE CONNECTOR	200008-00
10	2		8"	SAFETY CABLE	500646-08

ROADMASTER, INC.



# BASEPLATE KIT INSTALLATION INSTRUCTIONS

**KIT# 1017-1**  
06/21/04

ROADMASTER, Inc. 6110 NE 127th Ave. Vancouver, WA 98682 1-800-669-9690 fax 360-735-9300 www.roadmasterinc.com

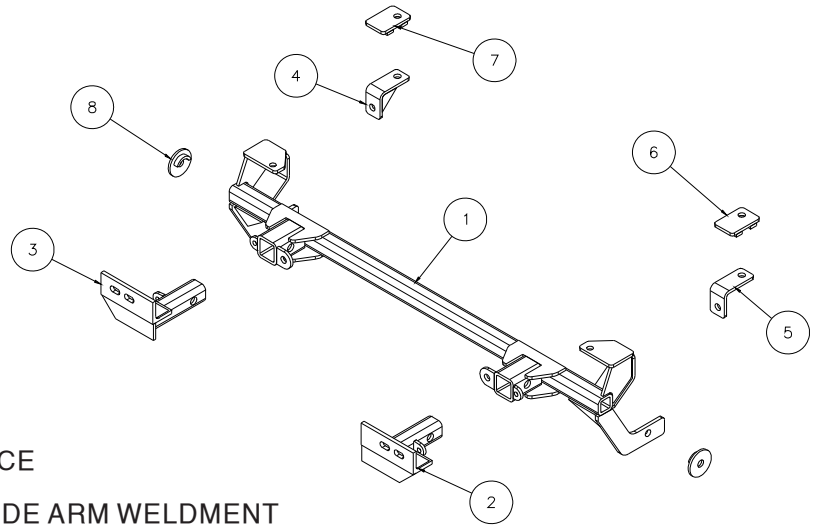

ITEM	QTY	PART NO.	ASSEMBLY
1	1	C-000960	.... MAIN BRACE
2	1	C-000961	.... DRIVER SIDE ARM WELDMENT
3	1	C-000962	.... PASSENGER SIDE ARM WELDMENT
4	1	C-000963	.... PASSENGER SIDE LOWER CORE SUPPORT BRACE TO FRAME RAIL
5	1	C-000964	.... DRIVER SIDE LOWER CORE SUPPORT BRACE TO FRAME RAIL

**IMPORTANT:** All baseplates **must** be assembled with all the bolts left loose for final adjustment and positioning (before tightening) unless otherwise instructed. All bolts **must** be torqued for proper strength. If more than one bolt is used per fastening point, the diagram may only show one. Use flat washers over all slotted holes and lock washers on all fasteners.

## WARNING

Failure to heed these warnings or follow the installation instructions may result in a voided warranty, loss of towed vehicle, personal injury or death.

- Do not weld or modify this baseplate or its components. Welding or modification will void the warranty.
- Do not use this document as a basis to design/fabricate a baseplate, as it may not show all parts or structural components.
- We strongly recommend professional installation.
- If the towed vehicle has been in an accident, it must be properly repaired before attaching the baseplate. Do not install the baseplate if any structural frame damage is found.
- The installer must use all bolts and parts supplied. If running changes were made by the vehicle manufacturer after this kit was designed, some bolts or other fasteners may no longer be the correct size. It is the installer's responsibility to verify this kit is securely fastened to the vehicle.
- Use Loctite® Red on all bolts used to secure this baseplate. Torque all bolts to the specifications found at the end of these instructions. Do not over-torque the bolts or failure may occur.
- The installer must inspect the baseplate to ensure adequate clearance, particularly around hoses, air conditioner lines, radiators, etc. or non-warranty failure may result.
- Roadmaster manufactures many styles of baseplates. If your baseplate has removable arms, they must be removed before driving the vehicle, unless the arms can be pinned or padlocked in place. If not secured, the arms could vibrate out.
- Some motorhome chassis have such a tight turning radius that you can damage your motorhome, towed vehicle, tow bar or baseplate while turning sharply. Before getting on the road, test your turning radius in an empty parking lot. Turning too sharply could result in non-warranty damage to your towing system, motorhome and/or towed vehicle.
- Do not back up with the towed vehicle attached or non-warranty damage will occur to your towing system or vehicles.
- The safety cables must connect the towing vehicle to the towed vehicle frame to frame, with the cables crossed, with enough slack for sharp turns. See cable instructions for proper routing. Failure to do so will result in non-warranty damage and/or the loss of the towed vehicle.
- This kit is designed for use with ROADMASTER tow bars and ROADMASTER adapters only. Using this kit with other brands, without an approved ROADMASTER adapter, may result in non-warranty damage or injury.
- Receiver extensions and out-of-level towing situations of 3 inches or more. This can cause the system to swing much higher and lower, causing excessive strain on the tow bar, baseplate and frame. That can cause the towing system to fail, causing property damage, personal injury or even death. If you must use a receiver extension or drop hitch to tow, it will reduce your receiver's weight capacity by 1/3 to avoid damaging your system. Never use more than one extension and/or drop hitch, as this will void your warranty.
- Every 3,000 miles, the owner must inspect all mounting points for cracks or fatigue, and check the fasteners for proper torque, according to the bolt torque requirements chart on the last page of these instructions.
- The owner must follow the vehicle manufacturer's instructions to prepare the vehicle for towing. Failure to do so may cause severe damage to the vehicle.
- This baseplate is only warranted for the original installation. Installing a used baseplate on another vehicle is not recommended and will void the warranty.



# BASEPLATE KIT INSTALLATION INSTRUCTIONS

**KIT# 1017-1**  
06/21/04

ROADMASTER, Inc. 6110 NE 127th Ave. Vancouver, WA 98682 1-800-669-9690 fax 360-735-9300 www.roadmasterinc.com

This bracket kit is one of our XL series with removable front braces. The kit consists of a receiver brace which mounts to the side of the front frame tubes, two removable front braces and a hardware packet. Everything but the front arm braces install behind the bumper fascia (Fig. A). The front fascia and grille will have to be removed for the installation.



**1. Important: please use all supplied bolts and parts and read all instructions carefully before beginning this installation. The majority of questions you may have can be answered within the text, and proper installation will ensure safe and secure travel.**

Now, starting on the top of the fascia, remove four plastic fasteners (phillips head) between the headlights (Fig.B).



**2. Remove two bolts (10mm head) in the top of each headlight (Fig.C), and one more in the bottom (Fig.D). Disconnect two connections in the back of each headlight (Fig.E) and remove.**

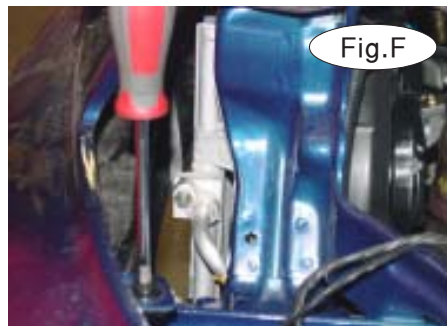
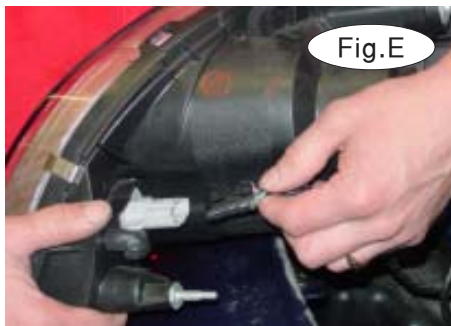

**3. Remove four plastic fasteners in each headlight opening (Fig.F). two more fasteners behind the grille (Fig.G).**



# BASEPLATE KIT INSTALLATION INSTRUCTIONS

**KIT# 1017-1**  
06/21/04

ROADMASTER, Inc. 6110 NE 127th Ave. Vancouver, WA 98682 1-800-669-9690 fax 360-735-9300 www.roadmasterinc.com

R  
O  
A  
D  
M  
A  
S  
T  
E  
R  
,  
I  
N  
C.



Fig.H



Fig.I



Fig.J

4. Disconnect the side marker lights (Fig.H) then remove four lower (7mm head) fasteners from the lower fascia on each side (Fig.I).
5. Pull the splash panel down to access the fender fascia joint and remove a screw (7mm head) located in the fender joint on each side (Fig.J).



Fig.K



Fig.L



Fig.M

6. Move under the bumper core and remove two plastic fasteners holding the fascia (Fig.K,L).
7. Pull forward to remove the fascia. (Fig.M).

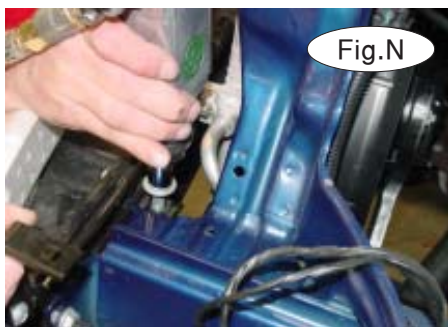

Fig.N



Fig.O

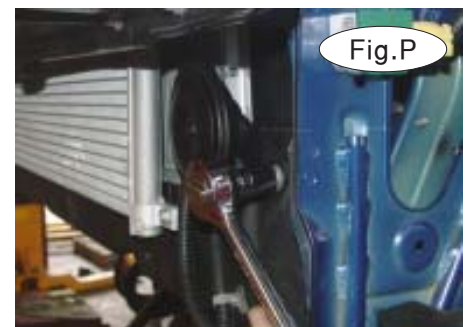

Fig.P

8. Working on the drivers side, remove the large bumper bolt located behind the bumper core (Fig.N).
9. Drill the lower bumper bolt frame nut with a 13/32" drill bit (Fig.O).
10. While in the area remove the horn (Fig.P)(14mm head) bolt and remove two more plastic fasteners from the lower splash panel for access (Fig.Q).



Fig.Q



# BASEPLATE KIT INSTALLATION INSTRUCTIONS

**KIT# 1017-1**  
06/21/04

ROADMASTER, Inc. 6110 NE 127th Ave. Vancouver, WA 98682 1-800-669-9690 fax 360-735-9300 www.roadmasterinc.com

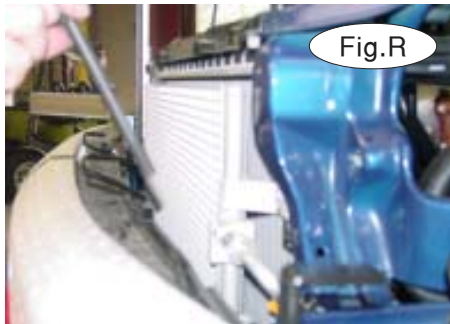

Fig.R



Fig.S

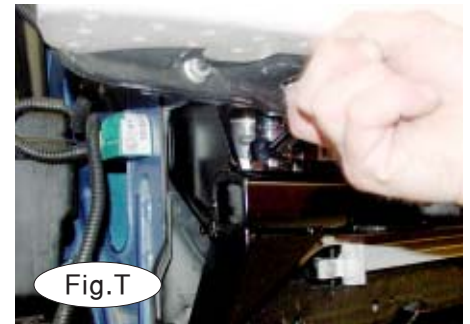

Fig.T

11. Replace the original bumper core bolt with a 10mm x 1.25 x 120mm bolt (Fig.R), then repeat steps 8 through 11 for the passenger side excluding the horn.

12. Hold the main receiver brace under the bumper core with the 10mm bolts through the upper mounts then bolt in place using a fender washer, lock washer and nut on each side (Fig.S,T).



Fig.U



Fig.V



Fig.W

13. Bolt through the lower main receiver brace mounting holes and the vehicles tie down loops with  $\frac{1}{2}$ " x  $1\frac{3}{4}$ " bolts, welded backing plates, lock washers and nuts on each side (Fig.U,V). Tighten all the mounting bolts installed so far.

14. Drill through the front of the frame on each side using the main receiver brace as a drill guide (Fig.W).



Fig.X

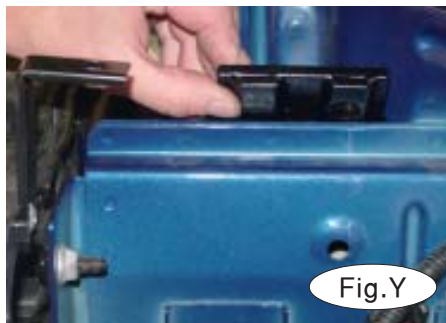

Fig.Y

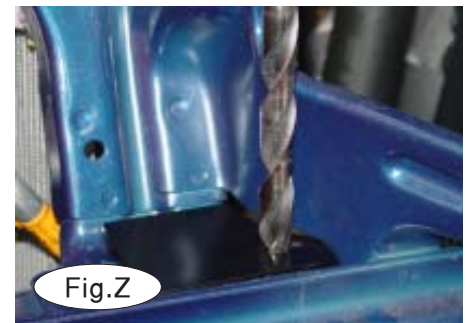

Fig.Z

15. Bolt through these holes mounting holes in the receiver brace, the frame and the rear frame rail braces with  $\frac{1}{2}$ " x  $1\frac{3}{4}$ " bolts, flat washers and nuts on both sides (Fig.X).

16. Fit the top backing plate to the top frame corrugations and use as a drilling guide for the top hole in the frame on each side (Fig.Y,Z). Continue drilling through the bottom of the frame and the installed frame supports on the bottom of the frames (Fig.AA).

# BASEPLATE KIT INSTALLATION INSTRUCTIONS

**KIT# 1017-1**  
06/21/04



ROADMASTER, Inc. 6110 NE 127th Ave. Vancouver, WA 98682 1-800-669-9690 fax 360-735-9300 www.roadmasterinc.com

ROADMASTER, INC.



Fig.AA

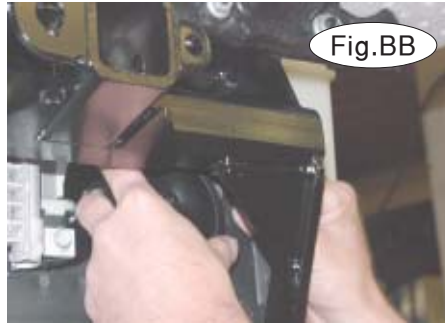

Fig.BB

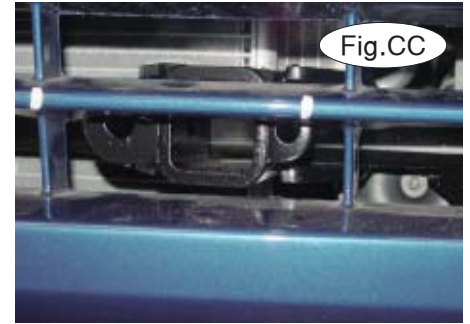

Fig.CC

17. Bolt trough the bottom frame support and the top backing plate with 1/2" x 5 1/2" bolts, lock washers and nuts (Fig.AA), then tighten all mounting bolts to the torque specifications below.
18. Refit horn removed in step 11, bend the mount as needed to displace horn away from the main brace. Double check and make sure the horn body or diaphragm doesn't contact anything (Fig.BB).
19. Trial fit the fascia, mark and cut center rib as shown to fit (Fig.CC), then reinstall fascia reversing steps 1 through 6.
20. Install the front braces in the receiver tubes a pin in place with 5/8" draw pins and 3/16" spring pins (Fig.DD).
21. Attach the 8" safety cables to the receiver brace with the included cable connectors (Fig.DD). Connect the other ends to the tow vehicle's safety cables and tow bar.
22. Install the tow bar according to the manufacturer's instructions and torque all bolts to the torque specifications below.

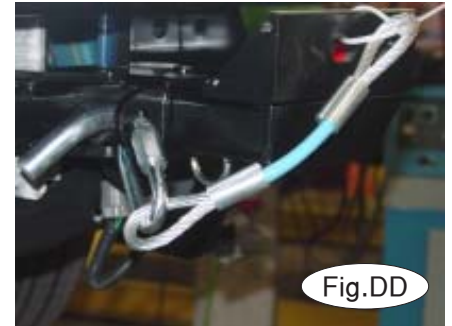

Fig.DD

## BOLT TORQUE REQUIREMENTS

Note: The torque values represented below are intended as general guidelines. Torque requirements for specific applications may vary. Roadmaster does not warrant this information to be accurate for all applications and disclaims all liability for any claims or damages which may result from its use.

STANDARD BOLTS			METRIC BOLTS			METRIC BOLTS		
Thread Size	Grade	Torque	Thread Size	Grade	Plated/Unplated	Thread Size	Grade	Plated/Unplated
5/16	5	13 ft./lb.	8mm-1.0	8.8	20 ft./lb. 18 ft./lb.	12mm-1.25	8.8	70 ft./lb. 65 ft./lb.
3/8	5	23 ft./lb.	8mm-1.25	8.8	19 ft./lb. 18 ft./lb.	12mm-1.5	8.8	66 ft./lb. 61 ft./lb.
7/16	5	37 ft./lb.	10mm-1.25	8.8	38 ft./lb. 36 ft./lb.	12mm-1.75	8.8	65 ft./lb. 60 ft./lb.
1/2	5	56 ft./lb.	10mm-1.5	8.8	37 ft./lb. 35 ft./lb.	14mm-2.0	8.8	104 ft./lb. 97 ft./lb.
5/8	5	150 ft./lb.						

All illustrations and specifications contained herein are based on the latest information available at the time of publication approval. ROADMASTER, INC. reserves the right to make changes at any time without notice in material, specification and models or to discontinue models.