

# BASEPLATE KIT INSTALLATION INSTRUCTIONS

ROADMASTER, Inc. 6110 NE 127th Ave. Vancouver, WA 98682 1-800-669-9690 fax 360-735-9300 www.roadmasterinc.com

**PARTS LIST:**

- 1- FRONT BRACE (A) - Passenger side
- 1- FRONT BRACE (B) - Driver's side
- 1- MAIN BRACE (C)

**KIT NO. 1137-1**

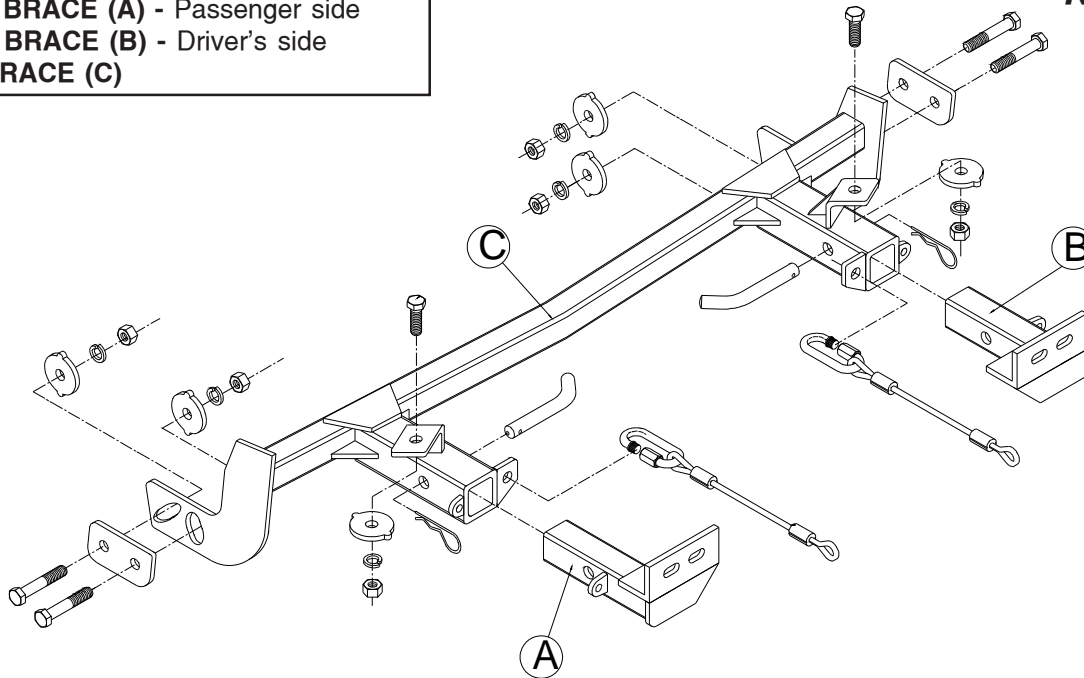

9/7/99

**IMPORTANT:** All baseplates *must* be assembled with all the bolts left loose for final adjustment and positioning (before tightening) unless otherwise instructed. All bolts *must* be torqued for proper strength. If more than one bolt is used per fastening point, the diagram may only show one. Use flat washers over all slotted holes and lock washers on all fasteners.

## WARNING

Failure to heed these warnings or follow the installation instructions may result in a voided warranty, loss of towed vehicle, personal injury or death.

- Do not weld or modify this baseplate or its components. Welding or modification will void the warranty.
- Do not use this document as a basis to design/fabricate a baseplate, as it may not show all parts or structural components.
- We strongly recommend professional installation.
- If the towed vehicle has been in an accident, it must be properly repaired before attaching the baseplate. Do not install the baseplate if any structural frame damage is found.
- The installer must use all bolts and parts supplied. If running changes were made by the vehicle manufacturer after this kit was designed, some bolts or other fasteners may no longer be the correct size. It is the installer's responsibility to verify this kit is securely fastened to the vehicle.
- Use Loctite® Red on all bolts used to secure this baseplate. Torque all bolts to the specifications found at the end of these instructions. Do not over-torque the bolts or failure may occur.
- The installer must inspect the baseplate to ensure adequate clearance, particularly around hoses, air conditioner lines, radiators, etc. or non-warranty failure may result.
- Roadmaster manufactures many styles of baseplates. If your baseplate has removable arms, they must be removed before driving the vehicle, unless the arms can be pinned or padlocked in place. If not secured, the arms could vibrate out.
- Some motorhome chassis have such a tight turning radius that you can damage your motorhome, towed vehicle, tow bar or baseplate while turning sharply. Before getting on the road, test your turning radius in

an empty parking lot. Turning too sharply could result in non-warranty damage to your towing system, motorhome and/or towed vehicle.

- Do not back up with the towed vehicle attached or non-warranty damage will occur to your towing system or vehicles.
- The safety cables must connect the towing vehicle to the towed vehicle frame to frame, with the cables crossed, with enough slack for sharp turns. See cable instructions for proper routing. Failure to do so will result in non-warranty damage and/or the loss of the towed vehicle.
- This kit is designed for use with ROADMASTER tow bars and ROADMASTER adapters only. Using this kit with other brands, without an approved ROADMASTER adapter, may result in non-warranty damage or injury.
- Receiver extensions and out-of-level towing situations of 3 inches or more. This can cause the system to swing much higher and lower, causing excessive strain on the tow bar, baseplate and frame. That can cause the towing system to fail, causing property damage, personal injury or even death. If you must use a receiver extension or drop hitch to tow, it will reduce your receiver's weight capacity by 1/3 to avoid damaging your system. Never use more than one extension and/or drop hitch, as this will void your warranty.
- Every 3,000 miles, the owner must inspect all mounting points for cracks or fatigue, and check the fasteners for proper torque, according to the bolt torque requirements chart on the last page of these instructions.
- The owner must follow the vehicle manufacturer's instructions to prepare the vehicle for towing. Failure to do so may cause severe damage to the vehicle.
- This baseplate is only warranted for the original installation. Installing a used baseplate on another vehicle is not recommended and will void the warranty.

# BASEPLATE KIT INSTALLATION INSTRUCTIONS

ROADMASTER, Inc. 6110 NE 127th Ave. Vancouver, WA 98682 1-800-669-9690 fax 360-735-9300 www.roadmasterinc.com

**KIT NO. 1137-1**

1. **Important:** please use all supplied bolts and parts and read all instructions carefully before beginning this installation. The majority of questions you may have can be answered within the text, and proper installation will ensure safe and secure travel. Now, begin the installation.
2. Remove the lower splash panels bolts on each side (3) and bumper skin bolts in the front (2) and set aside.
3. Remove the top 10mm bolts holding the turn signal lights and pull lights forward on each side. Now remove 10mm bolt underneath the turn signal lights holding bumper fascia.
4. Now, position the receiver brace between the lower tie down plates with the front mounting tabs inserted into the back of the steel bumper core. Locate the special two-hole 1/4" backing plates and fit outside the lower tie down plates. Bolt through on each side using four 1/2" x 2" bolts, plate washers, lock washers, and nuts.
5. Align the receiver brace so that the front mounting tabs are flat on the inside bottom of the bumper, then tighten the four mounting bolts.
6. Now, mark two center points on the bottom of the bumper core 1 3/4" from the front of the receivers and 1/4" from the outside of the receiver tubes. These marks should line up underneath the holes in the mounting tabs inside the bumper.
7. Drill a 1/4" or smaller pilot hole in the bottom of the bumper at each mark. Now, enlarge the hole with a 1/2" bit and match it with the holes in the braces mounting tabs.
8. Bolt up through the bumper using two 1/2" x 1 3/4" bolts, 1/2" plate washers, lock washers and nuts. Be sure to use the plate washers under the bumper and to bolt up through the bumper as illustrated.
9. Tighten all the bolts to the torque specifications below.
10. Take the bumper skin and measure 26" center to center and on center, approximately 2" down in the grill area. This will be where the receiver tubes will be when the skin is reinstalled. Cut the cross ribs located in the grill at these coordinates. You should only have to cut one on each side for clearance.
11. Reinstall the bumper skin and lower splash guards.
12. Insert the front braces into the receiver tubes and pin using the supplied 5/8" draw pins and 1/8" spring pins.
13. Install the tow bar according to the manufacturers instructions then torque the mounting bolts to the specifications below.
14. Use the cable connectors to attach the supplied 13" safety cables to the front receivers and the tow vehicle's safety cables.

**HARDWARE LIST:**

- |                                      |                     |
|--------------------------------------|---------------------|
| 4-1/2" X 2 " BOLTS                   | 2-13" SAFETY CABLES |
| 2-1/2" X 1 1/2" BOLTS                | 2-CABLE CONNECTORS  |
| 6-1/2" LOCK WASHERS                  | 2-5/8" DRAW PINS    |
| 6-1/2" PLATE WASHES                  | 2-1/8" SPRING PINS  |
| 6-1/2" NUTS                          |                     |
| 2-1/4" BACKING PLATES WITH TWO HOLES |                     |

9/7/99

**BOLT TORQUE REQUIREMENTS**

Note: The torque values represented below are intended as general guidelines. Torque requirements for specific applications may vary. Roadmaster does not warrant this information to be accurate for all applications and disclaims all liability for any claims or damages which may result from its use.

STANDARD BOLTS			METRIC BOLTS			METRIC BOLTS		
Thread Size	Grade	Torque	Thread Size	Grade	Plated/Unplated	Thread Size	Grade	Plated/Unplated
5/16	5	13 ft./lb.	8mm-1.0	8.8	20 ft./lb. 18 ft./lb.	12mm-1.25	8.8	70 ft./lb. 65 ft./lb.
3/8	5	23 ft./lb.	8mm-1.25	8.8	19 ft./lb. 18 ft./lb.	12mm-1.5	8.8	66 ft./lb. 61 ft./lb.
7/16	5	37 ft./lb.	10mm-1.25	8.8	38 ft./lb. 36 ft./lb.	12mm-1.75	8.8	65 ft./lb. 60 ft./lb.
1/2	5	56 ft./lb.	10mm-1.5	8.8	37 ft./lb. 35 ft./lb.	14mm-2.0	8.8	104 ft./lb. 97 ft./lb.
5/8	5	150 ft./lb.						