

BASEPLATE KIT INSTALLATION INSTRUCTIONS

ROADMASTER, Inc. 6110 NE 127th Ave. Vancouver, WA 98682 1-800-669-9690 fax 360-735-9300 www.roadmasterinc.com

PARTS LIST:

- 1- MAIN BRACE (A) - Passenger side
- 1- MAIN BRACE (B) - Driver's side
- 1- FRONT BRACE (C) - Passenger side
- 1- FRONT BRACE (D) - Driver's side

KIT NO. 1219-1

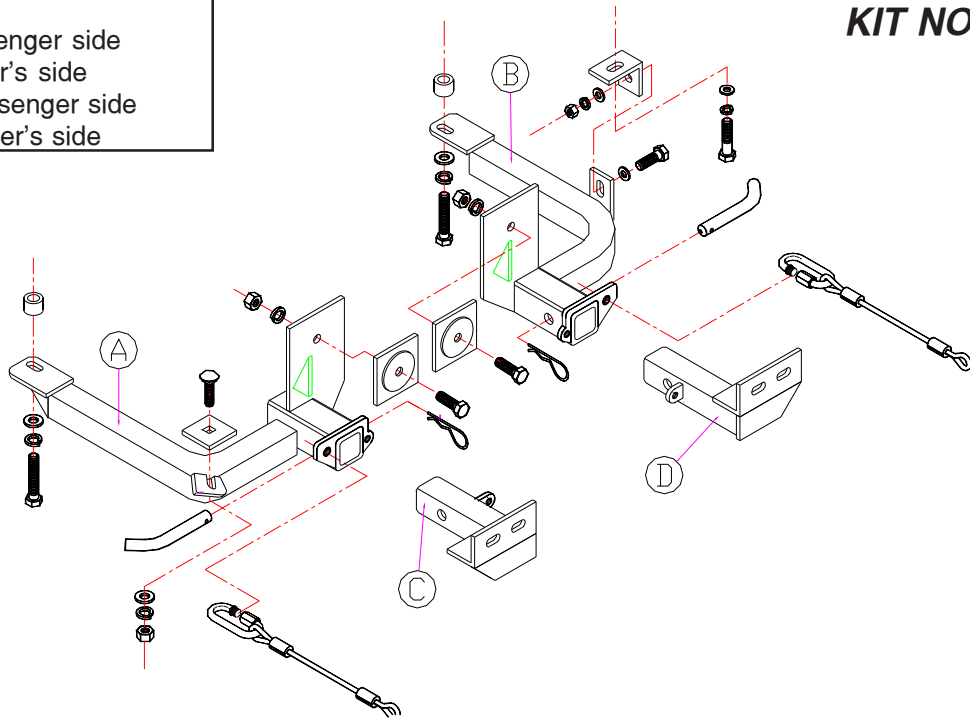

011599

IMPORTANT: All baseplates *must* be assembled with all the bolts left loose for final adjustment and positioning (before tightening) unless otherwise instructed. All bolts *must* be torqued for proper strength. If more than one bolt is used per fastening point, the diagram may only show one. Use flat washers over all slotted holes and lock washers on all fasteners.

WARNING

Failure to heed these warnings or follow the installation instructions may result in a voided warranty, loss of towed vehicle, personal injury or death.

- Do not weld or modify this baseplate or its components. Welding or modification will void the warranty.
- Do not use this document as a basis to design/fabricate a baseplate, as it may not show all parts or structural components.
- We strongly recommend professional installation.
- If the towed vehicle has been in an accident, it must be properly repaired before attaching the baseplate. Do not install the baseplate if any structural frame damage is found.
- The installer must use all bolts and parts supplied. If running changes were made by the vehicle manufacturer after this kit was designed, some bolts or other fasteners may no longer be the correct size. It is the installer's responsibility to verify this kit is securely fastened to the vehicle.
- Use Loctite® Red on all bolts used to secure this baseplate. Torque all bolts to the specifications found at the end of these instructions. Do not over-torque the bolts or failure may occur.
- The installer must inspect the baseplate to ensure adequate clearance, particularly around hoses, air conditioner lines, radiators, etc. or non-warranty failure may result.
- Roadmaster manufactures many styles of baseplates. If your baseplate has removable arms, they must be removed before driving the vehicle, unless the arms can be pinned or padlocked in place. If not secured, the arms could vibrate out.
- Some motorhome chassis have such a tight turning radius that you can damage your motorhome, towed vehicle, tow bar or baseplate while turning sharply. Before getting on the road, test your turning radius in

an empty parking lot. Turning too sharply could result in non-warranty damage to your towing system, motorhome and/or towed vehicle.

- Do not back up with the towed vehicle attached or non-warranty damage will occur to your towing system or vehicles.
- The safety cables must connect the towing vehicle to the towed vehicle frame to frame, with the cables crossed, with enough slack for sharp turns. See cable instructions for proper routing. Failure to do so will result in non-warranty damage and/or the loss of the towed vehicle.
- This kit is designed for use with ROADMASTER tow bars and ROADMASTER adapters only. Using this kit with other brands, without an approved ROADMASTER adapter, may result in non-warranty damage or injury.
- Receiver extensions and out-of-level towing situations of 3 inches or more. This can cause the system to swing much higher and lower, causing excessive strain on the tow bar, baseplate and frame. That can cause the towing system to fail, causing property damage, personal injury or even death. If you must use a receiver extension or drop hitch to tow, it will reduce your receiver's weight capacity by 1/3 to avoid damaging your system. Never use more than one extension and/or drop hitch, as this will void your warranty.
- Every 3,000 miles, the owner must inspect all mounting points for cracks or fatigue, and check the fasteners for proper torque, according to the bolt torque requirements chart on the last page of these instructions.
- The owner must follow the vehicle manufacturer's instructions to prepare the vehicle for towing. Failure to do so may cause severe damage to the vehicle.
- This baseplate is only warranted for the original installation. Installing a used baseplate on another vehicle is not recommended and will void the warranty.

BASEPLATE KIT INSTALLATION INSTRUCTIONS

ROADMASTER, Inc. 6110 NE 127th Ave. Vancouver, WA 98682 1-800-669-9690 fax 360-735-9300 www.roadmasterinc.com

KIT NO. 1219-1

1. **Important:** please use all supplied bolts and parts and read all instructions carefully before beginning this installation. The majority of questions you may have can be answered within the text, and proper installation will ensure safe and secure travel. Now, begin the installation. This bracket is one of our XL Series in which the front braces can be removed. This brace mounts to the rear of the front bumper and the main sub frame mount on each side of the car. Remove the running lights in the bumper, by snapping from the inner edge out with a small screw driver, then remove the lower grill under the bumper by removing two torx screws, releasing four plastic keepers on the grill and pulling out. To access the rear sub frame mounting bolt on the passenger side, remove two torx screws and pull the inner splash panel down and out of the way.
2. Work on one side at a time starting with the driver side. Remove the front and rear most sub frame mounting bolt at this time. Leave the center bolt in place.
3. Take the small L shaped upper brace and bolt to the front sub frame mounting hole with the supplied 10mm x 1.5mm x 35mm bolt, flat washer and lock washer. Be sure to bolt through the slot and position the brace with the lower leg facing the side of the car. Align and tighten to the torque specifications at this time.
4. Insert the driver side receiver brace through the lower grill. Position the flat mounting plate behind the bumper over a large formed hole in the back of the bumper. The rear of the brace should be positioned over the rear most stabilizer mounting bolt hole.
5. Insert the special 1/4" x 3" x 3" backing plate into the front of the bumper and bolt through it, the bumper and the brace with a 1/2" x 1 3/4" bolt, lock washer and nut. Leave finger tight for now.
6. Bolt through the rear of the brace with a 10mm x 1.5 x 85mm bolt, flat washer, lock washer and 3/4" pipe spacer. The pipe spacer will be sandwiched between the sub frame mount and the brace.
7. Now, bolt through the small upper L shaped brace and the matching side tab on the main receiver brace with a 7/16" x 1 1/2" bolt, flat washers, lock washers and nut.
8. Repeat steps two through five for the remaining passenger side. Now, bolt through the small lug and the vehicles towing loop with a 1/2" x 1 1/2" carriage bolt, 1/4" x 2" x 2" backing plate, flat washer, lock washer and nut.
9. Align the receivers then tighten to the torque specifications below.
10. Reinstall the splash panel screws and running lights. The grill can be trimmed to fit or left off.
11. Install the front braces in the receivers and pin with 5/8" draw pins and 1/8" spring pins.
12. Mount the tow bar according to the manufacturers instructions and torque all bolts to the specifications below.
13. Attach the 10" safety cables to the tow vehicle's tow bar and safety cables.

011599

BOLT TORQUE REQUIREMENTS

Note: The torque values represented below are intended as general guidelines. Torque requirements for specific applications may vary. Roadmaster does not warrant this information to be accurate for all applications and disclaims all liability for any claims or damages which may result from its use.

STANDARD BOLTS			METRIC BOLTS			METRIC BOLTS		
Thread Size	Grade	Torque	Thread Size	Grade	Plated/Unplated	Thread Size	Grade	Plated/Unplated
5/16	5	13 ft./lb.	8mm-1.0	8.8	20 ft./lb. 18 ft./lb.	12mm-1.25	8.8	70 ft./lb. 65 ft./lb.
3/8	5	23 ft./lb.	8mm-1.25	8.8	19 ft./lb. 18 ft./lb.	12mm-1.5	8.8	66 ft./lb. 61 ft./lb.
7/16	5	37 ft./lb.	10mm-1.25	8.8	38 ft./lb. 36 ft./lb.	12mm-1.75	8.8	65 ft./lb. 60 ft./lb.
1/2	5	56 ft./lb.	10mm-1.5	8.8	37 ft./lb. 35 ft./lb.	14mm-2.0	8.8	104 ft./lb. 97 ft./lb.
5/8	5	150 ft./lb.						



1-800-669-9690

R O A D M A S T E R

BASEPLATE KIT INSTALLATION INSTRUCTIONS

ROADMASTER, Inc. 6110 NE 127th Ave. Vancouver, WA 98682 1-800-669-9690 fax 360-735-9300 www.roadmasterinc.com

KIT NO. 1219-1

HARDWARE LIST:

- 2-10MM X 1.5 X 85MM BOLTS
- 2-10MM LOCK WASHERS
- 2-10MM FENDER WASHERS
- 2-1/2" X 1 3/4" BOLTS
- 2-1/2" LOCK WASHERS
- 2-3/4" TUBE SPACERS
- 2-1/4" X 3" X 3" CENTERED BACKING PLATES
- 1-1/2" X 2" X 2" SQUARE HOLE BACKING PLATE
- 1-1/2" X 1 1/2" CARRIAGE BOLTS
- 1-1/2" FLAT WASHERS
- 3-1/2" LOCK WASHERS
- 3-1/2" NUTS
- 1-7/16" X 1 1/2" BOLT
- 2-7/16" FLAT WASHERS
- 1-7/16" LOCK WASHERS
- 1-7/16" NUTS
- 1-10MM X 1.5 X 35MM BOLT
- 1-10MM FENDER WASHER
- 1-10MM LOCK WASHER
- 2-5/8" DRAW PIN
- 2-1/8" SPRING PINS
- 2-10" SAFETY CABLES
- 2-CABLE CONNECTORS
- 1-1/4" L SHAPED BRACE

011599

CAUTION:

Installer must read instructions and use all bolts and parts supplied.

FAILURE TO FOLLOW THESE INSTRUCTIONS CAN RESULT IN DEATH, PERSONAL INJURY OR PROPERTY DAMAGE

BOLT TORQUE REQUIREMENTS

Note: The torque values represented below are intended as general guidelines. Torque requirements for specific applications may vary. Roadmaster does not warrant this information to be accurate for all applications and disclaims all liability for any claims or damages which may result from its use.

STANDARD BOLTS			METRIC BOLTS			METRIC BOLTS		
Thread Size	Grade	Torque	Thread Size	Grade	Plated/Unplated	Thread Size	Grade	Plated/Unplated
5/16	5	13 ft./lb.	8mm-1.0	8.8	20 ft./lb. 18 ft./lb.	12mm-1.25	8.8	70 ft./lb. 65 ft./lb.
3/8	5	23 ft./lb.	8mm-1.25	8.8	19 ft./lb. 18 ft./lb.	12mm-1.5	8.8	66 ft./lb. 61 ft./lb.
7/16	5	37 ft./lb.	10mm-1.25	8.8	38 ft./lb. 36 ft./lb.	12mm-1.75	8.8	65 ft./lb. 60 ft./lb.
1/2	5	56 ft./lb.	10mm-1.5	8.8	37 ft./lb. 35 ft./lb.	14mm-2.0	8.8	104 ft./lb. 97 ft./lb.
5/8	5	150 ft./lb.						

All illustrations and specifications contained herein are based on the latest information available at the time of publication approval. ROADMASTER, INC. reserves the right to make changes at any time without notice in material, specification and models or to discontinue models.