

BASEPLATE KIT INSTALLATION INSTRUCTIONS

ROADMASTER, Inc. 6110 NE 127th Ave. Vancouver, WA 98682 1-800-669-9690 fax 360-735-9300 www.roadmasterinc.com

PARTS LIST:

- 1- MAIN BRACE (A) - Passenger side
- 1- MAIN BRACE (B) - Driver's side
- 1- FACE PLATE (C)

KIT NO. 1402-1

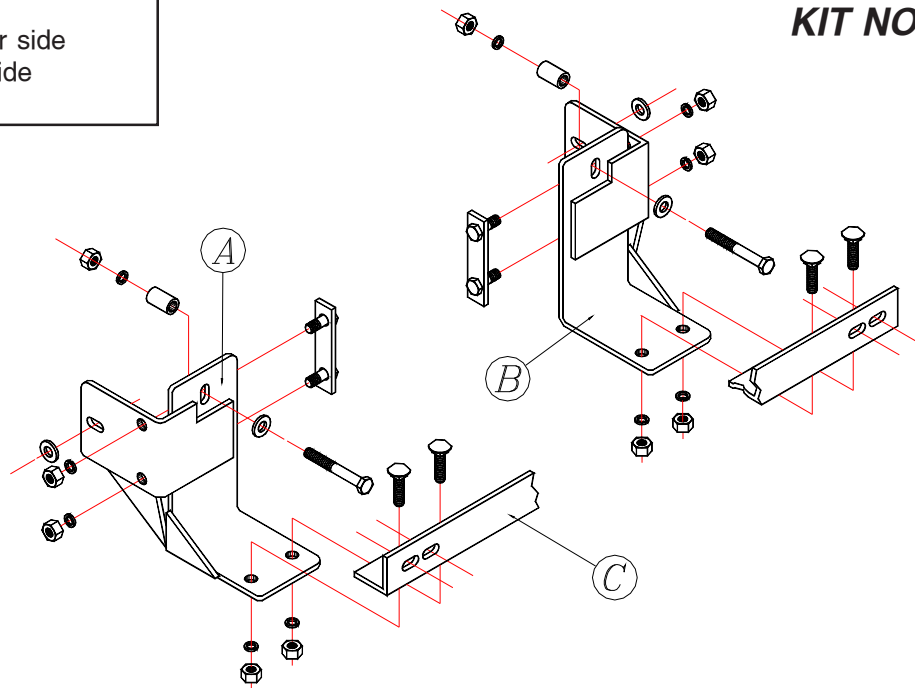

7/8/02

IMPORTANT: All baseplates **must** be assembled with all the bolts left loose for final adjustment and positioning (before tightening) unless otherwise instructed. All bolts **must** be torqued for proper strength. If more than one bolt is used per fastening point, the diagram may only show one. Use flat washers over all slotted holes and lock washers on all fasteners.

WARNING

Failure to heed these warnings or follow the installation instructions may result in a voided warranty, loss of towed vehicle, personal injury or death.

- Do not weld or modify this baseplate or its components. Welding or modification will void the warranty.
- Do not use this document as a basis to design/fabricate a baseplate, as it may not show all parts or structural components.
- We strongly recommend professional installation.
- If the towed vehicle has been in an accident, it must be properly repaired before attaching the baseplate. Do not install the baseplate if any structural frame damage is found.
- The installer must use all bolts and parts supplied. If running changes were made by the vehicle manufacturer after this kit was designed, some bolts or other fasteners may no longer be the correct size. It is the installer's responsibility to verify this kit is securely fastened to the vehicle.
- Use Loctite® Red on all bolts used to secure this baseplate. Torque all bolts to the specifications found at the end of these instructions. Do not over-torque the bolts or failure may occur.
- The installer must inspect the baseplate to ensure adequate clearance, particularly around hoses, air conditioner lines, radiators, etc. or non-warranty failure may result.
- Roadmaster manufactures many styles of baseplates. If your baseplate has removable arms, they must be removed before driving the vehicle, unless the arms can be pinned or padlocked in place. If not secured, the arms could vibrate out.
- Some motorhome chassis have such a tight turning radius that you can damage your motorhome, towed vehicle, tow bar or baseplate while turning sharply. Before getting on the road, test your turning radius in

an empty parking lot. Turning too sharply could result in non-warranty damage to your towing system, motorhome and/or towed vehicle.

- Do not back up with the towed vehicle attached or non-warranty damage will occur to your towing system or vehicles.
- The safety cables must connect the towing vehicle to the towed vehicle frame to frame, with the cables crossed, with enough slack for sharp turns. See cable instructions for proper routing. Failure to do so will result in non-warranty damage and/or the loss of the towed vehicle.
- This kit is designed for use with ROADMASTER tow bars and ROADMASTER adapters only. Using this kit with other brands, without an approved ROADMASTER adapter, may result in non-warranty damage or injury.
- Receiver extensions and out-of-level towing situations of 3 inches or more. This can cause the system to swing much higher and lower, causing excessive strain on the tow bar, baseplate and frame. That can cause the towing system to fail, causing property damage, personal injury or even death. If you must use a receiver extension or drop hitch to tow, it will reduce your receiver's weight capacity by 1/3 to avoid damaging your system. Never use more than one extension and/or drop hitch, as this will void your warranty.
- Every 3,000 miles, the owner must inspect all mounting points for cracks or fatigue, and check the fasteners for proper torque, according to the bolt torque requirements chart on the last page of these instructions.
- The owner must follow the vehicle manufacturer's instructions to prepare the vehicle for towing. Failure to do so may cause severe damage to the vehicle.
- This baseplate is only warranted for the original installation. Installing a used baseplate on another vehicle is not recommended and will void the warranty.

BASEPLATE KIT INSTALLATION INSTRUCTIONS

ROADMASTER, Inc. 6110 NE 127th Ave. Vancouver, WA 98682 1-800-669-9690 fax 360-735-9300 www.roadmasterinc.com

KIT NO. 1402-1

- Important: please use all supplied bolts and parts and read all instructions carefully before beginning this installation. The majority of questions you may have can be answered within the text, and proper installation will ensure safe and secure travel.** Now, begin the installation. This bracket is designed to fit to the front of the frame, just behind the front bumper. To gain access, remove the two small screws on the bottom side of the bumper on the passenger side that attach a vacuum canister to the bumper. Next, remove the two torx bolts in the bottom of the bumper and the two torx bolts behind the bumper (the two behind the bumper can be accessed by pushing up on the rubber splash panel; the two bolts are horizontal on the upper part of the back side of the bumper). Pull the bumper off of its brackets and set aside.
- Remove three bolts holding each bumper bracket on and set aside. Remove the spring clips (two on each side) that held the bumper brackets on and discard. Locate a hole just to the inside of the bumper bracket flanges and drill out to 17/32". These holes will be used later in the installation. Find the 1/4" x 1" x 4 1/2" backing plates with 1/2" bolts welded to them and insert into holes left by spring clips. *Note:* backing plates must go from inside out. Install main braces onto 1/2" backing plate bolts, then install bumper bracket over main brace and onto the same 1/2" bolts. Loosely fasten to bolts with 1/2" lock washers and nuts.
- Locate one of the 10mm bolts originally removed from the bumper brackets, insert the 7/16" flat washer onto the bolt through the slotted hole in the side of the main brace.
- Locate the 1/2" x 3" bolts and 1/2" flat washers and bolt through the slotted hole in the face of the main brace, through the 1/2" x 1 1/4" pipe spacers and through the hole drilled out previously. Install a 1/2" lock washer and nut onto the bolt. *Note:* access to the back side of the frame may be fairly difficult, but is easiest if approached from the underside through the rubber splash panels.
- Install the face plate onto the main braces with four 1/2" x 1 1/2" carriage bolts and nuts. Make sure braces are square with each other, then temporarily tighten the four carriage bolts. Torque all the other bolts to the torque specifications below, then remove the face plate.
- Reinstall the bumper onto its brackets and reattach the vacuum canister onto the bumper. The bumper may need to be trimmed slightly to fit around the main braces. Reinstall the face plate onto the main braces and bolt through using the 1/2" x 1 1/2" carriage bolts, 1/2" lock washers and nuts and torque these bolts to the torque specifications below.
- Mount the tow bar to the main receiver brace according to the manufacturer's instructions.

HARDWARE LIST:

- | | |
|--------------------------------|---|
| 4-1/2" X 1 1/2" CARRIAGE BOLTS | 2-1/2" X 1 1/4" PIPE SPACERS |
| 2-1/2" X 3" BOLTS | 2-1/4" X 1" X 4 1/2" BACKING PLATES WITH 1/2" BOLTS |
| 2-1/2" FLAT WASHERS | 10-1/2" LOCKWASHERS |
| 2-7/16" FLAT WASHERS | 10-1/2" NUTS |

7/8/02

BOLT TORQUE REQUIREMENTS

Note: The torque values represented below are intended as general guidelines. Torque requirements for specific applications may vary. Roadmaster does not warrant this information to be accurate for all applications and disclaims all liability for any claims or damages which may result from its use.

STANDARD BOLTS			METRIC BOLTS			METRIC BOLTS		
Thread Size	Grade	Torque	Thread Size	Grade	Plated/Unplated	Thread Size	Grade	Plated/Unplated
5/16	5	13 ft./lb.	8mm-1.0	8.8	20 ft./lb. 18 ft./lb.	12mm-1.25	8.8	70 ft./lb. 65 ft./lb.
3/8	5	23 ft./lb.	8mm-1.25	8.8	19 ft./lb. 18 ft./lb.	12mm-1.5	8.8	66 ft./lb. 61 ft./lb.
7/16	5	37 ft./lb.	10mm-1.25	8.8	38 ft./lb. 36 ft./lb.	12mm-1.75	8.8	65 ft./lb. 60 ft./lb.
1/2	5	56 ft./lb.	10mm-1.5	8.8	37 ft./lb. 35 ft./lb.	14mm-2.0	8.8	104 ft./lb. 97 ft./lb.
5/8	5	150 ft./lb.						