

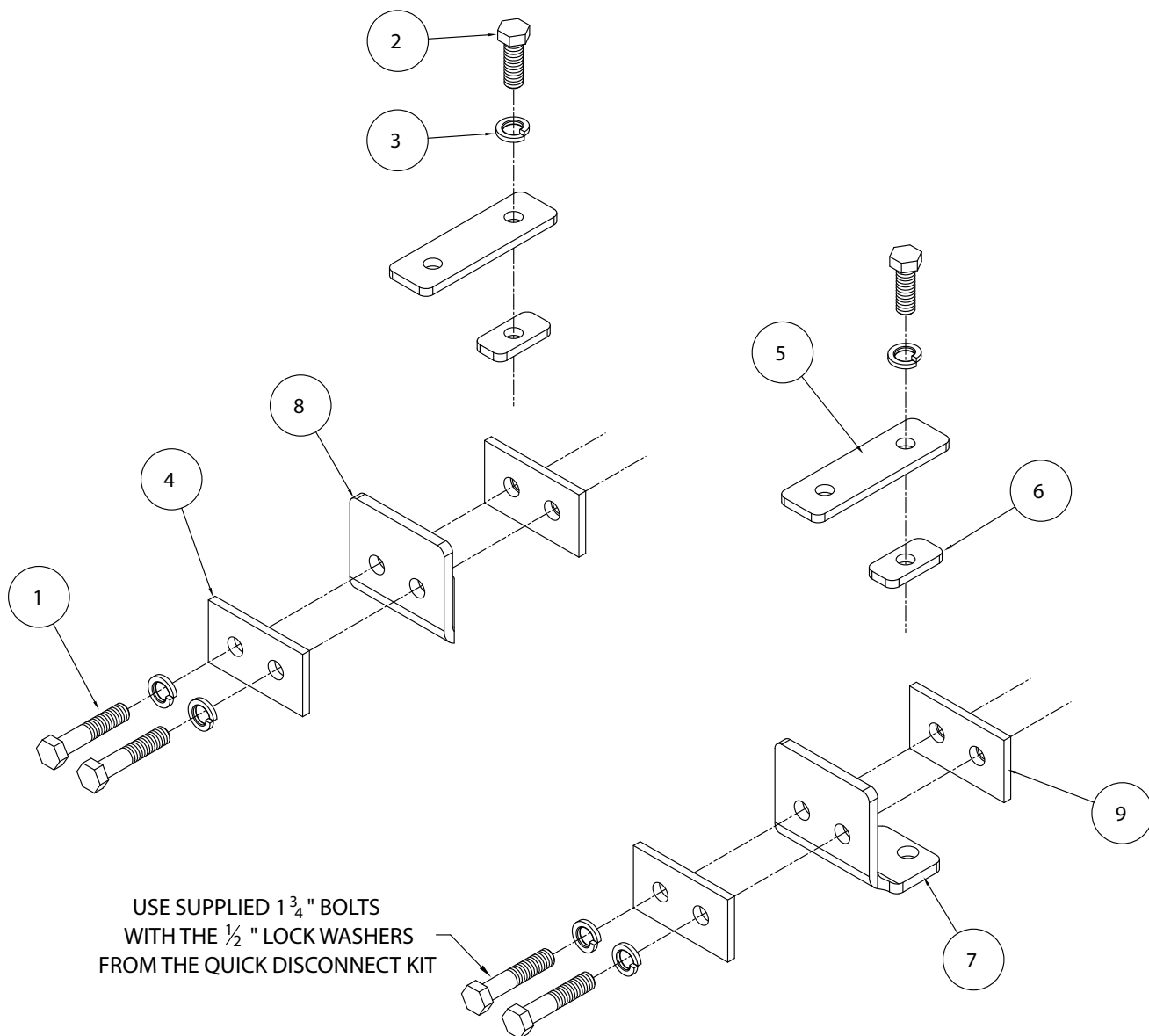

BASEPLATE KIT INSTALLATION INSTRUCTIONS

ROADMASTER, Inc. 6110 NE 127th Ave. Vancouver, WA 98682 360-896-0407 fax 360-735-9300 www.roadmasterinc.com



USE SUPPLIED 1 3/4" BOLTS
WITH THE 1/2" LOCK WASHERS
FROM THE QUICK DISCONNECT KIT

ITEM	QTY	NAME	PART #
1	4	1/2" x 2 1/2" BOLT	350099-00
2	2	1/2" x 1 1/2" BOLT	350095-00
3	6	1/2" LOCK WASHER	350309-00
4	2	1 3/4" x 3 1/4" BACKING PLATE	A000839
5	2	UPPER BUMPER BRACE	A000841
6	2	1" x 2" BACKING PLATE	A000842
7	1	DRIVER SIDE FRONT BRACE	B000333
8	1	PASSENGER SIDE FRONT BRACE	B000334
9	2	1 3/4" x 3 1/4" THREADED BACKING PLATE	C000467



BASEPLATE KIT INSTALLATION INSTRUCTIONS

ROADMASTER, Inc. 6110 NE 127th Ave. Vancouver, WA 98682 360-896-0407 fax 360-735-9300 www.roadmasterinc.com

1. Important: please use all supplied bolts and parts and read all instructions carefully before beginning this installation. The majority of questions you may have can be answered within the text, and proper installation will ensure safe and secure travel. Now, begin the installation. This bracket kit is designed as an adaptor to allow mounting a tow bar to the front bumper of a Jeep.



The kit consists of two front braces, two upper braces, two backing plates, two threaded backing plates and hardware kit (Fig. A).

2. Start by laying the kit out as illustrated and making sure all the components are there.
3. Remove the plastic frame cover if present (four 10mm head bolts) (Fig.B).
4. Remove the front channel bumper (four #55 Torx bolts).
5. Put the bumper on a convenient bench or table to work on. Mark or keep track of the bottom of the bumper.

IMPORTANT: All baseplates **must** be assembled with all the bolts left loose for final adjustment and positioning (before tightening) unless otherwise instructed. All bolts **must** be torqued for proper strength. If more than one bolt is used per fastening point, the diagram may only show one. Use flat washers over all slotted holes and lock washers on all fasteners.

WARNING

Failure to heed these warnings or follow the installation instructions may result in a voided warranty, loss of towed vehicle, personal injury or death.

- Do not weld or modify this baseplate or its components. Welding or modification will void the warranty.
- Do not use this document as a basis to design/fabricate a baseplate, as it may not show all parts or structural components.
- We strongly recommend professional installation.
- If the towed vehicle has been in an accident, it must be properly repaired before attaching the baseplate. Do not install the baseplate if any structural frame damage is found.
- The installer must use all bolts and parts supplied. If running changes were made by the vehicle manufacturer after this kit was designed, some bolts or other fasteners may no longer be the correct size. It is the installer's responsibility to verify this kit is securely fastened to the vehicle.
- Use Loctite® Red on all bolts used to secure this baseplate. Torque all bolts to the specifications found at the end of these instructions. Do not over-torque the bolts or failure may occur.
- The installer must inspect the baseplate to ensure adequate clearance, particularly around hoses, air conditioner lines, radiators, etc. or non-warranty failure may result.
- Roadmaster manufactures many styles of baseplates. If your baseplate has removable arms, they must be removed before driving the vehicle, unless the arms can be pinned or padlocked in place. If not secured, the arms could vibrate out.
- Some motorhome chassis have such a tight turning radius that you can damage your motorhome, towed vehicle, tow bar or baseplate while turning sharply. Before getting on the road, test your turning radius in an empty parking lot. Turning too sharply could result in non-warranty damage to your towing system, motorhome and/or towed vehicle.
- Do not back up with the towed vehicle attached or non-warranty damage will occur to your towing system or vehicles.
- The safety cables must connect the towing vehicle to the towed vehicle frame to frame, with the cables crossed, with enough slack for sharp turns. See cable instructions for proper routing. Failure to do so will result in non-warranty damage and/or the loss of the towed vehicle.
- This kit is designed for use with ROADMASTER tow bars and ROADMASTER adapters only. Using this kit with other brands, without an approved ROADMASTER adapter, may result in non-warranty damage or injury.
- Receiver extensions and out-of-level towing situations of 3 inches or more. This can cause the system to swing much higher and lower, causing excessive strain on the tow bar, baseplate and frame. That can cause the towing system to fail, causing property damage, personal injury or even death. If you must use a receiver extension or drop hitch to tow, it will reduce your receiver's weight capacity by 1/3 to avoid damaging your system. Never use more than one extension and/or drop hitch, as this will void your warranty.
- Every 3,000 miles, the owner must inspect all mounting points for cracks or fatigue, and check the fasteners for proper torque, according to the bolt torque requirements chart on the last page of these instructions.
- The owner must follow the vehicle manufacturer's instructions to prepare the vehicle for towing. Failure to do so may cause severe damage to the vehicle.
- This baseplate is only warranted for the original installation. Installing a used baseplate on another vehicle is not recommended and will void the warranty.



BASEPLATE KIT INSTALLATION INSTRUCTIONS

ROADMASTER, Inc. 6110 NE 127th Ave. Vancouver, WA 98682 360-896-0407 fax 360-735-9300 www.roadmasterinc.com



Fig.C

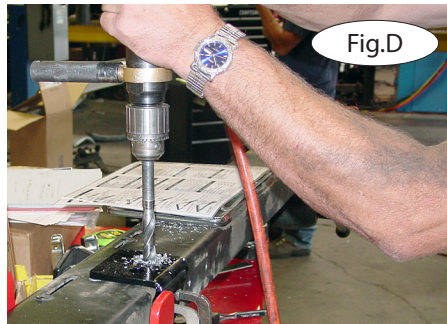

Fig.D

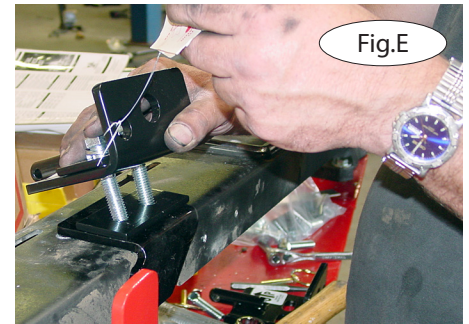

Fig.E

6. Bolt or clamp the front braces to the front and bottom of the bumper over the lower bumper mounting holes. Measure from the hole centers in the front of the braces and adjust if necessary to measure 27" and 30" center to center. Try to center the bottom holes in the braces over the lower mounting holes (Fig.C).

7. Once aligned and clamped, use these braces as drill templates to drill through the front of the bumper with a 17/32" drill bit (Fig.D).

8. Install the Quick Disconnect base plates or the bar adapter on the front of the bumper using either the bolts supplied with the Quick Disconnects or if needed the supplied 1/2" x 2 1/2" bolts. Be sure to use the supplied backing plates between the bumper and the quick-disconnects (Fig.E). If an older bar or base plate adaptor is used, the backing plates may be left out.

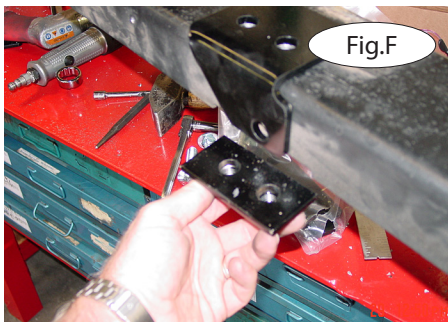

Fig.F



Fig.G

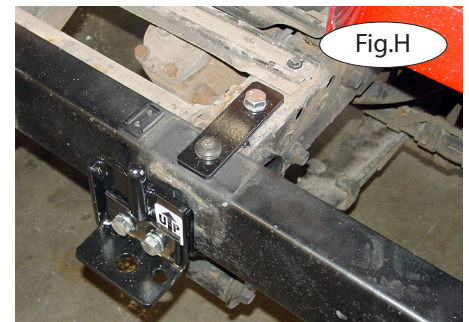

Fig.H

9. Tighten the front assembly bolts on the bumper using the threaded backing plates (Fig.F), then reinstall the bumper on the vehicle using the stock #55 Torx bolts in the bottom mounting holes (Fig.G).

10. Bolt through the upper bumper strap braces on each side with the remaining #55 Torx screws (Fig.H), then bolt through the rear of the strap braces with 1/2" x 1 1/2" bolts, lock washers, and 1/4" spacers under the strap brace (Fig.H).

11. If a quick-disconnect style bar or base is to be mounted, mount the bar or base to align the front quick-disconnect plates, then torque all mounting bolts to the specifications found at the end of this document.

12. Hold the plastic frame cover over the top of the frame and braces and mark where the rear bolt heads protrude. Cut small holes in the cover to allow clearance for the bolt heads then reinstall, reversing step 3 (Fig.I, J).

13. Install the tow bar according to the manufacturer's instructions.



BASEPLATE KIT INSTALLATION INSTRUCTIONS

ROADMASTER, Inc. 6110 NE 127th Ave. Vancouver, WA 98682 360-896-0407 fax 360-735-9300 www.roadmasterinc.com

12. Hold the plastic frame cover over the top of the frame and braces and mark where the rear bolt heads protrude. Cut small holes in the cover to allow clearance for the bolt heads then reinstall, reversing step 3 (Fig.I, J).

13. Install the tow bar according to the manufacturer's instructions.

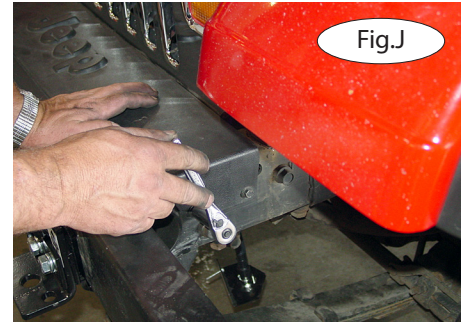
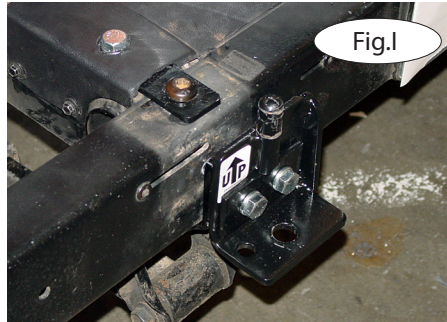

BOLT TORQUE REQUIREMENTS

Note: The torque values represented below are intended as general guidelines. Torque requirements for specific applications may vary. Roadmaster does not warrant this information to be accurate for all applications and disclaims all liability for any claims or damages which may result from its use.

STANDARD BOLTS			METRIC BOLTS			METRIC BOLTS		
Thread Size	Grade	Torque	Thread Size	Grade	Plated / Unplated	Thread Size	Grade	Plated / Unplated
5/16	5	13 ft./lb.	8mm-1.0	8.8	20 ft./lb. 18 ft./lb.	12mm-1.25	8.8	70 ft./lb. 65 ft./lb.
3/8	5	23 ft./lb.	8mm-1.25	8.8	19 ft./lb. 18 ft./lb.	12mm-1.5	8.8	66 ft./lb. 61 ft./lb.
7/16	5	37 ft./lb.	10mm-1.25	8.8	38 ft./lb. 36 ft./lb.	12mm-1.75	8.8	65 ft./lb. 60 ft./lb.
1/2	5	56 ft./lb.	10mm-1.5	8.8	37 ft./lb. 35 ft./lb.	14mm-2.0	8.8	104 ft./lb. 97 ft./lb.
5/8	5	150 ft./lb.						

All illustrations and specifications contained herein are based on the latest information available at the time of publication approval. ROADMASTER, INC. reserves the right to make changes at any time without notice in material, specification and models or to discontinue models.