

BASEPLATE KIT INSTALLATION INSTRUCTIONS

ROADMASTER, Inc. 6110 NE 127th Ave. Vancouver, WA 98682 1-800-669-9690 fax 360-735-9300 www.roadmasterinc.com

PARTS LIST:

- 1- MAIN BRACE (A) - Passenger side
- 1- MAIN BRACE (B) - Driver's side
- 1- FRONT BRACE (C) - Passenger side
- 1- FRONT BRACE (D) - Driver's side
- 1- EXTENSION PLATE (E) - Passenger side
- 1- EXTENSION PLATE (F) - Driver's side

KIT NO. 1411-2

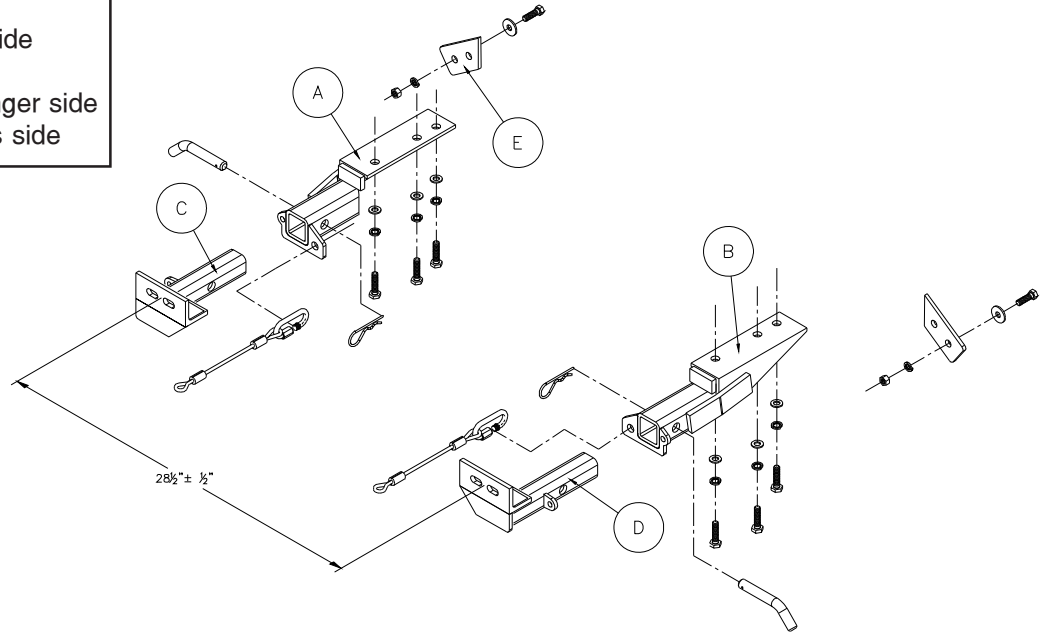

IMPORTANT: All baseplates **must** be assembled with all the bolts left loose for final adjustment and positioning (before tightening) unless otherwise instructed. All bolts **must** be torqued for proper strength. If more than one bolt is used per fastening point, the diagram may only show one. Use flat washers over all slotted holes and lock washers on all fasteners.

WARNING

Failure to heed these warnings or follow the installation instructions may result in a voided warranty, loss of towed vehicle, personal injury or death.

- Do not weld or modify this baseplate or its components. Welding or modification will void the warranty.
- Do not use this document as a basis to design/fabricate a baseplate, as it may not show all parts or structural components.
- We strongly recommend professional installation.
- If the towed vehicle has been in an accident, it must be properly repaired before attaching the baseplate. Do not install the baseplate if any structural frame damage is found.
- The installer must use all bolts and parts supplied. If running changes were made by the vehicle manufacturer after this kit was designed, some bolts or other fasteners may no longer be the correct size. It is the installer's responsibility to verify this kit is securely fastened to the vehicle.
- Use Loctite® Red on all bolts used to secure this baseplate. Torque all bolts to the specifications found at the end of these instructions. Do not over-torque the bolts or failure may occur.
- The installer must inspect the baseplate to ensure adequate clearance, particularly around hoses, air conditioner lines, radiators, etc. or non-warranty failure may result.
- Roadmaster manufactures many styles of baseplates. If your baseplate has removable arms, they must be removed before driving the vehicle, unless the arms can be pinned or padlocked in place. If not secured, the arms could vibrate out.
- Some motorhome chassis have such a tight turning radius that you can damage your motorhome, towed vehicle, tow bar or baseplate while turning sharply. Before getting on the road, test your turning radius in

an empty parking lot. Turning too sharply could result in non-warranty damage to your towing system, motorhome and/or towed vehicle.

- Do not back up with the towed vehicle attached or non-warranty damage will occur to your towing system or vehicles.
- The safety cables must connect the towing vehicle to the towed vehicle frame to frame, with the cables crossed, with enough slack for sharp turns. See cable instructions for proper routing. Failure to do so will result in non-warranty damage and/or the loss of the towed vehicle.
- This kit is designed for use with ROADMASTER tow bars and ROADMASTER adapters only. Using this kit with other brands, without an approved ROADMASTER adapter, may result in non-warranty damage or injury.
- Receiver extensions and out-of-level towing situations of 3 inches or more. This can cause the system to swing much higher and lower, causing excessive strain on the tow bar, baseplate and frame. That can cause the towing system to fail, causing property damage, personal injury or even death. If you must use a receiver extension or drop hitch to tow, it will reduce your receiver's weight capacity by 1/3 to avoid damaging your system. Never use more than one extension and/or drop hitch, as this will void your warranty.
- Every 3,000 miles, the owner must inspect all mounting points for cracks or fatigue, and check the fasteners for proper torque, according to the bolt torque requirements chart on the last page of these instructions.
- The owner must follow the vehicle manufacturer's instructions to prepare the vehicle for towing. Failure to do so may cause severe damage to the vehicle.
- This baseplate is only warranted for the original installation. Installing a used baseplate on another vehicle is not recommended and will void the warranty.

BASEPLATE KIT INSTALLATION INSTRUCTIONS

ROADMASTER, Inc. 6110 NE 127th Ave. Vancouver, WA 98682 1-800-669-9690 fax 360-735-9300 www.roadmasterinc.com

KIT NO. 1411-2

1. This bracket assembly fits between the frame and the front radiator support cross member, utilizing the frame weldnuts for attachment. *Note:* on vehicles with the Up-Country suspension package, the tow hooks and brackets attaching the tow hooks will have to be removed in order to mount the tow bar brackets. Also, re-secure backing plates inside frame by reinstalling at least 2 of the bolts previously removed with washers between the bolt head and the frame (to keep the backing plates from rattling while driving vehicle).
2. Locate and remove the two bolts securing the radiator cross member to the frame. Also remove the plastic splash guard retainer located 1½” behind the rear cross member bolt. This will expose a frame weld nut. *Note:* these bolts may have had Loctite applied and may require a breaker bar to loosen.
3. Unbolt the tubular cowl support from the radiator cross member and loosen the bolts that attach it to the cowl. These are located beneath the splash panel.
4. Insert a receiver brace through the lower bumper valance and insert it between the radiator cross member and the frame. Bolt with three 10mm x 1.5 x 40mm bolts and washers provided. Line up all three holes in the main frame and tighten the two forward holes.
5. Now, bolt a ¼” x 2” extension tab to the back of the radiator cross member (see illustration) using the existing bolt in the cross member. Bolt the loose end of the core support bracket to the tab using a 7/16” x 1½” bolt, washers and nut provided.
6. Now, follow the same procedure on the other side.
7. Reinstall the splash guard and torque the main frame bolts to the torque specifications below. Using the drawing on the first page as a reference, measure between the two front braces, ensuring that the distance is still 28” +/- ½”.
8. Insert the front braces into the receivers as illustrated and secure using the provided 5/8” draw pins and 1/8” spring pins. Recheck the measurements, to make certain this distance is still 28” +/- ½”.
9. Mount the tow bar according to the manufacturer’s instructions. *Note:* when towing, connect the tow vehicle’s safety cables to the bracket receivers using the provided quick links.

HARDWARE LIST:

- 6-10MM X 1.5 X 40MM BOLTS
- 6-10MM FLAT WASHERS
- 6-10MM LOCK WASHERS
- 2-7/16” NUTS
- 2-7/16” X 1½” BOLTS
- 2-7/16” LOCK WASHERS
- 2-1/8” SPRING PINS
- 2-5/8” DRAW PINS
- 2-QUICK LINKS
- 2- 13" SAFETY CABLES, 8,000 lb. rated
- 2- 1/4"x 2"x 4-3/8" EXTENSION PLATES
- 2- 7/16" FLAT WASHERS

02-11-11

BOLT TORQUE REQUIREMENTS

Note: The torque values represented below are intended as general guidelines. Torque requirements for specific applications may vary. Roadmaster does not warrant this information to be accurate for all applications and disclaims all liability for any claims or damages which may result from its use.

STANDARD BOLTS			METRIC BOLTS			METRIC BOLTS		
Thread Size	Grade	Torque	Thread Size	Grade	Plated/Unplated	Thread Size	Grade	Plated/Unplated
5/16	5	13 ft./lb.	8mm-1.0	8.8	20 ft./lb. 18 ft./lb.	12mm-1.25	8.8	70 ft./lb. 65 ft./lb.
3/8	5	23 ft./lb.	8mm-1.25	8.8	19 ft./lb. 18 ft./lb.	12mm-1.5	8.8	66 ft./lb. 61 ft./lb.
7/16	5	37 ft./lb.	10mm-1.25	8.8	38 ft./lb. 36 ft./lb.	12mm-1.75	8.8	65 ft./lb. 60 ft./lb.
1/2	5	56 ft./lb.	10mm-1.5	8.8	37 ft./lb. 35 ft./lb.	14mm-2.0	8.8	104 ft./lb. 97 ft./lb.
5/8	5	150 ft./lb.						

All illustrations and specifications contained herein are based on the latest information available at the time of publication approval. ROADMASTER, INC. reserves the right to make changes at any time without notice in material, specification and models or to discontinue models.