



MOUNTING BRACKET KIT INSTALLATION INSTRUCTIONS

KIT# 1415-1

12/06/07

KS

ROADMASTER, Inc. 6110 NE 127th Ave. Vancouver, WA 98682 1-800-669-9690 fax 360-735-9300 www.roadmasterinc.com

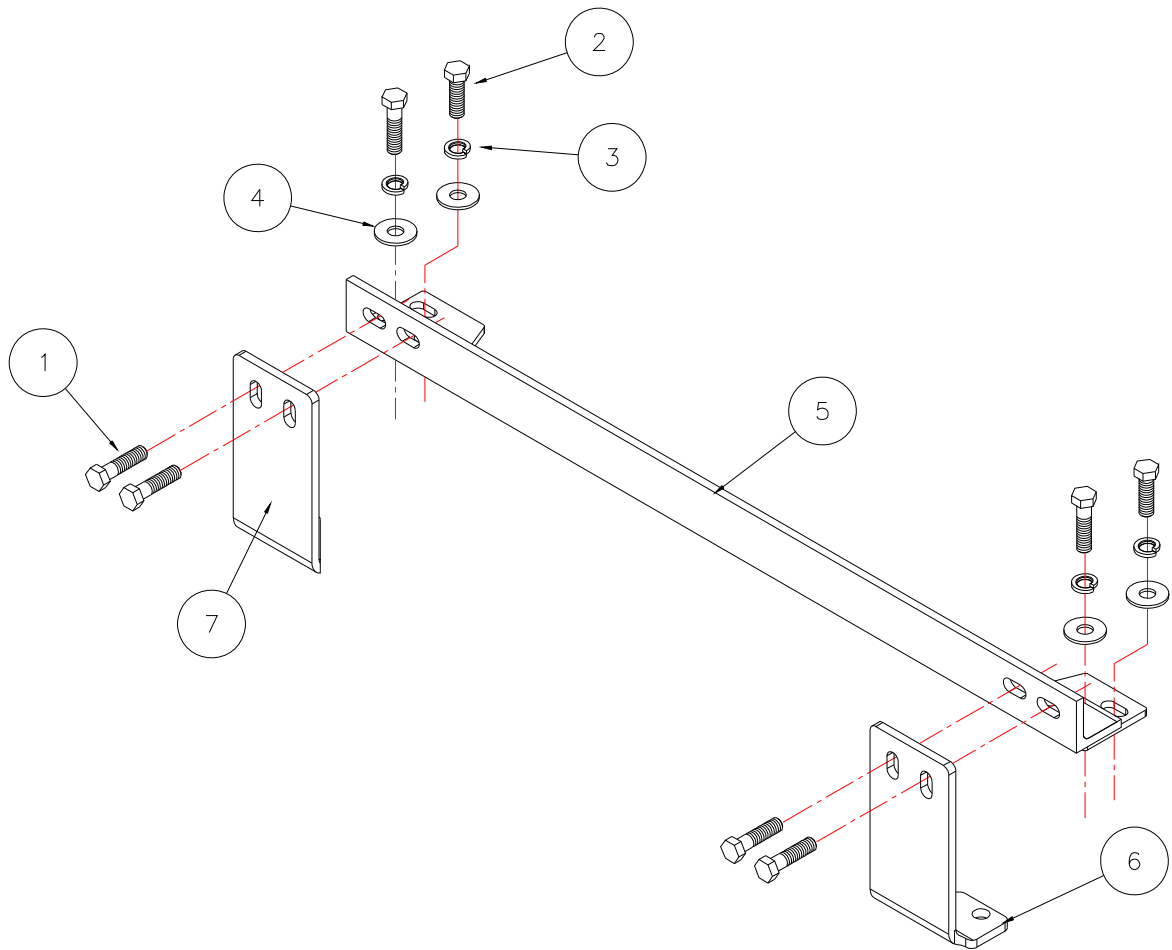

Item	Qty	Length	Width	Name	Material
1	6	2"	1/2"	1/2" x 2" BOLT	350097-00
2	2	1 3/4"	1/2"	1/2" x 1 3/4" BOLT	350096-00
3	8		1/2"	1/2" LOCK WASHER	350309-00
4	4		1/2"	1/2" FLAT WASHERS	350308-00
5	1			MAIN BRACE	C-000465
6	1	4"		DRIVER SIDE LOWER BRACE	B-000331
7	1	4"		PASSENGER SIDE LOWER BRACE	B-000332



MOUNTING BRACKET KIT INSTALLATION INSTRUCTIONS

KIT# 1415-1

12/06/07

KS

ROADMASTER, Inc. 6110 NE 127th Ave. Vancouver, WA 98682 1-800-669-9690 fax 360-735-9300 www.roadmasterinc.com

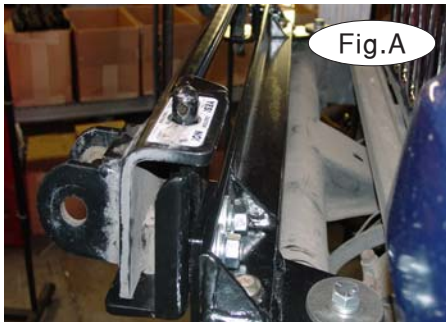

Fig.A

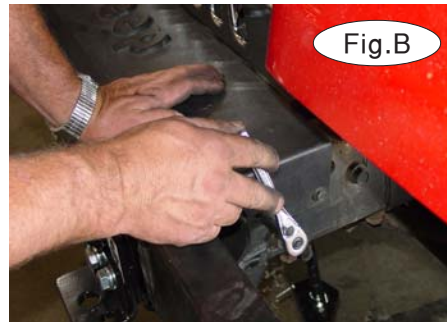

Fig.B



Fig.C

1. This bracket kit is designed as a convenient adapter to allow mounting any of our towing products to the front bumper of the Jeep. The kit consists of two front braces, one main brace and hardware kit (Fig.A). *Note:* photos may vary from actual installation.

2. Before starting the installation, lay out the kit components in order as they will be used. This will give you a visual idea of how the components work, and will also confirm that everything is present and accounted for.

3. Remove the plastic frame cover if one is present. There will be four 10mm (head) bolts (Fig.B).

4. Working on one side at a time, remove the two lower channel bumper #55 Torx mounting bolts (Fig.C).

5. Take a front brace and bolt through the bottom-mounting hole with the original Torx bolt. Leave loose and do the same for the remaining lower mounting bolt (Fig.C).

IMPORTANT: All brackets **must** be assembled with all the bolts left loose for final adjustment and positioning (before tightening) unless otherwise instructed. All bolts **must** be torqued for proper strength. If more than one bolt is used per fastening point, the diagram may only show one.

- Use flat washers over all slotted holes
- Use lock washers on all fasteners

ROADMASTER Limited Warranty, including One-Year Conditional Warranty Text and Product Registration Card, in Carton.

WARNING

- Do not use this document for custom fabrication, as it may not show all parts or structural components. Custom fabrication or an attempt to copy this bracket design could result in loss of the towed vehicle.
- The owner must inspect all mounts and brackets before each use for cracks or other signs of fatigue. Also, inspect the fasteners for proper torque, according to the bolt torque requirements chart on the last page. Failure to do so could result in loss of the towed vehicle.
- The owner must check the manufacturer's instructions for the proper procedure(s) to prepare the vehicle for towing. Some vehicles must be equipped with a transmission lube pump, an axle disconnect, driveline disconnect or free-wheeling hubs before they can be towed. Failure to properly equip the vehicle will cause severe damage to the transmission.
- The installer must read the instructions and use all bolts and parts supplied. Failure to securely fasten the bracket could result in loss of the towed vehicle.
- If running changes were made by the vehicle manufacturer after this bracket was designed, some bolts or other fasteners in the included hardware pack may no longer be the correct size. It is the installer's responsibility to verify that the bracket is securely fastened to the vehicle, and fitted with the correct hardware, to account for these changes. Failure to securely fasten the bracket could result in loss of the towed vehicle.
- If the towed vehicle has been in an accident, it must be properly repaired before attaching the bracket. Do not install the bracket if any structural frame damage is found. Failure to repair the damage may result in the loss of the towed vehicle.
- Some motorhome chassis have such a tight turning radius that you can damage your motorhome, towed vehicle, tow bar or bracket while turning sharply. Before getting on the road, test your turning radius in an empty parking lot. Turning too sharply could result in non-warranty damage to towing system, motorhome and/or towed vehicle.
- Do not back up with the towed vehicle attached or non-warranty damage will occur to your towing system, motorhome and/or towed vehicle.
- The safety cables must connect the towing vehicle to the towed vehicle frame to frame, with the cables crossed, with enough slack for sharp turns. Refer to the cable instructions for proper routing. Failure to leave enough slack in the safety cables, or failure to connect the safety cables frame to frame, will result in the loss of the towed vehicle.
- This bracket is designed for use with ROADMASTER tow bars and ROADMASTER adaptors only. Using this bracket with other brands, without an approved ROADMASTER adaptor, may result in non-warranty damage or injury.
- Upon final installation, the installer must inspect the bracket to ensure adequate clearance, particularly around hoses, air conditioner lines, radiators, etc., or non-warranty damage to the towed vehicle will result.
- This bracket is only warranted for the original installation. Installing a used bracket on another vehicle is not recommended and will void the warranty.

WARNING

Failure to follow these instructions can result in property damage, personal injury or even death.



MOUNTING BRACKET KIT INSTALLATION INSTRUCTIONS

KIT# 1415-1

12/06/07

KS

ROADMASTER, Inc. 6110 NE 127th Ave. Vancouver, WA 98682 1-800-669-9690 fax 360-735-9300 www.roadmasterinc.com

6. Remove the top bumper mounting bolts on both sides (two #55 Torx bolts). *Note:* some vehicles may be equipped with tow hooks and four top bolts on each side. If they are present, remove the hooks and bolts.

7. Set the main brace on top of the bumper and bolt the front and rear holes with 1/2" x 1 3/4" bolts, lock washers and flat washers (Fig.D).

8. Install the quick-disconnect base plates or the bar adaptor on the front of the braces using the supplied 1/2" x 2" bolts. Use the bar or base to align the front quick-disconnect plates then torque all mounting bolts to the specifications below (Fig.E).

9. If the plastic frame cover is to be refitted, hold over the top of the frame and braces and mark to fit around the main brace. Then, cut and reinstall with the bolts removed in step 3.

10. Install the tow bar according to the manufacturer's instructions and torque all mounting bolts to the specifications below.

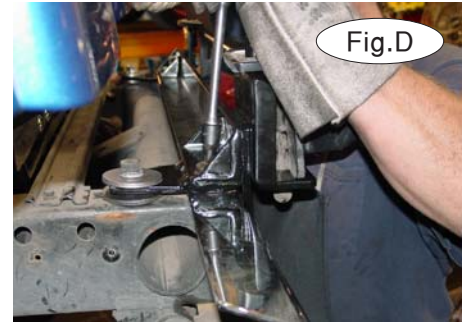

Fig.D

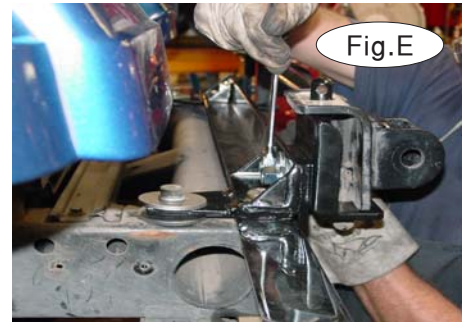

Fig.E

BOLT TORQUE REQUIREMENTS

Note: The torque values represented below are intended as general guidelines. Torque requirements for specific applications may vary. Roadmaster does not warrant this information to be accurate for all applications and disclaims all liability for any claims or damages which may result from its use.

STANDARD BOLTS

Thread Size	Grade	Torque
5/16	5	13 ft./lb.
3/8	5	23 ft./lb.
7/16	5	37 ft./lb.
1/2	5	56 ft./lb.
5/8	5	150 ft./lb.

METRIC BOLTS

Thread Size	Grade	Plated / Unplated
8mm-1.0	8.8	20 ft./lb. 18 ft./lb.
8mm-1.25	8.8	19 ft./lb. 18 ft./lb.
10mm-1.25	8.8	38 ft./lb. 36 ft./lb.
10mm-1.5	8.8	37 ft./lb. 35 ft./lb.

METRIC BOLTS

Thread Size	Grade	Plated / Unplated
12mm-1.25	8.8	70 ft./lb. 65 ft./lb.
12mm-1.5	8.8	66 ft./lb. 61 ft./lb.
12mm-1.75	8.8	65 ft./lb. 60 ft./lb.
14mm-2.0	8.8	104 ft./lb. 97 ft./lb.

All illustrations and specifications contained herein are based on the latest information available at the time of publication approval. ROADMASTER, INC. reserves the right to make changes at any time without notice in material, specification and models or to discontinue models.