



# BASEPLATE KIT INSTALLATION INSTRUCTIONS

ROADMASTER, INC. 6110 NE 127TH AVE VANCOUVER, WA 98684 1-800-669-9690 FAX (503) 288-8900

**PARTS LIST:**

- 1- FRONT BRACE (A) - Passenger side
- 1- FRONT BRACE (B) - Driver's side
- 1- STABILIZER BAR (C)
- 1- SIDE BRACE (D) - Passenger side
- 1- SIDE BRACE (E) - Driver's side

**KIT NO. 154-1**

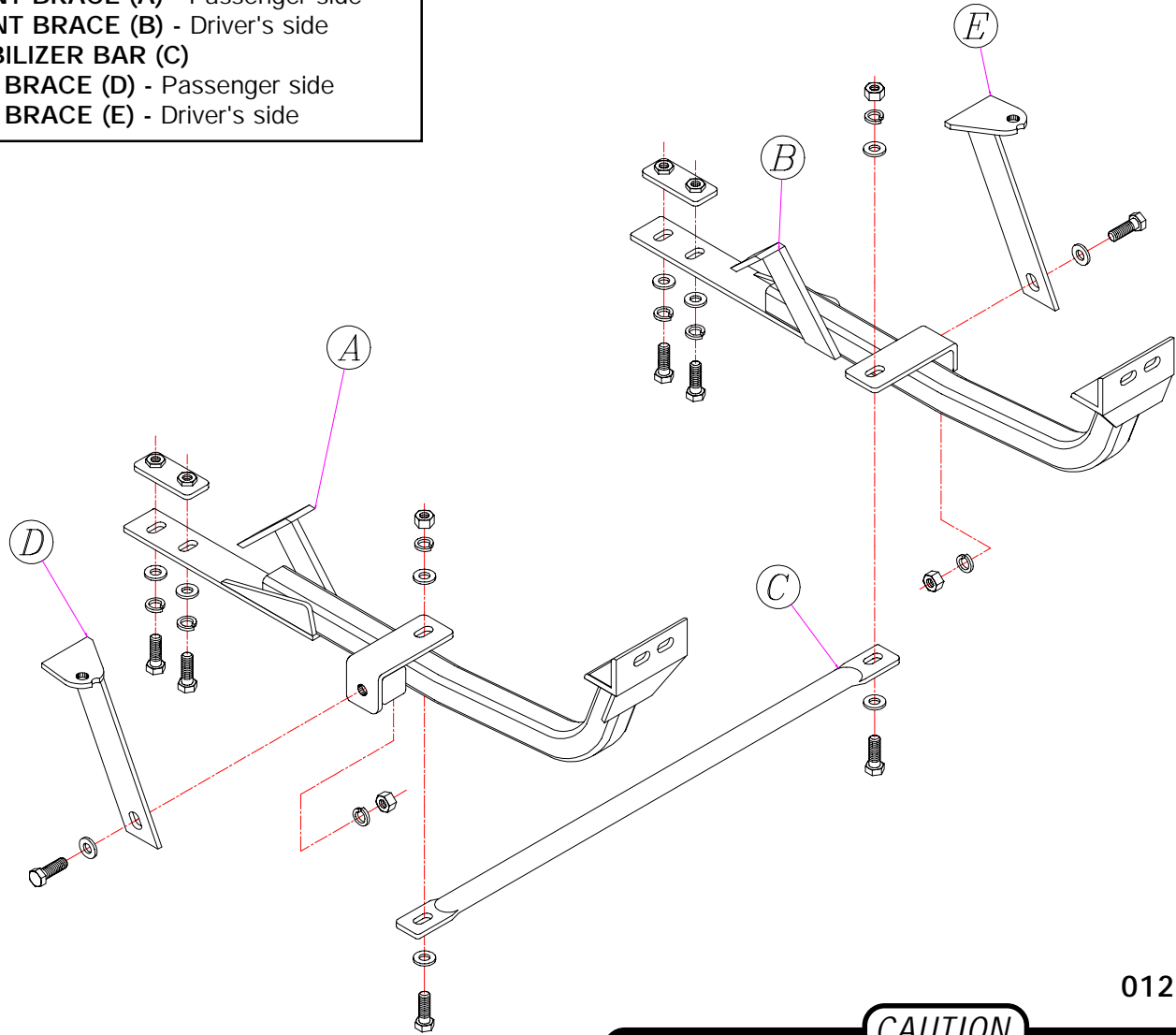

012799

**CAUTION**

**SAFETY CABLES MUST CONNECT THE TOWING VEHICLE TO THE TOWED VEHICLE FRAME TO FRAME. FOLLOW SAFETY INFORMATION IN WARRANTY PACKET**

## WARNING:

- **DO NOT** USE THIS DOCUMENT FOR CUSTOM FABRICATION AS THIS ILLUSTRATION MAY NOT SHOW ALL PARTS OR STRUCTURAL COMPONENTS.
- **ROADMASTER WILL NOT BE RESPONSIBLE** FOR ANY DAMAGE OR INJURY RESULTING FROM ANY MODIFICATION OR ALTERATION.
- **OWNER MUST INSPECT ALL MOUNTS AND BRACKETS BEFORE EACH USE** FOR CRACKS OR OTHER SIGNS OF FATIGUE. ALSO INSPECT FASTENERS FOR PROPER TORQUE.

**CAUTION: FAILURE TO FOLLOW THESE INSTRUCTIONS CAN RESULT IN DEATH, PERSONAL INJURY OR PROPERTY DAMAGE**

**IMPORTANT:** All brackets **must** be assembled with all the bolts left loose for final adjustment & positioning (before tightening) unless otherwise instructed. All bolts **must** be torqued for proper strength. If more than one bolt is used per fastening point, the diagram may only show one.

- Use flat washers over all slotted holes
- Use lock washers on all fasteners

# BASEPLATE KIT INSTALLATION INSTRUCTIONS

ROADMASTER, INC. 5602 N.E. SKYPORT WAY PORTLAND, OR 97218 1-800-669-9690 FAX (503) 288-8900

**KIT NO. 154-1**

**Congratulations!** You have just purchased another fine Roadmaster product. Thank you.

1. This bracket assembly utilizes the lower frame, sub frame, stabilizer bar mount as attachment points. Remove the lower plastic air dam located under the bumper. It will be necessary to trim and refit later. Work on one side at a time, starting with the passenger side.
2. Remove the top stabilizer bar mounting bolts from the stabilizer mounting bracket. Hold the lower main brace in position with the rear mounting tab over the top of the stabilizer mounting bracket. Reinstall the stabilizer bar mounting bolt through the braces rear mounting tab.
3. Now, find the large sub frame mount bolt near the front and above the brace. Remove this bolt and reinstall through the side brace mounting tab. Be sure to install as illustrated. Bolt the side brace to the main brace using the supplied 1/2" x 1 1/2" bolts, flat washers, lock washers and nut.
4. Locate the existing holes in the sub frame that line up with the two holes in the rear lower brace extension. A 1/4" x 1 1/2" x 3 1/2" nutted backing plate will have to be fish wired through the hollow front of the sub frame and lined up with the 1/2" holes in the brace extension. Once the backing plate is inserted it can be held in place with a finger through a nearby access hole in the sub frame. Bolt through the lower brace extension and sub frame using the supplied 1/2" x 1 1/2" bolts, flat washers, and lock washers.
5. Repeat steps 2, 3 and 4 to install the driver side main and side brace with the following exception. After fish wiring the nutted backing plate into position and bolting through the one available hole in the sub frame, swing the backing plate to one side for clearance and drill a 1/2" hole through the sub frame using the existing hole in the lower brace extension as a template.
6. Bolt the center brace between the lower braces using two 1/2" x 1 1/2" bolts, flat washers, lock washers and nuts.
7. Align the main braces so they are parallel and level with each other, then tighten all bolts to the torque specifications below.
8. Mount the tow bar according to the manufacturers instructions.

**HARDWARE LIST:**

- 8-1/2" X 1 1/2" BOLTS
- 8-1/2" LOCK WASHERS
- 10-1/2" FLAT WASHERS
- 4-1/2" NUTS
- 2-1/4" X 1 1/2" X 3 1/2" NUTTED BACKING PLATES

012799

**CAUTION:** Installer must read instructions and use all bolts and parts supplied.

FAILURE TO FOLLOW THESE INSTRUCTIONS CAN RESULT IN DEATH, PERSONAL INJURY OR PROPERTY DAMAGE

**BOLT TORQUE REQUIREMENTS**

STANDARD BOLTS			METRIC BOLTS			METRIC BOLTS		
SIZE	GRADE	TORQUE	SIZE	GRADE	PLATED / UNPLATED	SIZE	GRADE	PLATED / UNPLATED
5/16	5	13 ft./lb.	M8-1.0	8.8	20 ft./lb. 18ft./lb.	M 12-1.25	8.8	70 ft./lb. 65ft./lb.
3/8	5	23 ft./lb.	M8-1.25	8.8	19 ft./lb. 18ft./lb.	M 12-1.5	8.8	66 ft./lb. 61ft./lb.
7/16	5	37 ft./lb.	M10-1.25	8.8	38 ft./lb. 36ft./lb.	M 12-1.75	8.8	65 ft./lb. 60ft./lb.
1/2	5	56 ft./lb.	M10-1.5	8.8	37 ft./lb. 35ft./lb.	M 12-2.0	8.8	104 ft./lb. 97ft./lb.

All illustrations and specifications contained herein are based on the latest information available at the time of publication approval. ROADMASTER, INC. reserves the right to make changes at any time without notice in material, specification and models or to discontinue models.