



MOUNTING BRACKET KIT INSTALLATION INSTRUCTIONS

ROADMASTER, Inc. 6110 NE 127th Ave. Vancouver, WA 98682 1-800-669-9690 fax 360-735-9300 www.roadmasterinc.com

PARTS LIST:

- 1- FRONT BRACE (A) - Passenger side
- 1- FRONT BRACE (B) - Driver's side

KIT NO. 158-1

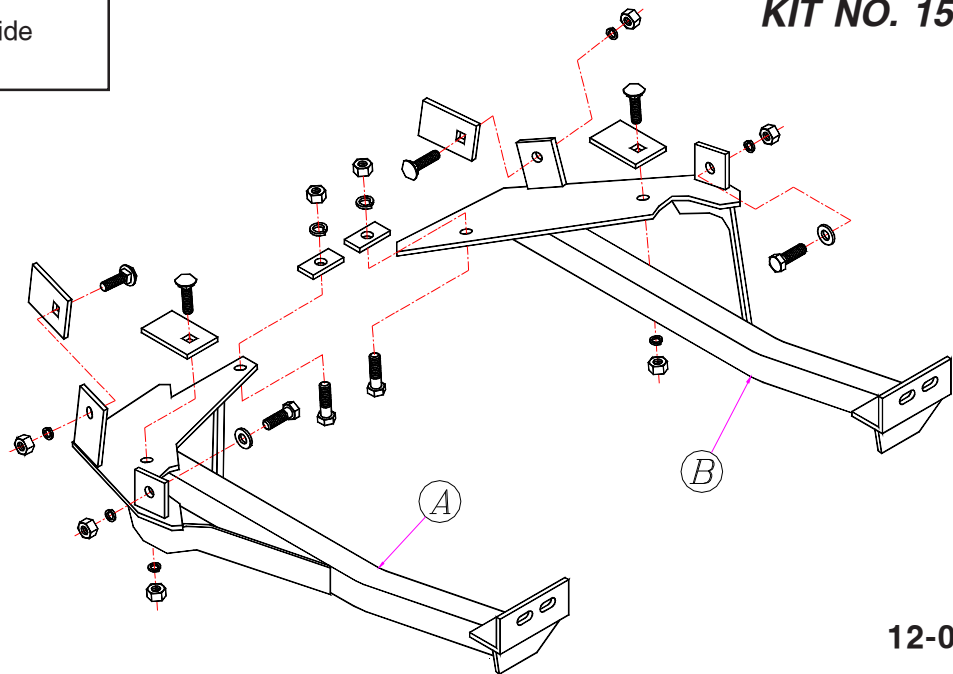

12-04-97

IMPORTANT: All brackets **must** be assembled with all the bolts left loose for final adjustment and positioning (before tightening) unless otherwise instructed. All bolts **must** be torqued for proper strength. If more than one bolt is used per fastening point, the diagram may only show one.

- Use flat washers over all slotted holes
- Use lock washers on all fasteners

ROADMASTER Limited Warranty, including One-Year Conditional Warranty Text and Product Registration Card, in Carton.

! WARNING

Failure to follow these instructions can result in property damage, personal injury or even death.

- Installation of most mounting brackets requires moderate mechanical aptitude and skills. We strongly recommend professional installation by an experienced installer.
- The installer must read the instructions and use all bolts and parts supplied. Failure to securely fasten the bracket could result in loss of the towed vehicle.
- Do not use this document for custom fabrication, as it may not show all parts or structural components. Custom fabrication or an attempt to copy this bracket design could result in loss of the towed vehicle.
- The owner must inspect all mounts and brackets before each use for cracks or other signs of fatigue. Also, inspect the fasteners for proper torque, according to the bolt torque requirements chart on the last page. Failure to do so could result in loss of the towed vehicle.
- The owner must check the vehicle manufacturer's instructions for the proper procedure(s) to prepare the vehicle for towing. Some vehicles must be equipped with a transmission lube pump, an axle disconnect, driveline disconnect or free-wheeling hubs before they can be towed. Failure to properly equip the vehicle will cause severe damage to the transmission.
- If running changes were made by the vehicle manufacturer after this bracket was designed, some bolts or other fasteners in the included hardware pack may no longer be the correct size. It is the installer's responsibility to verify that the bracket is securely fastened to the vehicle, and fitted with the correct hardware, to account for these changes. Failure to

securely fasten the bracket could result in loss of the towed vehicle.

- If the towed vehicle has been in an accident, it must be properly repaired before attaching the bracket. **Do not install the bracket if any structural frame damage is found.** Failure to repair the damage could result in the loss of the towed vehicle.
- Some motorhome chassis have such a tight turning radius that you can damage your motorhome, towed vehicle, tow bar or bracket while turning sharply. **Before getting on the road, test your turning radius in an empty parking lot.** Turning too sharply could result in non-warranty damage to towing system, motorhome and/or towed vehicle.
- Do not back up with the towed vehicle attached or non-warranty damage will occur to your towing system, motorhome and/or towed vehicle.
- The safety cables must connect the towing vehicle to the towed vehicle frame to frame, with the cables crossed, with enough slack for sharp turns. Refer to the cable instructions for proper routing. Failure to leave enough slack in the safety cables, or failure to connect the safety cables frame to frame, will result in the loss of the towed vehicle.
- This bracket is designed for use with ROADMASTER tow bars and ROADMASTER adaptors only. **Using this bracket with other brands, without an approved ROADMASTER adaptor, may result in non-warranty damage or injury.**
- Upon final installation, the installer must inspect the bracket to ensure adequate clearance, particularly around hoses, air conditioner lines, radiators, etc., or non-warranty damage to the towed vehicle will result.
- This bracket is only warranted for the original installation. Installing a used bracket on another vehicle is not recommended and will void the warranty.

MOUNTING BRACKET KIT INSTALLATION INSTRUCTIONS

ROADMASTER, Inc. 6110 NE 127th Ave. Vancouver, WA 98682 1-800-669-9690 fax 360-735-9300 www.roadmasterinc.com

KIT NO. 158-1

- Important:** please use all supplied bolts and parts and read all instructions carefully before beginning this installation. The majority of questions you may have can be answered within the text, and proper installation will ensure safe and secure travel. Now, begin the installation. This bracket kit mounts to the sides and under the front subframe on both sides of the vehicle. Remove the lower plastic bumper skirt and the protective sheet metal plate on the passenger side of the subframe.
- To mount the braces, begin by inserting a 1/2" x 1 1/2" carriage bolt into two 1/4" x 2" x 3" backing plates. Now locate an oval hole on the side of each subframe horn approximately 10" from the front subframe mount. Fish wire these backing plates and bolts down through the front of each frame horn and into the side hole. Leave the fish wire on each bolt for now.
- Look at the top outside of the frame horns on each side. You will find a 1/2" hole directly in line with the subframe mount. Pass a 1/2" x 1 1/2" bolt with a flat washer through it from the inside of the frame horn; if you can't, enlarge the hole slightly. Find the two remaining 1/4" x 2" x 3" backing plates and insert a 1/2" x 1 1/2" carriage bolt into each one and set aside.
- Start with the driver side brace and hold it up to the bottom of the subframe. Fish the bottom side bolt through the side tab and bolt with a 1/2" nut and lock washer. Do the same with the top bolt. Now, let the brace hang down slightly and install a backing plate inside the subframe horn through an existing bottom hole near the large opening at the front of the subframe. Finish with a 1/2" nut and lock washer.
- Follow the same procedure for the passenger side with the exception of drilling a 1/2" hole through the frame horn to install the top backing plate.
- Install the tow bar according to the manufacturer's instructions, align and tighten all bolts to the chart torque specifications below.
- Now, find the remaining hole in the bottom mounting plate on each brace and drill a hole through each into the lip of the horizontal crossmember. *Note:* make sure all hoses and wires are out of the way. Bolt through each hole using a 1/2" x 1 3/4" bolt, 1/4" x 1" x 2" backing plate, lock washer and nut. Torque to the specifications below.

HARDWARE LIST:

- | | |
|--|-----------------------------------|
| 4 - 1/2" x 1-1/2" carriage bolts | 2 - 1/4" x 1" x 2" backing plates |
| 2 - 1/2" x 1-1/2" bolts | 8 - 1/2" lock washers |
| 8 - 1/2" nuts | 2 - 1/2" x 1-3/4" bolts |
| 4 - 1/4" x 2" x 3" sq. hole backing plates | 2 - 1/2" flat washers |

12-04-97

BOLT TORQUE REQUIREMENTS

Note: The torque values represented below are intended as general guidelines. Torque requirements for specific applications may vary. Roadmaster does not warrant this information to be accurate for all applications and disclaims all liability for any claims or damages which may result from its use.

STANDARD BOLTS			METRIC BOLTS			METRIC BOLTS		
Thread Size	Grade	Torque	Thread Size	Grade	Plated/Unplated	Thread Size	Grade	Plated/Unplated
5/16	5	13 ft./lb.	8mm-1.0	8.8	20 ft./lb. 18 ft./lb.	12mm-1.25	8.8	70 ft./lb. 65 ft./lb.
3/8	5	23 ft./lb.	8mm-1.25	8.8	19 ft./lb. 18 ft./lb.	12mm-1.5	8.8	66 ft./lb. 61 ft./lb.
7/16	5	37 ft./lb.	10mm-1.25	8.8	38 ft./lb. 36 ft./lb.	12mm-1.75	8.8	65 ft./lb. 60 ft./lb.
1/2	5	56 ft./lb.	10mm-1.5	8.8	37 ft./lb. 35 ft./lb.	14mm-2.0	8.8	104 ft./lb. 97 ft./lb.
5/8	5	150 ft./lb.						