

BASEPLATE KIT INSTALLATION INSTRUCTIONS

ROADMASTER, Inc. 6110 NE 127th Ave. Vancouver, WA 98682 1-800-669-9690 fax 360-735-9300 www.roadmasterinc.com

PARTS LIST:

- 1- FRONT BRACE (A) - Passenger side
- 1- FRONT BRACE (B) - Driver's side

KIT NO. 158-2

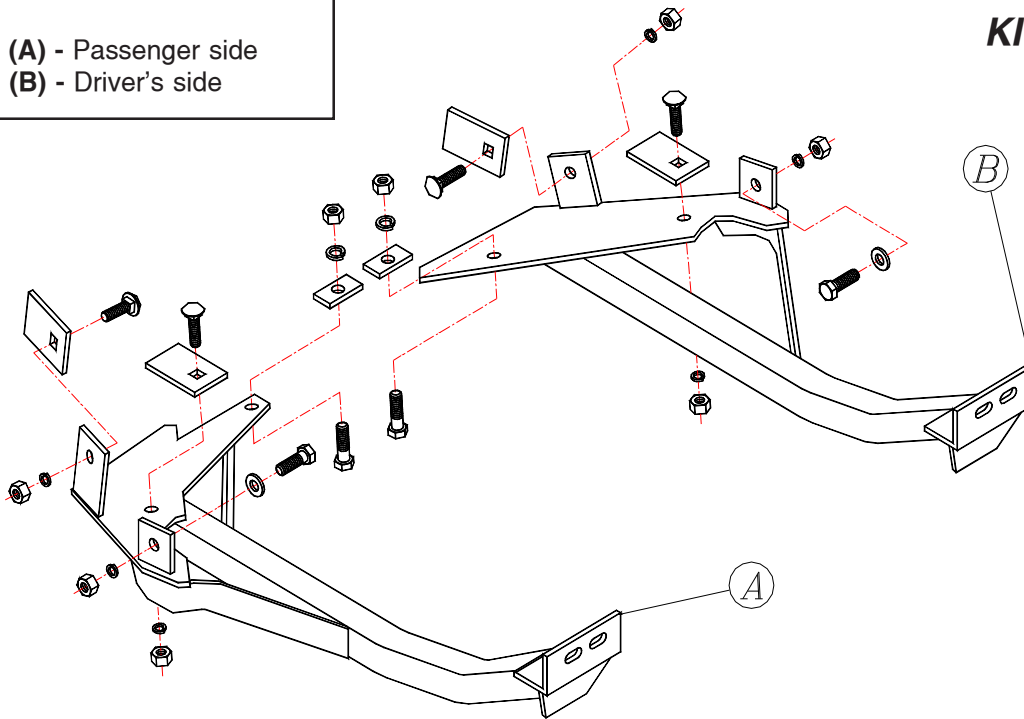

12-02-97

IMPORTANT: All baseplates **must** be assembled with all the bolts left loose for final adjustment and positioning (before tightening) unless otherwise instructed. All bolts **must** be torqued for proper strength. If more than one bolt is used per fastening point, the diagram may only show one. Use flat washers over all slotted holes and lock washers on all fasteners.

WARNING

Failure to heed these warnings or follow the installation instructions may result in a voided warranty, loss of towed vehicle, personal injury or death.

- Do not weld or modify this baseplate or its components. Welding or modification will void the warranty.
- Do not use this document as a basis to design/fabricate a baseplate, as it may not show all parts or structural components.
- We strongly recommend professional installation.
- If the towed vehicle has been in an accident, it must be properly repaired before attaching the baseplate. **Do not install the baseplate if any structural frame damage is found.**
- The installer must use all bolts and parts supplied. If running changes were made by the vehicle manufacturer after this kit was designed, some bolts or other fasteners may no longer be the correct size. **It is the installer's responsibility to verify this kit is securely fastened to the vehicle.**
- Use **Loctite® Red on all bolts used to secure this baseplate.** Torque all bolts to the specifications found at the end of these instructions. **Do not over-torque the bolts or failure may occur.**
- The installer must inspect the baseplate to ensure adequate clearance, particularly around hoses, air conditioner lines, radiators, etc. or non-warranty failure may result.
- Roadmaster manufactures many styles of baseplates. **If your baseplate has removable arms, they must be removed before driving the vehicle, unless the arms can be pinned or padlocked in place.** If not secured, the arms could vibrate out.
- Some motorhome chassis have such a tight turning radius that you can damage your motorhome, towed vehicle, tow bar or baseplate while turning sharply. **Before getting on the road, test your turning radius in**

an empty parking lot. Turning too sharply could result in non-warranty damage to your towing system, motorhome and/or towed vehicle.

- **Do not back up with the towed vehicle attached** or non-warranty damage will occur to your towing system or vehicles.
- **The safety cables must connect the towing vehicle to the towed vehicle frame to frame, with the cables crossed, with enough slack for sharp turns.** See cable instructions for proper routing. Failure to do so will result in non-warranty damage and/or the loss of the towed vehicle.
- This kit is designed for use with ROADMASTER tow bars and ROADMASTER adapters only. **Using this kit with other brands, without an approved ROADMASTER adapter, may result in non-warranty damage or injury.**
- **Receiver extensions and out-of-level towing situations of 3 inches or more.** This can cause the system to swing much higher and lower, causing excessive strain on the tow bar, baseplate and frame. That can cause the towing system to fail, causing property damage, personal injury or even death. **If you must use a receiver extension or drop hitch to tow, it will reduce your receiver's weight capacity by 1/3 to avoid damaging your system. Never use more than one extension and/or drop hitch, as this will void your warranty.**
- **Every 3,000 miles, the owner must inspect all mounting points for cracks or fatigue, and check the fasteners for proper torque, according to the bolt torque requirements chart on the last page of these instructions.**
- **The owner must follow the vehicle manufacturer's instructions to prepare the vehicle for towing.** Failure to do so may cause severe damage to the vehicle.
- **This baseplate is only warranted for the original installation.** Installing a used baseplate on another vehicle is not recommended and will void the warranty.



BASEPLATE KIT INSTALLATION INSTRUCTIONS

ROADMASTER, Inc. 6110 NE 127th Ave. Vancouver, WA 98682 1-800-669-9690 fax 360-735-9300 www.roadmasterinc.com

KIT NO. 158-2

- Important:** please use all supplied bolts and parts and read all instructions carefully before beginning this installation. The majority of questions you may have can be answered within the text, and proper installation will ensure safe and secure travel. Now, begin the installation. This bracket kit mounts to the sides and under the front subframe on both sides of the vehicle. Remove the lower plastic bumper skirt and the protective sheet metal plate on the passenger side of the subframe.
- To mount the braces, begin by inserting a 1/2" x 1 1/2" carriage bolt into two 1/4" x 2" x 3" backing plates. Now locate an oval hole on the side of each subframe horn approximately 10" from the front subframe mount. *Note:* see the included fishwiring sheet. Fishwire these backing plates and bolts down through the front of each frame horn and into the side hole. Leave the fishwire on each bolt for now.
- Look at the top outside of the frame horns on each side. You will find a 1/2" hole directly in line with the subframe mount. Pass a 1/2" x 1 1/2" bolt with a flat washer through it from the inside of the frame horn; if you can't, enlarge the hole slightly. Find the two remaining 1/4" x 2" x 3" backing plates and insert a 1/2" x 1 1/2" carriage bolt into each one and set aside.
- Start with the driver side brace and hold it up to the bottom of the subframe. Fish the bottom side bolt through the side tab and bolt with a 1/2" nut and lock washer. Do the same with the top bolt. Now, let the brace hang down slightly and install a backing plate inside the subframe horn through an existing bottom hole near the large opening at the front of the subframe. Finish with a 1/2" nut and lock washer.
- Follow the same procedure fro the passenger side with the exception of drilling a 1/2" hole through the frame horn to install the top backing plate.
- Install the tow bar according to the manufacturer's instructions, align and tighten all bolts to the chart torque specifications below.
- Now, find the remaining hole in the bottom mounting plate on each brace and drill a hole through each into the lip of the horizontal crossmember. *Note:* make sure all hoses and wires are out of the way. Bolt through each hole using a 1/2" x 1 3/4" bolt, 1/4" x 1" x 2" backing plate, lock washer and nut. Torque to the specifications below.

HARDWARE LIST:

- | | | |
|--------------------------------------------|-------------------------|----------|
| 4 - 1/2" x 1-1/2" carriage bolts | 8 - 1/2" lock washers | |
| 2 - 1/2" x 1-1/2" bolts | 2 - 1/2" x 1-3/4" bolts | 12-02-97 |
| 8 - 1/2" nuts | 2 - 1/2" flat washers | |
| 4 - 1/4" x 2" x 3" sq. hole backing plates | | |
| 2 - 1/4" x 1" x 2" backing plates | | |

BOLT TORQUE REQUIREMENTS

Note: The torque values represented below are intended as general guidelines. Torque requirements for specific applications may vary. Roadmaster does not warrant this information to be accurate for all applications and disclaims all liability for any claims or damages which may result from its use.

STANDARD BOLTS			METRIC BOLTS			METRIC BOLTS		
Thread Size	Grade	Torque	Thread Size	Grade	Plated/Unplated	Thread Size	Grade	Plated/Unplated
5/16	5	13 ft./lb.	8mm-1.0	8.8	20 ft./lb. 18 ft./lb.	12mm-1.25	8.8	70 ft./lb. 65 ft./lb.
3/8	5	23 ft./lb.	8mm-1.25	8.8	19 ft./lb. 18 ft./lb.	12mm-1.5	8.8	66 ft./lb. 61 ft./lb.
7/16	5	37 ft./lb.	10mm-1.25	8.8	38 ft./lb. 36 ft./lb.	12mm-1.75	8.8	65 ft./lb. 60 ft./lb.
1/2	5	56 ft./lb.	10mm-1.5	8.8	37 ft./lb. 35 ft./lb.	14mm-2.0	8.8	104 ft./lb. 97 ft./lb.
5/8	5	150 ft./lb.						