



BASEPLATE KIT INSTALLATION INSTRUCTIONS

KIT# 179-2

09/07/10
KS

ROADMASTER, Inc. 6110 NE 127th Ave. Vancouver, WA 98682 360-896-0407 fax 360-735-9300 www.roadmasterinc.com

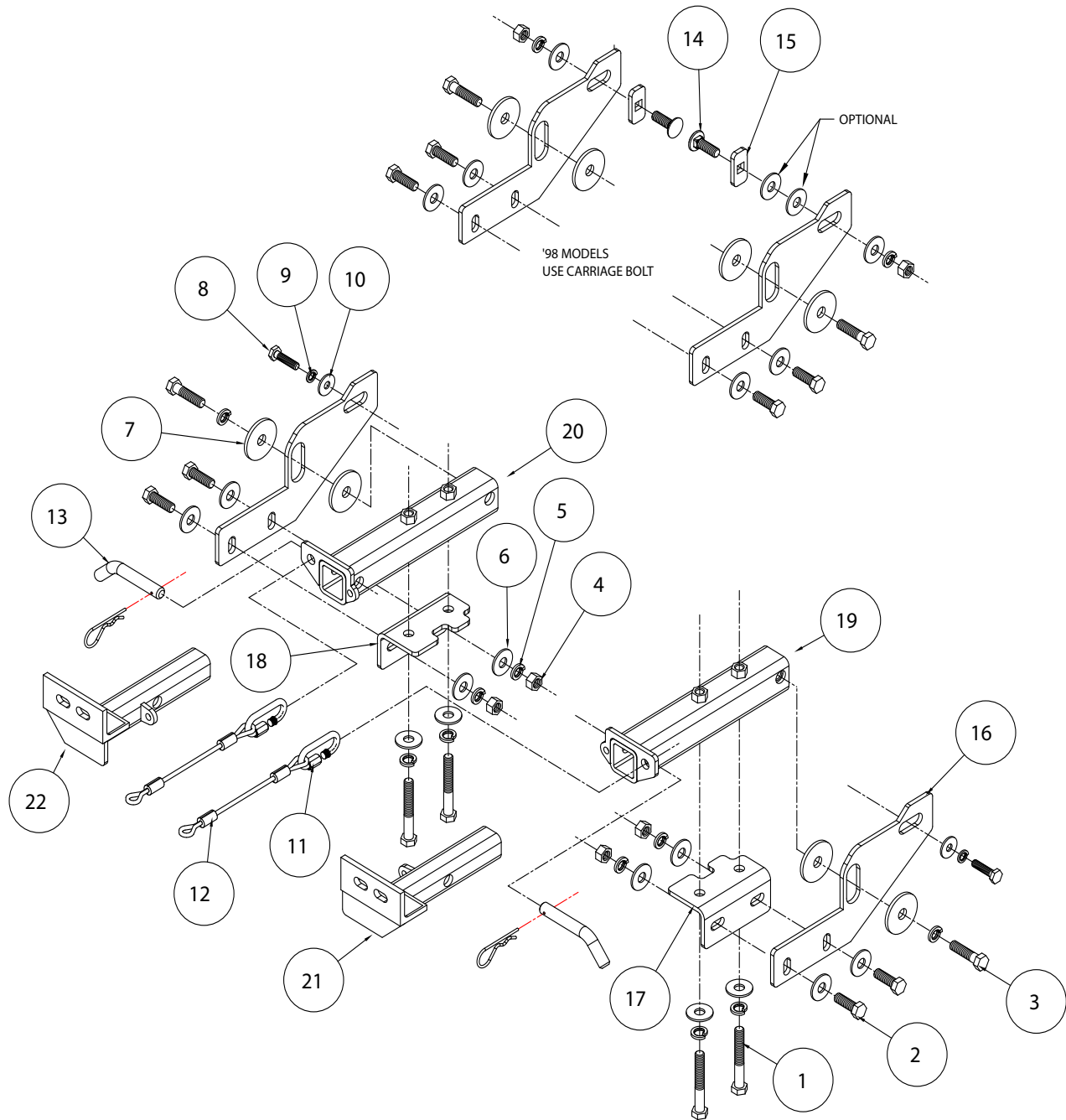

Hardware list on next page



BASEPLATE KIT INSTALLATION INSTRUCTIONS

KIT# 179-2

09/07/10
KS

ROADMASTER, Inc. 6110 NE 127th Ave. Vancouver, WA 98682 360-896-0407 fax 360-735-9300 www.roadmasterinc.com

ITEM	QTY	NAME	MATERIAL
1.....	4	1/2" x 3 1/2" BOLT.....	350103-00
2.....	4	1/2" x 1 1/2" BOLT.....	350095-00
3.....	2	1/2" x 2" BOLT.....	350097-00
4.....	6	1/2" HEX NUT	350258-00
5.....	12	1/2" LOCK WASHER	350309-00
6.....	16	1/2" FLAT WASHER.....	350308-00
7.....	4	1/2' PLATE WASHER	350351-00
8.....	2	10mm x 1.50 x 40 mm BOLT	356103-00
9.....	2	10mm LOCK WASHER.....	355715-00
10.....	2	10mm FENDER WASHER	355702-00
11.....	2	QUICK LINK.....	200008-00
12.....	2	13" SAFETY CABLES (8000#)	650648-13
13.....	2	DRAW PIN W/ CLIP.....	357035-00
14.....	2	1/2" x 1 1/2" CARRIAGE BOLT.....	350362-00
15.....	2	1" x 2" SQ. HOLE BACKING PLATE	A-000040
16.....	2	MOUNTING PLATE	A-000769
17.....	1	DRIVER SIDE BRACE.....	B-000313
18.....	1	PASSENGER SIDE BRACE.....	B-000312
19.....	1	DRIVER SIDE RECEIVER.....	C-000426

IMPORTANT: All baseplates **must** be assembled with all the bolts left loose for final adjustment and positioning (before tightening) unless otherwise instructed. All bolts **must** be torqued for proper strength. If more than one bolt is used per fastening point, the diagram may only show one. Use flat washers over all slotted holes and lock washers on all fasteners.

WARNING

Failure to heed these warnings or follow the installation instructions may result in a voided warranty, loss of towed vehicle, personal injury or death.

- Do not weld or modify this baseplate or its components. Welding or modification will void the warranty.
- Do not use this document as a basis to design/fabricate a baseplate, as it may not show all parts or structural components.
- We strongly recommend professional installation.
- If the towed vehicle has been in an accident, it must be properly repaired before attaching the baseplate. Do not install the baseplate if any structural frame damage is found.
- The installer must use all bolts and parts supplied. If running changes were made by the vehicle manufacturer after this kit was designed, some bolts or other fasteners may no longer be the correct size. It is the installer's responsibility to verify this kit is securely fastened to the vehicle.
- Use Loctite® Red on all bolts used to secure this baseplate. Torque all bolts to the specifications found at the end of these instructions. Do not over-torque the bolts or failure may occur.
- The installer must inspect the baseplate to ensure adequate clearance, particularly around hoses, air conditioner lines, radiators, etc. or non-warranty failure may result.
- Roadmaster manufactures many styles of baseplates. If your baseplate has removable arms, they must be removed before driving the vehicle, unless the arms can be pinned or padlocked in place. If not secured, the arms could vibrate out.
- Some motorhome chassis have such a tight turning radius that you can damage your motorhome, towed vehicle, tow bar or baseplate while turning sharply. Before getting on the road, test your turning radius in an empty parking lot. Turning too sharply could

result in non-warranty damage to your towing system, motorhome and/or towed vehicle.

- Do not back up with the towed vehicle attached or non-warranty damage will occur to your towing system or vehicles.
- The safety cables must connect the towing vehicle to the towed vehicle frame to frame, with the cables crossed, with enough slack for sharp turns. See cable instructions for proper routing. Failure to do so will result in non-warranty damage and/or the loss of the towed vehicle.
- This kit is designed for use with ROADMASTER tow bars and ROADMASTER adapters only. Using this kit with other brands, without an approved ROADMASTER adapter, may result in non-warranty damage or injury.
- Receiver extensions and out-of-level towing situations of 3 inches or more. This can cause the system to swing much higher and lower, causing excessive strain on the tow bar, baseplate and frame. That can cause the towing system to fail, causing property damage, personal injury or even death. If you must use a receiver extension or drop hitch to tow, it will reduce your receiver's weight capacity by 1/3 to avoid damaging your system. Never use more than one extension and/or drop hitch, as this will void your warranty.
- Every 3,000 miles, the owner must inspect all mounting points for cracks or fatigue, and check the fasteners for proper torque, according to the bolt torque requirements chart on the last page of these instructions.
- The owner must follow the vehicle manufacturer's instructions to prepare the vehicle for towing. Failure to do so may cause severe damage to the vehicle.
- This baseplate is only warranted for the original installation. Installing a used baseplate on another vehicle is not recommended and will void the warranty.



BASEPLATE KIT INSTALLATION INSTRUCTIONS

KIT# 179-2

09/07/10
KS

ROADMASTER, Inc. 6110 NE 127th Ave. Vancouver, WA 98682 360-896-0407 fax 360-735-9300 www.roadmasterinc.com

1. **Important:** please use all supplied bolts and parts and read all instructions carefully before beginning this installation. The majority of questions you may have can be answered within the text, and proper installation will ensure safe and secure travel. Now, begin the installation. This bracket kit is one of our XL Series, which is designed so that the front braces can be removed from the receiver braces. The kit consists of the main receiver braces, front braces and a hardware pack. The receiver braces utilizes the front tow hook mounts in the frame and the side of the frame as attachment points on each side. Start by laying out the kit as illustrated. This will give you a visual idea of how the kit installs and also confirm that the kit components are present and accounted for. Start by removing the tow hooks and stock bolts on both sides.
2. Enlarge the existing tow hook mount bolt holes slightly to accommodate the larger 1/2" bolts included in the kit hardware.
3. Working on one side at a time, fit the lower brace plate under the frame and under the side of the skidpan. Line up the holes in the lower brace plate with the reamed holes in the frame.
4. Fit a receiver brace through the air dam and into the front of the frame tube. Line up the two bottom holes in the brace with the enlarged holes in the frame and lower brace plate, then check the large slotted side hole in the frame and see if it lines up with the rear side mounting nut on the receiver brace. If it doesn't line up, the frame hole will have to be enlarged.
5. Bolt through the lower brace plate and two enlarged tow hook mounting holes into the inserted receiver brace with the supplied 1/2" x 3 1/2" bolts and lock washers.
6. Pull the fender brace away from the frame slightly, hold the side brace to the side of the frame and bolt through the fender brace and side plate with a 10mm x 1.5 x 40mm bolt, lock washer and flat washer. *Note:* from '98 vehicles on, the fender brace has been eliminated and the mounting procedure for the rear side brace mounting bolt has been changed. Using 1" x 2" backing plates and trimmed head 1/2" x 1 3/4" carriage bolts, fishwire through the large slot on the outside of the frame and then through the brace. Finish with flat washers, lock washers, and nuts. Some vehicles may require two additional flat washers as spacers between the frame and plate on the driver's side. Repeat this step on the passenger side.
7. Bolt the bottom of the side brace to the bottom brace plate using 1/2" x 1 1/2" bolts, flat washers, lock washers and nuts.
8. Now, bolt through the frame side hole with a 1/2" x 2" bolt, 1/2" plate washers and lock washer. Use one of the plate washers as a spacer between the frame and side brace as a spacer.
9. Repeat steps 3 through 8 for the remaining side.
10. Replace skid pan bolts if present.
11. Insert the front braces into the rear receivers and secure in place using the supplied 5/8" draw pins and 1/8" spring pins.
12. Mount the tow bar according to the manufacturer's instructions.
13. Use the supplied safety cables and cable connectors to connect the receiver brace to the tow bar and tow vehicle's safety cables.