



BASEPLATE KIT INSTALLATION INSTRUCTIONS

KIT# 1913-1

08/26/04

ROADMASTER, Inc. 6110 NE 127th Ave. Vancouver, WA 98682 360-896-0407 fax 360-735-9300 www.roadmasterinc.com

Important

Note: this bracket will not accommodate the Guardian rock shield, some models of the Tow Defender, Stowaway or the StowMaster and StowMaster All Terrain tow bars.

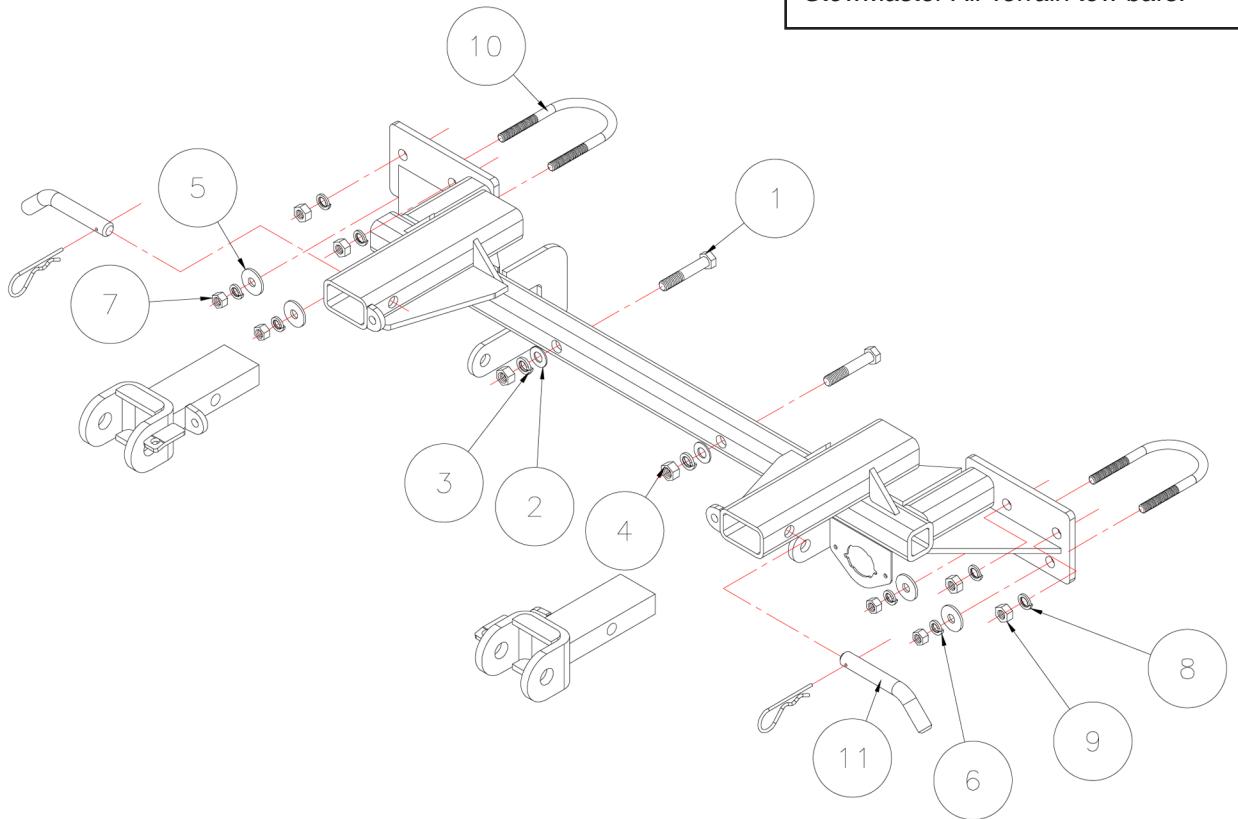

Item	Qty.	Length	Width	Description	Part #
1	2	2 1/2"	7/16"	BOLT	350078-00
2	2		7/16"	FLAT WASHER	350345-00
3	2		7/16"	LOCK WASHER	350307-00
4	2		7/16"	NUT	350256-00
5	4		3/8"	FLAT WASHER	350304-50
6	4		3/8"	LOCK WASHER	350305-00
7	4		3/8"	NUT	350254-00
8	4		10mm	LOCK WASHER	355715-00
9	4		10mm	M10 x 1.5 NUT	356230-00
10	2		3/8"	U-BOLT	357361-00
11	2			DRAW PIN/SPRING PIN	357038-00

ROADMASTER, INC.



BASEPLATE KIT INSTALLATION INSTRUCTIONS

KIT# 1913-1

08/26/04

ROADMASTER, Inc. 6110 NE 127th Ave. Vancouver, WA 98682 360-896-0407 fax 360-735-9300 www.roadmasterinc.com

Item	Qty.	Part #	Description
1.....	1	C-001053	MAIN BRACE WELDMENT
2.....	1	C-001054	DRIVER SIDE ARM TUBE
3.....	1	C-001055	PASSENGER SIDE ARM TUBE
4.....	2	357361-00.....	U-BOLT

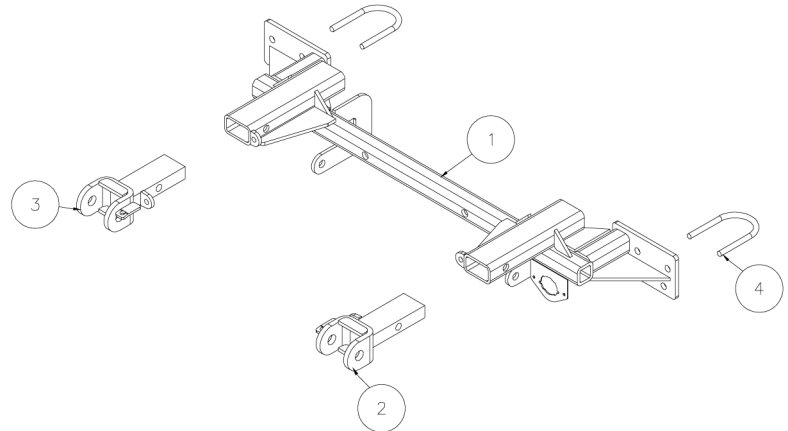

IMPORTANT: All baseplates **must** be assembled with all the bolts left loose for final adjustment and positioning (before tightening) unless otherwise instructed. All bolts **must** be torqued for proper strength. If more than one bolt is used per fastening point, the diagram may only show one. Use flat washers over all slotted holes and lock washers on all fasteners.

WARNING

Failure to heed these warnings or follow the installation instructions may result in a voided warranty, loss of towed vehicle, personal injury or death.

- Do not weld or modify this baseplate or its components. Welding or modification will void the warranty.
- Do not use this document as a basis to design/fabricate a baseplate, as it may not show all parts or structural components.
- We strongly recommend professional installation.
- If the towed vehicle has been in an accident, it must be properly repaired before attaching the baseplate. Do not install the baseplate if any structural frame damage is found.
- The installer must use all bolts and parts supplied. If running changes were made by the vehicle manufacturer after this kit was designed, some bolts or other fasteners may no longer be the correct size. It is the installer's responsibility to verify this kit is securely fastened to the vehicle.
- Use Loctite® Red on all bolts used to secure this baseplate. Torque all bolts to the specifications found at the end of these instructions. Do not over-torque the bolts or failure may occur.
- The installer must inspect the baseplate to ensure adequate clearance, particularly around hoses, air conditioner lines, radiators, etc. or non-warranty failure may result.
- Roadmaster manufactures many styles of baseplates. If your baseplate has removable arms, they must be removed before driving the vehicle, unless the arms can be pinned or padlocked in place. If not secured, the arms could vibrate out.
- Some motorhome chassis have such a tight turning radius that you can damage your motorhome, towed vehicle, tow bar or baseplate while turning sharply. Before getting on the road, test your turning radius in an empty parking lot. Turning too sharply could

result in non-warranty damage to your towing system, motorhome and/or towed vehicle.

- Do not back up with the towed vehicle attached or non-warranty damage will occur to your towing system or vehicles.
- The safety cables must connect the towing vehicle to the towed vehicle frame to frame, with the cables crossed, with enough slack for sharp turns. Failure to do so will result in non-warranty damage and/or the loss of the towed vehicle.
- This kit is designed for use with ROADMASTER tow bars and ROADMASTER adapters only. Using this kit with other brands, without an approved ROADMASTER adapter, may result in non-warranty damage or injury.
- Receiver extensions and out-of-level towing situations of 3 inches or more. This can cause the system to swing much higher and lower, causing excessive strain on the tow bar, baseplate and frame. That can cause the towing system to fail, causing property damage, personal injury or even death. If you must use a receiver extension or drop hitch to tow, it will reduce your receiver's weight capacity by 1/3 to avoid damaging your system. Never use more than one extension and/or drop hitch, as this will void your warranty.
- Every 3,000 miles, the owner must inspect all mounting points for cracks or fatigue, and check the fasteners for proper torque, according to the bolt torque requirements chart on the last page of these instructions.
- The owner must follow the vehicle manufacturer's instructions to prepare the vehicle for towing. Failure to do so may cause severe damage to the vehicle.
- This baseplate is only warranted for the original installation. Installing a used baseplate on another vehicle is not recommended and will void the warranty.



BASEPLATE KIT INSTALLATION INSTRUCTIONS

KIT# 1913-1

08/26/04

ROADMASTER, Inc. 6110 NE 127th Ave. Vancouver, WA 98682 360-896-0407 fax 360-735-9300 www.roadmasterinc.com

This bracket kit is one of our MX series, which is designed to be partly removable. The kit consists of the main receiver brace, front braces and a hardware pack. The main receiver brace mounts behind the front bumper fascia to the frame and side of the radiator support on each side (Fig.A). The front braces insert into the receivers on each side.

Start by laying the kit out according to the illustration. This will give you a visual idea of how the kit installs and also confirm that the kit components are present and accounted for.

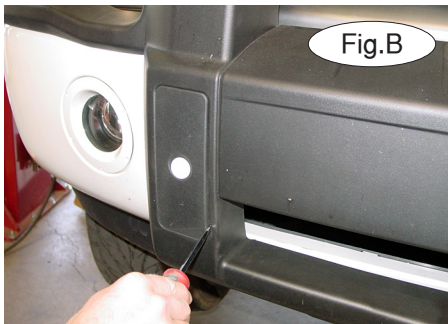

1. **Important:** please use all supplied bolts and parts and read all instructions carefully before beginning this installation. The majority of questions you may have can be answered within the text, and proper installation will ensure safe and secure travel. Now, begin the installation. Start by removing the tow hook covers and disconnecting proximity sensors on each side (Fig.B,C).

2. Remove side reflectors from both sides of the brush guard and remove the two 3mm allen head screws from each side (Fig.D,E).



3. Remove the 13mm bolts on each side as shown in (Fig.F)

4. Pull the brush guard out on both sides, then pull forward and remove (Fig.G). Be sure to set the plastic spacer aside: you will need to reinstall this when the brush guard is put back on (Fig.H).

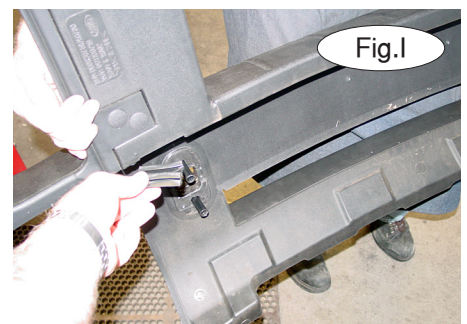



BASEPLATE KIT INSTALLATION INSTRUCTIONS

KIT# 1913-1

08/26/04

ROADMASTER, Inc. 6110 NE 127th Ave. Vancouver, WA 98682 360-896-0407 fax 360-735-9300 www.roadmasterinc.com

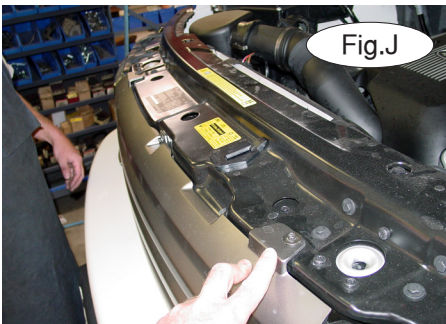

Fig.J

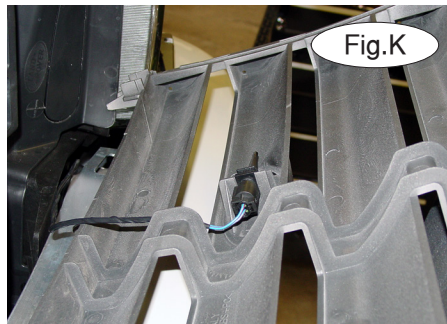

Fig.K



Fig.L

5. Now, removing three (8mm head) fasteners in the top of the grille between the headlights (Fig.J). Pull the ambient air sensor from the grille (Fig.K) then pull the grille forward and up to remove.

6. Remove four more fasteners from the top of the fascia (Fig.L).



Fig.M



Fig.N

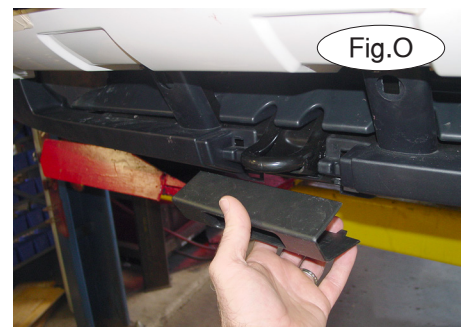

Fig.O

7. Remove one (8mm head) fastener from each side panel (Fig.M).

8. Remove four more large Phillips fasteners from the lower grille area (Fig.N).

9. Remove the plastic tow hook covers (Fig. O).

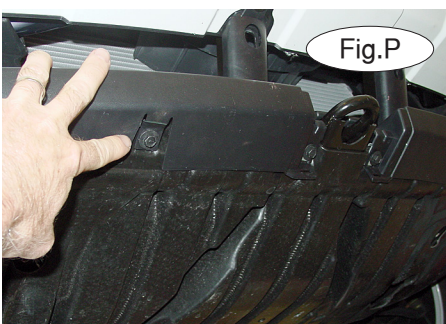

Fig.P

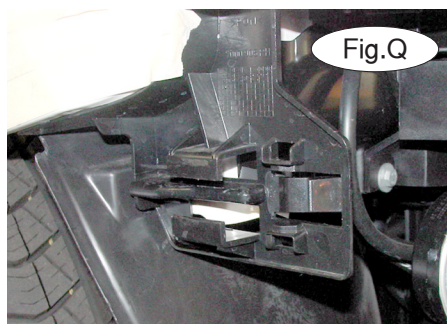

Fig.Q



Fig.R

10. Remove six (10mm head) bolts from the bottom of the fascia (Fig.P).

11. Disconnect the fog and marker lights then push in to release the fascia latches on each side and pull the bumper fascia forward to remove (Fig.Q,R).



BASEPLATE KIT INSTALLATION INSTRUCTIONS

KIT# 1913-1

08/26/04

ROADMASTER, Inc. 6110 NE 127th Ave. Vancouver, WA 98682 360-896-0407 fax 360-735-9300 www.roadmasterinc.com

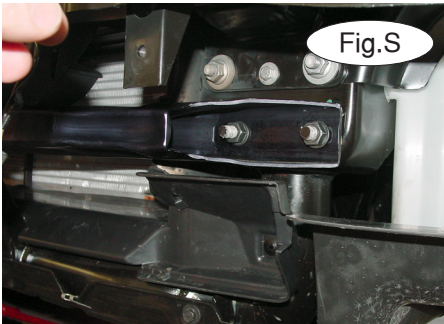

Fig.S

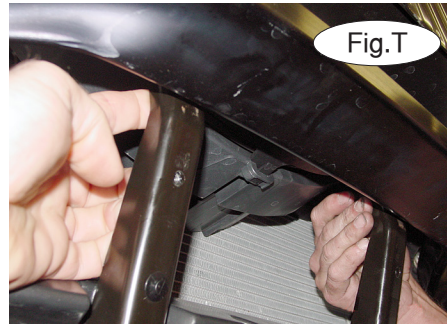

Fig.T



Fig.U

12. Remove the center crossmember (four 16mm nuts) two on each end (Fig.S), then two more bolts (10mm head) behind the bar (Fig.T,U). The main receiver brace will replace this crossmember.

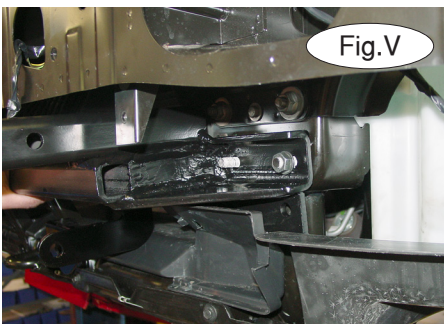

Fig.V

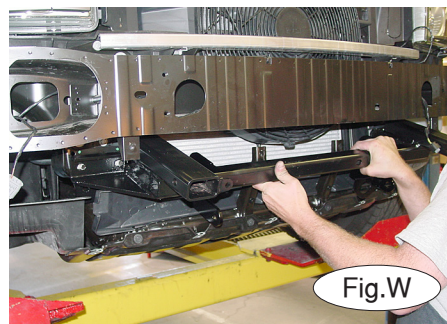

Fig.W

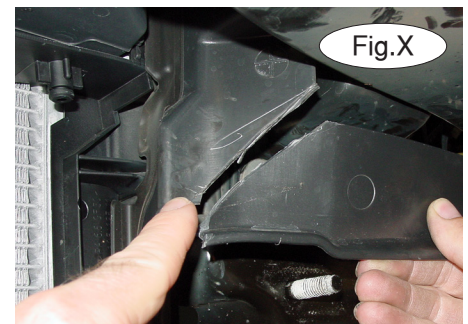

Fig.X

13. Install the main receiver brace on the studs as shown (Fig.V) with the stock nuts removed in the previous step (Fig.W).

14. Trim the plastic air deflectors on both sides as shown to clear the receiver brace (Fig.X).

15. Bolt through the front brace with 7/16" x 3" bolts, lock washers and nuts (Fig.Y).

16. Install 3/8" bolts as shown (Fig.Z, AA) with nuts and lock washers.

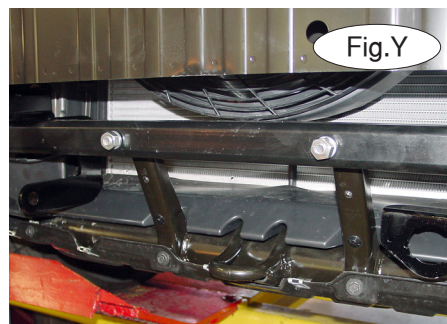

Fig.Y

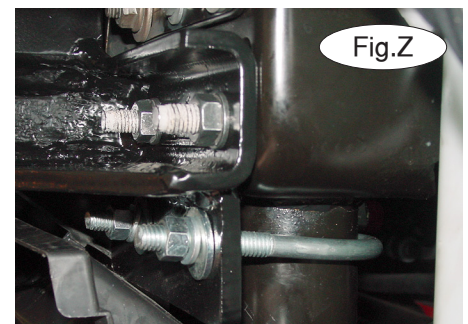

Fig.Z



BASEPLATE KIT INSTALLATION INSTRUCTIONS

KIT# 1913-1

08/26/04

ROADMASTER, Inc. 6110 NE 127th Ave. Vancouver, WA 98682 360-896-0407 fax 360-735-9300 www.roadmasterinc.com

17. Install 3/8" bolts as shown (Fig.Z,AA) with nuts and lock washers.
18. Torque all mounting bolts to the torque specifications below.
19. Replace the fascia and grille reversing steps 1 through 11 (Fig.BB).
20. Once the fascia and grille are installed, insert the front braces into the receiver braces and pin using 1/2" draw pins and 3/16" spring pins as shown (Fig.CC). Mount the tow bar according to the manufacturer's instructions and attach the safety cables to the main receiver brace.

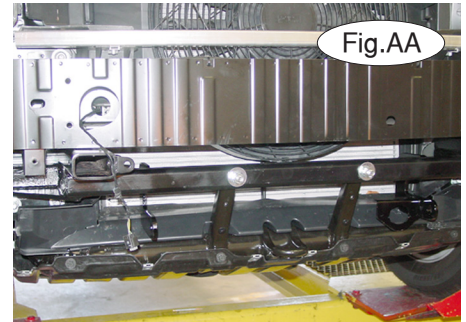

Fig.AA

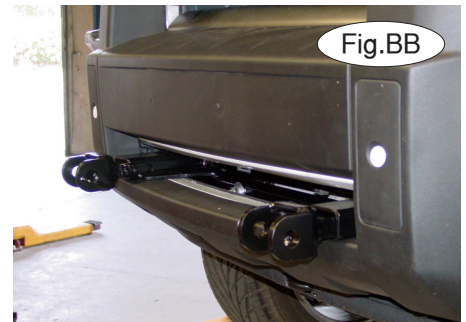

Fig.BB

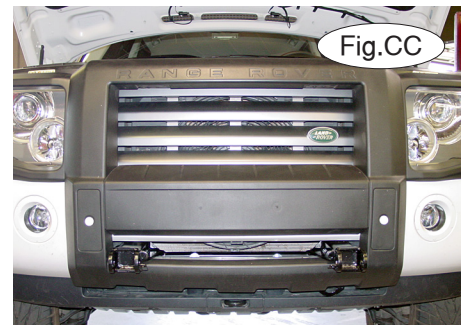

Fig.CC

BOLT TORQUE REQUIREMENTS

Note: The torque values represented below are intended as general guidelines. Torque requirements for specific applications may vary. Roadmaster does not warrant this information to be accurate for all applications and disclaims all liability for any claims or damages which may result from its use.

STANDARD BOLTS

Thread Size	Grade	Torque
5/16.....	5.....	13 ft./lb.
3/8.....	5.....	23 ft./lb.
7/16.....	5.....	37 ft./lb.
1/2.....	5.....	56 ft./lb.
5/8.....	5.....	150 ft./lb.

METRIC BOLTS

Thread Size	Grade	Plated / Unplated
8mm-1.0	8.8	20 ft./lb. 18 ft./lb.
8mm-1.25	8.8	19 ft./lb. 18 ft./lb.
10mm-1.25	8.8	38 ft./lb. 36 ft./lb.
10mm-1.5	8.8	37 ft./lb. 35 ft./lb.

METRIC BOLTS

Thread Size	Grade	Plated / Unplated
12mm-1.25	8.8	70 ft./lb. 65 ft./lb.
12mm-1.5	8.8	66 ft./lb. 61 ft./lb.
12mm-1.75	8.8	65 ft./lb. 60 ft./lb.
14mm-2.0	8.8	104 ft./lb. 97 ft./lb.