

# BASEPLATE KIT INSTALLATION INSTRUCTIONS

ROADMASTER, Inc. 6110 NE 127th Ave. Vancouver, WA 98682 1-800-669-9690 fax 360-735-9300 www.roadmasterinc.com

**PARTS LIST:**  
1- FRONT BRACE (A)  
1- MAIN BRACE (B)

**KIT NO. 2103-1**

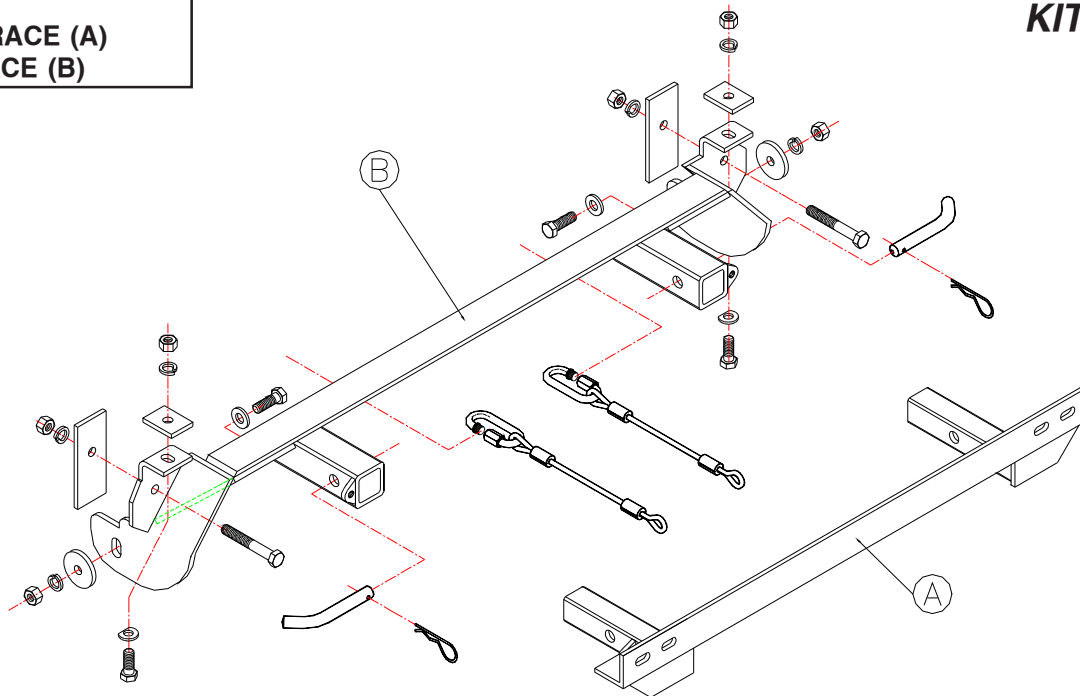

7/12/00

**IMPORTANT:** All baseplates **must** be assembled with all the bolts left loose for final adjustment and positioning (before tightening) unless otherwise instructed. All bolts **must** be torqued for proper strength. If more than one bolt is used per fastening point, the diagram may only show one. Use flat washers over all slotted holes and lock washers on all fasteners.

## WARNING

Failure to heed these warnings or follow the installation instructions may result in a voided warranty, loss of towed vehicle, personal injury or death.

- Do not weld or modify this baseplate or its components. Welding or modification will void the warranty.
- Do not use this document as a basis to design/fabricate a baseplate, as it may not show all parts or structural components.
- We strongly recommend professional installation.
- If the towed vehicle has been in an accident, it must be properly repaired before attaching the baseplate. Do not install the baseplate if any structural frame damage is found.
- The installer must use all bolts and parts supplied. If running changes were made by the vehicle manufacturer after this kit was designed, some bolts or other fasteners may no longer be the correct size. It is the installer's responsibility to verify this kit is securely fastened to the vehicle.
- Use Loctite® Red on all bolts used to secure this baseplate. Torque all bolts to the specifications found at the end of these instructions. Do not over-torque the bolts or failure may occur.
- The installer must inspect the baseplate to ensure adequate clearance, particularly around hoses, air conditioner lines, radiators, etc. or non-warranty failure may result.
- Roadmaster manufactures many styles of baseplates. If your baseplate has removable arms, they must be removed before driving the vehicle, unless the arms can be pinned or padlocked in place. If not secured, the arms could vibrate out.
- Some motorhome chassis have such a tight turning radius that you can damage your motorhome, towed vehicle, tow bar or baseplate while turning sharply. Before getting on the road, test your turning radius in

an empty parking lot. Turning too sharply could result in non-warranty damage to your towing system, motorhome and/or towed vehicle.

- Do not back up with the towed vehicle attached or non-warranty damage will occur to your towing system or vehicles.
- The safety cables must connect the towing vehicle to the towed vehicle frame to frame, with the cables crossed, with enough slack for sharp turns. See cable instructions for proper routing. Failure to do so will result in non-warranty damage and/or the loss of the towed vehicle.
- This kit is designed for use with ROADMASTER tow bars and ROADMASTER adapters only. Using this kit with other brands, without an approved ROADMASTER adapter, may result in non-warranty damage or injury.
- Receiver extensions and out-of-level towing situations of 3 inches or more. This can cause the system to swing much higher and lower, causing excessive strain on the tow bar, baseplate and frame. That can cause the towing system to fail, causing property damage, personal injury or even death. If you must use a receiver extension or drop hitch to tow, it will reduce your receiver's weight capacity by 1/3 to avoid damaging your system. Never use more than one extension and/or drop hitch, as this will void your warranty.
- Every 3,000 miles, the owner must inspect all mounting points for cracks or fatigue, and check the fasteners for proper torque, according to the bolt torque requirements chart on the last page of these instructions.
- The owner must follow the vehicle manufacturer's instructions to prepare the vehicle for towing. Failure to do so may cause severe damage to the vehicle.
- This baseplate is only warranted for the original installation. Installing a used baseplate on another vehicle is not recommended and will void the warranty.

# BASEPLATE KIT INSTALLATION INSTRUCTIONS

ROADMASTER, Inc. 6110 NE 127th Ave. Vancouver, WA 98682 1-800-669-9690 fax 360-735-9300 www.roadmasterinc.com

**KIT NO. 2103-1**

1. **Important: please use all supplied bolts and parts and read all instructions carefully before beginning this installation. The majority of questions you may have can be answered within the text, and proper installation will ensure safe and secure travel.** Now, begin the installation. This bracket kit is one of our XL series which is designed to be partly removable. The kit consists of the main receiver brace, front brace and a hardware pack. The main receiver brace mounts behind the front bumper fascia and lower grille. The front brace inserts through the lower grille under the bumper into the receiver brace on each side. Start by laying the kit out according to the illustration. This will give you a visual idea of how the kit installs and also confirm that the kit components are present and accounted for.
2. Start by removing the head light fasteners (two 10mm bolts per head light). Pull the head lights forward then set out of the way.
3. Remove four plastic fasteners securing the top of the bumper fascia, then remove the 10mm nuts from the fascia bolts on the side of each head light opening.
4. Remove three plastic fasteners underneath located underneath the bumper in the lower grill opening, then remove eight fasteners underneath the front fascia.
5. Pull the fender well splash panel down and remove the screw holding the bumper fascia in each fender well.
6. Remove the front fascia and set aside.
7. Remove two top bolts holding bumper core on each side, then pull bumper forward and set aside.
8. Hold the main receiver brace up to the front of the frame and bolt through the tie down plates on each side with 1/2" x 1 1/2" bolts, plate washers, lock washers and nuts.
9. Make sure the brace is aligned and tight against the bottom of the front frame tubes. Then using the brace as a template drill through the frame on each side. Bolt in position with 1/2" x 4" bolts, 1/4" x 2" x 5" backing plates, lock washers and nuts.
10. Using the front top bumper mount hole in the top of the frame as a guide, drill through the bottom of the frame tube into the mounting tabs hole below the frame on each side.
11. Bolt through these drilled holes with 1/2" x 1 1/4" bolts, lock washers, and nuts.
12. Torque all mounting bolts to the specifications below.
13. Cover the front receiver tubes with shop rags or gloves to prevent marring the plastic grille fascia, then reinstall the bumper core, front bumper fascia and headlights reversing the previous steps one through seven.
14. Insert the front brace into the receiver tubes and pin with 5/8" draw pins and 1/8" spring pins.
15. Install the tow bar according to the manufacturer's instructions and torque all mounting bolts to the specifications below.
16. Attach one end of the included 12" safety cables to the lower front hole in the side mounting plate on each side of the receiver brace with the included cable connectors. Connect the other end to the tow vehicle's safety cables and the tow bar.

Hardware	2- 1/2" plate washers	6- 1/2" nuts
2- 1/2" x 1-1/2" bolts	2- 1/4" x 1-1/2" x 2" backing plates	2- 12" safety cables
2- 1/2" x 4-1/2" bolts	2- 1/2" flat washers	2- cable connectors
2- 1/2" x 1-1/4" bolts	2- 1/4" x 2" x 5" backing plates	2- 5/8" draw pins
2- 1/2" clipped flat washers	6- 1/2" lock washers	2- 1/8" spring pins

## BOLT TORQUE REQUIREMENTS

Note: The torque values represented below are intended as general guidelines. Torque requirements for specific applications may vary. Roadmaster does not warrant this information to be accurate for all applications and disclaims all liability for any claims or damages which may result from its use.

STANDARD BOLTS			METRIC BOLTS			METRIC BOLTS		
Thread Size	Grade	Torque	Thread Size	Grade	Plated/Unplated	Thread Size	Grade	Plated/Unplated
5/16	5	13 ft./lb.	8mm-1.0	8.8	20 ft./lb. 18 ft./lb.	12mm-1.25	8.8	70 ft./lb. 65 ft./lb.
3/8	5	23 ft./lb.	8mm-1.25	8.8	19 ft./lb. 18 ft./lb.	12mm-1.5	8.8	66 ft./lb. 61 ft./lb.
7/16	5	37 ft./lb.	10mm-1.25	8.8	38 ft./lb. 36 ft./lb.	12mm-1.75	8.8	65 ft./lb. 60 ft./lb.
1/2	5	56 ft./lb.	10mm-1.5	8.8	37 ft./lb. 35 ft./lb.	14mm-2.0	8.8	104 ft./lb. 97 ft./lb.
5/8	5	150 ft./lb.						