



BASEPLATE KIT INSTALLATION INSTRUCTIONS

KIT# 2105-1

05/03/04

ROADMASTER, Inc. 6110 NE 127th Ave. Vancouver, WA 98682 1-800-669-9690 fax 360-735-9300 www.roadmasterinc.com

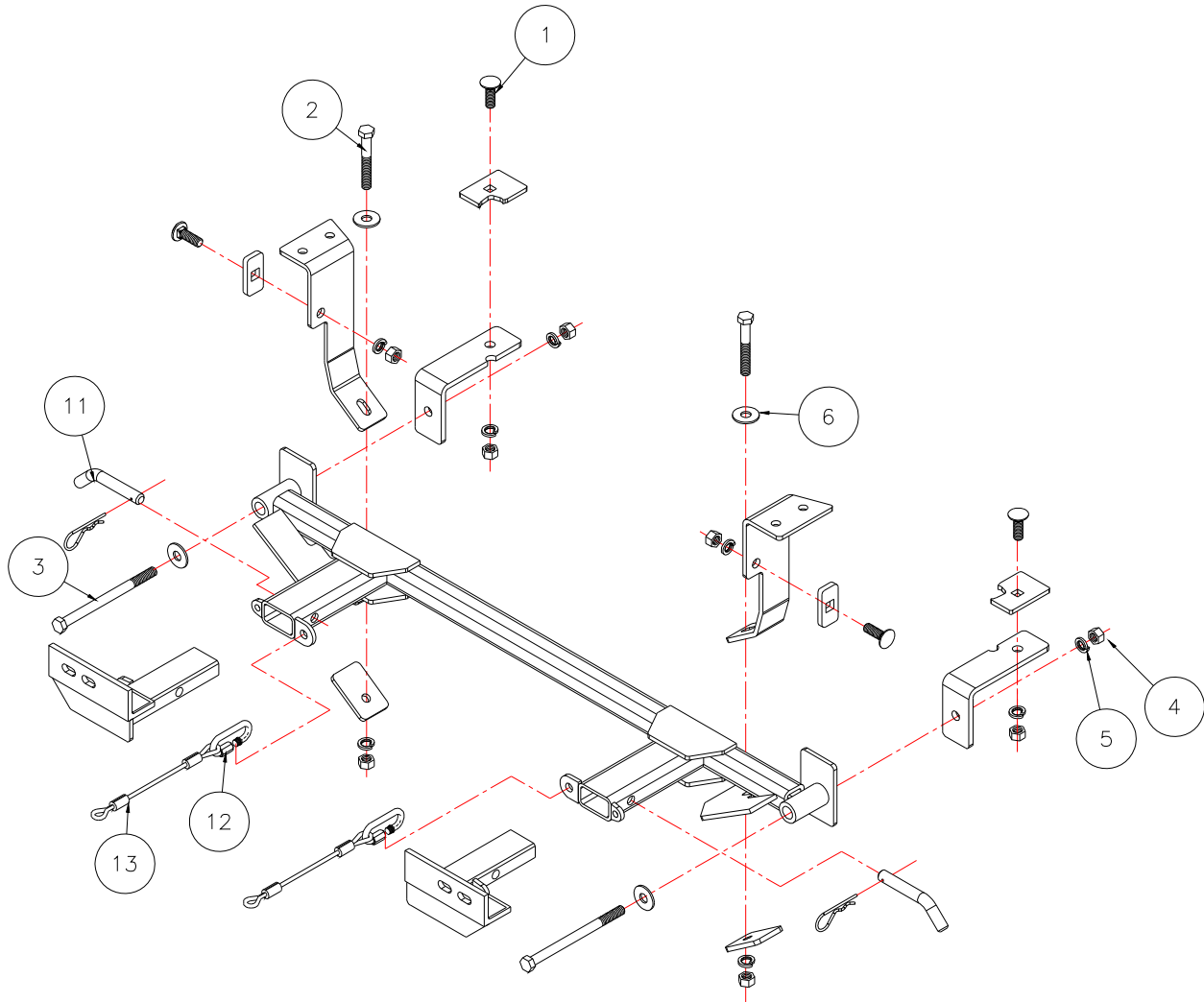

Item	Qty	Length	Width	Hardware	Part No.
1	4	1 1/2"	1/2"	1/2" x 1 1/2" CARRIAGE BOLT	350362-00
2	2	3 1/2"	1 1/2"	1/2" X 3 1/2" BOLT	350103-00
3	2	7"	1/2"	1/2" X 7" BOLTS	350111-00
4	8		1/2"	NUT	350258-00
5	8		1/2"	LOCK WASHER	350309-00
6	4	1/2"	1/2"	FLAT WASHER	350308-20
11	2	1/2"		DRAW PIN/SPRING PIN	357038-00
12	2			CABLE CONNECTORS	200008-00
13	2	8"		CABLES	350646-8
14	1	7"		NYLON TIE U\V BLACK	300140-8

ROADMASTER, INC.



BASEPLATE KIT INSTALLATION INSTRUCTIONS

KIT# 2105-1

05/03/04

ROADMASTER, Inc. 6110 NE 127th Ave. Vancouver, WA 98682 1-800-669-9690 fax 360-735-9300 www.roadmasterinc.com

IMPORTANT: All brackets **must** be assembled with all the bolts left loose for final adjustment & positioning (before tightening) unless otherwise instructed. All bolts **must** be torqued for proper strength. If more than one bolt is used per fastening point, the diagram may only show one.

- Use flat washers over all slotted holes
- Use lock washers on all fasteners

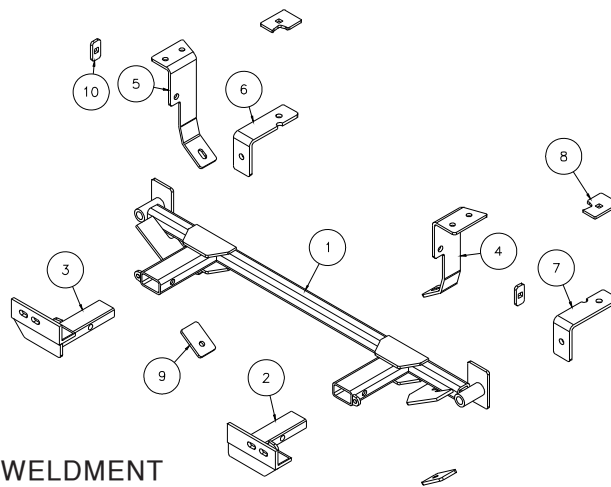

Item	Qty	Part No.	Assembly
1	1	C-000713	...MAIN RECEIVER BRACE WELDMENT
2	1	C-000714	...DRIVER SIDE ARM WELDMENT
3	1	C-000715	...PASSENGER SIDE ARM WELDMENT
4	1	B-000488	...DRIVER SIDE UPPER MOUNTING PLATE
5	1	B-000489	...PASSENGER SIDE UPPER MOUNTING PLATE
6	1	B-000491	...PASSENGER SIDE REAR MOUNTING PLATE
7	1	B-000490	...DRIVER SIDE REAR MOUNTING PLATE
8	2	A-001210	...SHAPED BACKING PLATE

IMPORTANT: All baseplates **must** be assembled with all the bolts left loose for final adjustment and positioning (before tightening) unless otherwise instructed. All bolts **must** be torqued for proper strength. If more than one bolt is used per fastening point, the diagram may only show one. Use flat washers over all slotted holes and lock washers on all fasteners.

WARNING

Failure to heed these warnings or follow the installation instructions may result in a voided warranty, loss of towed vehicle, personal injury or death.

- Do not weld or modify this baseplate or its components. Welding or modification will void the warranty.
- Do not use this document as a basis to design/fabricate a baseplate, as it may not show all parts or structural components.
- We strongly recommend professional installation.
- If the towed vehicle has been in an accident, it must be properly repaired before attaching the baseplate. Do not install the baseplate if any structural frame damage is found.
- The installer must use all bolts and parts supplied. If running changes were made by the vehicle manufacturer after this kit was designed, some bolts or other fasteners may no longer be the correct size. It is the installer's responsibility to verify this kit is securely fastened to the vehicle.
- Use Loctite® Red on all bolts used to secure this baseplate. Torque all bolts to the specifications found at the end of these instructions. Do not over-torque the bolts or failure may occur.
- The installer must inspect the baseplate to ensure adequate clearance, particularly around hoses, air conditioner lines, radiators, etc. or non-warranty failure may result.
- Roadmaster manufactures many styles of baseplates. If your baseplate has removable arms, they must be removed before driving the vehicle, unless the arms can be pinned or padlocked in place. If not secured, the arms could vibrate out.
- Some motorhome chassis have such a tight turning radius that you can damage your motorhome, towed vehicle, tow bar or baseplate while turning sharply. Before getting on the road, test your turning radius in an empty parking lot. Turning too sharply could

result in non-warranty damage to your towing system, motorhome and/or towed vehicle.

- Do not back up with the towed vehicle attached or non-warranty damage will occur to your towing system or vehicles.
- The safety cables must connect the towing vehicle to the towed vehicle frame to frame, with the cables crossed, with enough slack for sharp turns. See cable instructions for proper routing. Failure to do so will result in non-warranty damage and/or the loss of the towed vehicle.
- This kit is designed for use with ROADMASTER tow bars and ROADMASTER adapters only. Using this kit with other brands, without an approved ROADMASTER adapter, may result in non-warranty damage or injury.
- Receiver extensions and out-of-level towing situations of 3 inches or more. This can cause the system to swing much higher and lower, causing excessive strain on the tow bar, baseplate and frame. That can cause the towing system to fail, causing property damage, personal injury or even death. If you must use a receiver extension or drop hitch to tow, it will reduce your receiver's weight capacity by 1/3 to avoid damaging your system. Never use more than one extension and/or drop hitch, as this will void your warranty.
- Every 3,000 miles, the owner must inspect all mounting points for cracks or fatigue, and check the fasteners for proper torque, according to the bolt torque requirements chart on the last page of these instructions.
- The owner must follow the vehicle manufacturer's instructions to prepare the vehicle for towing. Failure to do so may cause severe damage to the vehicle.
- This baseplate is only warranted for the original installation. Installing a used baseplate on another vehicle is not recommended and will void the warranty.

T E R, I N C.



BASEPLATE KIT INSTALLATION INSTRUCTIONS

KIT# 2105-1

05/03/04

ROADMASTER, Inc. 6110 NE 127th Ave. Vancouver, WA 98682 1-800-669-9690 fax 360-735-9300 www.roadmasterinc.com

ROADMASTER, INC.

This bracket kit is one of our XL series, (FIG.A) which is designed to be partly removable. The kit consists of the main receiver brace, two front arm braces, two upper braces, two rear mounting plates and a hardware pack. The main receiver brace mounts behind the front bumper fascia to the inside of the frame. The upper braces attach to the inside of the frame on each side. The front arm braces insert into the receivers on each side. Start by laying the kit out according to the illustration. This will give you a visual idea of how the kit installs and also confirm that all the components are present and accounted for.

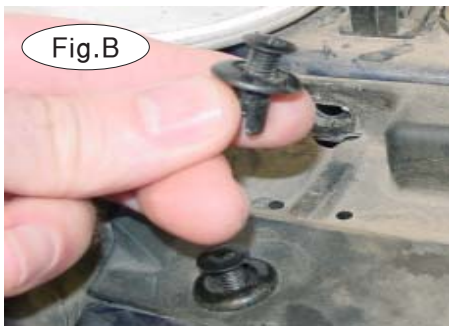

1. **Important:** please use all supplied bolts and parts and read all instructions carefully before beginning this installation. The majority of questions you may have can be answered within the text, and proper installation will ensure safe and secure travel. Now, begin the installation. Start by removing twelve plastic fasteners in the top of the front grille cover (FIG.B,C), then remove the cover and set aside (FIG.D).

2. Remove three (10mm head) screws from each headlight (FIG.E), then disconnect (FIG.F) and set aside.





BASEPLATE KIT INSTALLATION INSTRUCTIONS

KIT# 2105-1

05/03/04

ROADMASTER, Inc. 6110 NE 127th Ave. Vancouver, WA 98682 1-800-669-9690 fax 360-735-9300 www.roadmasterinc.com

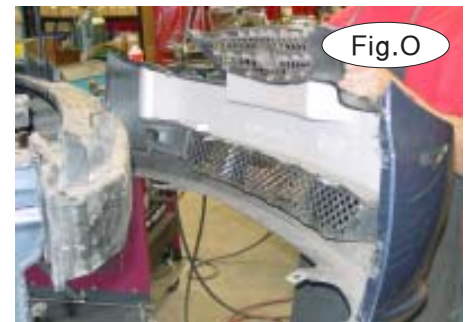
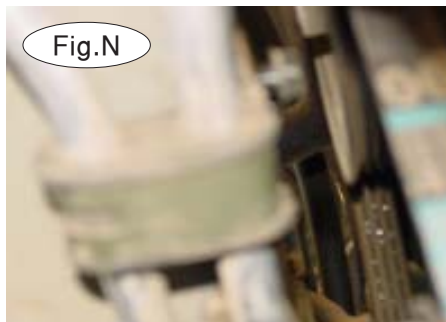

3. Remove two plastic fasteners in the top of the fascia on each side (Fig.G).
4. Now remove four (10mm head) bolts holding the fascia to the fenders on each side (FIG.H).
5. Remove four plastic fasteners in the bottom of the fascia, two on each side (FIG.I,J).
6. Remove four more plastic fasteners just below the bumper core (FIG.K).
7. Remove six (10mm head) in the front of the bottom splash panels (FIG.L) then remove a plastic fastener in each side panel so they will hang down on each side (FIG.M).
8. Remove a (10mm head) bolt holding the power steering lines (FIG.N).
9. Now pull forward on the fascia and remove the fascia and shock absorption foam (Fig.O).



BASEPLATE KIT INSTALLATION INSTRUCTIONS

KIT# 2105-1

05/03/04

ROADMASTER, Inc. 6110 NE 127th Ave. Vancouver, WA 98682 1-800-669-9690 fax 360-735-9300 www.roadmasterinc.com



Fig.P



Fig.Q



Fig.R



Fig.S



Fig.T

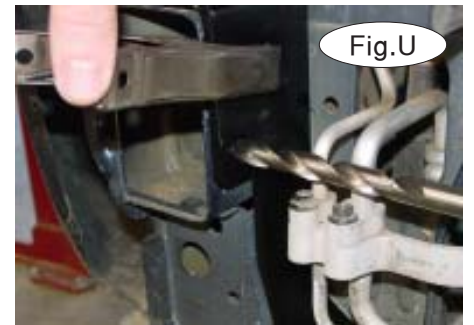

Fig.U

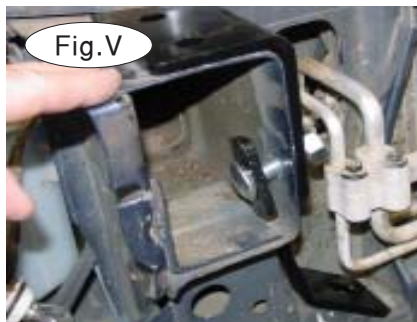

Fig.V

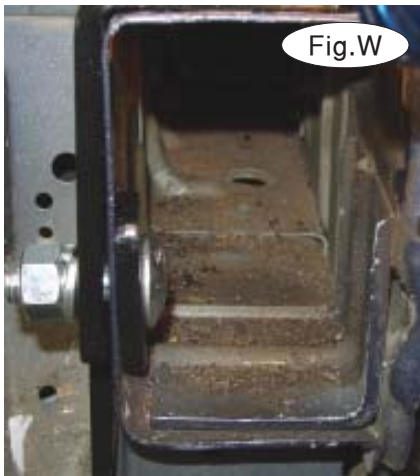

Fig.W



Fig.X

10. Remove the lower grille from the fascia (six phillips screws and metal clips – FIG.P,Q) then set aside for now.
11. Remove the bumper core (four 14mm head bolts) two on each side (FIG.R,S) then set aside.
12. Working on both sides, clamp the side support brackets over the frames with the top holes lined up with existing holes (FIG.T).
13. Drill side holes using brace as template (FIG.U).
14. Bolt the side support braces to the frames with a 1/2" x 1 1/2" carriage bolts and 1" x 2" backing plates in the frames (FIG.V).
15. While in this area, find two 1/2" x 1 1/2" carriage bolts and shaped backing plates then insert into existing frame holes approximately 8" from the front of the frames (FIG.W,X).



BASEPLATE KIT INSTALLATION INSTRUCTIONS

KIT# 2105-1

05/03/04

ROADMASTER, Inc. 6110 NE 127th Ave. Vancouver, WA 98682 1-800-669-9690 fax 360-735-9300 www.roadmasterinc.com

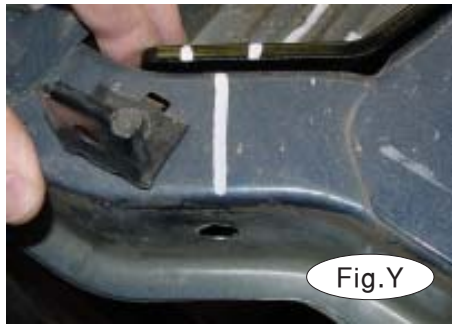

Fig.Y



Fig.Z



Fig.AA



Fig.BB



Fig.CC

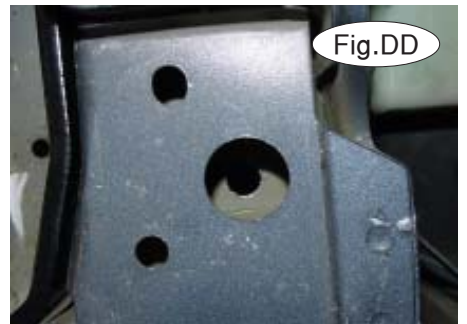

Fig.DD

16. Moving to the lower frame, find the lower holes in the side plates on the top of the lower frame and mark hole centers as shown (FIG.Y,Z).

17. Make center marks on the bottom of the frames, then drill through the frames and the side plate on each side (FIG.AA).

18. Now move to the bottom of the frame behind the radiator core support and bolt the rear mounting plates to the inside bottom of the frames using $\frac{1}{2}$ " nuts and lock washers on the bolts inserted in step 14 (FIG.BB).

19. Using the rear mounting plates as drill templates, drill through the back of the radiator core support on each side (FIG.CC,DD).

20. Set the main receiver brace on top the installed upper mounting plates against the front of the radiator core support and bolt through the radiator core support, the main receiver brace and the rear mounting plates with $\frac{1}{2}$ " x 7" bolts, flat washers, lock washers and nuts on both sides (FIG.EE).

21. Now bolt down through the main receiver brace, upper mounting plates, radiator support and backing plates with $\frac{1}{2}$ " x 3 $\frac{1}{2}$ " bolts, flat washers, lock washers and nuts on both sides (FIG.EE).

22. Now bolt down through the main receiver brace, upper mounting plates, radiator support and backing plates with $\frac{1}{2}$ " x 3 $\frac{1}{2}$ " bolts, flat washers, lock washers and nuts on both sides (FIG.EE).

23. Torque all mounting bolts to the specification at the end of the instructions.

24. Remount the bumper core reversing step 11 (FIG.HH).

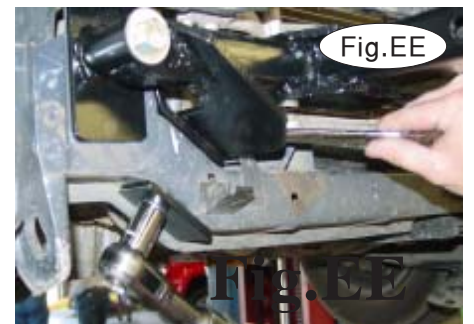

Fig.EE

ROADMASTER, INC.

BASEPLATE KIT INSTALLATION INSTRUCTIONS

KIT# 2105-1

05/03/04



ROADMASTER, Inc. 6110 NE 127th Ave. Vancouver, WA 98682 1-800-669-9690 fax 360-735-9300 www.roadmasterinc.com

ROADMASTER, INC.



Fig.HH



Fig.II



Fig.JJ

25. Check the power steering cooler lines for clearance then zip tie as shown to stabilize the lines (FIG.II). This will replace the bolt removed in step 8.

26. Trim the lower splash shield to fit (FIG.JJ).

27. Trial fit the fascia then hold the lower grille in front of the main brace and trim to fit (FIG.KK).

28. Remove the fascia, install the grille in the fascia then reinstall the fascia, headlights and lower splash panels reversing steps 1 through 10 (FIG.KK).



Fig.KK

29. Insert the front braces into the receiver tubes and pin with 5/8" draw pins and spring pins (FIG.LL).

30. Install the tow bar according to the manufacturer's instructions.

31. Attach the ends of the 8" safety cables to front holes on each side of the receiver brace with the included cable connectors. Connect the other end to the tow vehicle's safety cables and tow bar.



Fig.LL

BOLT TORQUE REQUIREMENTS

Note: The torque values represented below are intended as general guidelines. Torque requirements for specific applications may vary. Roadmaster does not warrant this information to be accurate for all applications and disclaims all liability for any claims or damages which may result from its use.

STANDARD BOLTS			METRIC BOLTS			METRIC BOLTS		
Thread Size	Grade	Torque	Thread Size	Grade	Plated/Unplated	Thread Size	Grade	Plated/Unplated
5/16	5	13 ft./lb.	8mm-1.0	8.8	20 ft./lb. 18 ft./lb.	12mm-1.25	8.8	70 ft./lb. 65 ft./lb.
3/8	5	23 ft./lb.	8mm-1.25	8.8	19 ft./lb. 18 ft./lb.	12mm-1.5	8.8	66 ft./lb. 61 ft./lb.
7/16	5	37 ft./lb.	10mm-1.25	8.8	38 ft./lb. 36 ft./lb.	12mm-1.75	8.8	65 ft./lb. 60 ft./lb.
1/2	5	56 ft./lb.	10mm-1.5	8.8	37 ft./lb. 35 ft./lb.	14mm-2.0	8.8	104 ft./lb. 97 ft./lb.
5/8	5	150 ft./lb.						

All illustrations and specifications contained herein are based on the latest information available at the time of publication approval. ROADMASTER, INC. reserves the right to make changes at any time without notice in material, specification and models or to discontinue models.