



# BASEPLATE KIT INSTALLATION INSTRUCTIONS

**KIT# 2109-1**

01/04/11  
KS

ROADMASTER, Inc. 6110 NE 127th Ave. Vancouver, WA 98682 1-800-669-9690 fax 360-735-9300 www.roadmasterinc.com

ROADMASTER, INC.

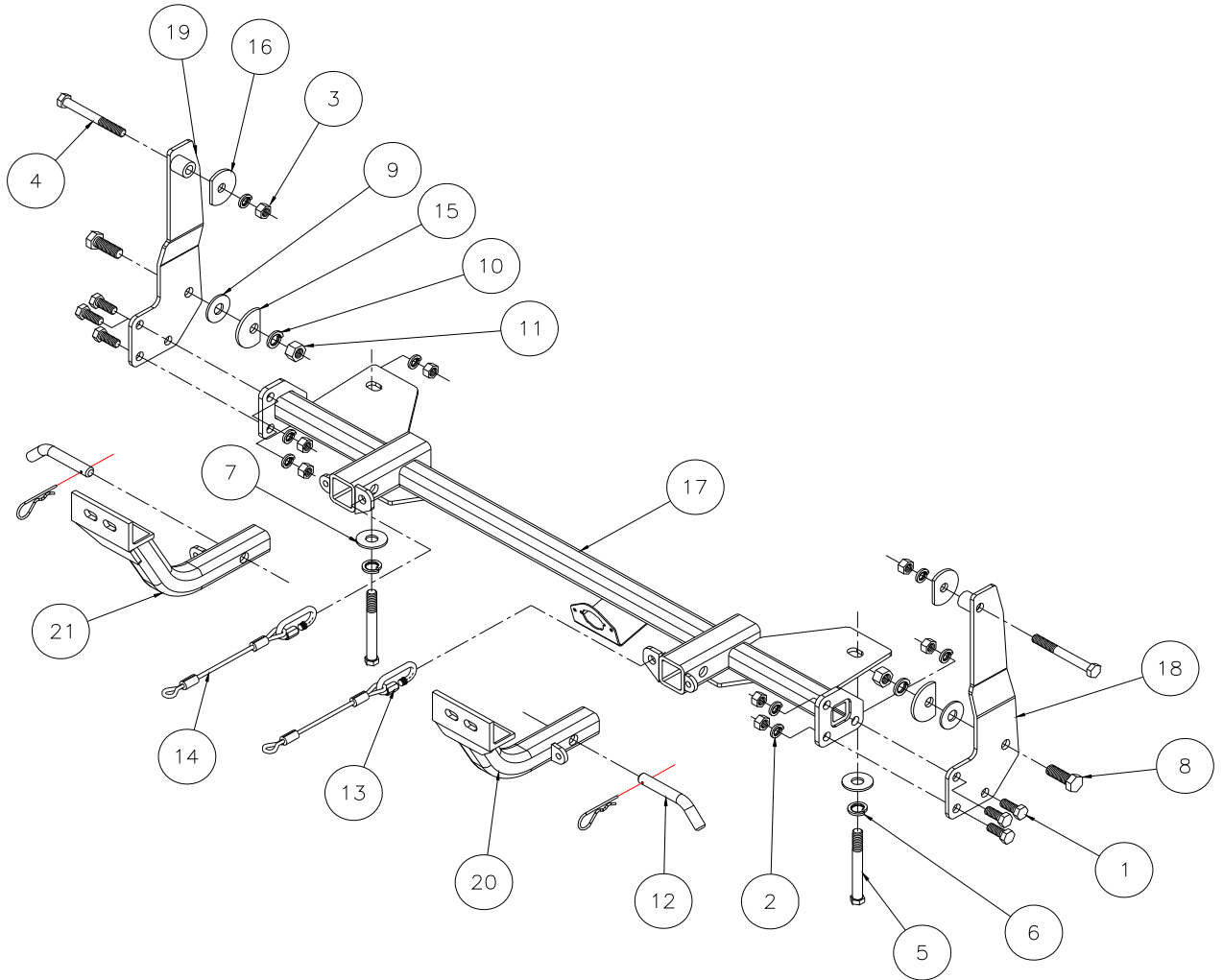

ITEM	QTY	NAME	MATERIAL
1	6	1/2" x 1 1/4" BOLT	350094-10
2	8	1/2" LOCK WASHER	350309-00
3	8	1/2" HEX NUT	350258-00
4	2	1/2" x 4 1/2" BOLT	350106-00
5	2	14mm x 1.5 x130 mm BOLT	357213-00
6	2	14mm LOCK WASHER	355740-00
7	2	14mm FENDER WASHER	355741-00
8	2	5/8" x1 3/4" BOLT	350149-00
9	2	5/8" FLAT WASHER	350348-00
10	2	5/8" LOCK WASHER	350313-00
11	2	5/8" HEX NUT	350262-00
12	2	DRAW PIN W/ CLIP	357035-00
13	2	QUICK LINK	200008-00
14	2	10" SAFETY CABLE	650646-10
15	2	CLIPPED 5/8" PLATE WASHER	A-002035
16	2	CLIPPED 1/2" PLATE WASHER	A-002687
17	1	MAIN RECEIVER	C-001251
18	1	DRIVER SIDE PLATE	C-001252
19	1	PASSENGER SIDE PLATE	C-001253
20	1	DRIVER SIDE ARM	C-001254
21	1	PASSENGER SIDE ARM	C-001255



# BASEPLATE KIT INSTALLATION INSTRUCTIONS

**KIT# 2109-1**

01/04/11  
KS

ROADMASTER, Inc. 6110 NE 127th Ave. Vancouver, WA 98682 1-800-669-9690 fax 360-735-9300 www.roadmasterinc.com

This is one of our XL series brackets, which allows the visible front portion of the bracket to be easily removed from the front of the vehicle (Fig.A and Fig.B). The bracket kit consists of a main receiver brace, two side braces, two removable front braces and a hardware pack. The main receiver brace mounts to the subframe. The two side braces mount to the main receiver brace, the tow hooks and the frame rails. The removable front braces install in the main receiver brace.

Before starting the installation, lay out the kit components in order, as they will be used. This will give you a visual idea of how the components work, and will also confirm that everything is present and accounted for.



**IMPORTANT:** All baseplates **must** be assembled with all the bolts left loose for final adjustment and positioning (before tightening) unless otherwise instructed. All bolts **must** be torqued for proper strength. If more than one bolt is used per fastening point, the diagram may only show one. Use flat washers over all slotted holes and lock washers on all fasteners.

## WARNING

Failure to heed these warnings or follow the installation instructions may result in a voided warranty, loss of towed vehicle, personal injury or death.

- Do not weld or modify this baseplate or its components. Welding or modification will void the warranty.
- Do not use this document as a basis to design/fabricate a baseplate, as it may not show all parts or structural components.
- We strongly recommend professional installation.
- If the towed vehicle has been in an accident, it must be properly repaired before attaching the baseplate. Do not install the baseplate if any structural frame damage is found.
- The installer must use all bolts and parts supplied. If running changes were made by the vehicle manufacturer after this kit was designed, some bolts or other fasteners may no longer be the correct size. It is the installer's responsibility to verify this kit is securely fastened to the vehicle.
- Use Loctite® Red on all bolts used to secure this baseplate. Torque all bolts to the specifications found at the end of these instructions. Do not over-torque the bolts or failure may occur.
- The installer must inspect the baseplate to ensure adequate clearance, particularly around hoses, air conditioner lines, radiators, etc. or non-warranty failure may result.
- Roadmaster manufactures many styles of baseplates. If your baseplate has removable arms, they must be removed before driving the vehicle, unless the arms can be pinned or padlocked in place. If not secured, the arms could vibrate out.
- Some motorhome chassis have such a tight turning radius that you can damage your motorhome, towed vehicle, tow bar or baseplate while turning sharply. Before getting on the road, test your turning radius in an empty parking lot. Turning too sharply could result in non-warranty damage to your towing system, motorhome and/or towed vehicle.
- Do not back up with the towed vehicle attached or non-warranty damage will occur to your towing system or vehicles.
- The safety cables must connect the towing vehicle to the towed vehicle frame to frame, with the cables crossed, with enough slack for sharp turns. See cable instructions for proper routing. Failure to do so will result in non-warranty damage and/or the loss of the towed vehicle.
- This kit is designed for use with ROADMASTER tow bars and ROADMASTER adapters only. Using this kit with other brands, without an approved ROADMASTER adapter, may result in non-warranty damage or injury.
- Receiver extensions and out-of-level towing situations of 3 inches or more. This can cause the system to swing much higher and lower, causing excessive strain on the tow bar, baseplate and frame. That can cause the towing system to fail, causing property damage, personal injury or even death. If you must use a receiver extension or drop hitch to tow, it will reduce your receiver's weight capacity by 1/3 to avoid damaging your system. Never use more than one extension and/or drop hitch, as this will void your warranty.
- Every 3,000 miles, the owner must inspect all mounting points for cracks or fatigue, and check the fasteners for proper torque, according to the bolt torque requirements chart on the last page of these instructions.
- The owner must follow the vehicle manufacturer's instructions to prepare the vehicle for towing. Failure to do so may cause severe damage to the vehicle.
- This baseplate is only warranted for the original installation. Installing a used baseplate on another vehicle is not recommended and will void the warranty.



# BASEPLATE KIT INSTALLATION INSTRUCTIONS

**KIT# 2109-1**

01/04/11  
KS

ROADMASTER, Inc. 6110 NE 127th Ave. Vancouver, WA 98682 1-800-669-9690 fax 360-735-9300 www.roadmasterinc.com



1. **Important:** please use all supplied bolts and parts and read all instructions carefully before beginning this installation. The majority of questions you may have can be answered within the text, and proper installation will ensure safe and secure travel. Now, begin the installation by removing the radiator overflow bottle (The overflow bottle will obstruct an attachment in a later step.) – first, remove the cap and pull out the hose (Fig.C). Then, lift the bottle straight up and away (Fig.D).

2. Next, on each side, remove four plastic fasteners holding the lower fender liner to the fascia (Fig.E).

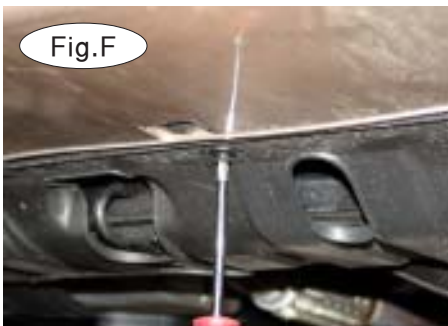

3. Remove four plastic fasteners toward the front of the center splash shield (Fig.F), and four 10mm (head) bolts toward the rear of the center splash shield (Fig.G). Then, remove the center splash shield (Fig.H).

4. Support the subframe (Fig.I).

5. On each side, remove a 19mm (head) subframe bolt, and the bushing cup (Fig.J).



For '05-'06 Kia Spectra EX and LX and '05 to '09 Kia Spectra 5 models, proceed to step 9 in these instructions.

## For 2007 to 2009 Kia Spectra EX and LX models only

If the vehicle is a 2007 Kia Spectra EX or LX model, the fascia will require trimming to allow for clearance of the braces. Follow steps 6 through 8 below. If the vehicle is not a 2007 to 2009 Kia Spectra EX or LX model, proceed to step 9 in these instructions.

6. Pull out and forward to remove the fascia.

7. Using the yellow lines in Figure K as a reference, trim the fascia to allow for clearance of the side brace, as shown in Figure L.

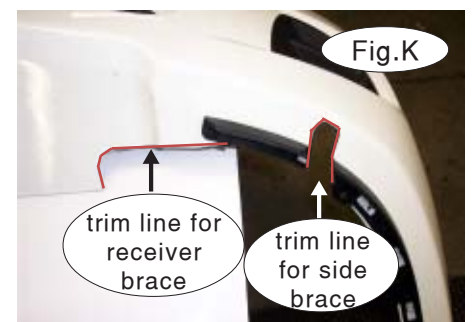



# BASEPLATE KIT INSTALLATION INSTRUCTIONS

**KIT# 2109-1**

01/04/11  
KS

ROADMASTER, Inc. 6110 NE 127th Ave. Vancouver, WA 98682 1-800-669-9690 fax 360-735-9300 www.roadmasterinc.com

8. Using the yellow lines in Figure K as a reference, trim the fascia to allow for clearance of the receiver brace, as shown in Figure M.

This completes the fascia trimming on the 2007 to 2009 Kia Spectra EX and LX models. Now, proceed to the following step to finish the installation of the bracket.



Fig.L



Fig.M



Fig.N



Fig.O



Fig.P

9. Next, place the two bushing cups over the pre-drilled holes at each end of the main receiver brace (Fig.N). Then, slide a 14mm lock washer and flat washer over both of the supplied 14mm x 1.5 x 130mm bolts, and slide the bolts through the main receiver brace and the bushing cups (Fig.N). Apply thread lock to the bolts.

10. Move the main receiver brace under the subframe, and align the two 14mm x 1.5 x 30mm bolts to the holes for the factory subframe bolts you removed in step 5. Tighten both of the bolts, only enough to hold the main receiver brace in position. For the **2005 to 2009 Spectra 5 model**: If the vehicle is equipped with a front spoiler the spoiler will need to be trimmed. This will allow for clearance of the receiver, arm and end plate. This will need to be done before you can tighten the main receiver brace. Refer to Figure O and use the yellow marker line as a guide for trimming. Repeat for the other side. Figure P shows the driver side subframe attachment. Leave the subframe support in place. Center the main receiver brace between the tow hooks (Fig.O).

11. Before attaching the side braces, trim a small portion of the lower fascia (Fig.R, circled) on each side, to allow clearance. Trim and then test-fit the side braces, until you have trimmed enough material. (The braces will fit only one side of the vehicle – the welded pipe spacers at the top will fit against the frame rails.)

12. The side braces are bolted to the main receiver brace, to the tow hooks, and also to the frame rails. First, attach them to the main receiver brace, through the three pre-drilled holes at each end of the main receiver brace (Fig.R). Use three of the supplied 1/2" x 1 1/4" bolts, lock washers and nuts for each brace. Figure S shows the three passenger-side bolts in place. Finger-tighten only at this time.



# BASEPLATE KIT INSTALLATION INSTRUCTIONS

**KIT# 2109-1**

01/04/11  
KS

ROADMASTER, Inc. 6110 NE 127th Ave. Vancouver, WA 98682 1-800-669-9690 fax 360-735-9300 www.roadmasterinc.com

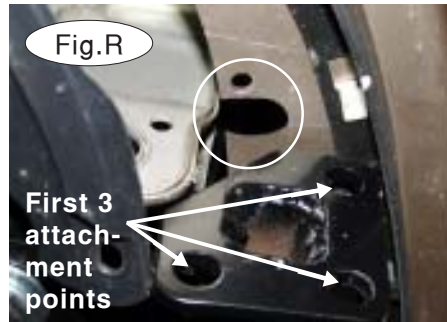
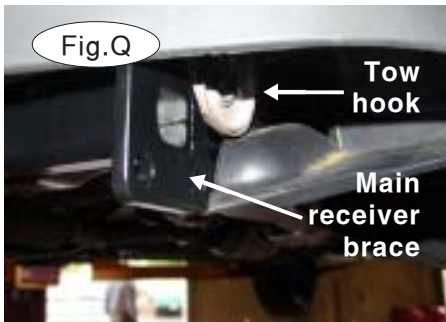

13. Now, attach the side braces to the tow hooks – for each side, position one of the supplied 5/8" flat washers between the side brace and the tow hook, so that the hole in the washer aligns to the pre-drilled hole in the side brace. Now, position one of the supplied 5/8" cut plate washers next to the tow hook, so that it aligns over the same hole (Fig.T). Bolt through the side brace and the tow hook with one of the supplied 5/8" x 1 3/4" bolts, lock washers and nuts. Figure Q shows the passenger side attachment. Finger-tighten only at this time.

14. Now, attach one of the side braces to the frame rail – the top hole in each side brace aligns to an existing hole through both sides of the frame rail. From the outside of the frame rail, slide one of the supplied 1/2" x 4 1/2" bolts through the side brace and both sides of the frame rail. From the inside of the frame rail, secure the bolt with a 1/2" cut plate washer, lock washer and nut. Tighten the bolt from the inside, using a ratchet or air ratchet. Repeat for the other side.

15. Starting with the subframe bolts, torque all bolts to the specifications at the bottom of these instructions.

16. Reassemble the center splash shield, the lower fender liners, and the radiator overflow bottle by reversing steps 1 through 3.

Note: the two plastic fasteners on the outside of the center splash shield will not be replaced.

Note: in order to accommodate the side braces, it will be necessary to trim a small portion of both lower fender liners. Refer to Figure U.

17. Fit the front bracket arms into the front receiver braces, and secure them in place with the supplied 5/8" draw pins and spring pins (Fig.V).

18. Attach the 10" safety cables with the cable connectors (Q-Links) to the front of the receiver braces (Fig.V).

19. Attach the ends of the safety cables to the tow vehicle's safety cables and tow bar.

20. Install the tow bar to the mounting bracket according to the manufacturer's instructions.

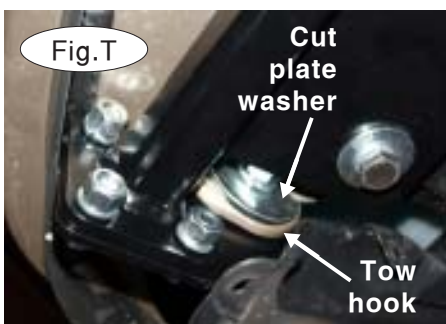



# BASEPLATE KIT INSTALLATION INSTRUCTIONS

**KIT# 2109-1**

01/04/11  
KS

ROADMASTER, Inc. 6110 NE 127th Ave. Vancouver, WA 98682 1-800-669-9690 fax 360-735-9300 www.roadmasterinc.com

## BOLT TORQUE REQUIREMENTS

Note: The torque values represented below are intended as general guidelines. Torque requirements for specific applications may vary. Roadmaster does not warrant this information to be accurate for all applications and disclaims all liability for any claims or damages which may result from its use.

### STANDARD BOLTS

Thread Size	Grade	Torque
5/16	5	13 ft./lb.
3/8	5	23 ft./lb.
7/16	5	37 ft./lb.
1/2	5	56 ft./lb.
5/8	5	150 ft./lb.

### METRIC BOLTS

Thread Size	Grade	Plated / Unplated
8mm-1.0	8.8	20 ft./lb. 18 ft./lb.
8mm-1.25	8.8	19 ft./lb. 18 ft./lb.
10mm-1.25	8.8	38 ft./lb. 36 ft./lb.
10mm-1.5	8.8	37 ft./lb. 35 ft./lb.

### METRIC BOLTS

Thread Size	Grade	Plated / Unplated
12mm-1.25	8.8	70 ft./lb. 65 ft./lb.
12mm-1.5	8.8	66 ft./lb. 61 ft./lb.
12mm-1.75	8.8	65 ft./lb. 60 ft./lb.
14mm-2.0	8.8	104 ft./lb. 97 ft./lb.

All illustrations and specifications contained herein are based on the latest information available at the time of publication approval. ROADMASTER, INC. reserves the right to make changes at any time without notice in material, specification and models or to discontinue models.