



# MOUNTING BRACKET KIT INSTALLATION INSTRUCTIONS

ROADMASTER, Inc. 6110 NE 127th Ave. Vancouver, WA 98682 1-800-669-9690 fax 360-735-9300 www.roadmasterinc.com

## PARTS LIST:

- 1- FRONT BRACE (A) - Passenger side
- 1- FRONT BRACE (B) - Driver's side
- 1- MAIN BRACE (C)
- 1- WIRE PLUG CONNECTOR BRACKET (D)

KIT NO. 262-1

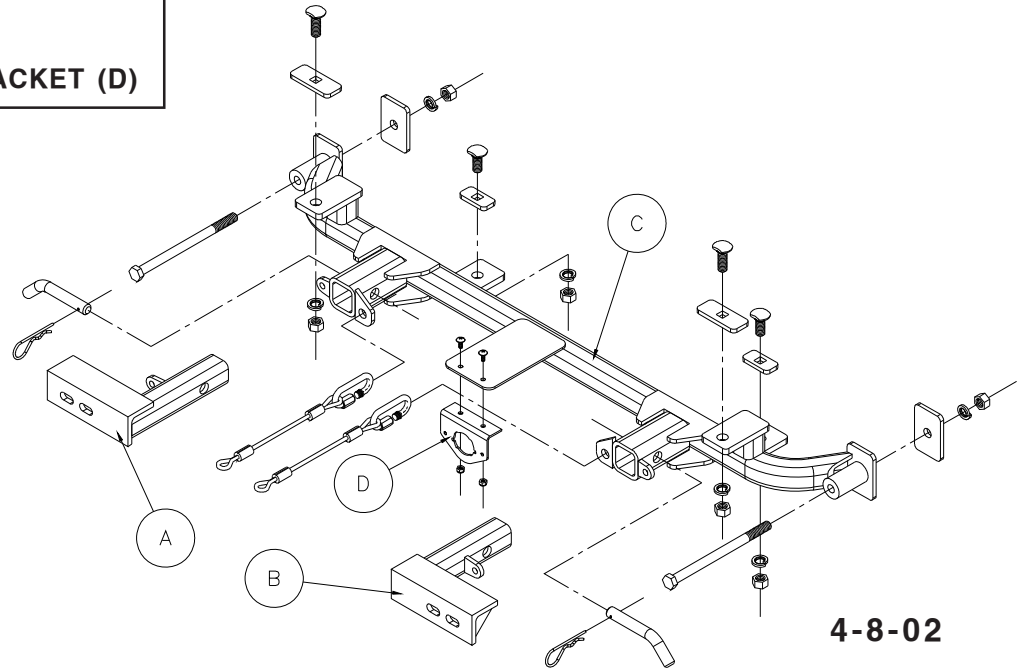

4-8-02

**IMPORTANT:** All brackets **must** be assembled with all the bolts left loose for final adjustment and positioning (before tightening) unless otherwise instructed. All bolts **must** be torqued for proper strength. If more than one bolt is used per fastening point, the diagram may only show one.

- Use flat washers over all slotted holes
- Use lock washers on all fasteners

ROADMASTER Limited Warranty, including One-Year Conditional Warranty Text and Product Registration Card, in Carton.



## WARNING

- Do not use this document for custom fabrication, as it may not show all parts or structural components. Custom fabrication or an attempt to copy this bracket design could result in loss of the towed vehicle.
- The owner must inspect all mounts and brackets before each use for cracks or other signs of fatigue. Also, inspect the fasteners for proper torque, according to the bolt torque requirements chart on the last page. Failure to do so could result in loss of the towed vehicle.
- The owner must check the manufacturer's instructions for the proper procedure(s) to prepare the vehicle for towing. Some vehicles must be equipped with a transmission lube pump, an axle disconnect, driveline disconnect or free-wheeling hubs before they can be towed. Failure to properly equip the vehicle will cause severe damage to the transmission.
- The installer must read the instructions and use all bolts and parts supplied. Failure to securely fasten the bracket could result in loss of the towed vehicle.
- If running changes were made by the vehicle manufacturer after this bracket was designed, some bolts or other fasteners in the included hardware pack may no longer be the correct size. It is the installer's responsibility to verify that the bracket is securely fastened to the vehicle, and fitted with the correct hardware, to account for these changes. Failure to securely fasten the bracket could result in loss of the towed vehicle.
- If the towed vehicle has been in an accident, it must be properly repaired before attaching the bracket. Do not install the bracket if any structural frame damage is found. Failure to repair the damage may result in the loss of the towed vehicle.

- Some motorhome chassis have such a tight turning radius that you can damage your motorhome, towed vehicle, tow bar or bracket while turning sharply. Before getting on the road, test your turning radius in an empty parking lot. Turning too sharply could result in non-warranty damage to towing system, motorhome and/or towed vehicle.
- Do not back up with the towed vehicle attached or non-warranty damage will occur to your towing system, motorhome and/or towed vehicle.
- The safety cables must connect the towing vehicle to the towed vehicle frame to frame, with the cables crossed, with enough slack for sharp turns. Refer to the cable instructions for proper routing. Failure to leave enough slack in the safety cables, or failure to connect the safety cables frame to frame, will result in the loss of the towed vehicle.
- This bracket is designed for use with ROADMASTER tow bars and ROADMASTER adaptors only. Using this bracket with other brands, without an approved ROADMASTER adaptor, may result in non-warranty damage or injury.
- Upon final installation, the installer must inspect the bracket to ensure adequate clearance, particularly around hoses, air conditioner lines, radiators, etc., or non-warranty damage to the towed vehicle will result.
- This bracket is only warranted for the original installation. Installing a used bracket on another vehicle is not recommended and will void the warranty.



## WARNING

Failure to follow these instructions can result in property damage, personal injury or even death.

# MOUNTING BRACKET KIT INSTALLATION INSTRUCTIONS

ROADMASTER, Inc. 6110 NE 127th Ave. Vancouver, WA 98682 1-800-669-9690 fax 360-735-9300 www.roadmasterinc.com

**KIT NO. 262-1**

1. This bracket kit is one of our XL Series, which is hidden for the most part behind the front bumper fascia and grille. The kit consists of a receiver brace, two front braces and a hardware kit. The front braces install in the receiver braces and are pinned in place 5/8" draw pins and spring pins. Start by laying the kit out and making sure all the components are present. *Note:* this bracket kit is not designed to fit fog-light equipped vehicles.
2. Remove the headlights, (three 8mm head bolts each). Set these back in the engine compartment or disconnect and set aside.
3. The combination bumper grille and fascia will have to be removed to install the receiver brace. Start at the top of the grille by pulling two plastic fasteners and two (10mm head bolts) located on each side adjacent to the headlights.
4. Look along the side of the headlight cavity on each side and locate the 8mm nut at the junction of the fascia and the front fender sheet metal. Remove these nuts.
5. Follow the junction of the bumper skin and front fenders to the front of the fender wells and remove a Phillip head screw and a (10mm head) screw inside each fender well.
6. Remove five (10mm head) bolts from the back of the lower splashguard.
7. Now pull the fascia forward and off.
8. Unbolt the ambient air sensor (10mm head screw) from its holder and leave hanging for now.
9. Enlarge two existing holes in the bottom of the bumper core located approximately 6" from the ends to 17/32".
10. Fish wire two 1/2" x 1 1/2" ground head carriage bolts with 1/4" x 1 1/4" 3" sq. hole backing plates into the holes.
11. Hold the receiver brace to the front of the radiator subframe and the bottom of the bumper core. Bolt under the bumper core using 1/2" nuts and lock washers.
12. Check the alignment, then using the receiver brace as a drill template drill two 17/32" holes through the lower radiator cross member, and a 17/32" hole through each side frame. *Note:* use backing plates when drilling to avoid component damage.
13. Bolt through the side frames with 1/2" x 7 1/2" bolts, 1/4" x 2" x 3" backing plates, lock washers and nuts.
14. Enlarge two existing access holes in the bottom of the lower radiator cross member so that 1/4" x 1" x 2" backing plates and 1/2" x 1 1/4" ground head carriage bolts can be fish wired through these holes into the holes drilled in step 11.
15. Fish wire these bolts and backing plates into place then finish with 1/2" nuts and lock washers.
16. Torque all bolts to the specifications below. Do not over tighten.
17. Reinstall the ambient air sensor on its holder by reversing it so it hangs slightly lower to clear the receiver brace.
18. Hold the bumper fascia in position and mark the lower horizontal grille ribs on each side for trimming, then trim to clear the receiver braces.
19. Now reinstall the fascia by reversing steps 1 through 7.

**CAUTION:** Installer must read instructions and use all bolts and parts supplied.

4-8-02

FAILURE TO FOLLOW THESE INSTRUCTIONS CAN RESULT IN DEATH, PERSONAL INJURY OR PROPERTY DAMAGE

## BOLT TORQUE REQUIREMENTS

Note: The torque values represented below are intended as general guidelines. Torque requirements for specific applications may vary. Roadmaster does not warrant this information to be accurate for all applications and disclaims all liability for any claims or damages which may result from its use.

STANDARD BOLTS			METRIC BOLTS			METRIC BOLTS		
Thread Size	Grade	Torque	Thread Size	Grade	Plated/Unplated	Thread Size	Grade	Plated/Unplated
5/16	5	13 ft./lb.	8mm-1.0	8.8	20 ft./lb. 18 ft./lb.	12mm-1.25	8.8	70 ft./lb. 65 ft./lb.
3/8	5	23 ft./lb.	8mm-1.25	8.8	19 ft./lb. 18 ft./lb.	12mm-1.5	8.8	66 ft./lb. 61 ft./lb.
7/16	5	37 ft./lb.	10mm-1.25	8.8	38 ft./lb. 36 ft./lb.	12mm-1.75	8.8	65 ft./lb. 60 ft./lb.
1/2	5	56 ft./lb.	10mm-1.5	8.8	37 ft./lb. 35 ft./lb.	14mm-2.0	8.8	104 ft./lb. 97 ft./lb.
5/8	5	150 ft./lb.						



# MOUNTING BRACKET KIT INSTALLATION INSTRUCTIONS

ROADMASTER, Inc. 6110 NE 127th Ave. Vancouver, WA 98682 1-800-669-9690 fax 360-735-9300 www.roadmasterinc.com

**KIT NO. 262-1**

- 20. Insert the front braces into the receiver brace and pin in place using 5/8" drift pins and 3/16" spring pins.
- 21. Mount the tow bar according to the manufacturer's instructions and torque all bolts to the specifications below.
- 22. Attach the 8" safety cables to the receiver brace using the supplied cable connectors. Connect the other end to the tow vehicle's safety cables and the tow bar.
- 23. A plug connector bracket has been supplied for use with your wiring plug, just bolt in place if needed with two supplied #10-24 x 1/2" screws.

## HARDWARE LIST

- 2-1/2" X 1 1/2" GROUND HEAD CARRIAGE BOLTS
- 2-1/2" X 1 1/4" GROUND HEAD CARRIAGE BOLTS
- 2-1/2" X 7 1/2" BOLTS
- 2-1/4" X 1 1/4" X 3" SQ. HOLE BACKING PLATES
- 2- 1/4" X 1" X 2" SQ. HOLE BACKING PLATES
- 2- 1/4" X 2" X 3" ROUND HOLE BACKING PLATES
- 6-1/2" LOCK WASHERS
- 6-1/2" NUTS
- 2-#10-24 x 1/2" MACHINE SCREWS
- 2-#10-24 NYLOCK NUTS
- 2-CABLE CONNECTORS
- 2-8" SAFETY CABLES
- 2-5/8" DRAW PINS
- 2-3/16" SPRING PINS

4-8-02

# CAUTION:

## Installer must read instructions and use all bolts and parts supplied.

FAILURE TO FOLLOW THESE INSTRUCTIONS CAN RESULT IN DEATH, PERSONAL INJURY OR PROPERTY DAMAGE

### BOLT TORQUE REQUIREMENTS

Note: The torque values represented below are intended as general guidelines. Torque requirements for specific applications may vary. Roadmaster does not warrant this information to be accurate for all applications and disclaims all liability for any claims or damages which may result from its use.

STANDARD BOLTS			METRIC BOLTS			METRIC BOLTS		
Thread Size	Grade	Torque	Thread Size	Grade	Plated/Unplated	Thread Size	Grade	Plated/Unplated
5/16	5	13 ft./lb.	8mm-1.0	8.8	20 ft./lb. 18 ft./lb.	12mm-1.25	8.8	70 ft./lb. 65 ft./lb.
3/8	5	23 ft./lb.	8mm-1.25	8.8	19 ft./lb. 18 ft./lb.	12mm-1.5	8.8	66 ft./lb. 61 ft./lb.
7/16	5	37 ft./lb.	10mm-1.25	8.8	38 ft./lb. 36 ft./lb.	12mm-1.75	8.8	65 ft./lb. 60 ft./lb.
1/2	5	56 ft./lb.	10mm-1.5	8.8	37 ft./lb. 35 ft./lb.	14mm-2.0	8.8	104 ft./lb. 97 ft./lb.
5/8	5	150 ft./lb.						

All illustrations and specifications contained herein are based on the latest information available at the time of publication approval. ROADMASTER, INC. reserves the right to make changes at any time without notice in material, specification and models or to discontinue models.