



# BASEPLATE KIT INSTALLATION INSTRUCTIONS

**KIT# 3108-1**

11/07/07  
KS

ROADMASTER, Inc. 6110 NE 127th Ave. Vancouver, WA 98682 360-896-0407 fax 360-735-9300 www.roadmasterinc.com

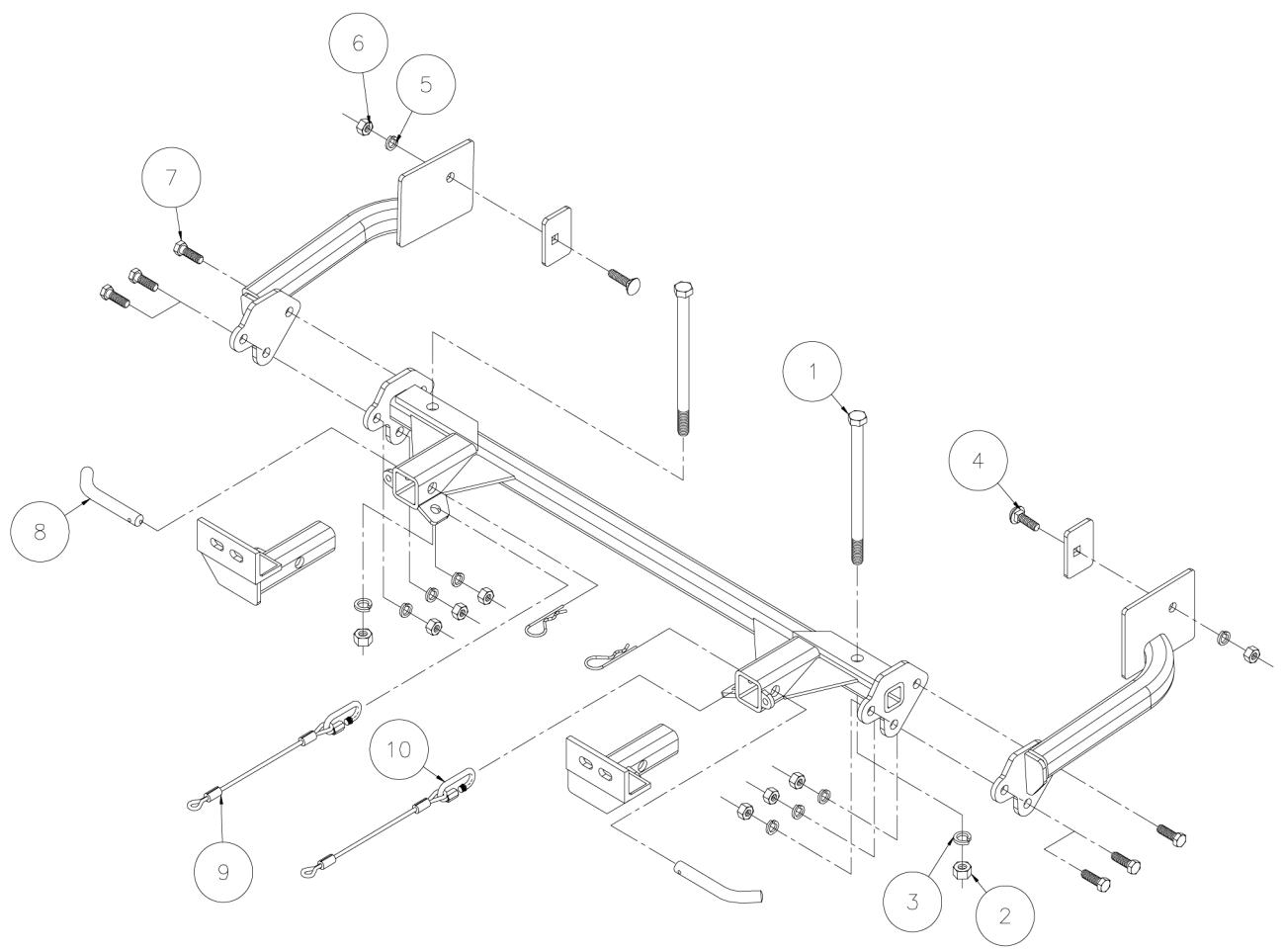

Item	Qty	Length	Width	Hardware	Part No.
1	2	9"	5/8"	5/8" x 9" BOLT	350379-00
2	2		5/8"	5/8" NUT	350262-00
3	2		5/8"	5/8" LOCK WASHER	350313-00
4	2	1 1/2"	1/2"	1/2" x 1 1/2" CARRIAGE BOLT	350362-00
5	8		1/2"	1/2" LOCK WASHER	350309-00
6	8		1/2"	1/2" NUT	350258-00
7	6	1 1/2"	1/2"	1/2" x 1 1/2" BOLT	350095-00
8	2			DRAW PIN/SPRING PIN	357035-00
9	2	10"		10" SAFETY CABLES, 8,000 lb. rated	650648-10
10	2			CABLE CONNECTORS	200008-00



# BASEPLATE KIT INSTALLATION INSTRUCTIONS

**KIT# 3108-1**

11/07/07  
KS

ROADMASTER, Inc. 6110 NE 127th Ave. Vancouver, WA 98682 360-896-0407 fax 360-735-9300 www.roadmasterinc.com

**IMPORTANT:** All brackets *must* be assembled with all the bolts left loose for final adjustment & positioning (before tightening) unless otherwise instructed. All bolts *must* be torqued for proper strength. If more than one bolt is used per fastening point, the diagram may only show one.

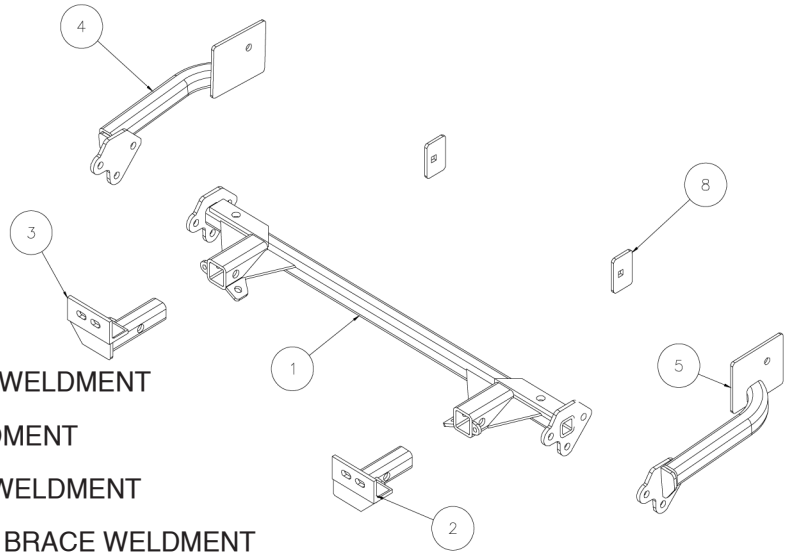

Item	Qty	Name	Assembly
1.....	1.....	C-000145.....	MAIN RECEIVER BRACE WELDMENT
2.....	1.....	C-000146.....	DRIVER SIDE ARM WELDMENT
3.....	1.....	C-000147.....	PASSENGER SIDE ARM WELDMENT
4.....	1.....	C-000149.....	PASSENGER SIDE REAR BRACE WELDMENT
5.....	1.....	C-000148.....	DRIVER SIDE REAR BRACE WELDMENT
8.....	2.....	A-000271.....	2" x 3" SQUARE HOLE BACKING PLATE - OFFSET HOLE

**IMPORTANT:** All baseplates *must* be assembled with all the bolts left loose for final adjustment and positioning (before tightening) unless otherwise instructed. All bolts *must* be torqued for proper strength. If more than one bolt is used per fastening point, the diagram may only show one. Use flat washers over all slotted holes and lock washers on all fasteners.

## WARNING

Failure to heed these warnings or follow the installation instructions may result in a voided warranty, loss of towed vehicle, personal injury or death.

- Do not weld or modify this baseplate or its components. Welding or modification will void the warranty.
- Do not use this document as a basis to design/fabricate a baseplate, as it may not show all parts or structural components.
- We strongly recommend professional installation.
- If the towed vehicle has been in an accident, it must be properly repaired before attaching the baseplate. Do not install the baseplate if any structural frame damage is found.
- The installer must use all bolts and parts supplied. If running changes were made by the vehicle manufacturer after this kit was designed, some bolts or other fasteners may no longer be the correct size. It is the installer's responsibility to verify this kit is securely fastened to the vehicle.
- Use Loctite® Red on all bolts used to secure this baseplate. Torque all bolts to the specifications found at the end of these instructions. Do not over-torque the bolts or failure may occur.
- The installer must inspect the baseplate to ensure adequate clearance, particularly around hoses, air conditioner lines, radiators, etc. or non-warranty failure may result.
- Roadmaster manufactures many styles of baseplates. If your baseplate has removable arms, they must be removed before driving the vehicle, unless the arms can be pinned or padlocked in place. If not secured, the arms could vibrate out.
- Some motorhome chassis have such a tight turning radius that you can damage your motorhome, towed vehicle, tow bar or baseplate while turning sharply. Before getting on the road, test your turning radius in an empty parking lot. Turning too sharply could

result in non-warranty damage to your towing system, motorhome and/or towed vehicle.

- Do not back up with the towed vehicle attached or non-warranty damage will occur to your towing system or vehicles.
- The safety cables must connect the towing vehicle to the towed vehicle frame to frame, with the cables crossed, with enough slack for sharp turns. See cable instructions for proper routing. Failure to do so will result in non-warranty damage and/or the loss of the towed vehicle.
- This kit is designed for use with ROADMASTER tow bars and ROADMASTER adapters only. Using this kit with other brands, without an approved ROADMASTER adapter, may result in non-warranty damage or injury.
- Receiver extensions and out-of-level towing situations of 3 inches or more. This can cause the system to swing much higher and lower, causing excessive strain on the tow bar, baseplate and frame. That can cause the towing system to fail, causing property damage, personal injury or even death. If you must use a receiver extension or drop hitch to tow, it will reduce your receiver's weight capacity by 1/3 to avoid damaging your system. Never use more than one extension and/or drop hitch, as this will void your warranty.
- Every 3,000 miles, the owner must inspect all mounting points for cracks or fatigue, and check the fasteners for proper torque, according to the bolt torque requirements chart on the last page of these instructions.
- The owner must follow the vehicle manufacturer's instructions to prepare the vehicle for towing. Failure to do so may cause severe damage to the vehicle.
- This baseplate is only warranted for the original installation. Installing a used baseplate on another vehicle is not recommended and will void the warranty.



# BASEPLATE KIT INSTALLATION INSTRUCTIONS

**KIT# 3108-1**

11/07/07  
KS

ROADMASTER, Inc. 6110 NE 127th Ave. Vancouver, WA 98682 360-896-0407 fax 360-735-9300 www.roadmasterinc.com

1. **Important:** please use all supplied bolts and parts and read all instructions carefully before beginning this installation. The majority of questions you may have can be answered within the text, and proper installation will ensure safe and secure travel. Now, begin the installation. This bracket kit is one of our XL series, which is designed to be partly removable. The kit consists of the main receiver brace, two front braces, two rear braces and a hardware pack. The main receiver brace mounts below the front bumper core and utilizes the stock bumper core mounts for the front mounts and the side of the frame rails for the back mounting points. The rear braces bolt to the sides of the main receiver brace and then to the frame. The front braces then insert into the receiver brace under the front bumper. The front grille and bumper will have to be removed to access the mounting area. Start by laying the kit out according to the illustration. This will give you a visual idea of how the kit installs and also confirm that the kit components are present and accounted for.

2. The next step is to remove the grill, this will provide access to the main bumper mounting bolts. Pull forward on the top of the grill, this should pop the top retainer clips loose so that you can pull up and release the bottom plastic retainer clips. Once the grille is free, just lay it on top of the engine compartment, leaving the headlight washer lines attached.

3. To remove the bumper fascia and bumper core, remove two plastic fasteners per side in the bottom of the fascia, two 10mm (head) screws and one plastic fastener in the top of the fascia then one large bumper bolt per side. Pull forward and lift the entire fascia and bumper core off.

4. Remove the lower black plastic shroud located between the bumper core and the radiator. This will be left off to make room for the receiver braces. *Note:* retain the shroud and attachment hardware for replacement in case the bracket is ever removed.

5. Prepare the bumper core for remounting by separating the bumper fascia from the bumper core (four plastic fasteners in the bottom of the bumper core). Now remove the large spring retainer nuts located on the bottom on each side.

6. Install the bare bumper core back on the vehicle with the 5/8" x 9" bolts in the hardware pack. These bolts will replace the factory bolts. Wait until the next step to put on nuts and lock washers.

7. Hold the main receiver brace to the bottom of the bumper core and bolt in place with 5/8" nuts and lock washers.

8. Working on one side at a time, hold a side brace into position on the side of the frame and the main receiver brace and bolt to the receiver brace with three 1/2" x 1 1/2" bolts, lock washers and nuts.

9. Now, fishwire a 1/2" x 1 1/2" carriage bolt and 1/4" x 2" x 3" backing plate through the back of the frame into the remaining mounting hole in the side plate. Bolt in plate with a 1/2" lock washer and nut.

10. Repeat steps 8 through 9 for the remaining side.

11. Torque the 5/8" bolts to 150-ft./lb. and the rest of the bolts to the specifications below.

12. Reinstall the front fascia and grill reversing steps 2 and 3 then replace the plastic pins removed in step 4.

13. Insert the front braces into the receiver brace and secure with 5/8" draw pins and 1/8" spring pins.

14. Install the tow bar according to the manufacturer's instructions.

15. Attach 10" safety cables to the holes provided in the receiver brace with the included cable links. Connect the other end to the tow vehicle's safety cables and tow bar.

## BOLT TORQUE REQUIREMENTS

Note: The torque values represented below are intended as general guidelines. Torque requirements for specific applications may vary. Roadmaster does not warrant this information to be accurate for all applications and disclaims all liability for any claims or damages which may result from its use.

### STANDARD BOLTS

Thread Size	Grade	Torque
5/16.....	5.....	13 ft./lb.
3/8.....	5.....	23 ft./lb.
7/16.....	5.....	37 ft./lb.
1/2.....	5.....	56 ft./lb.
5/8.....	5.....	150 ft./lb.

### METRIC BOLTS

Thread Size	Grade	Plated / Unplated
8mm-1.0.....	8.8.....	20 ft./lb. 18 ft./lb.
8mm-1.25.....	8.8.....	19 ft./lb. 18 ft./lb.
10mm-1.25.....	8.8.....	38 ft./lb. 36 ft./lb.
10mm-1.5.....	8.8.....	37 ft./lb. 35 ft./lb.

### METRIC BOLTS

Thread Size	Grade	Plated / Unplated
12mm-1.25.....	8.8.....	70 ft./lb. 65 ft./lb.
12mm-1.5.....	8.8.....	66 ft./lb. 61 ft./lb.
12mm-1.75.....	8.8.....	65 ft./lb. 60 ft./lb.
14mm-2.0.....	8.8.....	104 ft./lb. 97 ft./lb.

All illustrations and specifications contained herein are based on the latest information available at the time of publication approval. ROADMASTER, INC. reserves the right to make changes at any time without notice in material, specification and models or to discontinue models.