

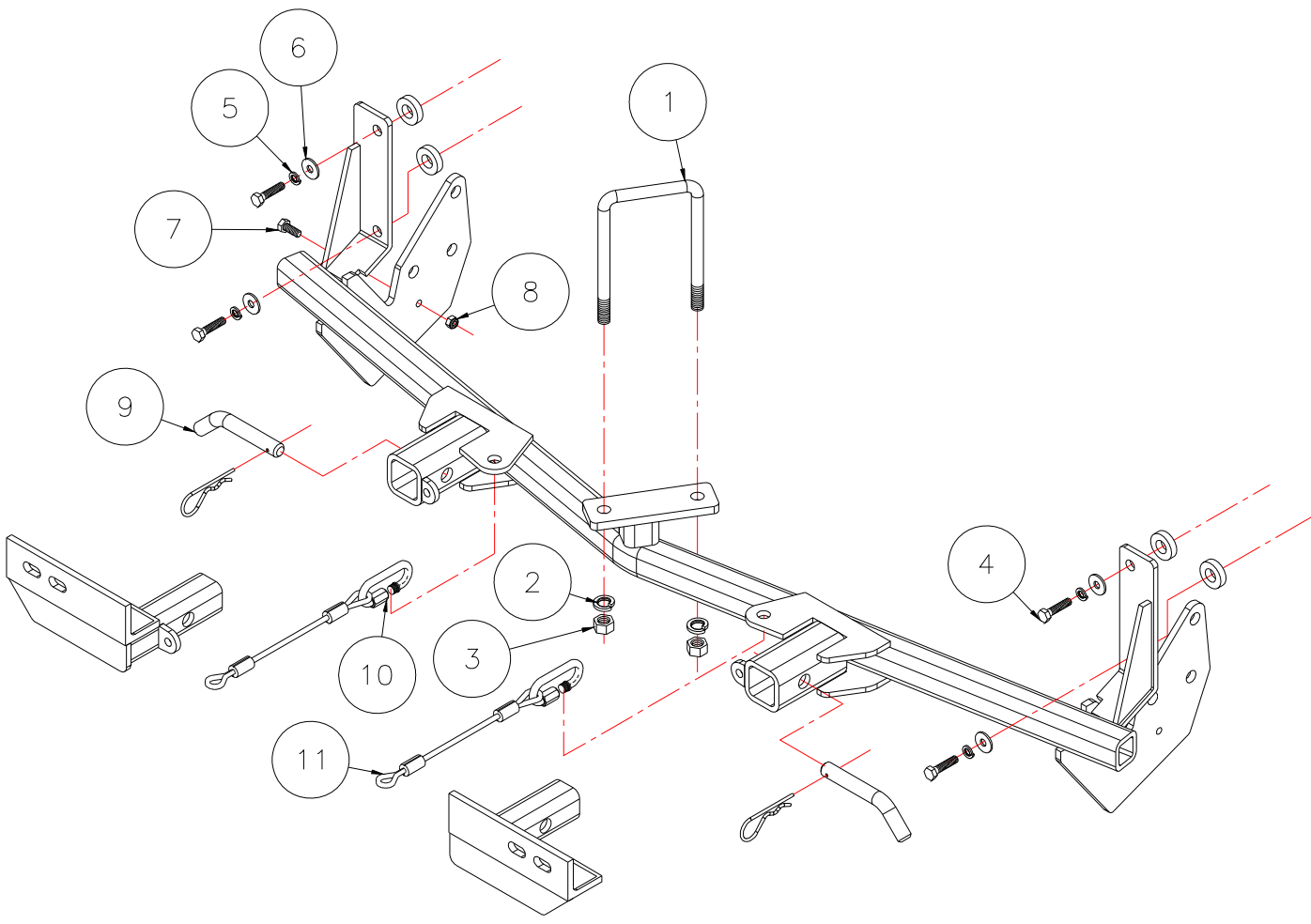

MOUNTING BRACKET KIT INSTALLATION INSTRUCTIONS

KIT# 343-1
06/14/04

ROADMASTER, Inc. 6110 NE 127th Ave. Vancouver, WA 98682 1-800-669-9690 fax 360-735-9300 www.roadmasterinc.com



ITEM	QTY	Length	Width	HARDWARE	PART NO.
1	1	6"	3 1/2"	1/2" x 3 1/2" x 6" UBOLT	357021-00
2	2		1/2"	LOCK WASHER	350309-00
3	2		1/2"	NUT	350258-00
4	4	35MM	8MM	8MM x 1.25MM x 35MM BOLT	356002-00
5	4		8MM	LOCK WASHER	355705-00
6	4		8MM	FENDER WASHER	355702-00
7	1	20MM	6MM	6MM x 1.0MM x 20MM SCREW	355750-00
8	1	6MM	6MM	6MM x 1.0MM NY-LOCK NUT	355760-00
9	2			DRAW PIN/SPRING PIN	357035-00
10	2			CABLE CONNECTOR	200008-00
11	2	10"	10"	CABLE	500646-10



MOUNTING BRACKET KIT INSTALLATION INSTRUCTIONS

KIT# 343-1

06/14/04

ROADMASTER, Inc. 6110 NE 127th Ave. Vancouver, WA 98682 1-800-669-9690 fax 360-735-9300 www.roadmasterinc.com

IMPORTANT: All brackets **must** be assembled with all the bolts left loose for final adjustment & positioning (before tightening) unless otherwise instructed. All bolts **must** be torqued for proper strength. If more than one bolt is used per fastening point, the diagram may only show one.

- Use flat washers over all slotted holes
- Use lock washers on all fasteners

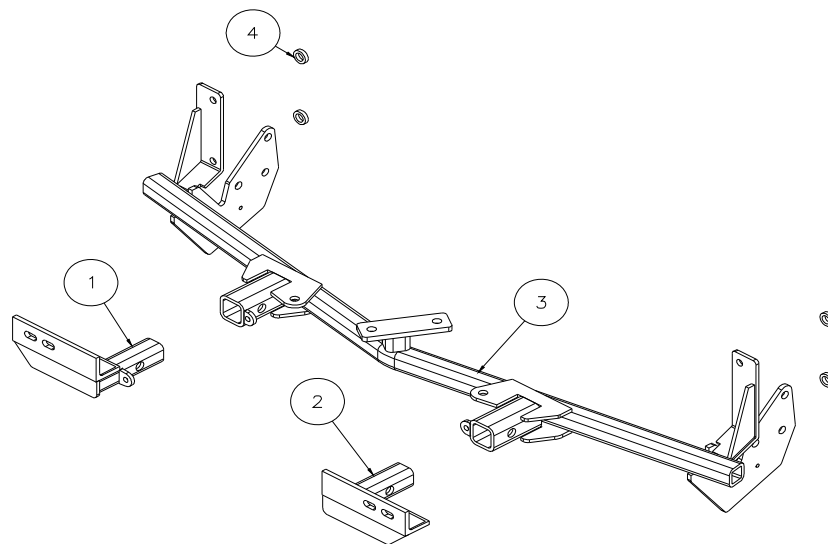

ITEM	QTY	PART. NO	ASSEMBLY
1	1	C-000918	RECEIVER BRACE WELDMENT
2	1	C-000917	DRIVER SIDE ARM BRACE WELDMENT
3	1	C-000916	PASSENGER SIDE ARM BRACE WELDMENT
4	4	A-001022	1" O.D. x 1/4" x .188 WALL TUBE

ROADMASTER Limited Warranty, including One-Year Conditional Warranty Text and Product Registration Card, in Carton.

WARNING

Failure to follow these instructions can result in property damage, personal injury or even death.

- Installation of most mounting brackets requires moderate mechanical aptitude and skills. We strongly recommend professional installation by an experienced installer.
- The installer must read the instructions and use all bolts and parts supplied. Failure to securely fasten the bracket could result in loss of the towed vehicle.
- Do not use this document for custom fabrication, as it may not show all parts or structural components. Custom fabrication or an attempt to copy this bracket design could result in loss of the towed vehicle.
- The owner must inspect all mounts and brackets before each use for cracks or other signs of fatigue. Also, inspect the fasteners for proper torque, according to the bolt torque requirements chart on the last page. Failure to do so could result in loss of the towed vehicle.
- The owner must check the vehicle manufacturer's instructions for the proper procedure(s) to prepare the vehicle for towing. Some vehicles must be equipped with a transmission lube pump, an axle disconnect, driveline disconnect or free-wheeling hubs before they can be towed. Failure to properly equip the vehicle will cause severe damage to the transmission.
- If running changes were made by the vehicle manufacturer after this bracket was designed, some bolts or other fasteners in the hardware pack may no longer be the correct size. It is the installer's responsibility to verify that the bracket is securely fastened to the vehicle and fitted with the correct hardware to account for these changes. Failure to securely fasten the bracket could result in loss of the towed vehicle.
- If the towed vehicle has been in an accident, it must be properly repaired before attaching the bracket. Do not install the bracket if any structural frame damage is found. Failure to repair the damage could result in the loss of the towed vehicle.
- Some motorhome chassis have such a tight turning radius that you can damage your motorhome, towed vehicle, tow bar or bracket while turning sharply. Before getting on the road, test your turning radius in an empty parking lot. Turning too sharply could result in non-warranty damage to towing system, motorhome and/or towed vehicle.
- Do not back up with the towed vehicle attached or non-warranty damage will occur to your towing system, motorhome and/or towed vehicle.
- The safety cables must connect the towing vehicle to the towed vehicle frame to frame, with the cables crossed, with enough slack for sharp turns. Refer to the cable instructions for proper routing. Failure to leave enough slack in the safety cables, or failure to connect the safety cables frame to frame, will result in the loss of the towed vehicle.
- This bracket is designed for use with ROADMASTER tow bars and ROADMASTER adaptors only. Using this bracket with other brands, without an approved ROADMASTER adaptor, may result in non-warranty damage or injury.
- Upon final installation, the installer must inspect the bracket to ensure adequate clearance, particularly around hoses, air conditioner lines, radiators, etc., or non-warranty damage to the towed vehicle will result.
- This bracket is only warranted for the original installation. Installing a used bracket on another vehicle is not recommended and will void the warranty.

ROADMASTER, INC.



MOUNTING BRACKET KIT INSTALLATION INSTRUCTIONS

KIT# 343-1

06/14/04

ROADMASTER, Inc. 6110 NE 127th Ave. Vancouver, WA 98682 1-800-669-9690 fax 360-735-9300 www.roadmasterinc.com

ROADMASTER, INC.

This bracket kit is one of our XL series with removable front braces. The kit consists of a receiver brace which mounts to the side of the front frame tubes, two removable front braces and a hardware packet. Everything but the front arm braces install behind the bumper fascia (Fig. A). The front fascia and grille will have to be removed for the installation.



2. Important: please use all supplied bolts and parts and read all instructions carefully before beginning this installation. The majority of questions you may have can be answered within the text, and proper installation will ensure safe and secure travel. Now, begin the installation. Starting on the top of the fascia, remove two plastic fasteners on each side (Fig.B) then push in on the center of four plastic fasteners in the grill cover (Fig.C,D).



3. Remove the grill cover and set aside (Fig.F), then remove two more fasteners in the top of grille (Fig.F). Pull forward and up to remove the grille and set aside.

4. Move under the front fascia and remove five plastic fasteners from the front of the lower splash shield and fascia (Fig.G).



MOUNTING BRACKET KIT INSTALLATION INSTRUCTIONS

KIT# 343-1

06/14/04

ROADMASTER, Inc. 6110 NE 127th Ave. Vancouver, WA 98682 1-800-669-9690 fax 360-735-9300 www.roadmasterinc.com

ROADMASTER, INC.



Fig.H



Fig.I



Fig.J

5. Remove two phillip head fasteners from the lower fascia on each side (Fig.H) then pull down to disconnect the marker lights (Fig.I).
6. Pull the splash panel down to access the fender fascia joint and remove two phillip head screws located in the front and back of the joints on each side (Fig.J).



Fig.K

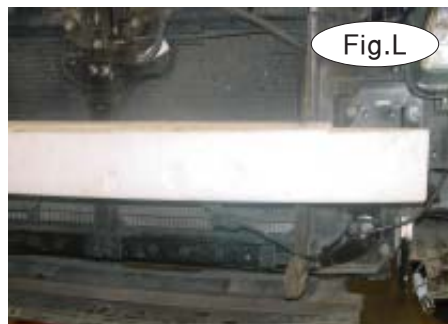

Fig.L

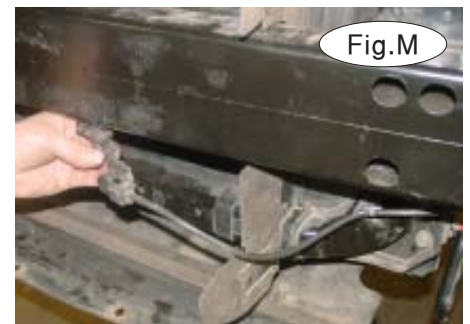

Fig.M

7. Pull the fascia forward on each side to disengage the tabs under the head lights and remove (Fig.K).
8. Remove the energy absorbtion foam from the front of the bumper core (Fig.L) then loosen the ambient air sensor (Fig.M).



Fig.N



Fig.O

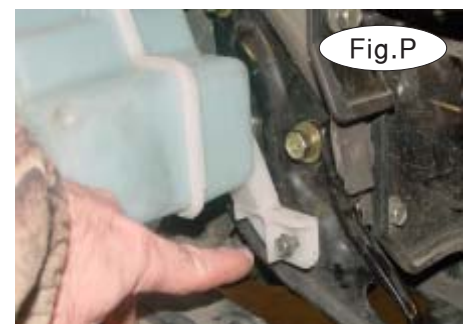

Fig.P

9. Trim the radiator air deflectors to clear the main receiver brace (Fig.N).
10. Remove the tie down plates on each side (three 14mm head bolts) (Fig.O). Discard the plates and keep the bolts for reinstallation. On the passenger side, remove two lower washer reservoir mounting bolts (10mm head) to access the tie down plates and loosen the top bolt (Fig.P,Q).



MOUNTING BRACKET KIT INSTALLATION INSTRUCTIONS

KIT# 343-1

06/14/04

ROADMASTER, Inc. 6110 NE 127th Ave. Vancouver, WA 98682 1-800-669-9690 fax 360-735-9300 www.roadmasterinc.com

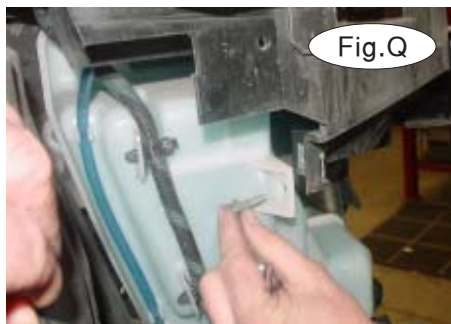

Fig.Q

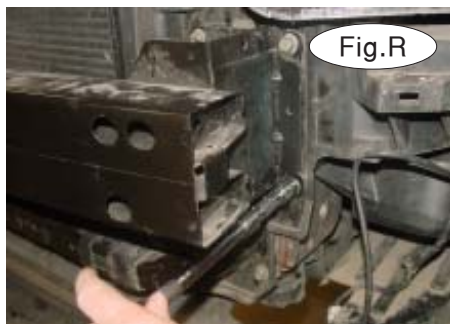

Fig.R



Fig.S

11. Remove the two outside bumper core bolts (12mm head) on each side (Fig.R), then hold the receiver brace in position under the bumper core (Fig.S) and secure in the middle with the mounting u-bolt and two 1/2" bolts and lock washers (Fig.T).

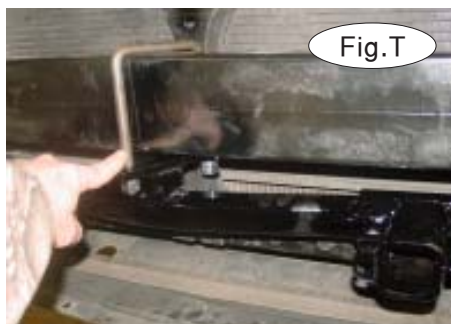

Fig.T



Fig.U



Fig.V

12. Reinstall the bolts removed in step 10, bolting through the receiver brace on both sides (Fig.U). Don't tighten at this time.

13. Put small 1/4" spacers behind the brace as shown in (Fig.V) before bolting through the front of the receiver brace with 8mm x 1.25 x 35mm bolts, lock washers and fender washers on each side. Tighten these bolts then tighten all the bolts including the center U-bolt to the torque specifications on the last page.



Fig.W

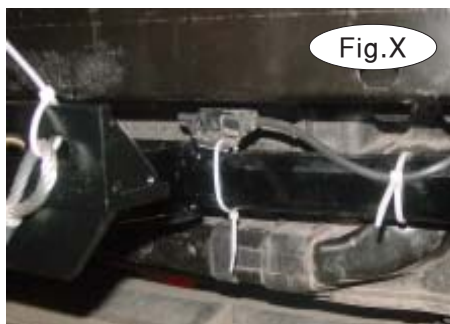

Fig.X

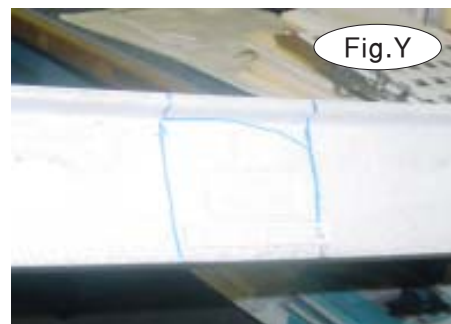

Fig.Y

14. Replace the bottom bolt on the passenger side water reservoir with a 8mm x 1.0 x 20mm bolt and lock nut through the side of the receiver brace side plate (Fig.W).

15. Remount the ambient air sensor with the included zip ties on the receiver brace cross bar as shown in (Fig.X).

16. Trim the energy absorption foam to fit (Fig.Y), then reinstall.



MOUNTING BRACKET KIT INSTALLATION INSTRUCTIONS

KIT# 343-1

06/14/04

ROADMASTER, Inc. 6110 NE 127th Ave. Vancouver, WA 98682 1-800-669-9690 fax 360-735-9300 www.roadmasterinc.com

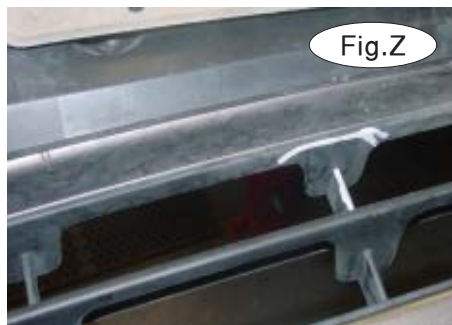

Fig.Z



Fig.AA

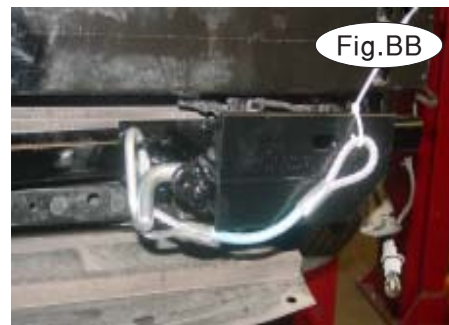

Fig.BB

17. Trim the fascia to fit in the areas shown (Fig.Z,AA) then the fascia reversing steps 2 through 7.
16. Install the front braces in the receiver tubes a pin in place with 5/8" draw pins and 3/16" spring pins (Fig.BB).
20. Attach the 10" safety cables to the RECEIVER BRACE with the included cable connectors (Fig.42). Connect the other ends to the TOW VEHICLES safety cables and tow bar.
21. Install the tow bar according to the manufacture's instructions and torque all bolts to the torque specifications below.

BOLT TORQUE REQUIREMENTS

Note: The torque values represented below are intended as general guidelines. Torque requirements for specific applications may vary. Roadmaster does not warrant this information to be accurate for all applications and disclaims all liability for any claims or damages which may result from its use.

STANDARD BOLTS			METRIC BOLTS			METRIC BOLTS		
Thread Size	Grade	Torque	Thread Size	Grade	Plated/Unplated	Thread Size	Grade	Plated/Unplated
5/16	5	13 ft./lb.	8mm-1.0	8.8	20 ft./lb. 18 ft./lb.	12mm-1.25	8.8	70 ft./lb. 65 ft./lb.
3/8	5	23 ft./lb.	8mm-1.25	8.8	19 ft./lb. 18 ft./lb.	12mm-1.5	8.8	66 ft./lb. 61 ft./lb.
7/16	5	37 ft./lb.	10mm-1.25	8.8	38 ft./lb. 36 ft./lb.	12mm-1.75	8.8	65 ft./lb. 60 ft./lb.
1/2	5	56 ft./lb.	10mm-1.5	8.8	37 ft./lb. 35 ft./lb.	14mm-2.0	8.8	104 ft./lb. 97 ft./lb.
5/8	5	150 ft./lb.						

All illustrations and specifications contained herein are based on the latest information available at the time of publication approval. ROADMASTER, INC. reserves the right to make changes at any time without notice in material, specification and models or to discontinue models.