



MOUNTING BRACKET KIT INSTALLATION INSTRUCTIONS

KIT# 344-3

08/06/08
KS

ROADMASTER, Inc. 6110 NE 127th Ave. Vancouver, WA 98682 1-800-669-9690 fax 360-735-9300 www.roadmasterinc.com

Important
Note: this bracket will not accommodate the Guardian rock shield, Stowaway or the StowMaster and StowMaster All Terrain tow bars.

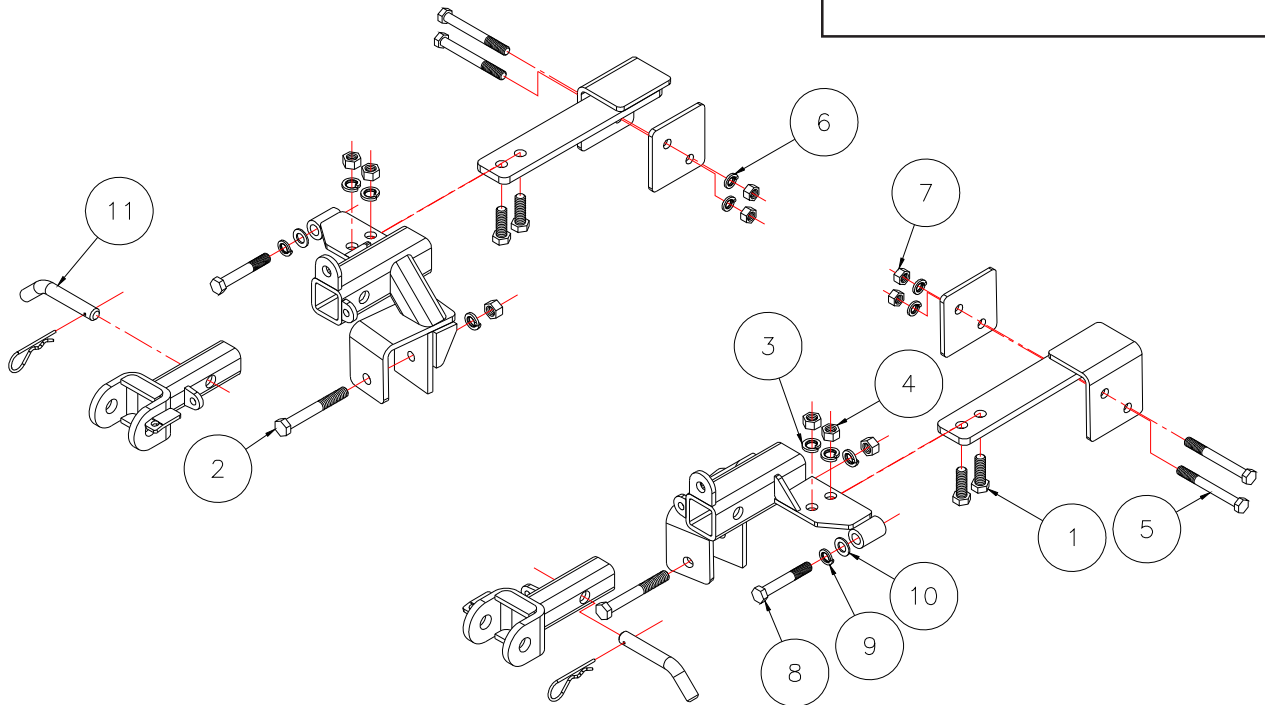

Item	Qty.	Length	Width	Description	Part#
1	4	1 1/2"	1/2"	1/2" x 1 1/2" BOLT	350095-00
2	2	4"	1/2"	1/2" x 4" BOLT	350105-00
3	6		1/2"	LOCK WASHER	350309-00
4	6		1/2"	NUT	350258-00
5	4		7/16"	7/16" x 4" BOLT	350084-00
6	4		7/16"	LOCK WASHER	350307-00
7	4		7/16"	NUT	350256-00
8	2	80mm	12mm	12mm x 1.25 x 80mm BOLT	357111-00
9	2		12mm	LOCK WASHER	355725-00
10	2		12mm	FLAT WASHER	355720-00
11	2		5/8"	DRAW PINS, SPRING PINS	357035-00

ROADMASTER, INC.



MOUNTING BRACKET KIT INSTALLATION INSTRUCTIONS

KIT# 344-3

08/06/08
KS

ROADMASTER, Inc. 6110 NE 127th Ave. Vancouver, WA 98682 1-800-669-9690 fax 360-735-9300 www.roadmasterinc.com

IMPORTANT: All brackets *must* be assembled with all the bolts left loose for final adjustment & positioning (before tightening) unless otherwise instructed. All bolts *must* be torqued for proper strength. If more than one bolt is used per fastening point, the diagram may only show one.

- Use flat washers over all slotted holes
- Use lock washers on all fasteners

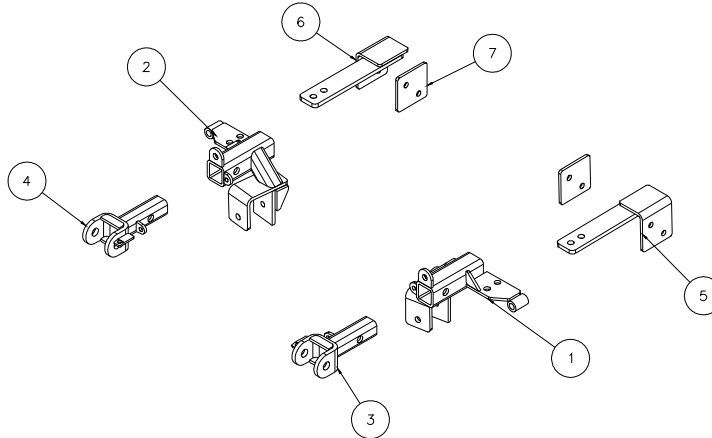

Item	Qty.	Part #	Description
1	1	C-001033	DRIVER SIDE RECEIVER BRACE WELDMENT
2	1	C-001034	PASSENGER SIDE RECEIVER BRACE WELDMENT
3	1	C-001107	DRIVER SIDE ARM WELDMENT
4	1	C-001108	PASSENGER SIDE ARM WELDMENT
5	1	C-001134	DRIVER SIDE REAR BRACE
6	1	C-001135	PASSENGER SIDE REAR BRACE
7	2	A-001872	1/4" x 3 1/2" x 3 1/2" PLATE

WARNING

Failure to follow these instructions can result in property damage, personal injury or even death.

- **Installation of most mounting brackets requires moderate mechanical aptitude and skills.** We strongly recommend professional installation by an experienced installer.
- **The installer must read the instructions and use all bolts and parts supplied.** When the instructions require the reuse of factory bolts, thread lock and/or lock washers must also be used. Failure to securely fasten the bracket could result in loss of the towed vehicle.
- **Do not use this document for custom fabrication,** as it may not show all parts or structural components. Custom fabrication or an attempt to copy this bracket design could result in loss of the towed vehicle.
- **Every 3,000 miles, the owner must inspect the fasteners** for proper torque, according to the bolt torque requirements chart on the last page of these instructions. **The owner must also inspect all mounts and brackets for cracks or other signs of fatigue every 3,000 miles.** Failure to do so could result in loss of the towed vehicle.
- **The owner must check the vehicle manufacturer's instructions for the proper procedure(s) to prepare the vehicle for towing.** Some vehicles must be equipped with a transmission lube pump, an axle disconnect, driveline disconnect or free-wheeling hubs before they can be towed. Failure to properly equip the vehicle will cause severe damage to the transmission.
- **If running changes were made** by the vehicle manufacturer after this bracket was designed, some bolts or other fasteners in the hardware pack may no longer be the correct size. **It is the installer's responsibility** to verify that the bracket is securely fastened to the vehicle and fitted with the correct hardware to account for these changes. Failure to

securely fasten the bracket could result in loss of the towed vehicle.

- If the towed vehicle has been in an accident, it must be properly repaired before attaching the bracket. **Do not install the bracket if any structural frame damage is found.** Failure to repair the damage could result in the loss of the towed vehicle.
- Some motorhome chassis have such a tight turning radius that you can damage your motorhome, towed vehicle, tow bar or bracket while turning sharply. **Before getting on the road, test your turning radius in an empty parking lot.** Turning too sharply could result in non-warranty damage to towing system, motorhome and/or towed vehicle.
- **Do not back up with the towed vehicle attached** or non-warranty damage will occur to your towing system, motorhome and/or towed vehicle.
- **The safety cables must connect the towing vehicle to the towed vehicle frame to frame, with the cables crossed, with enough slack for sharp turns.** Refer to the cable instructions for proper routing. Failure to leave enough slack in the safety cables, or failure to connect the safety cables frame to frame, will result in the loss of the towed vehicle.
- This bracket is designed for use with ROADMASTER tow bars and ROADMASTER adaptors only. **Using this bracket with other brands, without an approved ROADMASTER adaptor, may result in non-warranty damage or injury.**
- Upon final installation, **the installer must inspect the bracket to ensure adequate clearance, particularly around hoses, air conditioner lines, radiators, etc.,** or non-warranty damage to the towed vehicle will result.
- **This bracket is only warranted for the original installation.** Installing a used bracket on another vehicle is not recommended and will void the warranty.



MOUNTING BRACKET KIT INSTALLATION INSTRUCTIONS

KIT# 344-3

08/06/08
KS

ROADMASTER, Inc. 6110 NE 127th Ave. Vancouver, WA 98682 1-800-669-9690 fax 360-735-9300 www.roadmasterinc.com

2005-08 Nissan Frontier Instructions

This bracket kit fits the 2005-08 Nissan Frontier, the 2005-08 Nissan Pathfinder, and the 2005-08 Nissan Xterra. Follow the instructions below for the Nissan Frontier; for Pathfinder and Xterra installation, see the separate sections included in these instructions.

This is one of our MX series brackets, which allows the visible front portion of the brackets to be easily removed from the front of the vehicle (Fig.A and Fig.B). The bracket consists of a main receiver brace, two rear braces and a hardware pack.

Before starting the installation, lay out the kit components in order, as they will be used. This will give you a visual idea of how the components work, and will also confirm that everything is present and accounted for.

1. Start by removing six plastic fasteners across the top of the grille (Fig.C).
2. There are four retainer clips (two on each side of the grille, Fig.D) which attach the grille to the core support. Rotate each clip a quarter turn to the right to release it.
3. There are four plastic tabs at the bottom of the grille (Fig.E) which connect the grille to the fascia. Lift up on each tab to release it. Then, remove the grille (Fig.F).



Note: for the 2005-06 Nissan Frontier XE model, see the attached supplemental instructions that replace steps 4 through 8.

4. On each side, remove two 12mm (head) bolts connecting the bumper core to the frame rail (Fig.G).
5. Remove six 10mm (head) bolts, located across the bottom of the fascia (Fig.H). Then, remove the lower section of the fascia.



MOUNTING BRACKET KIT INSTALLATION INSTRUCTIONS

KIT# 344-3

08/06/08
KS

ROADMASTER, Inc. 6110 NE 127th Ave. Vancouver, WA 98682 1-800-669-9690 fax 360-735-9300 www.roadmasterinc.com



6. Remove four 10mm bolts attaching the fascia to the rock guard (Fig.I), as well as two 12mm bolts attaching the bumper core to the frame rail (one on each side).
7. On each side, remove one 10mm bolt holding the bumper brace to the bumper (Fig.J).
8. Disconnect the fog lights, if the vehicle is so equipped, then remove the bumper (Fig.K).



9. Remove the upper 17mm head bolts (one on each side) holding the bumper core to the frame rail (Fig.L).
10. Position both of the rear braces between the radiator and the body support, on the top of the frame rail (Fig.M). Fit two 1/2" x 1 1/2" bolts into place at the front of each brace (Fig.N) before lowering it into position. These two bolts will be used to attach one of the main braces.

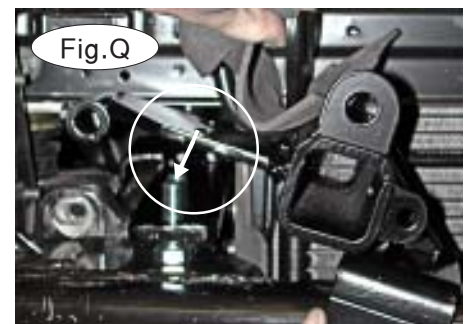

11. The rear braces are attached to the frame rail. On each side, slide two 7/16" x 4" bolts through the rear brace, the two existing holes in the frame rail, and one of the 3 1/2" x 3 1/2" backing plates (Fig.O). Then, secure each bolt in place with a 7/16" lock washer and nut. Finger-tighten only at this time. Figure P shows one of the braces with both rear mounting bolts, lock washers, nuts and the backing plate in place.
12. Fit one of the main braces over one of the rear braces, and over the top of the two 1/2" x 1 1/2" bolts you positioned in step 10 (Fig.Q). Thread two 1/2" lock washers and nuts over the bolts to secure them (Fig.R). Finger-tighten only at this time. Repeat for the other side.

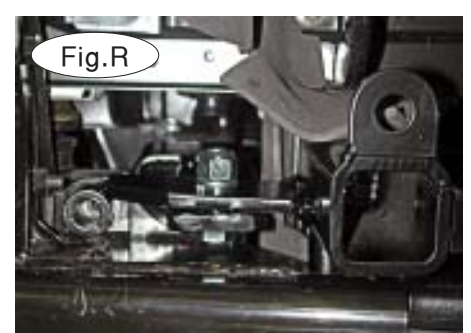

All illustrations and specifications contained herein are based on the latest information available at the time of publication approval.
ROADMASTER, INC. reserves the right to make changes at any time without notice in material, specification and models or to discontinue models.



MOUNTING BRACKET KIT INSTALLATION INSTRUCTIONS

KIT# 344-3

08/06/08
KS

ROADMASTER, Inc. 6110 NE 127th Ave. Vancouver, WA 98682 1-800-669-9690 fax 360-735-9300 www.roadmasterinc.com



13. Thread a 12mm x 1.25 x 80mm bolt, with a 12mm lock washer and flat washer, through each main brace and into the existing weld nut in the frame rail (Fig.S).
14. Tighten all bolts to the torque specifications at the bottom of these instructions.
15. Using the hole in the main brace as a template, drill a 1/2" hole through the bumper core (Fig.T). Bolt through the hole with a 1/2" x 4" bolt, lock washer and nut (Fig.U). Repeat for the other side. Tighten the two bolts to the torque specifications at the bottom of these instructions.
16. Remount the bumper and both sections of the fascia, reversing steps 1 through 8.
17. Fit the front bracket arms into the front receiver braces, and secure them in place with the supplied 5/8" draw pins and spring pins.
18. Install the tow bar to the mounting bracket according to the manufacturer's instructions. Attach the safety cables to the main receiver brace.

BOLT TORQUE REQUIREMENTS

Note: The torque values represented below are intended as general guidelines. Torque requirements for specific applications may vary. Roadmaster does not warrant this information to be accurate for all applications and disclaims all liability for any claims or damages which may result from its use.

STANDARD BOLTS

Thread Size	Grade	Torque
5/16	5	13 ft./lb.
3/8	5	23 ft./lb.
7/16	5	37 ft./lb.
1/2	5	56 ft./lb.
5/8	5	150 ft./lb.

METRIC BOLTS

Thread Size	Grade	Plated / Unplated
8mm-1.0	8.8	20 ft./lb. 18 ft./lb.
8mm-1.25	8.8	19 ft./lb. 18 ft./lb.
10mm-1.25	8.8	38 ft./lb. 36 ft./lb.
10mm-1.5	8.8	37 ft./lb. 35 ft./lb.

METRIC BOLTS

Thread Size	Grade	Plated / Unplated
12mm-1.25	8.8	70 ft./lb. 65 ft./lb.
12mm-1.5	8.8	66 ft./lb. 61 ft./lb.
12mm-1.75	8.8	65 ft./lb. 60 ft./lb.
14mm-2.0	8.8	104 ft./lb. 97 ft./lb.

All illustrations and specifications contained herein are based on the latest information available at the time of publication approval. ROADMASTER, INC. reserves the right to make changes at any time without notice in material, specification and models or to discontinue models.



MOUNTING BRACKET KIT INSTALLATION INSTRUCTIONS

KIT# 344-3

08/06/08
KS

ROADMASTER, Inc. 6110 NE 127th Ave. Vancouver, WA 98682 1-800-669-9690 fax 360-735-9300 www.roadmasterinc.com

2005-08 Nissan Frontier XE Model Supplemental Instructions

These supplemental instructions will replace steps 4 through 8. After you have finished these steps proceed back to step 9 and follow the remaining instructions for proper installation.



Fig.A



Fig.B



Fig.C

1. Start by removing three plastic fasteners located behind the grille, attaching the top of the fascia to the bumper core (Fig.A).
2. Next, remove six 10mm (head) screws attaching the lower center panel to the fascia (Fig.B). Remove the panel.
3. Remove four 10mm (head) screws attaching the lower fascia to the rock guard (Fig.C).



Fig.D

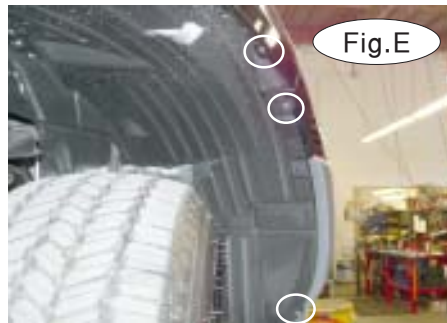

Fig.E

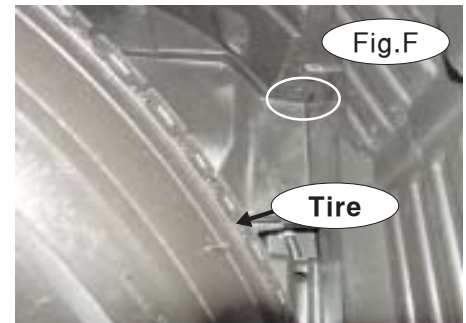

Fig.F

4. On both sides, remove two Phillips head screws attaching the fender liner to the bottom of the fascia (Fig.D).
5. On both sides, remove three Phillips head screws attaching the fender liner to the outer edge of the fascia (Fig.E).
6. On both sides, remove one plastic fastener attaching the fender liner to the inner fender well (Fig.F).
7. On both sides, pull back the fender liner and remove two 10mm screws attaching the bumper cover to the fender (Fig.G, H).
8. Disconnect the fog lights (if the vehicle is so equipped).



Fig.G

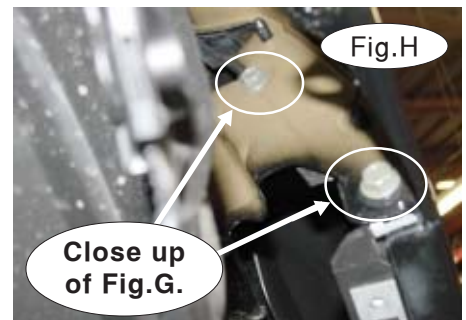

Fig.H

Close up
of Fig.G.

Continued on next page.



MOUNTING BRACKET KIT INSTALLATION INSTRUCTIONS

KIT# 344-3

08/06/08
KS

ROADMASTER, Inc. 6110 NE 127th Ave. Vancouver, WA 98682 1-800-669-9690 fax 360-735-9300 www.roadmasterinc.com

9. Remove three plastic fasteners located along the upper edge of the lower grille opening (Fig.1).

10. Next, pull down slightly on the outer corners of the fascia and pull forward to remove it.

11. Now, proceed back to step 9 in the original instructions for the Nissan Frontier to finish the installation.





MOUNTING BRACKET KIT INSTALLATION INSTRUCTIONS

KIT# 344-3

08/06/08
KS

ROADMASTER, Inc. 6110 NE 127th Ave. Vancouver, WA 98682 1-800-669-9690 fax 360-735-9300 www.roadmasterinc.com

2005-08 Nissan Pathfinder Instructions

This bracket kit fits the 2005-08 Nissan Pathfinder, the 2005-08 Nissan Frontier, and the 2005-08 Nissan Xterra. Follow the instructions below for the Nissan Pathfinder; for Frontier and Xterra installation, see the separate sections included in these instructions.

This is one of our MX series brackets, which allows the visible front portion of the brackets to be easily removed from the front of the vehicle (Fig.A and Fig.B). The bracket consists of a main receiver brace, two rear braces and a hardware pack.

Before starting the installation, lay out the kit components in order, as they will be used. This will give you a visual idea of how the components work, and will also confirm that everything is present and accounted for.

1. Start by removing six plastic fasteners across the top of the grille (Fig.C).
2. There are four retainer clips (two on each side of the grille, Fig.D) which attach the grille to the core support. Rotate each clip a quarter turn to the right to release it.
3. There are four plastic tabs at the bottom of the grille (Fig.E) which connect the grille to the fascia. Lift up on each tab to release it. Then, remove the grille (Fig.F).

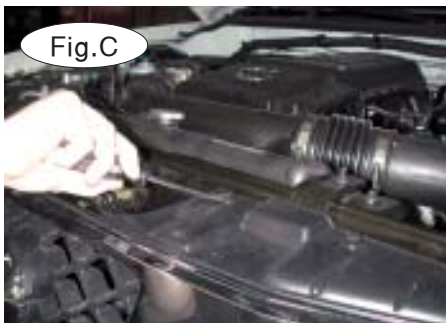

4. Remove six plastic fasteners holding the fascia to the bumper core – three behind the grille opening (Fig.G) and three at the top of the grille opening (Fig.H).



MOUNTING BRACKET KIT INSTALLATION INSTRUCTIONS

KIT# 344-3

08/06/08
KS

ROADMASTER, Inc. 6110 NE 127th Ave. Vancouver, WA 98682 1-800-669-9690 fax 360-735-9300 www.roadmasterinc.com

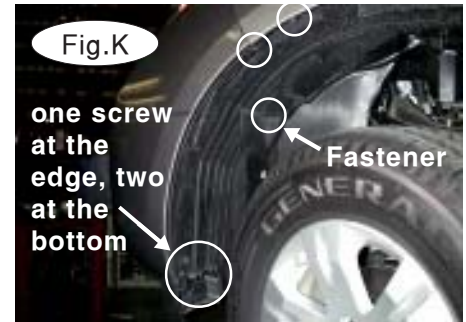
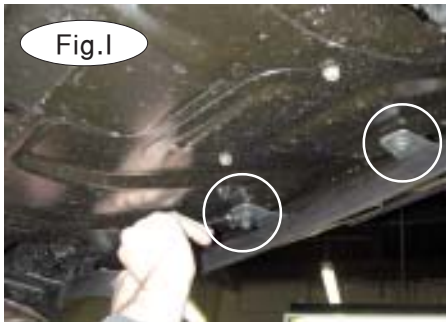

5. Pull down on the lower center section of the fascia, then remove four 10mm (head) bolts holding this section of the fascia to the rock guard (Fig.I).

6. On each side, remove one plastic fastener (Fig.J, Fig.K), as well as five Phillips head screws (three along the edge of the fender well and two at the bottom – Fig.K), holding the fender liner to the fascia.

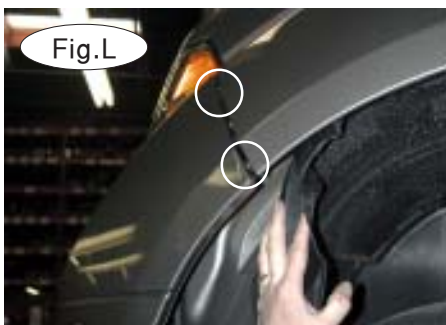

7. Pull back the fender liner on each side to gain access to the inner fender well. Then, remove two 10mm (head) bolts (Fig.L).

8. Disconnect the fog lights, if the vehicle is so equipped. Then, pull forward on each side of the fascia to remove it (Fig.M).

9. Remove the upper 17mm head bolts (one on each side) holding the bumper core to the frame rail (Fig.N).

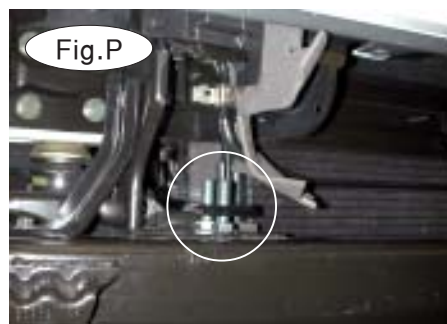

10. Position both of the rear braces between the radiator and the body support, on the top of the frame rail (Fig.O). Fit two 1/2" x 1 1/2" bolts into place at the front of each brace (Fig.P) before lowering it into position. These two bolts will be used to attach one of the main braces.

11. The rear braces are attached to the frame rail. On each side, slide two 7/16" x 4" bolts through the rear brace, the two existing holes in the frame rail, and one of the 3 1/2" x 3 1/2" backing plates (Fig.Q). Then, secure each bolt in place with a 7/16" lock washer and nut. Finger-tighten only at this time. Figure R shows one of the braces with both rear mounting bolts, lock washers, nuts and the backing plate in place.



MOUNTING BRACKET KIT INSTALLATION INSTRUCTIONS

KIT# 344-3

08/06/08
KS

ROADMASTER, Inc. 6110 NE 127th Ave. Vancouver, WA 98682 1-800-669-9690 fax 360-735-9300 www.roadmasterinc.com

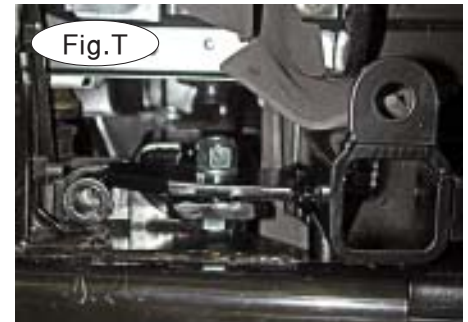
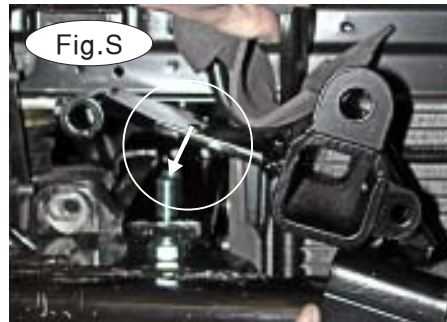

12. Fit one of the main braces over one of the rear braces, and over the top of the two $\frac{1}{2}$ " x $1\frac{1}{2}$ " bolts you positioned in step 10 (Fig.S). Thread two $\frac{1}{2}$ " lock washers and nuts over the bolts to secure them (Fig.T). Finger-tighten only at this time. Repeat for the other side.

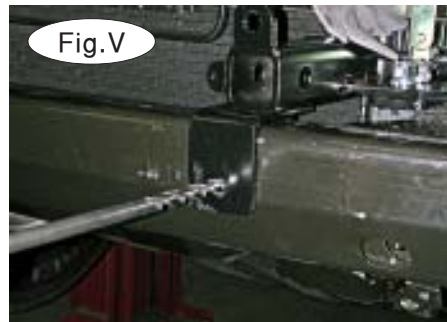

13. Thread a 12mm x 1.25 x 80mm bolt, with a 12mm lock washer and flat washer, through each main brace and into the existing weld nut in the frame rail (Fig.U).

14. Tighten all bolts to the torque specifications at the bottom of these instructions.

15. Using the hole in the main brace as a template, drill a $\frac{1}{2}$ " hole through the bumper core (Fig.V). Bolt through the hole with a $\frac{1}{2}$ " x 4" bolt, lock washer and nut (Fig.W). Repeat for the other side. Tighten

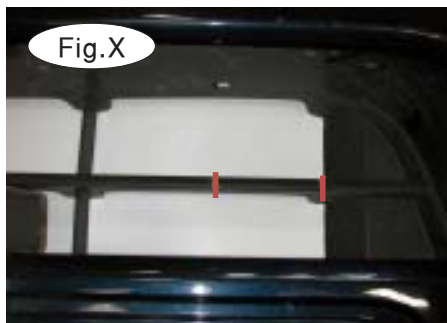

the two bolts to the torque specifications at the bottom of these instructions.

16. **For 2008 Nissan Pathfinder models:** trim the fascia using the red lines in Figure X as a guide.

17. Remount the fascia, reversing steps 1 through 8.

18. Fit the front bracket arms into the front receiver braces, and secure them in place with the supplied $\frac{5}{8}$ " draw pins and spring pins.

19. Attach the 8" safety cables with the cable connectors (Q-Links) to the front of the receiver braces (Fig.Y).

20. Attach the ends of the safety cables to the tow vehicle's safety cables and tow bar.

21. Install the tow bar to the mounting bracket according to the manufacturer's instructions.



MOUNTING BRACKET KIT INSTALLATION INSTRUCTIONS

KIT# 344-3

07/28/08
KS

ROADMASTER, Inc. 6110 NE 127th Ave. Vancouver, WA 98682 1-800-669-9690 fax 360-735-9300 www.roadmasterinc.com

2005-08 Nissan Xterra Instructions

This bracket kit fits the 2005-08 Nissan Xterra, the 2005-08 Nissan Frontier, and the 2005-08 Nissan Pathfinder. Follow the instructions below for the Nissan Xterra; for Pathfinder and Frontier installation, see the separate sections included in these instructions.

This is one of our MX series brackets, which allows the visible front portion of the brackets to be easily removed from the front of the vehicle (Fig.A and Fig.B). The bracket consists of a main receiver brace, two rear braces and a hardware pack.

Before starting the installation, lay out the kit components in order, as they will be used. This will give you a visual idea of how the components work, and will also confirm that everything is present and accounted for.

1. Start by removing six plastic fasteners across the top of the grille (Fig.C), holding the grille to the core support.
2. Reaching behind the grille, lift up and release four plastic tabs (Fig.D). Then, pull out on the grille to remove it (Fig.E). Figure E shows the location of the four plastic tabs.
3. Remove five plastic fasteners holding the fascia to the bumper core (Fig.F).

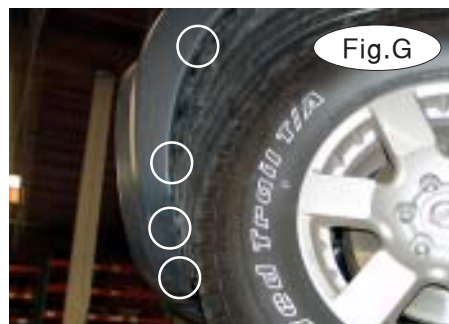

4. On each side, remove four Phillips head screws holding the fender liner to the fascia (Fig.G). Two are located on the fender well, and two are on the bottom of the fascia.
5. On each side, pull back on the fender liner to expose one 10mm (head) screw holding the fascia to the fender. Remove the 10mm (head) screw (Fig.H).



MOUNTING BRACKET KIT INSTALLATION INSTRUCTIONS

KIT# 344-3

07/28/08
KS

ROADMASTER, Inc. 6110 NE 127th Ave. Vancouver, WA 98682 1-800-669-9690 fax 360-735-9300 www.roadmasterinc.com



6. Remove four 10mm (head) screws holding the fascia to the splash shield (Fig.I). Two are located in the center; two are at the outside edges of the fascia.

7. Disconnect the fog lights (Fig.J), if the vehicle is so equipped.

8. Pull forward on each side of the fascia to release it from the track. Then, pull forward to remove the fascia (Fig.K).

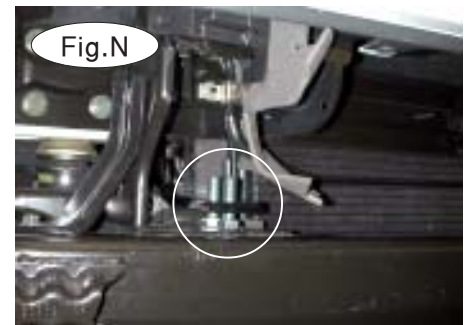

9. Remove the upper 17mm head bolts (one on each side) holding the bumper core to the frame rail (Fig.L).

10. Position both of the rear braces between the radiator and the body support, on the top of the frame rail (Fig.M). Fit two 1/2" x 1 1/2" bolts into place at the front of each brace (Fig.N) before lowering it into position. These two bolts will be used to attach one of the main braces.

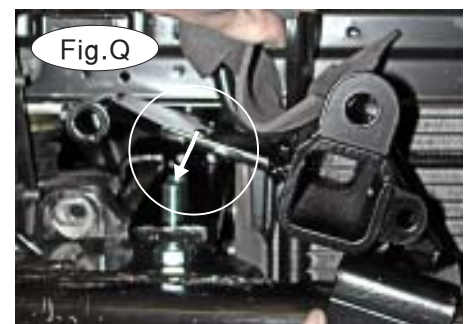

11. The rear braces are attached to the frame rail. On each side, slide two 7/16" x 4" bolts through the rear brace, the two existing holes in the frame rail, and one of the 3 1/2" x 3 1/2" backing plates (Fig.O). Then, secure each bolt in place with a 7/16" lock washer and nut. Finger-tighten only at this time. Figure P shows one of the braces with both rear mounting bolts, lock washers, nuts and the backing plate in place.

12. Fit one of the main braces over one of the rear braces, and over the top of the two 1/2" x 1 1/2" bolts you positioned in step 10 (Fig.Q).



MOUNTING BRACKET KIT INSTALLATION INSTRUCTIONS

KIT# 344-1

07/28/08
KS

ROADMASTER, Inc. 6110 NE 127th Ave. Vancouver, WA 98682 1-800-669-9690 fax 360-735-9300 www.roadmasterinc.com

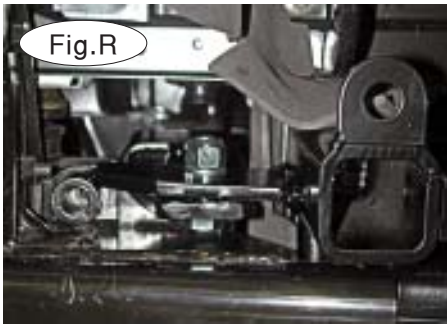

13. Now, thread two 1/2" lock washers and nuts over the bolts to secure them (Fig.R). Finger-tighten only at this time. Repeat for the other side.



14. Thread a 12mm x 1.25 x 80mm bolt, with a 12mm lock washer and flat washer, through each main brace and into the existing weld nut in the frame rail (Fig.S).

15. Tighten all bolts to the torque specifications at the bottom of these instructions.

16. Using the hole in the main brace as a template, drill a 1/2" hole through the bumper core (Fig.T). Bolt through the hole with a 1/2" x 4" bolt, lock washer and nut (Fig.U). Repeat for the other side. Tighten the two bolts to the torque specifications at the bottom of these instructions.

17. Before reassembling the fascia, trim a small portion of the lower opening at each side of the grille, on the lower edge, to accommodate the removable bracket arms. Trim down one inch, and six inches across – use Figure V as a reference.

18. Reassemble the fascia, reversing steps 1 through 8.

19. Fit the front bracket arms into the front receiver braces, and secure them in place with the supplied 5/8" draw pins and spring pins.

20. Attach the 8" safety cables with the cable connectors (Q-Links) to the front of the receiver braces (Fig.W).

21. Attach the ends of the safety cables to the main receiver brace.

22. Install the tow bar to the mounting bracket according to the manufacturer's instructions.

BOLT TORQUE REQUIREMENTS

Note: The torque values represented below are intended as general guidelines. Torque requirements for specific applications may vary. Roadmaster does not warrant this information to be accurate for all applications and disclaims all liability for any claims or damages which may result from its use.

STANDARD BOLTS

Thread Size	Grade	Torque
5/16	5	13 ft./lb.
3/8	5	23 ft./lb.
7/16	5	37 ft./lb.
1/2	5	56 ft./lb.
5/8	5	150 ft./lb.

METRIC BOLTS

Thread Size	Grade	Plated / Unplated
8mm-1.0	8.8	20 ft./lb. 18 ft./lb.
8mm-1.25	8.8	19 ft./lb. 18 ft./lb.
10mm-1.25	8.8	38 ft./lb. 36 ft./lb.
10mm-1.5	8.8	37 ft./lb. 35 ft./lb.

METRIC BOLTS

Thread Size	Grade	Plated / Unplated
12mm-1.25	8.8	70 ft./lb. 65 ft./lb.
12mm-1.5	8.8	66 ft./lb. 61 ft./lb.
12mm-1.75	8.8	65 ft./lb. 60 ft./lb.
14mm-2.0	8.8	104 ft./lb. 97 ft./lb.

All illustrations and specifications contained herein are based on the latest information available at the time of publication approval. ROADMASTER, INC. reserves the right to make changes at any time without notice in material, specification and models or to discontinue models.