

BASEPLATE KIT INSTALLATION INSTRUCTIONS

ROADMASTER, Inc. 6110 NE 127th Ave. Vancouver, WA 98682 1-800-669-9690 fax 360-735-9300 www.roadmasterinc.com

PARTS LIST:
1- FRONT BRACE (A)
1- MAIN RECEIVER (B)

KIT NO. 464-1

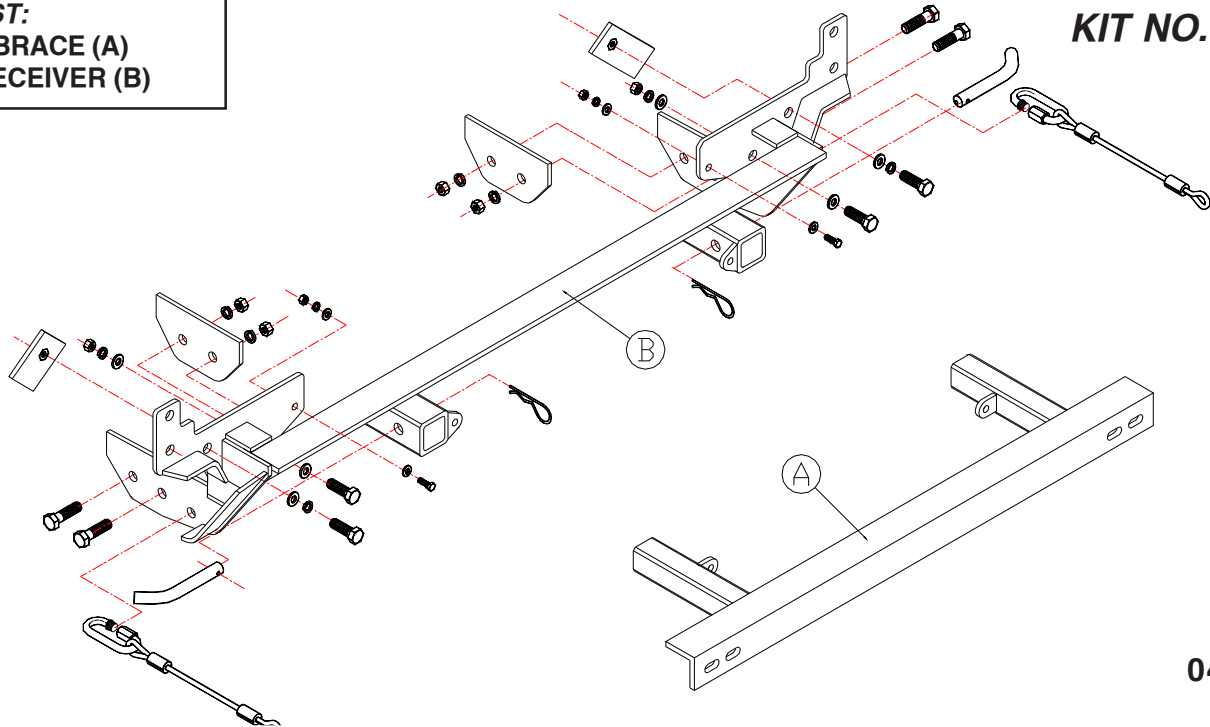

040998

IMPORTANT: All baseplates **must** be assembled with all the bolts left loose for final adjustment and positioning (before tightening) unless otherwise instructed. All bolts **must** be torqued for proper strength. If more than one bolt is used per fastening point, the diagram may only show one.

- Use flat washers over all slotted holes
- Use lock washers on all fasteners

WARNING

Failure to follow the below warnings and the installation instructions may result in voiding your warranty, property damage, the loss of your towed vehicle, personal injury or even death.

- Installation of most baseplates requires moderate mechanical aptitude and skills. We strongly recommend professional installation by an experienced installer.
- The installer must read the instructions and use all bolts and parts supplied.
- Use Loctite® Red on all bolts used for mounting this baseplate.
- Every 3,000 miles, the owner must inspect the fasteners for proper torque, according to the bolt torque requirements chart on the last page of these instructions. The owner must also inspect all mounting points for cracks or other signs of fatigue every 3,000 miles.
- The owner must check the vehicle manufacturer's instructions for the proper procedure(s) to prepare the vehicle for towing. Some vehicles must be equipped with a transmission lube pump, an axle disconnect, driveline disconnect or free-wheeling hubs before they can be towed. Failure to properly equip the vehicle will cause severe damage to the transmission.
- Do not weld. This baseplate is designed to be bolted to the vehicle. Welding will void the warranty.
- Do not use this document for custom fabrication, as it may not show all parts or structural components could result in loss of the towed vehicle.
- If the towed vehicle has been in an accident, it must be properly repaired before attaching the baseplate. Do not install the baseplate if any structural frame damage is found.
- If running changes were made by the vehicle manufacturer after this

kit was designed, some bolts or other fasteners in the hardware pack may no longer be the correct size. It is the installer's responsibility to verify this kit is securely fastened to the vehicle and fitted with the correct hardware to account for these changes.

- Roadmaster manufactures many styles of baseplates. If your baseplate has removable arms, they must be removed before driving the vehicle, unless the arms can be pinned or padlocked in place. If not secured, the arms could vibrate out.
- Some motorhome chassis have such a tight turning radius that you can damage your motorhome, towed vehicle, tow bar or baseplate while turning sharply. Before getting on the road, test your turning radius in an empty parking lot. Turning too sharply could result in non-warranty damage to towing system, motorhome and/or towed vehicle.
- Do not back up with the towed vehicle attached or non-warranty damage will occur to your towing system, motorhome and/or towed vehicle.
- The safety cables must connect the towing vehicle to the towed vehicle frame to frame, with the cables crossed, with enough slack for sharp turns. Refer to the cable instructions for proper routing. Failure to leave enough slack in the safety cables, or failure to connect the safety cables frame to frame, will result in the loss of the towed vehicle.
- This kit is designed for use with ROADMASTER tow bars and ROADMASTER adapters only. Using this kit with other brands, without an approved ROADMASTER adapter, may result in non-warranty damage or injury.
- Upon final installation, the installer must inspect the baseplate to ensure adequate clearance, particularly around hoses, air conditioner lines, radiators, etc.
- This baseplate is only warranted for the original installation. Installing a used baseplate on another vehicle is not recommended and will void the warranty.

BASEPLATE KIT INSTALLATION INSTRUCTIONS

ROADMASTER, Inc. 6110 NE 127th Ave. Vancouver, WA 98682 1-800-669-9690 fax 360-735-9300 www.roadmasterinc.com

KIT NO. 464-1

1. **Important:** please use all supplied bolts and parts and read all instructions carefully before beginning this installation. The majority of questions you may have can be answered within the text, and proper installation will ensure safe and secure travel. Now, begin the installation. This bracket kit is one of our XL series which is designed to be partly removable. The main receiver brace bolts to the front of the frame and tie down plates on each side, utilizing existing bumper mounting bolts and holes in the tie down plates. The front braces protrude through the grill below the bumper when mounted. The plastic bumper fascia and front grill will have to be removed as will the bumper core. To start, remove two small screws in the lip of each fender well liner. Pull the liner out of the way and locate two 9mm head bolts in the top of each fender well. Use a extension and remove these bolts. Now go to the top of the grill and remove four small keeper bolts. Unplug the fog light connectors if present and pull the bumper skin forward to remove. Set the bumper fascia aside for now.
2. Remove the plastic bumper core by removing two nuts on each side from the rear of the core. Set this aside also.
3. Hold the receiver brace to the front of the vehicle and sandwich the front mounting plates between the bumper core and front mounting area. Replace the nuts removed in step two. This will hold the brace in position for the following steps.
4. Bolt through the lower inside front of the mounting plate on each side using 8mm x 1.25 x 30mm bolts, fender washers, lock washers and nuts. Bolt through the two 1/2" holes on each side with 7/16" x 1 1/2" bolts, flat washers lock washers and nuts. Note: The bottom outer hole on each side will take a special threaded 1/4" x 2" x 3 1/2" backing plate which must be inserted behind the bolt.
5. On each side of the vehicle will be a bolted on formed tie down plate, sandwich the receiver brace to these plates with 1/4" backing plates, 1/2" x 1 3/4" bolts, lock washers and nuts.
6. Tighten all the mounting bolts to the torque specifications below.
7. Replace the bumper fascia and grill removed by reversing the steps in step one. The receiver tubes should protrude through the grill openings.
7. Insert the front braces into the receiver tubes and pin with 5/8" draw pins and 1/8" spring pins.
8. Install the tow bar according to the manufacturer's instructions and torque all mounting bolts to the specifications below.
9. Attach one end of the included 16" safety cables to the lower front hole in the side mounting plate on each side of the receiver brace with the included cable connectors. Connect the other end to the tow vehicle's safety cables and the tow bar.

Hardware

- | | | |
|--|-----------------------------------|---------------|
| 2- 8mm x 1.25 x 30mm bolts | 4- 1/2" x 1-3/4" bolts | |
| 4- 8mm fender washers | 4- 1/2" lock washers | |
| 2- 8mm lock washers | 4- 1/2" nuts | |
| 2- 8mm nuts | 2- shaped two hole backing plates | 040998 |
| 4- 7/16" x 1-1/2" bolts | 2- 16" safety cables | |
| 6- 7/16" flat washers | 2- cable connectors | |
| 4- 7/16" lock washers | 2- 5/8" draw pins | |
| 2- 7/16" nuts | 2- 1/8" spring pins | |
| 2- 1/4" x 2 X 3 1/2" threaded backing plates | | |

BOLT TORQUE REQUIREMENTS

Note: The torque values represented below are intended as general guidelines. Torque requirements for specific applications may vary. Roadmaster does not warrant this information to be accurate for all applications and disclaims all liability for any claims or damages which may result from its use.

STANDARD BOLTS			METRIC BOLTS			METRIC BOLTS		
Thread Size	Grade	Torque	Thread Size	Grade	Plated/Unplated	Thread Size	Grade	Plated/Unplated
5/16	5	13 ft./lb.	8mm-1.0	8.8	20 ft./lb. 18 ft./lb.	12mm-1.25	8.8	70 ft./lb. 65 ft./lb.
3/8	5	23 ft./lb.	8mm-1.25	8.8	19 ft./lb. 18 ft./lb.	12mm-1.5	8.8	66 ft./lb. 61 ft./lb.
7/16	5	37 ft./lb.	10mm-1.25	8.8	38 ft./lb. 36 ft./lb.	12mm-1.75	8.8	65 ft./lb. 60 ft./lb.
1/2	5	56 ft./lb.	10mm-1.5	8.8	37 ft./lb. 35 ft./lb.	14mm-2.0	8.8	104 ft./lb. 97 ft./lb.
5/8	5	150 ft./lb.						