



BASEPLATE KIT INSTALLATION INSTRUCTIONS

KIT# 493-1

03/10/08
KS

ROADMASTER, Inc. 6110 NE 127th Ave. Vancouver, WA 98682 1-800-669-9690 fax 360-735-9300 www.roadmasterinc.com

Special tools required

1- Drill bit - 1/2" x 12"

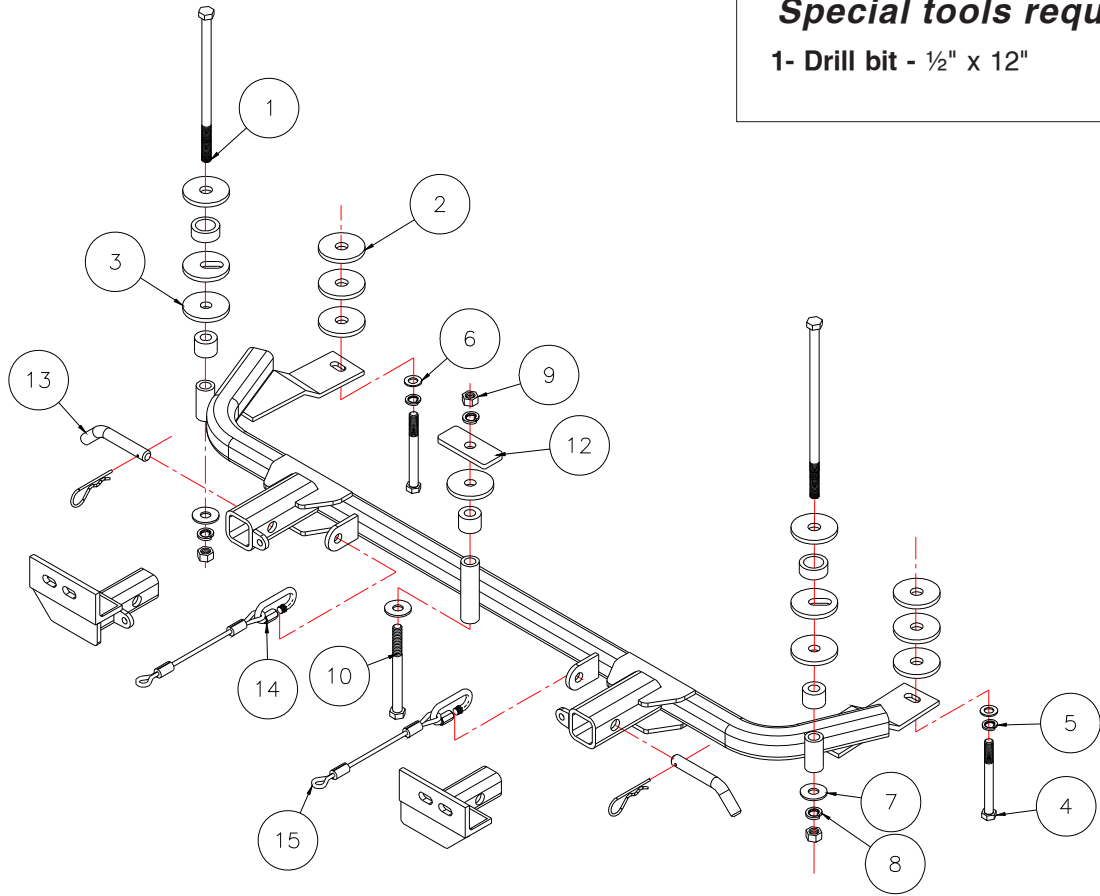

Item	Qty	Length	Width	Hardware	Part No.
1	2	10 1/2"	1/2"	BOLT	350121-00
2	8		5/8"	PLATE WASHER	350352-00
3	3		1/2"	PLATE WASHER	A003086
4	2	120mm	12mm	BOLT 1.75P	357210-00
5	2		12mm	LOCK WASHER	355725-00
6	2		12mm	FLAT WASHER	355720-00
7	2		1/2"	FLAT WASHER	350308-20
8	3		1/2"	LOCK WASHER	350309-00
9	3		1/2"	NUT	350258-00
10	1	5 1/2"	1/2"	BOLT	350108-00
13	2			DRAW PIN/SPRING PIN	357035-00
14	2			CABLE CONNECTORS	200008-00
15	2	10"		CABLES	500646-10

ROADMASTER, INC.



BASEPLATE KIT INSTALLATION INSTRUCTIONS

KIT# 493-1
03/10/08
KS

ROADMASTER, Inc. 6110 NE 127th Ave. Vancouver, WA 98682 1-800-669-9690 fax 360-735-9300 www.roadmasterinc.com

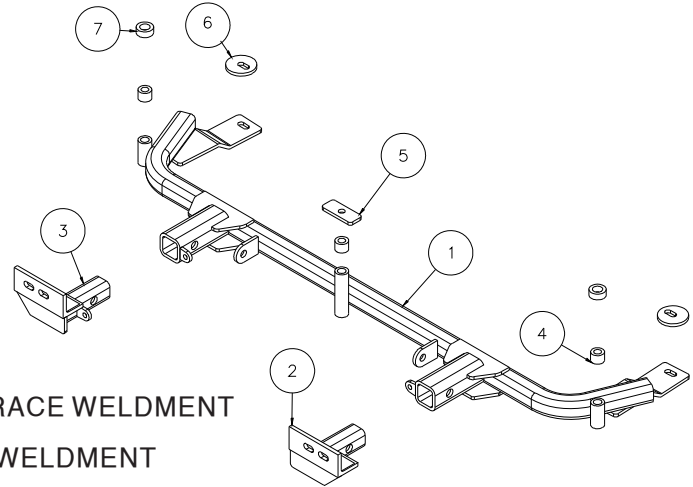

Item	Qty	Part No.	Assemblies
1	1	C-000693	MAIN RECEIVER BRACE WELDMENT
2	1	C-000694	DRIVER SIDE ARM WELDMENT
3	1	C-000695	PASSENGER SIDE ARM WELDMENT
4	3	A-001177	1" O.D. X 3/4" RD .219 WALL TUBE SPACER
5	1	A-000097	1/4" X 1 1/4" X 3" BACKING PLATE
6	2	A-001189	SLOTTED PLATE WASHER

IMPORTANT: All baseplates **must** be assembled with all the bolts left loose for final adjustment and positioning (before tightening) unless otherwise instructed. All bolts **must** be torqued for proper strength. If more than one bolt is used per fastening point, the diagram may only show one. Use flat washers over all slotted holes and lock washers on all fasteners.

WARNING

Failure to heed these warnings or follow the installation instructions may result in a voided warranty, loss of towed vehicle, personal injury or death.

- Do not weld or modify this baseplate or its components. Welding or modification will void the warranty.
- Do not use this document as a basis to design/fabricate a baseplate, as it may not show all parts or structural components.
- We strongly recommend professional installation.
- If the towed vehicle has been in an accident, it must be properly repaired before attaching the baseplate. Do not install the baseplate if any structural frame damage is found.
- The installer must use all bolts and parts supplied. If running changes were made by the vehicle manufacturer after this kit was designed, some bolts or other fasteners may no longer be the correct size. It is the installer's responsibility to verify this kit is securely fastened to the vehicle.
- Use Loctite® Red on all bolts used to secure this baseplate. Torque all bolts to the specifications found at the end of these instructions. Do not over-torque the bolts or failure may occur.
- The installer must inspect the baseplate to ensure adequate clearance, particularly around hoses, air conditioner lines, radiators, etc. or non-warranty failure may result.
- Roadmaster manufactures many styles of baseplates. If your baseplate has removable arms, they must be removed before driving the vehicle, unless the arms can be pinned or padlocked in place. If not secured, the arms could vibrate out.
- Some motorhome chassis have such a tight turning radius that you can damage your motorhome, towed vehicle, tow bar or baseplate while turning sharply. Before getting on the road, test your turning radius in an empty parking lot. Turning too sharply could

result in non-warranty damage to your towing system, motorhome and/or towed vehicle.

- Do not back up with the towed vehicle attached or non-warranty damage will occur to your towing system or vehicles.
- The safety cables must connect the towing vehicle to the towed vehicle frame to frame, with the cables crossed, with enough slack for sharp turns. See cable instructions for proper routing. Failure to do so will result in non-warranty damage and/or the loss of the towed vehicle.
- This kit is designed for use with ROADMASTER tow bars and ROADMASTER adapters only. Using this kit with other brands, without an approved ROADMASTER adapter, may result in non-warranty damage or injury.
- Receiver extensions and out-of-level towing situations of 3 inches or more. This can cause the system to swing much higher and lower, causing excessive strain on the tow bar, baseplate and frame. That can cause the towing system to fail, causing property damage, personal injury or even death. If you must use a receiver extension or drop hitch to tow, it will reduce your receiver's weight capacity by 1/3 to avoid damaging your system. Never use more than one extension and/or drop hitch, as this will void your warranty.
- Every 3,000 miles, the owner must inspect all mounting points for cracks or fatigue, and check the fasteners for proper torque, according to the bolt torque requirements chart on the last page of these instructions.
- The owner must follow the vehicle manufacturer's instructions to prepare the vehicle for towing. Failure to do so may cause severe damage to the vehicle.
- This baseplate is only warranted for the original installation. Installing a used baseplate on another vehicle is not recommended and will void the warranty.



BASEPLATE KIT INSTALLATION INSTRUCTIONS

KIT# 493-1
03/10/08
KS

ROADMASTER, Inc. 6110 NE 127th Ave. Vancouver, WA 98682 1-800-669-9690 fax 360-735-9300 www.roadmasterinc.com

1. This bracket kit is one of our XL series, which is designed to be partly removable. The kit consists of the main receiver brace, front braces, rear side braces and a hardware pack. The main receiver brace mounts under the bumper core behind the front bumper fascia to the front frame and radiator support area on each side. The front braces insert into the receivers on each side. Start by laying the kit out according to the illustration. This will give you a visual idea of how the kit installs and also confirm that the kit components are present and accounted for (Fig.A).



2. **Important:** please use all supplied bolts and parts and read all instructions carefully before beginning this installation. The majority of questions you may have can be answered within the text, and proper installation will ensure safe and secure travel. Now, begin the installation. Start by removing five plastic fasteners in the top plastic grille cover (Fig.B). Once the fasteners are removed simply lift the cover off and set aside.

3. Remove three phillips screws in each fenderwell (Fig.C).

4. Remove three screws under the fascia on each side (Fig.D) then remove five more fasteners in the middle (Fig.E).



5. Now, go to the fascia fender junction on each side and remove two 10mm (head) screws per side (Fig.F), then pull forward to remove the fascia (Fig.G,H).

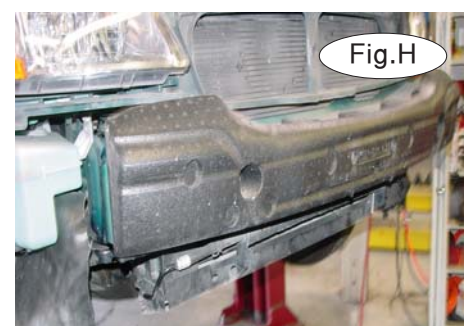



BASEPLATE KIT INSTALLATION INSTRUCTIONS

KIT# 493-1
03/10/08
KS

ROADMASTER, Inc. 6110 NE 127th Ave. Vancouver, WA 98682 1-800-669-9690 fax 360-735-9300 www.roadmasterinc.com

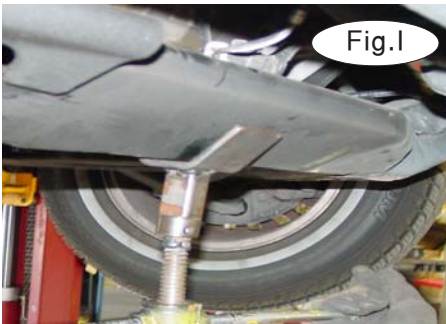

Fig.I



Fig.J

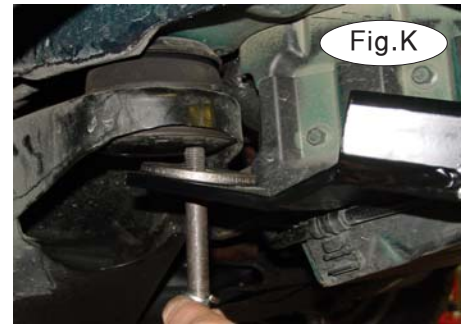

Fig.K

6. Support the middle of the subframe (Fig.I).

7. Remove the main subframe support bolts (Fig.J) on each side. Hold the main receiver brace in position then bolt through the rear of the receiver brace with a 12mm x 1.75 x 120mm bolt and slotted 5/8" plate washer (Fig.K). Make certain that plate washers are between the subframe mount and the receiver brace (Fig.L). Tighten to hold in position.



Fig.L

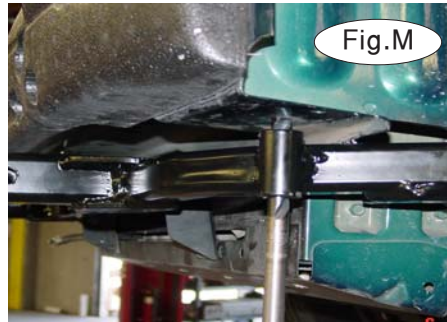

Fig.M

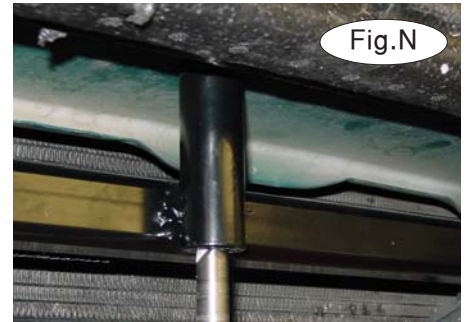

Fig.N

8. Using the brace as a template, drill three 1/2" holes through the bumper core core with a long drill bit (Fig.M,N).

9. If your vehicle is older than 2003, disregard this step. Later vehicles will require spacing the receiver brace down to match the openings in the lower grille. If your vehicle is the newer vehicle, use 1/2" spacers between the bottom of the bumper core and the three front mounts (Fig.O). The rear mounts will use three flat plate washers between the subframe and the receiver brace on each side.

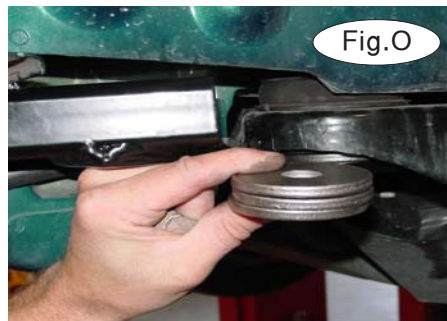

Fig.O



Fig.P

10. Bolt through the front center mount with a 1/2" x 5 1/2" bolt, flat washer, 1/4" x 1 1/2" x 3" backing plate, lock washer and nut (Fig.P,Q). Use the flat washer between the brace and the bottom of the bumper core (Fig.Q). *Note:* if the vehicle is a 2003 or later, include the spacer mentioned in step 7 (Fig.R).



Fig.Q



Fig.R



BASEPLATE KIT INSTALLATION INSTRUCTIONS

KIT# 493-1
03/10/08
KS

ROADMASTER, Inc. 6110 NE 127th Ave. Vancouver, WA 98682 1-800-669-9690 fax 360-735-9300 www.roadmasterinc.com

11. Bolt through two side front mounts into the bottom of the bumper core with two 1/2" x 10 1/2" bolts (Fig.S).

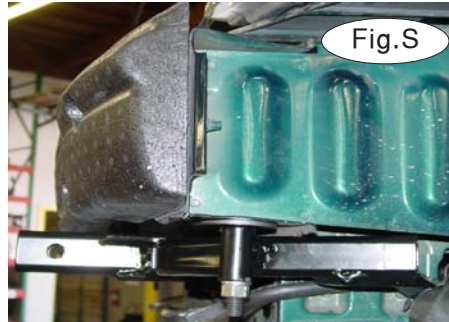

12. Torque all mounting bolts to the torque specifications found at the end of this document.



13. Trim the lower splash panels as needed to refit.

14. Replace the fascia reversing steps 2 through 4.

15. Insert the front braces into the receiver tubes and secure with 5/8" draw pins and spring pins (Fig.U,V).

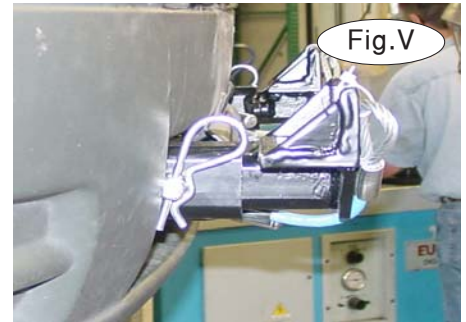
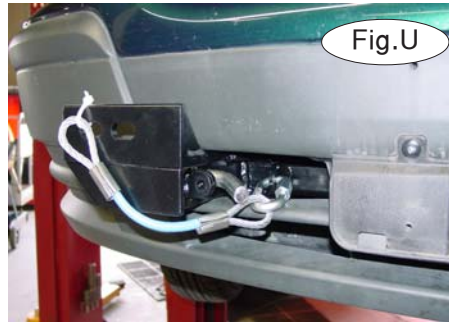

16. Install the tow bar according to the manufacturer's instructions.

18. Attach one end of the 10" safety cables to front holes on the receiver cross bar on each side of the receiver brace with the included cable connectors. Connect the other end to the tow vehicle's safety cables and the tow bar.

BOLT TORQUE REQUIREMENTS

Note: The torque values represented below are intended as general guidelines. Torque requirements for specific applications may vary. Roadmaster does not warrant this information to be accurate for all applications and disclaims all liability for any claims or damages which may result from its use.

STANDARD BOLTS

Thread Size	Grade	Torque
5/16	5	13 ft./lb.
3/8	5	23 ft./lb.
7/16	5	37 ft./lb.
1/2	5	56 ft./lb.
5/8	5	150 ft./lb.

METRIC BOLTS

Thread Size	Grade	Plated / Unplated
8mm-1.0	8.8	20 ft./lb. 18 ft./lb.
8mm-1.25	8.8	19 ft./lb. 18 ft./lb.
10mm-1.25	8.8	38 ft./lb. 36 ft./lb.
10mm-1.5	8.8	37 ft./lb. 35 ft./lb.

METRIC BOLTS

Thread Size	Grade	Plated / Unplated
12mm-1.25	8.8	70 ft./lb. 65 ft./lb.
12mm-1.5	8.8	66 ft./lb. 61 ft./lb.
12mm-1.75	8.8	65 ft./lb. 60 ft./lb.
14mm-2.0	8.8	104 ft./lb. 97 ft./lb.

All illustrations and specifications contained herein are based on the latest information available at the time of publication approval. ROADMASTER, INC. reserves the right to make changes at any time without notice in material, specification and models or to discontinue models.