



BASEPLATE KIT INSTALLATION INSTRUCTIONS

KIT# 499-1

12/26/07
KS

ROADMASTER, Inc. 6110 NE 127th Ave. Vancouver, WA 98682 1-800-669-9690 fax 360-735-9300 www.roadmasterinc.com

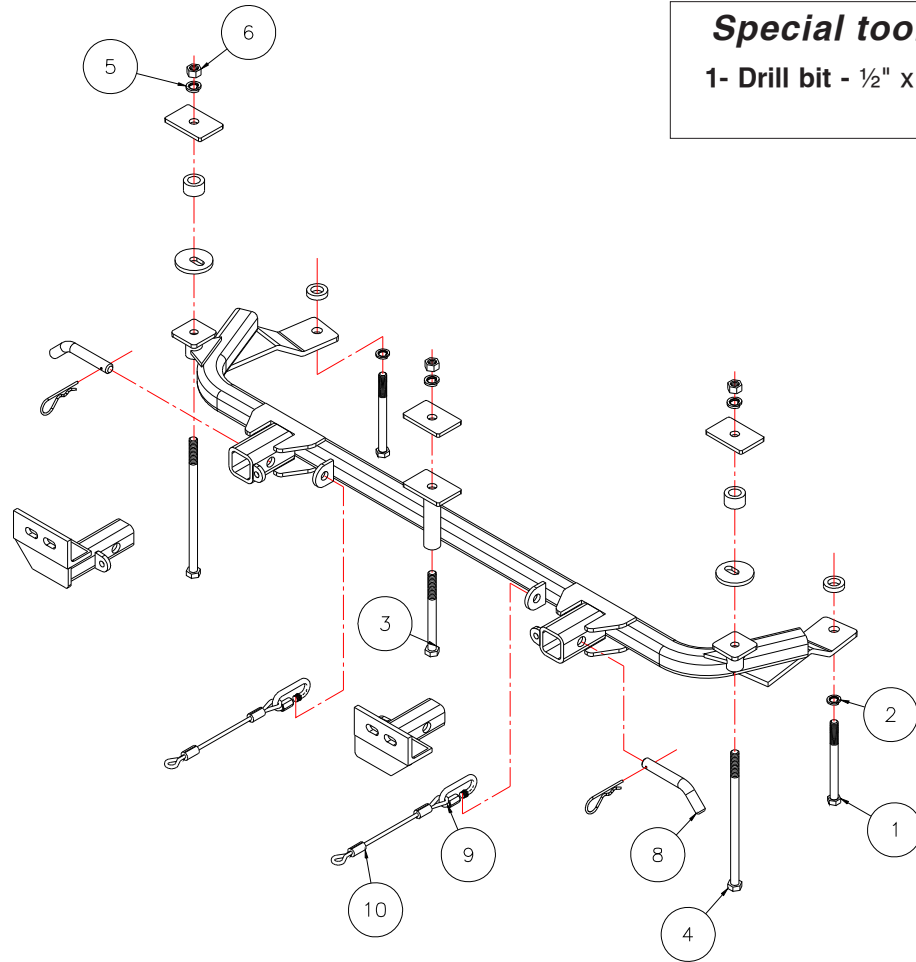

Special tools required
1- Drill bit - 1/2" x 12"

Item	Qty	Length	Width	Hardware	Part No.
1	2	2.0mm	14mm	14mm x 2.0 x 160mm BOLT	355910-00
2	2		14mm	LOCK WASHER	355740-00
3	1	5 1/2"	1/2"	BOLT	350108-00
4	2	9 1/2"	1/2"	BOLT	350118-00
5	3		1/2"	LOCK WASHER	350309-00
6	3		1/2"	NUT	350258-00
7	2		2 1/4" O.D.	1/4" SLOTTED PLATE WASHER	100032-01
8	2			DRAW PIN/SPRING PIN	357035-00
9	2			CABLE CONNECTOR	200008-00
10	2	8"		SAFETY CABLE	500646-08



BASEPLATE KIT INSTALLATION INSTRUCTIONS

KIT# 499-1

12/26/07
KS

ROADMASTER, Inc. 6110 NE 127th Ave. Vancouver, WA 98682 1-800-669-9690 fax 360-735-9300 www.roadmasterinc.com

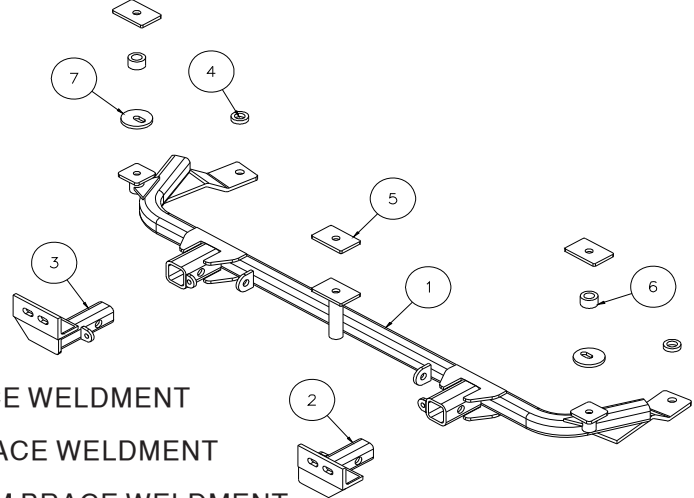

ITEM	QTY	PART NO.	ASSEMBLY
1	1	C-000919	MAIN RECEIVER BRACE WELDMENT
2	1	C-000920	DRIVER SIDE ARM BRACE WELDMENT
3	1	C-000921	PASSENGER SIDE ARM BRACE WELDMENT
4	2	A-001584	1 1/4" O.D. x 5/16" x .250 WALL TUBE
5	3	A-000147	1/4" x 2" X 3" BACKING PLATE
6	2	A-000559	1 1/4" O.D. x 3/4" x .250 WALL TUBE
7	2	A-001189	2 1/4" O.D. SLOTTED PLATE WASHER

IMPORTANT: All brackets **must** be assembled with all the bolts left loose for final adjustment and positioning (before tightening) unless otherwise instructed. All bolts **must** be torqued for proper strength. If more than one bolt is used per fastening point, the diagram may only show one.

- Use flat washers over all slotted holes
- Use lock washers on all fasteners

WARNING

Failure to follow these instructions can result in property damage, personal injury or even death.

- Installation of most mounting brackets requires moderate mechanical aptitude and skills. We strongly recommend professional installation by an experienced installer.
- The installer must read the instructions and use all bolts and parts supplied. Failure to do so could result in loss of the towed vehicle.
- Use Loctite® Red on all bolts used for mounting this bracket.
- Do not use this document for custom fabrication, as it may not show all parts or structural components. Custom fabrication or an attempt to copy this bracket design could result in loss of the towed vehicle.
- Every 3,000 miles, the owner must inspect the fasteners for proper torque, according to the bolt torque requirements chart on the last page of these instructions. The owner must also inspect all mounts and brackets for cracks or other signs of fatigue every 3,000 miles. Failure to do so could result in loss of the towed vehicle.
- The owner must check the vehicle manufacturer's instructions for the proper procedure(s) to prepare the vehicle for towing. Some vehicles must be equipped with a transmission lube pump, an axle disconnect, driveline disconnect or free-wheeling hubs before they can be towed. Failure to properly equip the vehicle will cause severe damage to the transmission.
- If running changes were made by the vehicle manufacturer after this bracket was designed, some bolts or other fasteners in the hardware pack may no longer be the correct size. It is the installer's responsibility to verify that the bracket is securely fastened to the vehicle and fitted with the correct hardware to account for these changes. Failure to securely fasten the bracket could result in loss of the towed vehicle.
- If the towed vehicle has been in an accident, it must be properly repaired before attaching the bracket. Do not install the bracket if any structural frame damage is found. Failure to repair the damage could result in the loss of the towed vehicle.
- Some motorhome chassis have such a tight turning radius that you can damage your motorhome, towed vehicle, tow bar or bracket while turning sharply. Before getting on the road, test your turning radius in an empty parking lot. Turning too sharply could result in non-warranty damage to towing system, motorhome and/or towed vehicle.
- Do not back up with the towed vehicle attached or non-warranty damage will occur to your towing system, motorhome and/or towed vehicle.
- The safety cables must connect the towing vehicle to the towed vehicle frame to frame, with the cables crossed, with enough slack for sharp turns. Refer to the cable instructions for proper routing. Failure to leave enough slack in the safety cables, or failure to connect the safety cables frame to frame, will result in the loss of the towed vehicle.
- This bracket is designed for use with ROADMASTER tow bars and ROADMASTER adaptors only. Using this bracket with other brands, without an approved ROADMASTER adaptor, may result in non-warranty damage or injury.
- Upon final installation, the installer must inspect the bracket to ensure adequate clearance, particularly around hoses, air conditioner lines, radiators, etc., or non-warranty damage to the towed vehicle will result.
- This bracket is only warranted for the original installation. Installing a used bracket on another vehicle is not recommended and will void the warranty.



BASEPLATE KIT INSTALLATION INSTRUCTIONS

KIT# 499-1

12/26/07
KS

ROADMASTER, Inc. 6110 NE 127th Ave. Vancouver, WA 98682 1-800-669-9690 fax 360-735-9300 www.roadmasterinc.com

This bracket kit is one of our XL series, which is designed to be partly removable. The kit consists of the main receiver brace, front braces and a hardware pack. The main receiver brace mounts under the bumper core behind the front bumper facia to the front frame and radiator support area on each side. The front braces insert into the receivers on each side (Fig.A). Start by laying the kit out according to the illustration. This will give you a visual idea of how the kit installs and also confirm that the kit components are present and accounted for. *Note:* do not cut the wiring harness when wiring this vehicle, instead use a Roadmaster #155 bulb and socket set.



1. **Important:** please use all supplied bolts and parts and read all instructions carefully before beginning this installation. The majority of questions you may have can be answered within the text, and proper installation will ensure safe and secure travel. Now, begin the installation. Start by removing eight plastic fasteners in the top plastic grille cover (Fig.B). Once the fasteners are removed simply lift the cover off and set aside (Fig.C).

2. Remove five plastic fasteners from the top of the fascia under the grille cover (Fig.D).



3. Pull up on two head light retainers on each side (Fig.E), then disconnect the headlights (Fig.F) and set aside.

4. Now, remove two 8mm (head) bolts from the fascia fender junctions on each side (Fig.G). They are located behind the headlights.



BASEPLATE KIT INSTALLATION INSTRUCTIONS

KIT# 499-1

12/26/07
KS

ROADMASTER, Inc. 6110 NE 127th Ave. Vancouver, WA 98682 1-800-669-9690 fax 360-735-9300 www.roadmasterinc.com



Fig.H



Fig.I



Fig.J

5. Remove two Phillips head screws from each front fender well (Fig.H), then move to the bottom of the fascia and remove nine more Phillips head screws (Fig.I,J).



Fig.K



Fig.L



Fig.M

6. Disconnect the fog lights on each side (Fig.K), then pull forward while pushing down on the top lock tabs located in each headlight opening (Fig.L). Pull off and set aside (Fig.M). Check the wiring harness and if it's routed under the bumper core, pull loose in preparation for mounting the receiver brace (Fig.N).



Fig.N



Fig.O



Fig.P

7. Support the subframe (Fig.O), then remove the front subframe bolts (18mm head) on each side (Fig.P).

8. Bolt through the rear mounting holes in the main receiver brace with two 14mm x 2.0mm x 160mm bolts, lock washers (Fig.Q) and 5/16" spacers between the receiver brace and the subframe on each side, then tighten to hold in position.



Fig.Q



BASEPLATE KIT INSTALLATION INSTRUCTIONS

KIT# 499-1

12/26/07
KS

ROADMASTER, Inc. 6110 NE 127th Ave. Vancouver, WA 98682 1-800-669-9690 fax 360-735-9300 www.roadmasterinc.com

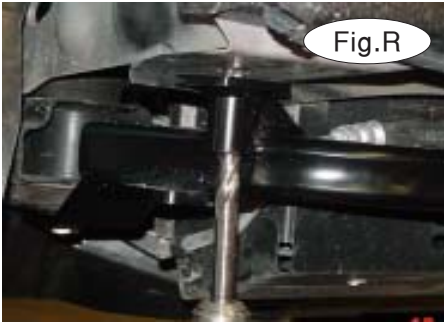

Fig.R



Fig.S



Fig.T

9. Using the receiver brace as a template, drill a $\frac{1}{2}$ " hole through the frame on each side (Fig.R).

10. Put a slotted spacer washer between the bottom of the frame and bumper core and a $\frac{3}{4}$ " spacer on top of the frame between the frame and bumper core, then bolt through the frame and bumper core on each side with $\frac{1}{2}$ " x $9\frac{1}{2}$ " bolts, 2" x 3" backing plate, lock washer and nut (Fig.S). Tighten these bolts (Fig.T).

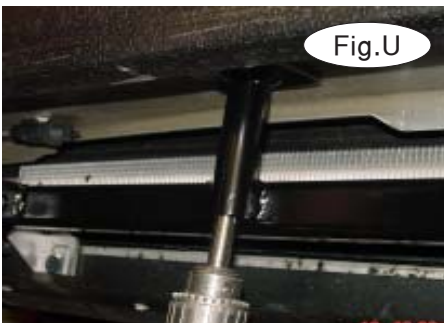

Fig.U



Fig.V



Fig.W

11. Drill another $\frac{1}{2}$ " hole through the bottom of the bumper core using the center mounting hole in the receiver brace as a guide (Fig.U).

12. Most vehicles will have a cooler limiting access to the back of the bumper core, if this is the case temporarily dismantle the cooler (two 8mm head bolts) (Fig.V) to gain access inside the bumper core.

13. Put a 2" x 3" backing plate inside the bumper core over the hole drilled in step 11, then bolt through the receiver brace, bumper core and backing plate with a $\frac{1}{2}$ " x $5\frac{1}{2}$ " bolt, lock washer and nut (Fig.W).

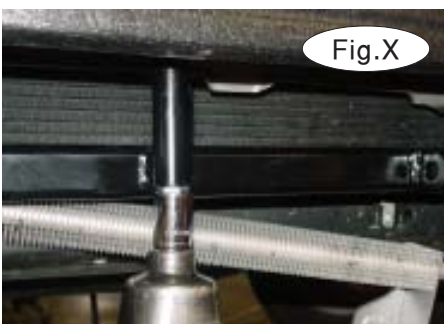

Fig.X



Fig.Y



Fig.Z

14. Now tighten this bolt and all the rest of the mounting bolts to the torque specifications on the last page (Fig.X).

15. Remount the cooler and the wiring harness to the bumper core (Fig.Y,Z).



BASEPLATE KIT INSTALLATION INSTRUCTIONS

KIT# 499-1

12/26/07
KS

ROADMASTER, Inc. 6110 NE 127th Ave. Vancouver, WA 98682 1-800-669-9690 fax 360-735-9300 www.roadmasterinc.com

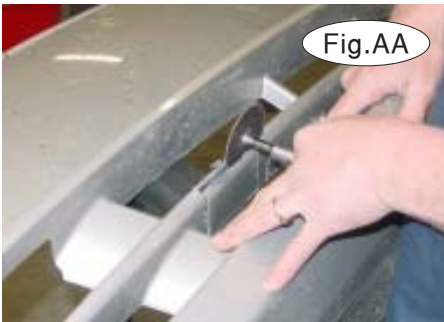

Fig. AA



Fig. BB

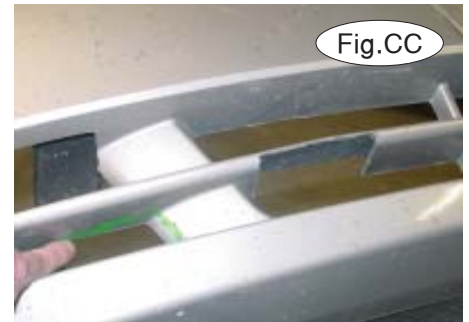

Fig. CC

16. Trial fit the fascia and mark the areas shown, then trim the grille in the areas shown (Fig. AA, BB, CC, DD, EE, FF).

17. Refit the fascia reversing steps 1 through 6.



Fig. DD



Fig. EE



Fig. FF



Fig. GG



Fig. HH



Fig. II

18. Insert the front braces into the receiver tubes and secure with 5/8" draw pins and spring pins (Fig. GG, HH).

19. Install the tow bar according to the manufacturer's instructions and torque all mounting bolts to the specifications below.

20. Attach one end of the 8" safety cables to the front holes on the receiver cross bar on each side of the brace with the included cable connectors (Fig. II, JJ). Connect the other end to the tow vehicle's safety cables and tow bar.



Fig. JJ



BASEPLATE KIT INSTALLATION INSTRUCTIONS

KIT# 499-1

12/26/07
KS

ROADMASTER, Inc. 6110 NE 127th Ave. Vancouver, WA 98682 1-800-669-9690 fax 360-735-9300 www.roadmasterinc.com

BOLT TORQUE REQUIREMENTS

Note: The torque values represented below are intended as general guidelines. Torque requirements for specific applications may vary. Roadmaster does not warrant this information to be accurate for all applications and disclaims all liability for any claims or damages which may result from its use.

STANDARD BOLTS

Thread Size	Grade	Torque
5/16	5	13 ft./lb.
3/8	5	23 ft./lb.
7/16	5	37 ft./lb.
1/2	5	56 ft./lb.
5/8	5	150 ft./lb.

METRIC BOLTS

Thread Size	Grade	Plated / Unplated
8mm-1.0	8.8	20 ft./lb. 18 ft./lb.
8mm-1.25	8.8	19 ft./lb. 18 ft./lb.
10mm-1.25	8.8	38 ft./lb. 36 ft./lb.
10mm-1.5	8.8	37 ft./lb. 35 ft./lb.

METRIC BOLTS

Thread Size	Grade	Plated / Unplated
12mm-1.25	8.8	70 ft./lb. 65 ft./lb.
12mm-1.5	8.8	66 ft./lb. 61 ft./lb.
12mm-1.75	8.8	65 ft./lb. 60 ft./lb.
14mm-2.0	8.8	104 ft./lb. 97 ft./lb.

All illustrations and specifications contained herein are based on the latest information available at the time of publication approval. ROADMASTER, INC. reserves the right to make changes at any time without notice in material, specification and models or to discontinue models.