

BASEPLATE KIT INSTALLATION INSTRUCTIONS

ROADMASTER, Inc. 6110 NE 127th Ave. Vancouver, WA 98682 1-800-669-9690 fax 360-735-9300 www.roadmasterinc.com

PARTS LIST:

- 1- FRONT BRACE (A) - Passenger side
- 1- FRONT BRACE (B) - Driver side
- 1- RECEIVER BRACE (C) - Passenger side
- 1- RECEIVER BRACE (D) - Driver side
- 1- CENTER BRACE (E)

KIT NO. 521612-1

01-26-05
RV

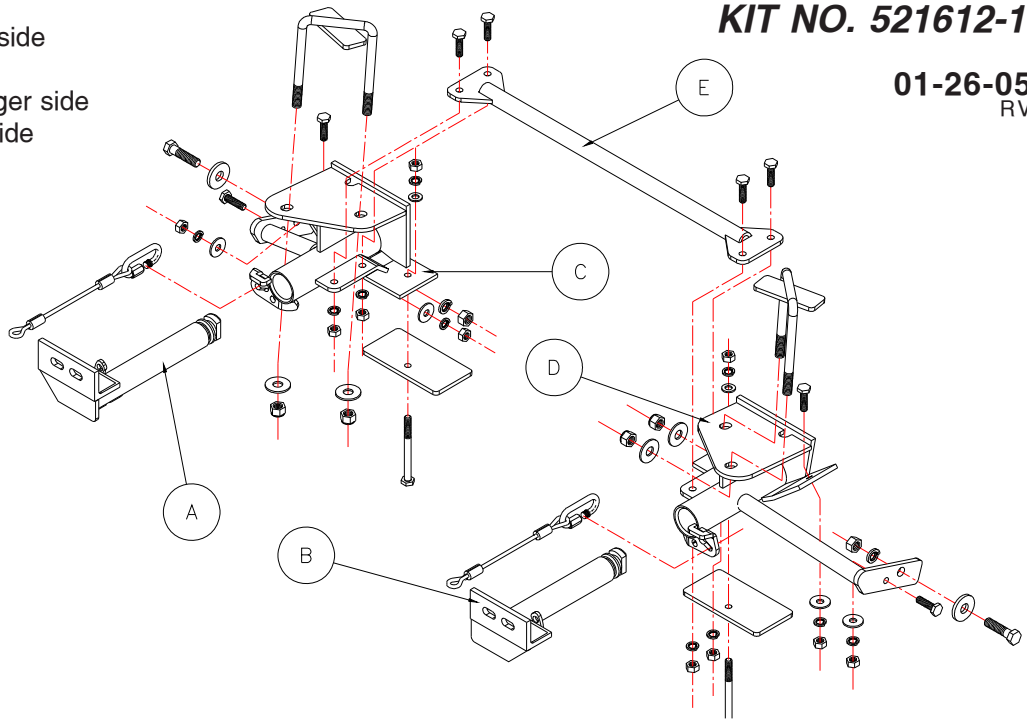

IMPORTANT: All baseplates **must** be assembled with all the bolts left loose for final adjustment and positioning (before tightening) unless otherwise instructed. All bolts **must** be torqued for proper strength. If more than one bolt is used per fastening point, the diagram may only show one. Use flat washers over all slotted holes and lock washers on all fasteners.

WARNING

Failure to heed these warnings or follow the installation instructions may result in a voided warranty, loss of towed vehicle, personal injury or death.

- Do not weld or modify this baseplate or its components. Welding or modification will void the warranty.
- Do not use this document as a basis to design/fabricate a baseplate, as it may not show all parts or structural components.
- We strongly recommend professional installation.
- If the towed vehicle has been in an accident, it must be properly repaired before attaching the baseplate. Do not install the baseplate if any structural frame damage is found.
- The installer must use all bolts and parts supplied. If running changes were made by the vehicle manufacturer after this kit was designed, some bolts or other fasteners may no longer be the correct size. It is the installer's responsibility to verify this kit is securely fastened to the vehicle.
- Use Loctite® Red on all bolts used to secure this baseplate. Torque all bolts to the specifications found at the end of these instructions. Do not over-torque the bolts or failure may occur.
- The installer must inspect the baseplate to ensure adequate clearance, particularly around hoses, air conditioner lines, radiators, etc. or non-warranty failure may result.
- Roadmaster manufactures many styles of baseplates. If your baseplate has removable arms, they must be removed before driving the vehicle, unless the arms can be pinned or padlocked in place. If not secured, the arms could vibrate out.
- Some motorhome chassis have such a tight turning radius that you can damage your motorhome, towed vehicle, tow bar or baseplate while turning sharply. Before getting on the road, test your turning radius in

an empty parking lot. Turning too sharply could result in non-warranty damage to your towing system, motorhome and/or towed vehicle.

- Do not back up with the towed vehicle attached or non-warranty damage will occur to your towing system or vehicles.
- The safety cables must connect the towing vehicle to the towed vehicle frame to frame, with the cables crossed, with enough slack for sharp turns. See cable instructions for proper routing. Failure to do so will result in non-warranty damage and/or the loss of the towed vehicle.
- This kit is designed for use with ROADMASTER tow bars and ROADMASTER adapters only. Using this kit with other brands, without an approved ROADMASTER adapter, may result in non-warranty damage or injury.
- Receiver extensions and out-of-level towing situations of 3 inches or more. This can cause the system to swing much higher and lower, causing excessive strain on the tow bar, baseplate and frame. That can cause the towing system to fail, causing property damage, personal injury or even death. If you must use a receiver extension or drop hitch to tow, it will reduce your receiver's weight capacity by 1/3 to avoid damaging your system. Never use more than one extension and/or drop hitch, as this will void your warranty.
- Every 3,000 miles, the owner must inspect all mounting points for cracks or fatigue, and check the fasteners for proper torque, according to the bolt torque requirements chart on the last page of these instructions.
- The owner must follow the vehicle manufacturer's instructions to prepare the vehicle for towing. Failure to do so may cause severe damage to the vehicle.
- This baseplate is only warranted for the original installation. Installing a used baseplate on another vehicle is not recommended and will void the warranty.

BASEPLATE KIT INSTALLATION INSTRUCTIONS

ROADMASTER, Inc. 6110 NE 127th Ave. Vancouver, WA 98682 1-800-669-9690 fax 360-735-9300 www.roadmasterinc.com

KIT NO. 521612-1

1. **Important: please use all supplied bolts and parts and read all instructions carefully before beginning this installation. The majority of questions you may have can be answered within the text, and proper installation will ensure safe and secure travel.** Now, begin the installation. This is one of our EZ lock bracket series, which allows the visible front portion of the brackets to be easily removed from the front of the car by rotating the front braces. The bracket kit consists of two main receiver braces, a center brace, two tubular front braces and a hardware pack. The rear receiver braces mount to the tie down plates, lower radiator cowl and the bumper core. The front tubular braces insert into the rear braces and rotate 90 degrees to lock in place. The bumper fascia will have to be removed to access the mounting area. Before starting the installation, lay out the kit components as it is illustrated. This will give you a visual idea of how the components work and also confirm that everything is present and accounted for.
2. Begin by removing four plastic fasteners from the top of the fascia between the headlights.
3. Next, remove the headlights (three 10mm head bolts each) disconnect wiring then pull out.
4. Now remove the plastic fastener and a 10mm head screw under each headlight.
5. Remove the 10mm head screw at the junction of the fascia and each fender located in the fender wells, then remove the remaining plastic fasteners located under each splash panel.
6. Pull the fascia forward and off with the foam bumper core facing.
7. Slip the driver side receiver brace under the bumper core, on the lower radiator frame and inside the lower tie down plate. Bolt through the small tie down plate hole with a 10mm x 1.5 x 35mm bolt, fender washer, lock washer and nut. Now take a large 5 ½" U-bolt and bolt the front of the brace to the bottom of the bumper core using two ½" nylock nuts, and flat washers. Align the brace against the inner radiator core support, then tighten in position.
8. Repeat step 7 for the passenger side receiver brace.
9. Bolt the center brace in position with two 10mm x 1.5 x 35mm bolts, lock washers and nuts on each side. Check the alignment on each side then tighten these bolts.
10. Find two ½" x 2" bolts, plate washers and lock washers, then finish bolting through the tie down plates on each side using the plate washers as backing plates.
11. Using the braces back mounting plates as a drill templates, drill two 10mm holes through the radiator core support, on each side, top and side (*Note: a long 10mm bit will be needed*). Bolt through the lower back mounting plates with a 10mm x 1.5 x 110mm bolts, ¼" x 3" x 6" backing plates, flat washers, lock washers and nuts. Bolt through the back, side-mounting plates with 10mm x 1.5 x 35mm bolts, fender washers, lock washers and nuts.
12. Torque all mounting bolts to the values below.
13. Trim the Styrofoam bumper facing to fit around U-bolts and the receiver braces, then install. Trim the lower edge of the outer rib of the fascia (on both sides), to allow clearance of the receiver.
14. Reinstall the bumper fascia-reversing steps 2 through 5.
15. Install the front braces by inserting with front braces vertical to the ground, push in and twist up 90 degrees to lock in place.
16. Mount the tow bar according to the tow bar manufacturer's instructions. Install the 8" safety cables to the side of the main receiver portion of the bracket with quick links provided. Attach the other end to the tow vehicle's safety cables and the tow bar.

BOLT TORQUE REQUIREMENTS

Note: The torque values represented below are intended as general guidelines. Torque requirements for specific applications may vary. Roadmaster does not warrant this information to be accurate for all applications and disclaims all liability for any claims or damages which may result from its use.

STANDARD BOLTS			METRIC BOLTS			METRIC BOLTS		
Thread Size	Grade	Torque	Thread Size	Grade	Plated/Unplated	Thread Size	Grade	Plated/Unplated
5/16	5	13 ft./lb.	8mm-1.0	8.8	20 ft./lb. 18 ft./lb.	12mm-1.25	8.8	70 ft./lb. 65 ft./lb.
3/8	5	23 ft./lb.	8mm-1.25	8.8	19 ft./lb. 18 ft./lb.	12mm-1.5	8.8	66 ft./lb. 61 ft./lb.
7/16	5	37 ft./lb.	10mm-1.25	8.8	38 ft./lb. 36 ft./lb.	12mm-1.75	8.8	65 ft./lb. 60 ft./lb.
1/2	5	56 ft./lb.	10mm-1.5	8.8	37 ft./lb. 35 ft./lb.	14mm-2.0	8.8	104 ft./lb. 97 ft./lb.
5/8	5	150 ft./lb.						



BASEPLATE KIT INSTALLATION INSTRUCTIONS

ROADMASTER, Inc. 6110 NE 127th Ave. Vancouver, WA 98682 1-800-669-9690 fax 360-735-9300 www.roadmasterinc.com

KIT NO. 521612-1

HARDWARE LIST

- (2) 10mm x 1.5 x 110mm bolts
- (8) 10mm x 1.5 x 35mm bolts
- (4) 10mm fender washers
- (10) 10mm lock washers
- (2) 10mm flat washers
- (10) 10mm nuts
- (2) 1/2" x 2" bolts
- (2) 1/4" x 3" x 6"x 3/8" hole backing plates
- (2) 1/2" plate washers
- (2) 1/2" lock washers
- (2) 1/2" nuts
- (4) 1/2" nylock nuts
- (4) 1/2" flat washers
- (2) 1/2" x 4" o.c. x 5 1/2" U-bolts
- (2) 8" safety cables
- (2) quick links

01-26-05
RV

BOLT TORQUE REQUIREMENTS

Note: The torque values represented below are intended as general guidelines. Torque requirements for specific applications may vary. Roadmaster does not warrant this information to be accurate for all applications and disclaims all liability for any claims or damages which may result from its use.

STANDARD BOLTS

Thread Size	Grade	Torque
5/16	5	13 ft./lb.
3/8	5	23 ft./lb.
7/16	5	37 ft./lb.
1/2	5	56 ft./lb.
5/8	5	150 ft./lb.

METRIC BOLTS

Thread Size	Grade	Plated/Unplated
8mm-1.0	8.8	20 ft./lb. 18 ft./lb.
8mm-1.25	8.8	19 ft./lb. 18 ft./lb.
10mm-1.25	8.8	38 ft./lb. 36 ft./lb.
10mm-1.5	8.8	37 ft./lb. 35 ft./lb.

METRIC BOLTS

Thread Size	Grade	Plated/Unplated
12mm-1.25	8.8	70 ft./lb. 65 ft./lb.
12mm-1.5	8.8	66 ft./lb. 61 ft./lb.
12mm-1.75	8.8	65 ft./lb. 60 ft./lb.
14mm-2.0	8.8	104 ft./lb. 97 ft./lb.

All illustrations and specifications contained herein are based on the latest information available at the time of publication approval. ROADMASTER, INC. reserves the right to make changes at any time without notice in material, specification and models or to discontinue models.