



BASEPLATE KIT INSTALLATION INSTRUCTIONS

KIT# 725-1

04/16/08

KS

ROADMASTER, Inc. 6110 NE 127th Ave. Vancouver, WA 98682 1-800-669-9690 fax 360-735-9300 www.roadmasterinc.com

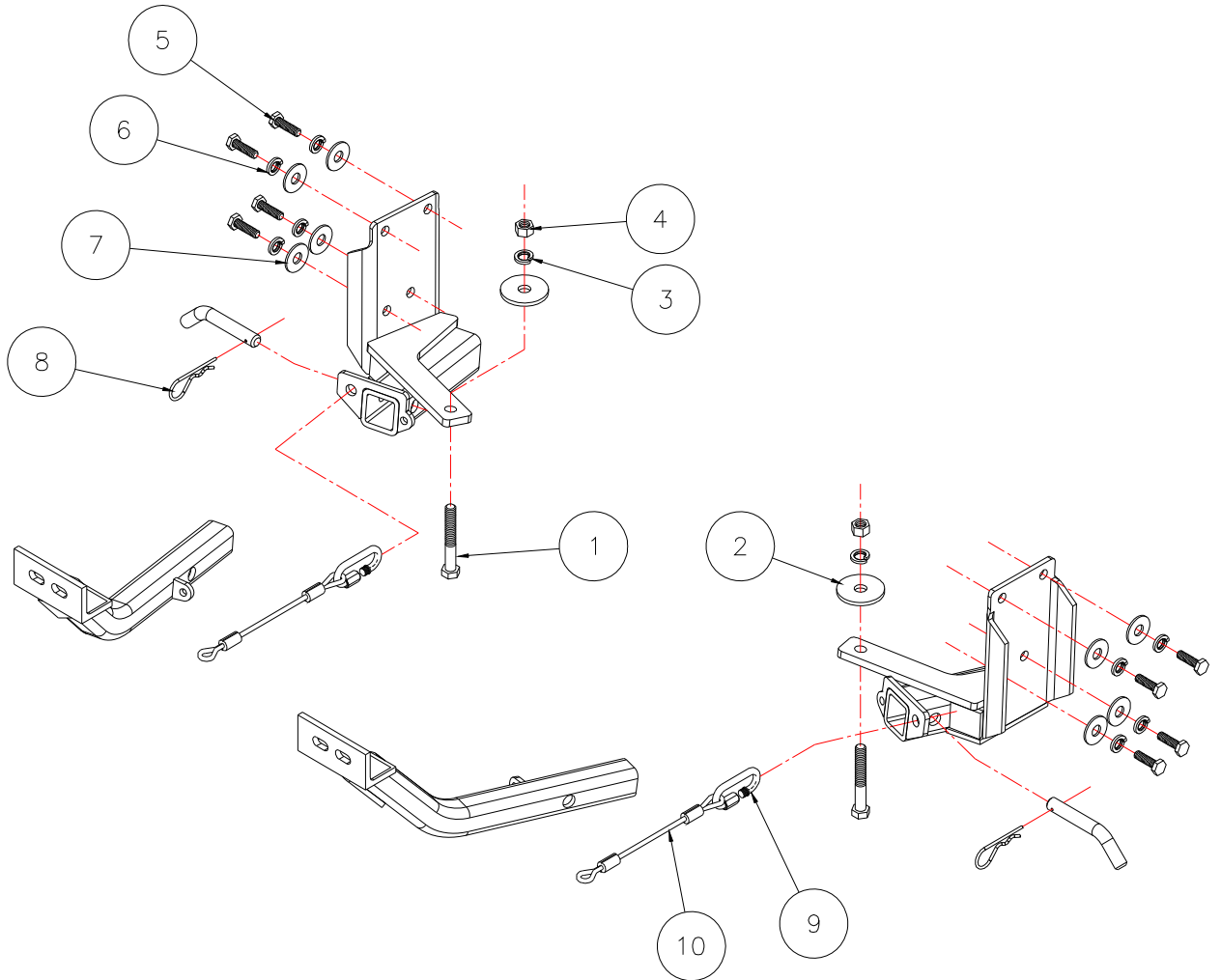

Item	Qty	Length	Width	Hardware	Part No.
1	2	3 1/2"	1/2"	BOLT	350103-00
2	2	2 1/4"		1/2" PLATE WASHER	A003086
3	2	1/2"		LOCK WASHER	350309-00
4	2	1/2"		NUT	350258-00
5	8	35mm	10mm	10mm x 1.25 x 35mm BOLT	356202-00
6	8		10mm	10mm LOCK WASHER	355715-00
7	8		10mm	10mm FLAT WASHER	355710-00
8	2			DRAW PIN / SPRING PIN	357035-00
9	2			CONNECTOR	200008-00
10	2	13"		SAFETY CABLES	500646-13



BASEPLATE KIT INSTALLATION INSTRUCTIONS

KIT# 725-1

04/16/08

KS

ROADMASTER, Inc. 6110 NE 127th Ave. Vancouver, WA 98682 1-800-669-9690 fax 360-735-9300 www.roadmasterinc.com

IMPORTANT: All brackets **must** be assembled with all the bolts left loose for final adjustment & positioning (before tightening) unless otherwise instructed. All bolts **must** be torqued for proper strength. If more than one bolt is used per fastening point, the diagram may only show one.

- Use flat washers over all slotted holes
- Use lock washers on all fasteners

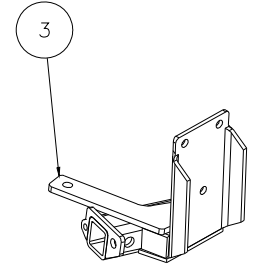
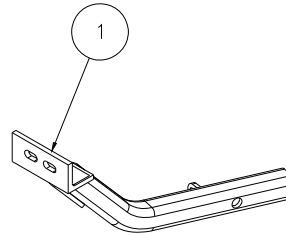
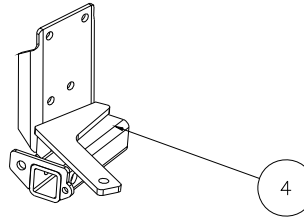
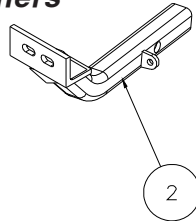

Item	Qty	Part No.	ASSEMBLY
1	1	C-000603	DRIVER SIDE ARM WELDMENT
2	1	C-000604	PASSENGER SIDE ARM WELDMENT
3	1	C-000605	DRIVER SIDE RECEIVER BRACE WELDMENT

IMPORTANT: All baseplates **must** be assembled with all the bolts left loose for final adjustment and positioning (before tightening) unless otherwise instructed. All bolts **must** be torqued for proper strength. If more than one bolt is used per fastening point, the diagram may only show one. Use flat washers over all slotted holes and lock washers on all fasteners.

WARNING

Failure to heed these warnings or follow the installation instructions may result in a voided warranty, loss of towed vehicle, personal injury or death.

- Do not weld or modify this baseplate or its components. Welding or modification will void the warranty.
- Do not use this document as a basis to design/fabricate a baseplate, as it may not show all parts or structural components.
- We strongly recommend professional installation.
- If the towed vehicle has been in an accident, it must be properly repaired before attaching the baseplate. Do not install the baseplate if any structural frame damage is found.
- The installer must use all bolts and parts supplied. If running changes were made by the vehicle manufacturer after this kit was designed, some bolts or other fasteners may no longer be the correct size. It is the installer's responsibility to verify this kit is securely fastened to the vehicle.
- Use Loctite® Red on all bolts used to secure this baseplate. Torque all bolts to the specifications found at the end of these instructions. Do not over-torque the bolts or failure may occur.
- The installer must inspect the baseplate to ensure adequate clearance, particularly around hoses, air conditioner lines, radiators, etc. or non-warranty failure may result.
- Roadmaster manufactures many styles of baseplates. If your baseplate has removable arms, they must be removed before driving the vehicle, unless the arms can be pinned or padlocked in place. If not secured, the arms could vibrate out.
- Some motorhome chassis have such a tight turning radius that you can damage your motorhome, towed vehicle, tow bar or baseplate while turning sharply. Before getting on the road, test your turning radius in an empty parking lot. Turning too sharply could

result in non-warranty damage to your towing system, motorhome and/or towed vehicle.

- Do not back up with the towed vehicle attached or non-warranty damage will occur to your towing system or vehicles.
- The safety cables must connect the towing vehicle to the towed vehicle frame to frame, with the cables crossed, with enough slack for sharp turns. See cable instructions for proper routing. Failure to do so will result in non-warranty damage and/or the loss of the towed vehicle.
- This kit is designed for use with ROADMASTER tow bars and ROADMASTER adapters only. Using this kit with other brands, without an approved ROADMASTER adapter, may result in non-warranty damage or injury.
- Receiver extensions and out-of-level towing situations of 3 inches or more. This can cause the system to swing much higher and lower, causing excessive strain on the tow bar, baseplate and frame. That can cause the towing system to fail, causing property damage, personal injury or even death. If you must use a receiver extension or drop hitch to tow, it will reduce your receiver's weight capacity by 1/3 to avoid damaging your system. Never use more than one extension and/or drop hitch, as this will void your warranty.
- Every 3,000 miles, the owner must inspect all mounting points for cracks or fatigue, and check the fasteners for proper torque, according to the bolt torque requirements chart on the last page of these instructions.
- The owner must follow the vehicle manufacturer's instructions to prepare the vehicle for towing. Failure to do so may cause severe damage to the vehicle.
- This baseplate is only warranted for the original installation. Installing a used baseplate on another vehicle is not recommended and will void the warranty.



BASEPLATE KIT INSTALLATION INSTRUCTIONS

KIT# 725-1

04/16/08

KS

ROADMASTER, Inc. 6110 NE 127th Ave. Vancouver, WA 98682 1-800-669-9690 fax 360-735-9300 www.roadmasterinc.com

This is one of our XL series bracket kits which are partly removeable. The main receiver braces mount to existing tie down plate mounts on each side of the vehicle (Fig.A). Remove three front fasteners (8mm head) in the bottom of each fender splash panel (Fig.B), then remove three more plastic fasteners in the fender wells (Fig.C). Pull the side splash panels down and away to provide access to the tie down area.

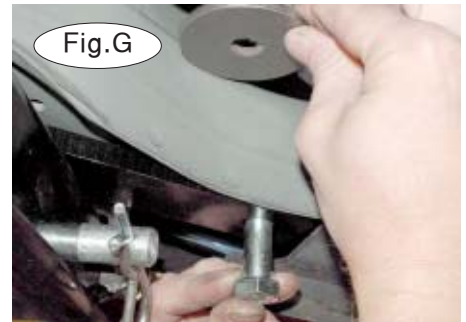
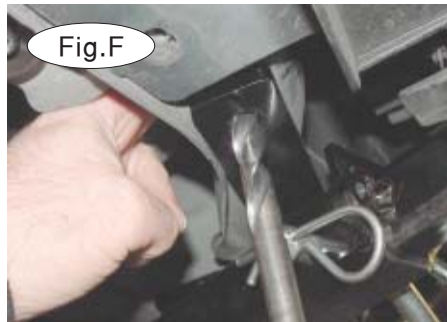

1. **Important:** please use all supplied bolts and parts and read all instructions carefully before beginning this installation. The majority of questions you may have can be answered within the text, and proper installation will ensure safe and secure travel. Now, begin the installation. Remove the tie down plates and bolts on each side of the car (Fig.D). They will not be replaced. *Note:* retain the tie down plates and bolts in case the bracket is ever removed from the vehicle.

2. Bolt the braces in place of the tie down plates as illustrated with the supplied 10mm x 1.25 x 35mm bolts, flat washers and lock washers then tighten. There should be four bolts per side (Fig.E).

3. Using the braces as a drill template, drill a 17/32" hole through the top of the radiator cross member on each side. Be sure to use a backing plate when doing this to avoid any problems with either the radiator or condensor lines (Fig.F).

4. Now, bolt through the radiator cross member and the inside mounting tabs on each side with 1/2" x 3 1/2" bolts, plate washers, lock washers and nuts. *Note:* be sure to put the plate washer on top of the cross member (Fig.G).



BASEPLATE KIT INSTALLATION INSTRUCTIONS

KIT# 725-1

04/16/08

KS

ROADMASTER, Inc. 6110 NE 127th Ave. Vancouver, WA 98682 1-800-669-9690 fax 360-735-9300 www.roadmasterinc.com

5. Insert the front braces into the main receiver braces and secure with the supplied 5/8" draw pins and 1/8" spring clips (Fig.H).
6. Align the braces with each other then torque the bolts to the specifications below.
7. Reinstall the side splash panels and center splash panel trimming to fit if necessary.
8. Mount the tow bar according to the manufacturer's instructions.
9. Attach the included 13" safety cables to the receiver braces with the supplied cable connectors (Fig.H).
10. Attach the other end to the tow bar and the tow vehicle's safety cables.



BOLT TORQUE REQUIREMENTS

Note: The torque values represented below are intended as general guidelines. Torque requirements for specific applications may vary. Roadmaster does not warrant this information to be accurate for all applications and disclaims all liability for any claims or damages which may result from its use.

STANDARD BOLTS

Thread Size	Grade	Torque
5/16	5	13 ft./lb.
3/8	5	23 ft./lb.
7/16	5	37 ft./lb.
1/2	5	56 ft./lb.
5/8	5	150 ft./lb.

METRIC BOLTS

Thread Size	Grade	Plated / Unplated
8mm-1.0	8.8	20 ft./lb. 18 ft./lb.
8mm-1.25	8.8	19 ft./lb. 18 ft./lb.
10mm-1.25	8.8	38 ft./lb. 36 ft./lb.
10mm-1.5	8.8	37 ft./lb. 35 ft./lb.

METRIC BOLTS

Thread Size	Grade	Plated / Unplated
12mm-1.25	8.8	70 ft./lb. 65 ft./lb.
12mm-1.5	8.8	66 ft./lb. 61 ft./lb.
12mm-1.75	8.8	65 ft./lb. 60 ft./lb.
14mm-2.0	8.8	104 ft./lb. 97 ft./lb.

All illustrations and specifications contained herein are based on the latest information available at the time of publication approval. ROADMASTER, INC. reserves the right to make changes at any time without notice in material, specification and models or to discontinue models.