

BASEPLATE KIT INSTALLATION INSTRUCTIONS

ROADMASTER, Inc. 6110 NE 127th Ave. Vancouver, WA 98682 1-800-669-9690 fax 360-735-9300 www.roadmasterinc.com

PARTS LIST:

- 1- RECEIVER BRACE (A) - Passenger side
- 1- RECEIVER BRACE (B) - Driver's side
- 1- FRONT BRACE (C) - Passenger side
- 1- FRONT BRACE (D) - Driver's side

KIT NO. 810-2

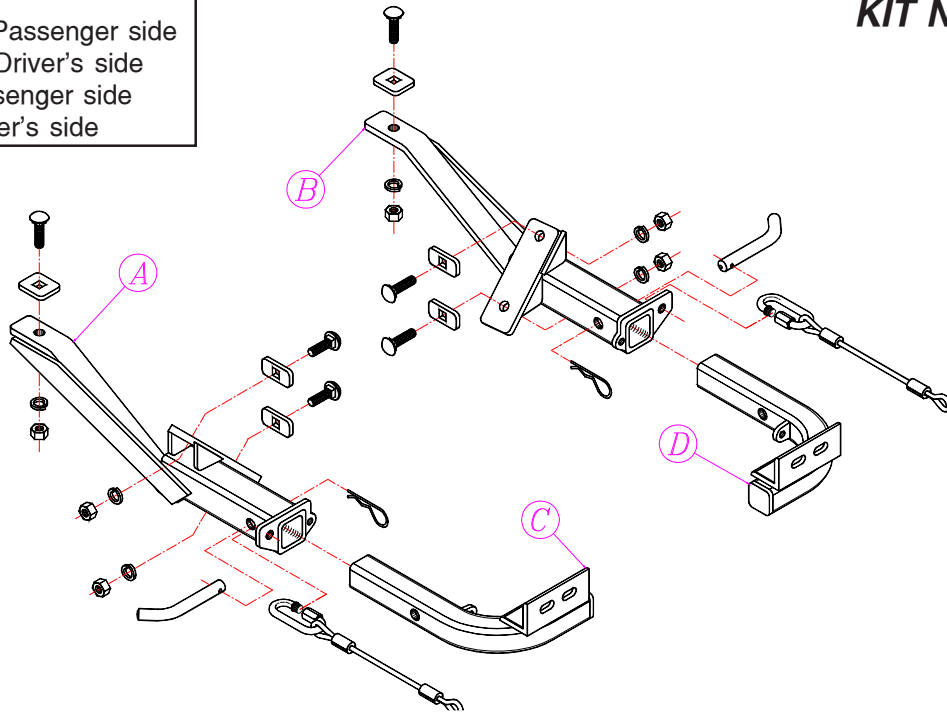

12-29-97

IMPORTANT: All baseplates **must** be assembled with all the bolts left loose for final adjustment and positioning (before tightening) unless otherwise instructed. All bolts **must** be torqued for proper strength. If more than one bolt is used per fastening point, the diagram may only show one.

- Use flat washers over all slotted holes
- Use lock washers on all fasteners

WARNING

Failure to follow the below warnings and the installation instructions may result in voiding your warranty, property damage, the loss of your towed vehicle, personal injury or even death.

- Installation of most baseplates requires moderate mechanical aptitude and skills. We strongly recommend professional installation by an experienced installer.
- The installer must read the instructions and use all bolts and parts supplied.
- Use Loctite® Red on all bolts used for mounting this baseplate.
- Every 3,000 miles, the owner must inspect the fasteners for proper torque, according to the bolt torque requirements chart on the last page of these instructions. The owner must also inspect all mounting points for cracks or other signs of fatigue every 3,000 miles.
- The owner must check the vehicle manufacturer's instructions for the proper procedure(s) to prepare the vehicle for towing. Some vehicles must be equipped with a transmission lube pump, an axle disconnect, driveline disconnect or free-wheeling hubs before they can be towed. Failure to properly equip the vehicle will cause severe damage to the transmission.
- Do not weld. This baseplate is designed to be bolted to the vehicle. Welding will void the warranty.
- Do not use this document for custom fabrication, as it may not show all parts or structural components could result in loss of the towed vehicle.
- If the towed vehicle has been in an accident, it must be properly repaired before attaching the baseplate. Do not install the baseplate if any structural frame damage is found.
- If running changes were made by the vehicle manufacturer after this

kit was designed, some bolts or other fasteners in the hardware pack may no longer be the correct size. It is the installer's responsibility to verify this kit is securely fastened to the vehicle and fitted with the correct hardware to account for these changes.

- Roadmaster manufactures many styles of baseplates. If your baseplate has removable arms, they must be removed before driving the vehicle, unless the arms can be pinned or padlocked in place. If not secured, the arms could vibrate out.
- Some motorhome chassis have such a tight turning radius that you can damage your motorhome, towed vehicle, tow bar or baseplate while turning sharply. Before getting on the road, test your turning radius in an empty parking lot. Turning too sharply could result in non-warranty damage to towing system, motorhome and/or towed vehicle.
- Do not back up with the towed vehicle attached or non-warranty damage will occur to your towing system, motorhome and/or towed vehicle.
- The safety cables must connect the towing vehicle to the towed vehicle frame to frame, with the cables crossed, with enough slack for sharp turns. Refer to the cable instructions for proper routing. Failure to leave enough slack in the safety cables, or failure to connect the safety cables frame to frame, will result in the loss of the towed vehicle.
- This kit is designed for use with ROADMASTER tow bars and ROADMASTER adapters only. Using this kit with other brands, without an approved ROADMASTER adapter, may result in non-warranty damage or injury.
- Upon final installation, the installer must inspect the baseplate to ensure adequate clearance, particularly around hoses, air conditioner lines, radiators, etc.
- This baseplate is only warranted for the original installation. Installing a used baseplate on another vehicle is not recommended and will void the warranty.

BASEPLATE KIT INSTALLATION INSTRUCTIONS

ROADMASTER, Inc. 6110 NE 127th Ave. Vancouver, WA 98682 1-800-669-9690 fax 360-735-9300 www.roadmasterinc.com

KIT NO. 810-2

1. **Important:** please use all supplied bolts and parts and read all instructions carefully before beginning this installation. The majority of questions you may have can be answered within the text, and proper installation will ensure safe and secure travel. Now, begin the installation. This bracket kit is one of our XL Series which can be partially removed when not in use. The bracket kit consists of two receiver braces which bolt to the front frame assembly with three bolts on each side and protrude through the lower grill opening. Two removable front braces which connect directly to the tow bar insert into the receivers and are pinned in place with 5/8" receiver pins. The bumper and bumper skin will have to be removed for the installation. Start by removing and disconnecting the turn signals.
2. Next, remove the small grilles between the headlights and take out two bolts located behind them.
3. Remove the black plastic splash guards located under the bumper in front of the fender wells. This will expose the bumper skin fasteners in the fender.
4. Remove the bumper skin fasteners at this time, then grasp the bumper skin and remove from the front of the car.
5. Locate the E-A units on which the bumper is mounted and remove them and the bumper by unbolting the two EA mounting bolts on each side.
6. The back of the receiver braces mount underneath the frame rails in existing holes. Find a large access hole located behind the EA mounts in the side of the frame and fish wire a 1/2" x 1 1/2" carriage bolt and a 1/4" x 1 1/2" x 1 3/4" backing plate through the hole into the existing lower frame hole. Do this for each side. Now, bolt the back of the braces to the frame using 1/2" lock washers and nuts. Position the braces as far forward as possible and against the side of the radiator frame before tightening.
7. Double check the braces alignment, then drill two 1/2" holes per side into the radiator frame using the braces as drill templates.
8. The receiver braces mount to the side of the frame and fish wire a 1/2" x 1 1/2" carriage bolts, 1" x 2" backing plates, lock washers and nuts. The carriage bolts and backing plates will have to be fish wired into position through the front of the frame. If the frame has a side or partition plate denying access to the radiator frame work, access will have to be created. A large sharp chisel will work well. Once the 1" x 2" backing plates and 1/2" x 1 1/2" carriage bolts are fish wired through the drilled holes and braces, finish with 1/2" lock washers and nuts.
9. Tighten all installed bolts to the torque specifications below.
10. Follow steps 1 through 5 in reverse to reinstall the bumper, bumper skin, splash panels, grilles and turn signals.
11. Insert the front braces into the receiver braces and pin using the supplied 5/8" draw pins and 1/8" spring pins.
12. Mount the bar according to the manufacturers instructions and torque the bolts to the specifications below.
13. Connect the provided 13" safety cables to the receiver brace and the tow vehicle's safety cables with the included cable connectors.

12-29-97

HARDWARE LIST:

6-1/2" X 1 1/2" CARRIAGE BOLTS
6-1/2" LOCK WASHERS
6-1/2" NUTS
2-5/8" RECEIVER PINS

2-1/8" SPRING PINS
2-CABLE CONNECTORS
2-13" SAFETY CABLES
2-1/4" X 1" X 2" BACKING PLATES
2-1/4" X 1 1/2" X 1 3/4" BACKING PLATES

BOLT TORQUE REQUIREMENTS

Note: The torque values represented below are intended as general guidelines. Torque requirements for specific applications may vary. Roadmaster does not warrant this information to be accurate for all applications and disclaims all liability for any claims or damages which may result from its use.

STANDARD BOLTS			METRIC BOLTS			METRIC BOLTS		
Thread Size	Grade	Torque	Thread Size	Grade	Plated/Unplated	Thread Size	Grade	Plated/Unplated
5/16	5	13 ft./lb.	8mm-1.0	8.8	20 ft./lb. 18 ft./lb.	12mm-1.25	8.8	70 ft./lb. 65 ft./lb.
3/8	5	23 ft./lb.	8mm-1.25	8.8	19 ft./lb. 18 ft./lb.	12mm-1.5	8.8	66 ft./lb. 61 ft./lb.
7/16	5	37 ft./lb.	10mm-1.25	8.8	38 ft./lb. 36 ft./lb.	12mm-1.75	8.8	65 ft./lb. 60 ft./lb.
1/2	5	56 ft./lb.	10mm-1.5	8.8	37 ft./lb. 35 ft./lb.	14mm-2.0	8.8	104 ft./lb. 97 ft./lb.
5/8	5	150 ft./lb.						