



BASEPLATE KIT

INSTALLATION INSTRUCTIONS

ROADMASTER, Inc. 6110 NE 127th Ave. Vancouver, WA 98682 1-800-669-9690 fax 360-735-9300 www.roadmasterinc.com

PARTS LIST:

- 1- FRONT ARM (A) - Passenger side
- 1- FRONT ARM (B) - Driver's side
- 1- MAIN BRACE (C)

KIT NO. 817-1

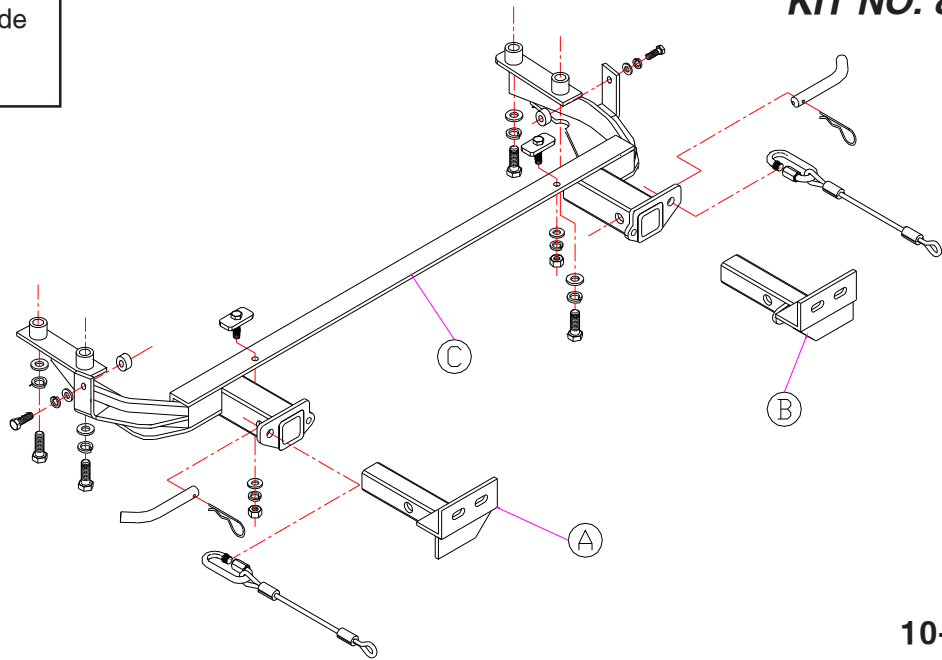

10-08-07

IMPORTANT: All baseplates **must** be assembled with all the bolts left loose for final adjustment and positioning (before tightening) unless otherwise instructed. All bolts **must** be torqued for proper strength. If more than one bolt is used per fastening point, the diagram may only show one. Use flat washers over all slotted holes and lock washers on all fasteners.

WARNING

Failure to heed these warnings or follow the installation instructions may result in a voided warranty, loss of towed vehicle, personal injury or death.

- Do not weld or modify this baseplate or its components. Welding or modification will void the warranty.
- Do not use this document as a basis to design/fabricate a baseplate, as it may not show all parts or structural components.
- We strongly recommend professional installation.
- If the towed vehicle has been in an accident, it must be properly repaired before attaching the baseplate. Do not install the baseplate if any structural frame damage is found.
- The installer must use all bolts and parts supplied. If running changes were made by the vehicle manufacturer after this kit was designed, some bolts or other fasteners may no longer be the correct size. It is the installer's responsibility to verify this kit is securely fastened to the vehicle.
- Use Loctite® Red on all bolts used to secure this baseplate. Torque all bolts to the specifications found at the end of these instructions. Do not over-torque the bolts or failure may occur.
- The installer must inspect the baseplate to ensure adequate clearance, particularly around hoses, air conditioner lines, radiators, etc. or non-warranty failure may result.
- Roadmaster manufactures many styles of baseplates. If your baseplate has removable arms, they must be removed before driving the vehicle, unless the arms can be pinned or padlocked in place. If not secured, the arms could vibrate out.
- Some motorhome chassis have such a tight turning radius that you can damage your motorhome, towed vehicle, tow bar or baseplate while turning sharply. Before getting on the road, test your turning radius in an empty parking lot. Turning too sharply could result in non-warranty damage to your towing system, motorhome and/or towed vehicle.
- Do not back up with the towed vehicle attached or non-warranty damage will occur to your towing system or vehicles.
- The safety cables must connect the towing vehicle to the towed vehicle frame to frame, with the cables crossed, with enough slack for sharp turns. See cable instructions for proper routing. Failure to do so will result in non-warranty damage and/or the loss of the towed vehicle.
- This kit is designed for use with ROADMASTER tow bars and ROADMASTER adapters only. Using this kit with other brands, without an approved ROADMASTER adapter, may result in non-warranty damage or injury.
- Receiver extensions and out-of-level towing situations of 3 inches or more. This can cause the system to swing much higher and lower, causing excessive strain on the tow bar, baseplate and frame. That can cause the towing system to fail, causing property damage, personal injury or even death. If you must use a receiver extension or drop hitch to tow, it will reduce your receiver's weight capacity by 1/3 to avoid damaging your system. Never use more than one extension and/or drop hitch, as this will void your warranty.
- Every 3,000 miles, the owner must inspect all mounting points for cracks or fatigue, and check the fasteners for proper torque, according to the bolt torque requirements chart on the last page of these instructions.
- The owner must follow the vehicle manufacturer's instructions to prepare the vehicle for towing. Failure to do so may cause severe damage to the vehicle.
- This baseplate is only warranted for the original installation. Installing a used baseplate on another vehicle is not recommended and will void the warranty.



BASEPLATE KIT INSTALLATION INSTRUCTIONS

ROADMASTER, Inc. 6110 NE 127th Ave. Vancouver, WA 98682 1-800-669-9690 fax 360-735-9300 www.roadmasterinc.com

KIT NO. 817-1

- Important:** please use all supplied bolts and parts and read all instructions carefully before beginning this installation. The majority of questions you may have can be answered within the text, and proper installation will ensure safe and secure travel. Now, begin the installation. Start by removing the front grille. This can be accomplished by locating quick release clips built into the grill and unsnapping them with the aid of a small screwdriver. You can then pull the grille free. Don't lose the small plastic inner snaps, these can be inserted in the radiator frame prior to refitting the grille.
- Now, the bumper fascia must be removed. Start by removing two plastic keepers and two 6mm screws in the top of the bumper exposed by removal of the grille. Now remove two plastic keepers under the bumper core and four plastic keepers from the bottom of the fascia. Remove two screws on each side located between the rear of the headlights and the fender well liner. Pull the fascia forward and disconnect the fog light wiring on each side if present. Finish pulling forward and off.
- Hold the main receiver brace up to the bottom frame members and bolt in place to the bottom of the frame using two 10mm x 1.25 x 65mm bolts plate washers and lock washers on each side. Leave the bolts slightly loose for now.
- Bolt to the side of the frame on each side using 8mm x 1.25 x 35mm bolts, 7/16" pipe spacers, 8mm fender washers and lock washers. *Note:* be sure to use the pipe spacers between the frame and the brace. Torque all mounting bolts to the specifications below.
- Check the remaining receiver brace mounting holes under the bumper for alignment with two existing holes in the bottom of the steel bumper core. Make sure the holes are in line; if slightly off, use the brace as a drill template and drill.
- Insert two special 1/4" x 1" x 2" backing plates with attached 8mm x 1.25 x 35mm bolts through the back of the bumper into the two holes. Finish with 8mm plate washers, lock washers and nuts.
- Reverse steps two and three to reinstall the bumper fascia and grill with the exception of inserting two plastic fasteners under the bumper core. These have been replaced with the 8mm bolts in step seven. After the bumper fascia is reinstalled, finish bolting the brace to the bumper with 8mm fender washers, lock washers and nuts. Torque to the specifications below.
- Insert the front braces into the receiver tubes and secure with 5/8" draw pins and 1/8" spring pins.
- Install the tow bar according to the manufacturer's instructions and torque all mounting bolts to the specifications below.
- Attach one end of the included 10" safety cables to the lower front hole in the side mounting plate on each side of the receiver brace with the included cable connectors. Connect the other end to the tow vehicle's safety cables and the tow bar.

Hardware

- | | |
|---|-----------------------|
| 4- 10mm x 1.25 x 60mm bolts | 2- 8mm nuts |
| 4- 10mm fender washers | 2- 7/16" pipe spacers |
| 4- 10mm lock washers | 2- 10" safety cables |
| 2- 8mm x 1.25 x 35mm bolts | 2- cable connectors |
| 2- 1/4" x 1" x 2" backing plates with 8mm x 1.25 x 35mm bolts | 2- 5/8" draw pins |
| 4- 8mm fender washers | 2- 1/8" spring pins |
| 4- 8mm lock washers | |

BOLT TORQUE REQUIREMENTS

Note: The torque values represented below are intended as general guidelines. Torque requirements for specific applications may vary. Roadmaster does not warrant this information to be accurate for all applications and disclaims all liability for any claims or damages which may result from its use.

STANDARD BOLTS			METRIC BOLTS			METRIC BOLTS		
Thread Size	Grade	Torque	Thread Size	Grade	Plated/Unplated	Thread Size	Grade	Plated/Unplated
5/16	5	13 ft./lb.	8mm-1.0	8.8	20 ft./lb. 18 ft./lb.	12mm-1.25	8.8	70 ft./lb. 65 ft./lb.
3/8	5	23 ft./lb.	8mm-1.25	8.8	19 ft./lb. 18 ft./lb.	12mm-1.5	8.8	66 ft./lb. 61 ft./lb.
7/16	5	37 ft./lb.	10mm-1.25	8.8	38 ft./lb. 36 ft./lb.	12mm-1.75	8.8	65 ft./lb. 60 ft./lb.
1/2	5	56 ft./lb.	10mm-1.5	8.8	37 ft./lb. 35 ft./lb.	14mm-2.0	8.8	104 ft./lb. 97 ft./lb.
5/8	5	150 ft./lb.						

All illustrations and specifications contained herein are based on the latest information available at the time of publication approval. ROADMASTER, INC. reserves the right to make changes at any time without notice in material, specification and models or to discontinue models.