

# SEAT ADAPTER KIT #88116 INSTALLATION INSTRUCTIONS



2946-04

ALL SPECIFICATIONS ARE SUBJECT TO CHANGE WITHOUT NOTICE

ROADMASTER, Inc. 6110 NE 127th Ave. Vancouver, WA 98682 360-896-0407 fax 360-735-9300 www.roadmasterinc.com

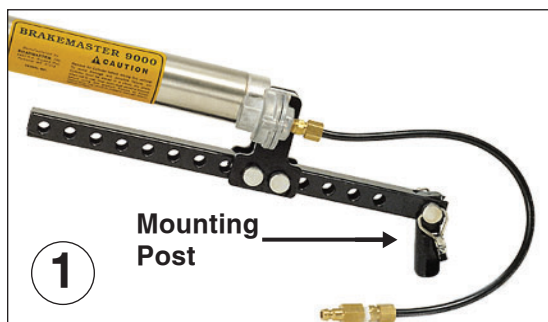

## Parts List

- (1) 3/8" x 3/4" bolt
- (1) 3/8" lock washer
- (2) 10mm x 1.25 x 35mm bolts
- (2) 10mm lock washers
- (2) 10mm flat washers
- (2) 3/8" x 1" spacers (optional)

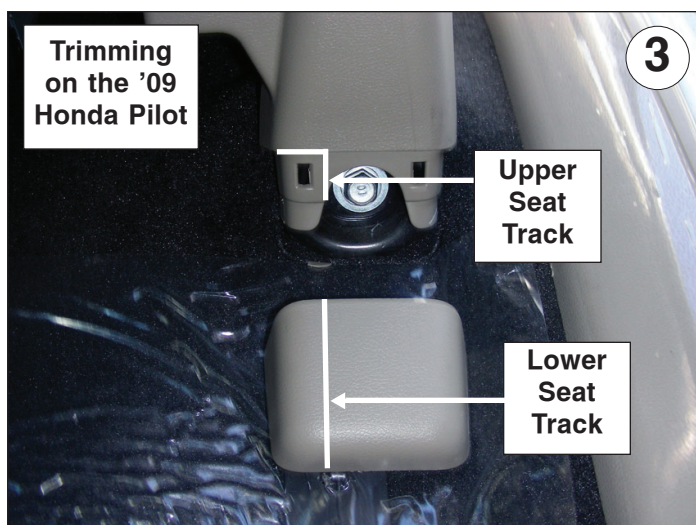

## Instructions

**1.** Locate the mounting post (Fig.1) that came with your BrakeMaster. If needed, order part number 450596. Now, secure the post to the center of the seat adapter using the included 3/8" x 3/4" bolt and 3/8" lock washer. If the hole is countersunk, use the Allen head bolt and lock washer included with this kit.

**2.** Snap off the plastic seat track covers on each side of the driver's seat and remove the two front seat mounting bolts (one on each side). *Note:* on the '09 Honda Pilot, trim the upper seat track cover as shown in Figure 3. Set the seat adapter in place over the front seat mounting bolt holes, and bolt it in place to the seat rail, using a 10mm x 1.25 x 35mm bolt, lock washer and flat washer on each side. *Note:* some applications may require the supplied 3/8" x 1" spacers between the seat adapter and seat tracks.

**3.** Trim the plastic seat track covers for the Honda Odyssey (inset, Figure 2) so that they will fit over the seat adapter, and snap them back in place. Figure 3 shows the lower seat track cover trimming on the '09 Honda Pilot.



**WARNING**

Failure to follow these instructions can result in property damage, personal injury or even death.