



1-800-669-9690

SEAT ADAPTOR KIT #88232 INSTALLATION INSTRUCTIONS



2950-01

ALL SPECIFICATIONS ARE SUBJECT TO CHANGE WITHOUT NOTICE

ROADMASTER, Inc. 6110 NE 127th Ave. Vancouver, WA 98682 1-800-669-9690 fax 360-735-9300 www.roadmasterinc.com

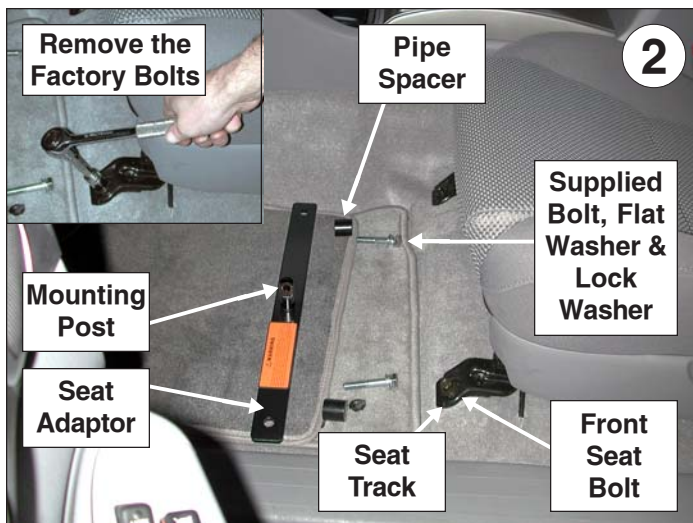
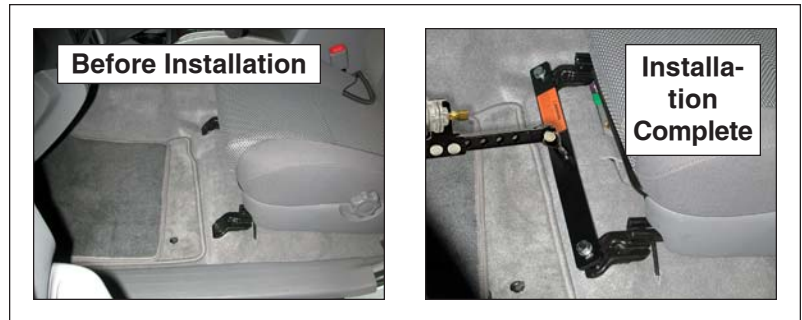
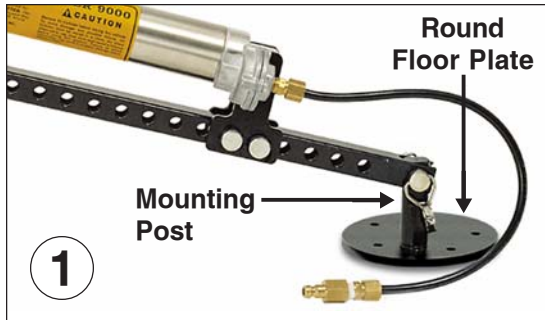

Parts List

- (1) 3/8" lock washer
- (1) 3/8" x 3/4" bolt
- (2) 1" x 1" pipe spacers
- (2) 10mm x 1.25 x 60mm bolts
- (2) 10mm flat washers
- (2) 10mm lock washers

Instructions

1. Before installing the seat adaptor, the mounting post (that was included with your BrakeMaster system) must be removed from the round plate (Fig.1). Secure the round plate in a vise. Use a wrench to loosen the mounting post, while holding the bolt with an Allen wrench. Don't try to turn the Allen bolt with the Allen wrench, as you might damage the wrench or bolt. Use a 1/2" open-end wrench to twist the mounting post off. Then, secure the mounting post to the center of the seat adaptor, using the included 3/8" x 3/4" bolt and 3/8" lock washer.
2. Remove the 14mm head front seat bolts (inset, Fig.2). Slide the seat adaptor over the front seat bolt holes (Fig.2), and bolt the adaptor into place using a 10mm x 1.25 x 60mm bolt, flat washer and lock washer on each side. Position a pipe spacer (on each side) between the seat adaptor and the seat track.



WARNING

Failure to follow these instructions can result in property damage, personal injury or even death.