

SEAT Adapter KIT #88237 INSTALLATION INSTRUCTIONS



4046-05

ALL SPECIFICATIONS ARE SUBJECT TO CHANGE WITHOUT NOTICE

ROADMASTER, Inc. 6110 NE 127th Ave. Vancouver, WA 98682 360-896-0407 fax 360-735-9300 www.roadmasterinc.com

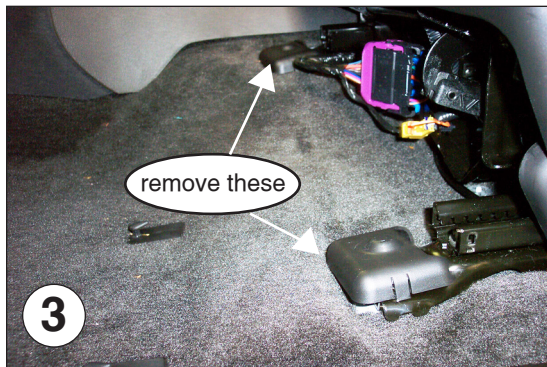
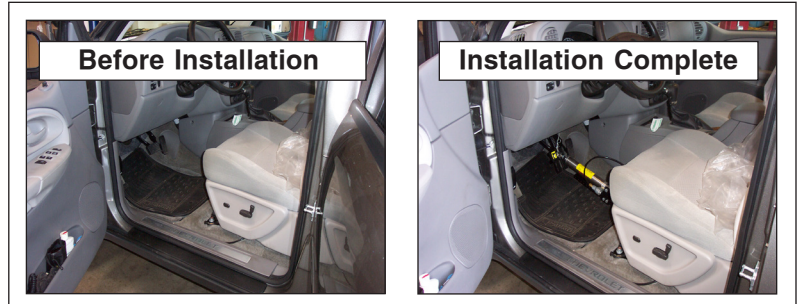
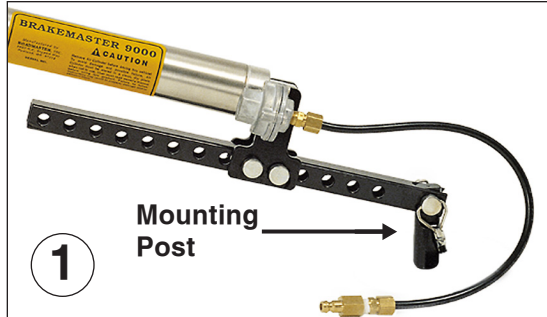

Instructions

1. Locate the mounting post (Fig.1) that came with your BrakeMaster. If needed, order part number 450596. Now, secure the post to the center of the seat adapter using the included 3/8" x 3/4" bolt and 3/8" lock washer. If the hole is countersunk, use the Allen head bolt and lock washer included with this kit.
2. Remove the rear seat track covers (Fig.2) and loosen the two 18mm (head) rear seat track nuts. Remove the two front seat track covers (Fig.3) and remove an 18mm nut from the driver's side track and an 18mm (head) bolt from the passenger side track. *Note:* the bolt will not be replaced.
3. Place the seat adapter between the floor and the seat tracks. Replace the driver's side nut, and using the supplied 12mm x 1.75 x 50mm bolt, lock washer and flat washer on the passenger side, bolt the adapter into place (Fig.4). *Note:* the mounting post on the adapter (Fig.1) must be directly in line to the brake pedal. The BrakeMaster air cylinder may jam or function incorrectly if the mounting post is not directly in line with the brake pedal.
4. Tighten all bolts and replace the seat track covers. Attach the air cylinder.

CAUTION

Once the seat adapter has been installed, carefully run the seat through its full range of motion. If it is impeded in any way, immediately stop and correct the interference. Failure to do so may result in non-warranty property damage.



WARNING

Failure to follow these instructions can result in property damage, personal injury or even death.

Parts List

- (1) 12mm x 1.75 x 50mm bolt
- (1) 12mm lock washer (1) 3/8" lock washer
- (1) 12mm flat washer (1) Allen head bolt