

# SEAT ADAPTER KIT #88336 INSTALLATION INSTRUCTIONS



5805-01

ALL SPECIFICATIONS ARE SUBJECT TO CHANGE WITHOUT NOTICE

ROADMASTER, Inc. 6110 NE 127th Ave. Vancouver, WA 98682 360-896-0407 fax 360-735-9300 www.roadmasterinc.com

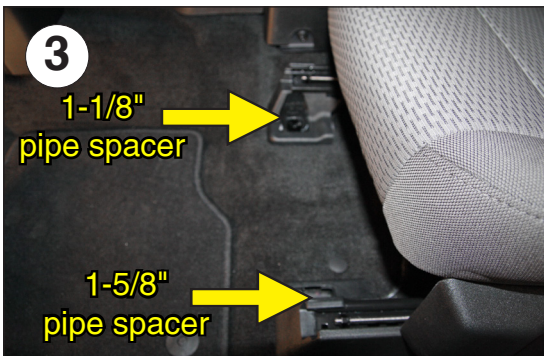
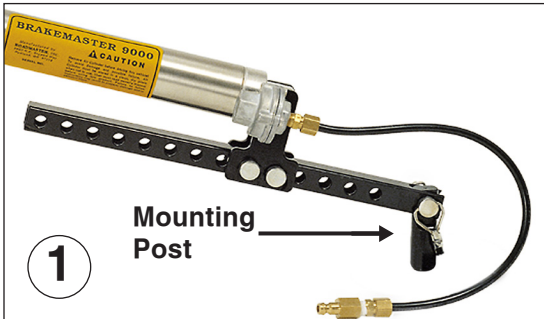

## Instructions

1. Locate the mounting post (Fig.1) that came with your BrakeMaster. If needed, order part number 450596. Now, secure the post to the center of the seat adapter using the included 3/8" x 3/4" bolt and 3/8" lock washer. If the hole is countersunk, use the Allen head bolt and lock washer included with this kit.
2. Push the driver's seat back as far as it will go, and remove the two front seat track covers (Fig.2). They will not be replaced.
3. Remove the two 13mm (head) seat track bolts attaching the front seat track to the floor pan. Place the shorter pipe spacer over the inside mount, and the longer one over the outside mount (Fig.3).
4. Place the seat adapter over the pipe spacers you installed in the previous step. *Note:* make certain to position the adapter so that the mounting post is directly in line to the brake pedal. The BrakeMaster air cylinder may jam or function incorrectly if the mounting post is not directly in line with the brake pedal.

*continued on next page*

## Parts List

- |                            |                        |
|----------------------------|------------------------|
| (1) 3/8" lock washer       | (1) 1-1/8" pipe spacer |
| (1) 3/8" x 3/4" bolt       | (1) 1-5/8" pipe spacer |
| (1) 10mm x 1.5 x 60mm bolt | (2) 10mm lock washers  |
| (1) 10mm x 1.5 x 75mm bolt | (2) 3/8" flat washers  |



**WARNING**

Failure to follow these instructions can result in property damage, personal injury or even death.



1-800-669-9690

## SEAT ADAPTER KIT #88336 INSTALLATION INSTRUCTIONS



5805-01

ALL SPECIFICATIONS ARE SUBJECT TO CHANGE WITHOUT NOTICE

ROADMASTER, Inc. 6110 NE 127th Ave. Vancouver, WA 98682 360-896-0407 fax 360-735-9300 www.roadmasterinc.com

*continued from previous page*



**4.** Bolt into the floor pan using the supplied hardware. Use the 10mm x 1.5 x 60mm bolt, 10mm lock washer and 3/8" flat washer over the mount with the shorter pipe spacer, and the 10mm x 1.5 x 75mm bolt, 10mm lock washer and 3/8" flat washer over the longer pipe spacer (Fig.4).

**5.** Attach the BrakeMaster to the brake pedal and to the seat adapter. Adjust the length of the air cylinder assembly, per the BrakeMaster installation instructions, ensuring that the BrakeMaster is pulling back on the brake pedal so the pedal is only depressed when the brakes are engaged at the motorhome. Failure to adjust the assembled length of the BrakeMaster may result in severe brake system damage and/or complete failure of the brakes.



**WARNING**

Failure to follow these instructions can result in property damage, personal injury or even death.