



Battery Ace™ — Battery Disconnect w/ Remote Key Fobs

INSTRUCTIONS & MANUAL

PART#768

11/25
RS

ROADMASTER, Inc. 6110 NE 127th Ave. Vancouver, WA 98682 360-896-0407 www.Roadmasterinc.com

Required tools and supplies

- Power Dremel, rotary tool, die grinder, or file
- Phillips screwdriver, sockets, and wrench
- Wire strippers and crimpers
- Heat Gun

CAUTION

Read all instructions before installing or operating this device. Failure to understand how to properly install or operate Battery Disconnect could result in extensive property damage.



Need Help? Call Toll-Free

1-800-669-9690

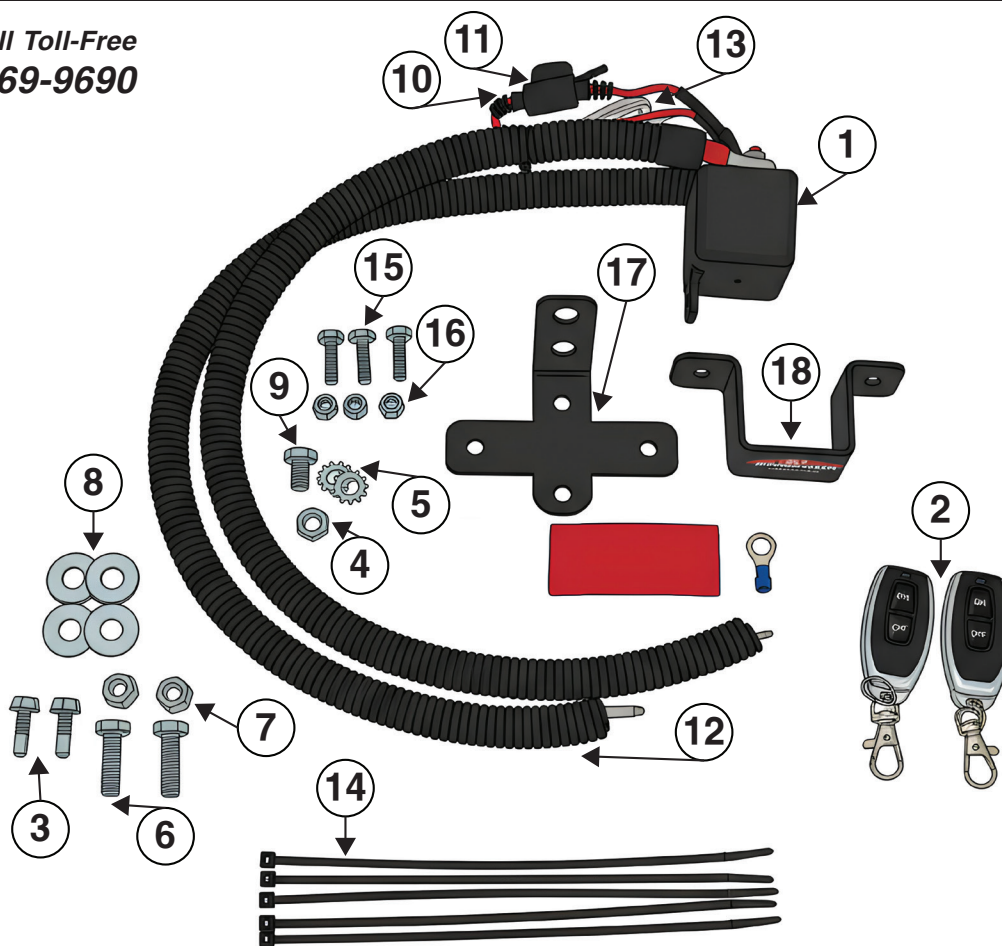

ITEM	QUANTITY	NAME	PART
1	1	RELAY	768200
2	2	KEY FOB	768200
3	3	1/4-14 X 3/4 HWH SELF DRILL SCR #3 PT ZC	357250-00
4	1	5/16 NF JAM NUT ZINC PLATED	350252-10
5	2	5/16 STAR WASHER, LOCK OUTWARD	350015-00
6	2	5/16 X 1 NC GD5 CAPSCREW	350030-00
7	2	5/16 NC NYLON INS LN ZINC PLATED	350253-00
8	4	1/4" USS CUT WASHER ZINC PLATED	350300-00
9	1	5/16 X 1/2" NF GD5 CAPSCREW ZINC PLATED	350031-50
10	1	ATM FUSE HOLDER - 14GA	451371
11	1	ATM MINI FUSE, 7.5 AMP	300104-75
12	4ft	CABLE, HEAVY DUTY WELD 600V RED	200005-50
13	2ft	WHITE WIRE 16 ga (MTW) 30m	300080-09
14	5	ZIP TIE UNIVERSAL 7.8"	300140-8
15	3	M6 X 1 X 20MM 8.8 CAPSCREW ZINC PLATED	355751-20
16	3	M6-1.0 METRIC LOCKNUT ZINC PLATED	355760-00
17	1	BATTERY DISCONNECT MOUNTING BRACKET	B004428
18	1	BATTERY DISCONNECT CLAMP PLATE	B004429
Not Shown	1	CARBON FIBER FARADAY KEY FOB POUCH	768250



Battery Ace™ — Battery Disconnect w/ Remote Key Fobs

INSTRUCTIONS & MANUAL

PART#768

11/25
RS

ROADMASTER, Inc. 6110 NE 127th Ave. Vancouver, WA 98682 360-896-0407 www.Roadmasterinc.com

⚠ DANGER!

This battery disconnect could be used to disconnect any 12 volt battery on a gasoline vehicle. This kit **ONLY** works with our provided hardware! Not for use with all vehicles. This disconnect is **NOT** for diesel engines.

Failure to follow the vehicle's owner's manual instructions for towing may cause non-warranty damage to the vehicle's components. It is the owner's responsibility to make certain that the battery cable can be safely disconnected for towing, and that all instructions in the vehicle owner's manual regarding towing are followed.

Do not use this product on vehicles with diesel engines, as they draw too much current and will cause non-warranty failure of the Relay – use the 767 Manual Battery Disconnect instead.

— About This Kit —

Our *Battery Ace* Remote Battery Disconnect with Key Fob helps eliminate the necessity of manually disconnecting your vehicle battery for towing, then having to reconnect it for driving. After the installation you will be able to press a highly convenient button on a wireless fob to accomplish the same task. This kit comes with two fobs and a safety faraday pouch (this prevents radio waves from escaping) to store the fobs. This battery disconnect does not work with diesel vehicles, always check with your vehicle's owner's manual to confirm it can work with a battery disconnect.

Check Roadmasterinc.com/patents for relevant patent information.

Rated at 200-amp up to 14 volts. Works on 12-volt batteries.

IMPORTANT: All illustrations and specifications contained herein are based on the latest information available at the time of publication approval. ROADMASTER, INC. reserves the right to make changes at any time without notice in material, specification and models or to discontinue models.



WARNING: This product can expose you to chemicals including vinyl chloride, which is known to the State of California to cause cancer and birth defects or reproductive harm. For more information, go to www.P65Warnings.ca.gov.

IMPORTANT NOTICE

Safety Definitions

These instructions contain information that is very important to know and understand. This information is provided for **safety** and to **prevent equipment problems**. To help recognize this information, observe the following symbols:

⚠ WARNING

WARNING indicates a potentially hazardous situation which, if not avoided, could result in property damage, serious personal injury, or even death.

⚠ CAUTION

CAUTION indicates a potentially hazardous situation which, if not avoided, may result in property damage, or minor or moderate personal injury.

⚠ DANGER!

DANGER! indicates a serious hazardous situation which, if not avoided, will result in property damage, serious personal injury, or even loss of life.

NOTE

Refers to important information and is placed in italic type. It is recommended that you take special notice of these items.



Battery Ace™ — Battery Disconnect w/ Remote Key Fobs

INSTRUCTIONS & MANUAL

PART#768

11/25
RS

ROADMASTER, Inc. 6110 NE 127th Ave. Vancouver, WA 98682 360-896-0407 www.Roadmasterinc.com

Installation

NOTE: Photos shown alongside instructions are for demonstration purposes only, your vehicle will differ from them, but the instructions are the same.

1. Make sure the vehicle is off. Follow the vehicle manufacturer's instructions to disconnect the negative battery cable.

2. Remove the plastic housing cover from the starter battery. Choose a mounting location for the battery disconnect Relay (Fig.A1 & 2) inside the engine compartment. The orientation of the Relay does not matter. This mounting location must meet the following conditions:

- The mounting location must support the weight of the battery disconnect and must be protected from road spray.
- The two cables on the battery disconnect must be able to reach the battery posts or terminal bus.
- Ideally, look for an existing bolt or mounting hole near the battery. Frequently you can utilize this for attaching the Relay's Mounting Bracket.

3. Position the Mounting Bracket at the desired location. Either use the pre-existing bolt, the include 1/4" self tapping screws or alternative hardware to secure the Mounting Bracket to the mounting location. Pre-drill a pilot hole if necessary.

4. Use a 20mm bolt and matching nut to secure the Relay to the Mounting Bracket. Use the Clamp Plate and two 20mm bolts and nuts to sandwich the Relay to the Mounting Bracket.

5. Then attach the white ground wire to any good chassis ground with the included ring terminal. The wire may be trimmed to length if needed (Fig.B).

6. Inspect the vehicles's positive battery terminal and attached cable. You will now determine if you will be connecting the battery disconnect to the OEM positive battery cable, or whether you will be connecting it to the battery bus. In most applications, the battery bus is the preferred method as it is cleaner and less visible. Connecting to the battery cable, may be easier.

• Option 1: Connecting to the battery cable.

Slide the provided section of shrink tubing (Fig.C1) over the Relay cable labeled "POSITIVE CABLE." Then attach this cable to the positive cable you just removed from the battery: align the two ends of the cables so they match. Connect the two cables together as shown in Figure C2. *Note: It is imperative that the star washers are positioned as shown. Note: If the end of the vehicle's battery cable has a diameter smaller than 5/16", use a 5/16" drill to enlarge it.*

Slide the shrink tubing over the connection as shown in Figure C1. Be certain no metal is exposed. Seal the shrink tubing with a heat gun or similar device.

⚠ CAUTION

Make certain that no metal is exposed on either side of the shrink tubing. If metal is exposed, a short circuit may cause an electrical fire, which may result in severe damage to the vehicle.

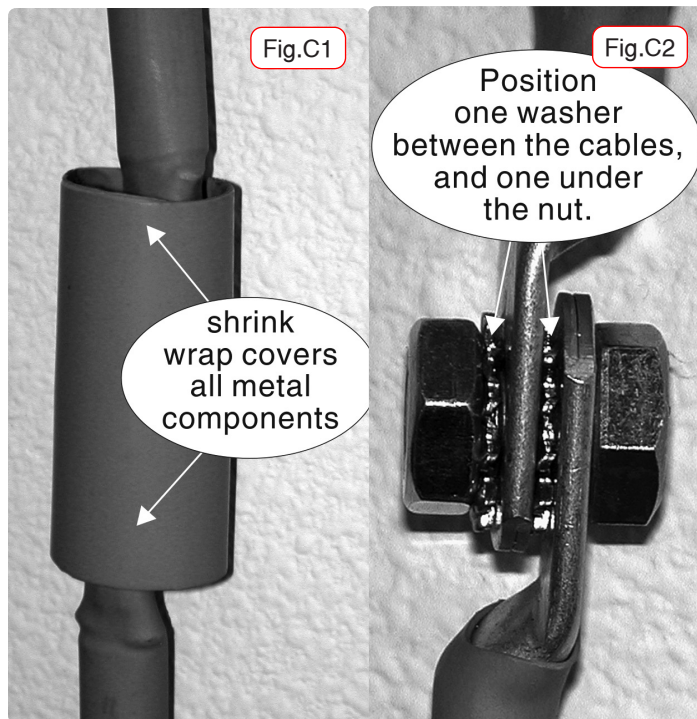
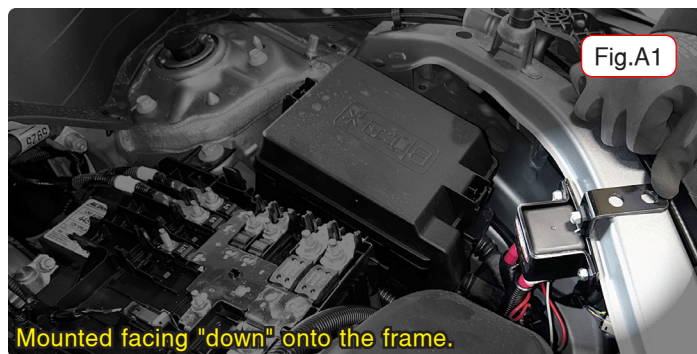



Battery Ace™ — Battery Disconnect w/ Remote Key Fobs

INSTRUCTIONS & MANUAL

PART#768

11/25
RS

ROADMASTER, Inc. 6110 NE 127th Ave. Vancouver, WA 98682 360-896-0407 www.Roadmasterinc.com

- **Option 2:** Connect the Relay to the battery bus.

Most late model batteries may have a steel tab that conducts power to multiple terminals in a bus. Cut the steel tab along the dotted lines as similar to figure C3. This will prevent power from accessing the rest of the terminal bus.

Identify a vertical stud or bolt to connect to, on the bus. This is the portion of the block that is no longer connected to the battery as a result of the cutting performed in the prior step. Identify the cable from the Relay called "Cable" (note the sticker may be underneath the split loom). Then, secure the ring terminal of the 'CABLE' to the most convenient vertical stud or bolt. **DO NOT CONNECT THE 'CABLE' TO THE STUD ON A POWER FUSE!** It may be helpful to bend the ring terminal into place for a better fit (Fig. D).

7. Attach the Relay cable labeled "POST", and any other accessories that require power when the battery is disconnected, to the battery post (Fig E.)

8. Trim any excess split loom on the cables that interfere with closing the plastic lid.

9. Look at the inside of the housing cover removed in Step 2. Using a Dremel, die grinder or file, remove any plastic ribs that would interfere with the cables or any part of the battery disconnect assembly.

10. Reconnect the negative battery cable you disconnected in Step 1. Replace the battery cover removed in Step 2. (Fig.F).

11. Professionally route the white ground wire and any cables using the included 8" cable ties.

12. Test the setup as described on the next page.

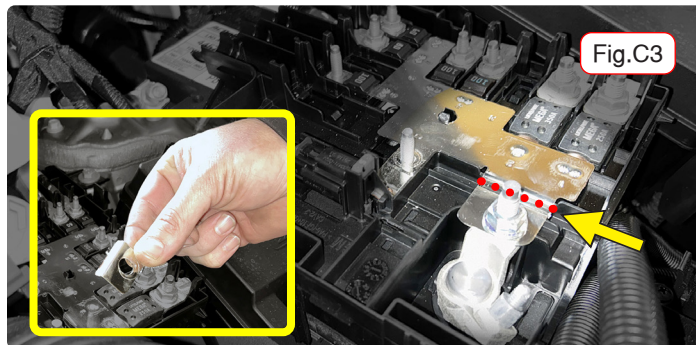



Operation Information

WARNING

Never disconnect the battery while operating the vehicle. Pushing the battery disconnect off button will shut off the engine which may cause a loss of vehicular control, resulting in property damage, personal injury or even death.

CAUTION

Repeatedly pushing the battery disconnect buttons may damage the vehicle's transmission, electronics or other systems. When energized your vehicle's computer goes through a boot up sequence and diagnostics. Powering the vehicle on and off rapidly can cause the computer to glitch leaving systems in an incorrect state. Other consequential, non-warranty damage may also occur.

Operating the battery disconnect...

1. Attempt to start the vehicle. If it won't start the Relay has already disconnected the battery. Press the 'On' button to reconnect the battery and the vehicle should start.
2. **To tow the vehicle:** With the battery connected, follow the owner's manual instructions to tow. At the point the manual instructs you to disconnect the battery, push the off button.
3. **To drive the vehicle:** follow the owner's manual instructions to reconnect the battery. At the point the manual instructs you to reconnect the battery, press the on button.
4. This kit includes a Faraday pouch that prevents radio frequencies from escaping. When inside the pouch, pressing the buttons will do nothing. Always store your key fobs in the Faraday pouch to prevent accidental connecting and disconnecting of your battery.

CAUTION

Your vehicle's key fob will not function once the battery has been disconnected. Accordingly, Roadmaster does not recommend storing your battery disconnect key fobs or vehicle key fobs within the vehicle unless you have an alternative means of unlocking your car without power.

To attach aftermarket accessories...

Attach aftermarket accessories, such as a supplemental braking system, to the positive post on the vehicle's battery.

CAUTION

The Remote Battery Disconnect is a convenient way to disconnect the vehicle's battery; however, disconnecting a vehicle's battery will affect the vehicle's electronics –

- You may need to reset dashboard presets, such as radio presets or seat and brake pedal presets.
- You may need to re-wire aftermarket electrical accessories, such as supplemental braking systems.
- Vehicles equipped with a Roadmaster braking system will require a brake light switch connected to the positive post on the vehicle's battery. Otherwise, the motor-home monitor will not indicate braking activity. Severe damage to the towed vehicle's brakes may result.

WARNING

Failure to follow the procedures above may result in significant, non-warranty damage to the vehicle.