

Stowaway^{ROADMASTER}

Guardian XL Storage System

Installation Instructions for the 4000-50 Stowaway with rear RV access

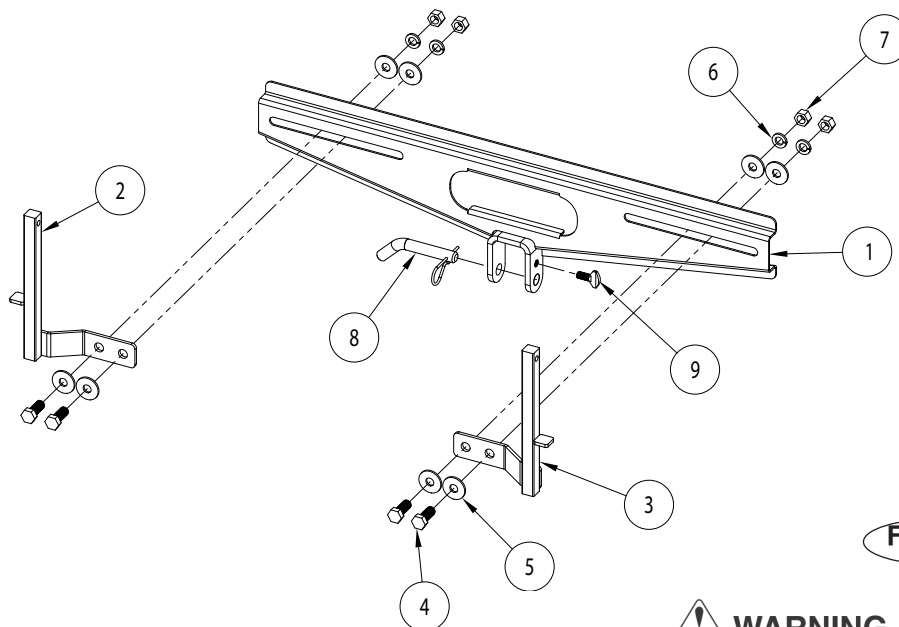

Figure A

NOTE: These instructions apply only to the Guardian XL. Use part 4000-40 for the regular Guardian.

Use the following instructions to install the 4000-50 Stowaway.

Before you begin...

In order to install the Stowaway, the motorhome receiver must extend past the rear of the coach. If the receiver is recessed, it can be extended an additional 12 inches with optional receiver extension #071, or six inches with optional receiver extension #072.

These extensions will work with any ROADMASTER motorhome-mounted tow bar.

Installation Instructions

(Refer to Figure A)

1. Slide the collar of the Stowaway over the tow bar stinger.
2. Now, insert the pin through the holes in the collar, and insert the clip through the pin to secure the Stowaway. Use the thumb screw to tighten the connection. (To remove the stowaway simply loosen the thumb screw, and then pull the pin and clip.)
3. Attach the remaining hardware as shown in Figure A; finger-tighten only.
4. Test-fit the Guardian XL over the brackets (items 2 & 3) and adjust the spacing, if necessary, to accommodate the Guardian XL. Then, **tighten all bolts.**
5. The Stowaway can be left on the tow bar while towing.



WARNING

Do not use the Stowaway or its mounting brackets as attachment points to tow a vehicle. The Stowaway is not designed to carry the weight of a vehicle and will fail if used for towing, which will cause the vehicle to detach, resulting in property damage, personal injury or even death.

6. When not towing, store the Guardian XL on the Stowaway by lowering the Guardian XL onto the brackets. Then, secure it in place by attaching the pins that came with the Guardian XL through the holes at the top of the square posts.

CAUTION

Make certain that the Stowaway, or anything stored on the Stowaway, does not come into contact with the motorhome. If the Stowaway vibrates against the motorhome, it may damage the finish, or cause other non-warranty damage.

Also, ensure that the Guardian XL is not too close, or comes into contact with, the motor-home exhaust (or any other "hot" component) when it is stored on the Stowaway. The heat from the exhaust may deform the Guardian XL.

7. If convenient, the motorhome-to-towed vehicle electrical connections can be routed through the center cut-out.

