



Front Anti-Sway Bar Kit INSTALLATION INSTRUCTIONS

KIT# 1109-131

06/25
RS

ROADMASTER, Inc. 6110 NE 127th Ave. Vancouver, WA 98682 360-896-0407 www.RoadmasterInc.com

For Chevrolet G30

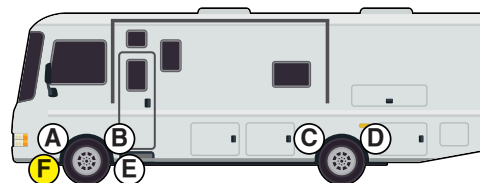

WARNING

Failure to follow these instructions can result in property damage, personal injury or even death.

- If raising the vehicle to install the anti-sway bar, always support the vehicle with jack stands at both frame rails or at the rear axle before working underneath. Ensure that the jack stands are securely positioned, and are rated at or above the weight of the vehicle.
- The installer must read the instructions and use all bolts and parts supplied. Use only the parts supplied by ROADMASTER to install this kit.
- Minor modifications are sometimes necessary due to slight vehicle variations, even for the same year, make and model.
- Regardless of year, make and model, a wide range of options for specific applications may or may not interfere with the installation. It is the installer's responsibility to make certain that equipment is not damaged once the suspension solution travels through the full range of motion. Failure to ensure adequate clearance could result in non-warranty property damage, personal injury or even death.

- If running changes were made by the manufacturer after this kit was designed, there may be weldments, braces, gussets, or other structural items which interfere with the installation. It is the installer's responsibility to allow for these running changes without sacrificing the structural integrity of the anti-sway bar. Failure to securely fasten the anti-sway bar could result in property damage, personal injury or even death.
- ROADMASTER will not be responsible for any damage or injury resulting from any modification or alteration.
- Check ALL the fasteners for tightness before and after road testing the vehicle.
- Do not use this document for custom fabrication, as it may not show all parts or structural components.
- Do not use an air impact wrench when re-installing bolts, as stripped threads may result.
- This anti-sway bar is only warranted for the original installation. Installing a used anti-sway bar on another vehicle is not recommended and will void the warranty.

Information:

Thank you for purchasing this rear anti-sway bar kit. This kit is designed to improve the handling characteristics of the Chevrolet G30 motorhome; by reducing the body roll and balancing the weight transfer during cornering.

The anti-sway bar kit is engineered for long life and trouble-free performance. For maximum suspension control, use this kit along with our shock absorbers and our front anti-sway bar kit. All the hardware needed for installation is included in this kit. Refer to the PARTS LIST in these instructions to identify the parts.

Before starting the installation, lay out the kit components in order, as they will be used. This will give you a visual idea of how the components work, and will also confirm that everything is present and accounted for.

BOLT TORQUE REQUIREMENTS

Note: The torque values represented below are intended as general guidelines. Torque requirements for specific applications may vary. Roadmaster does not warrant this information to be accurate for all applications and disclaims all liability for any claims or damages which may result from its use.

STANDARD BOLTS

Thread Size	Grade	Torque
5/16-18	5	13 ft./lb.
3/8-16	5	23 ft./lb.
7/16-14	5	37 ft./lb.
1/2-13	5	57 ft./lb.
5/8-11	5	112 ft./lb.

METRIC BOLTS

Thread Size	Grade	Torque
6mm-1.0	8.8	6 ft./lb.
8mm-1.0	8.8	18 ft./lb.
8mm-1.25	8.8	16 ft./lb.
10mm-1.25	8.8	36 ft./lb.
10mm-1.5	8.8	31 ft./lb.

METRIC BOLTS

Thread Size	Grade	Torque
12mm-1.25	8.8	64 ft./lb.
12mm-1.5	8.8	60 ft./lb.
12mm-1.75	8.8	55 ft./lb.
14mm-2.0	8.8	88 ft./lb.



Front Anti-Sway Bar Kit

INSTALLATION INSTRUCTIONS

KIT# 1109-131

06/25
RS

ROADMASTER, Inc. 6110 NE 127th Ave. Vancouver, WA 98682 360-896-0407 www.RoadmasterInc.com

What You'll Need

Sockets and Wrench
General Hand tools
Jack Stands
Second Person to Help

About this kit

1-3/8" diameter
Fits most Chevrolet G30 motorhome

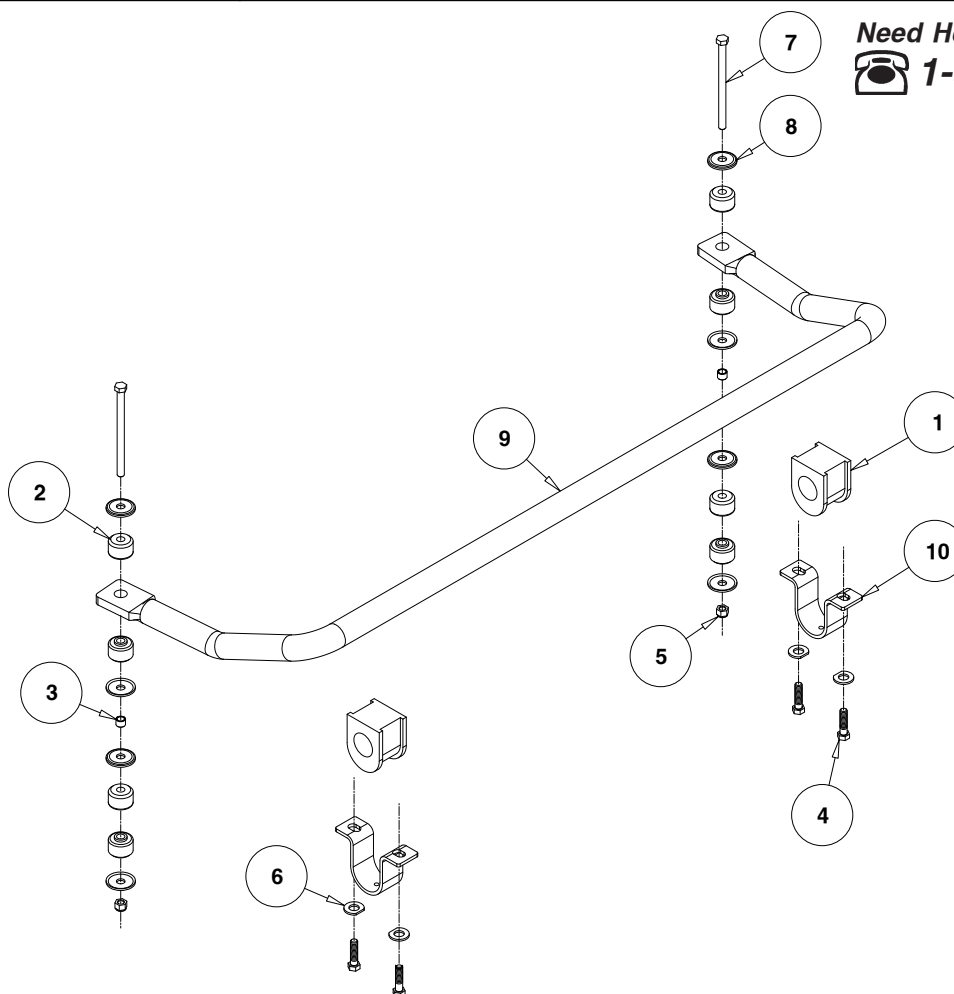

Need Help? Call Toll-Free
 1-800-669-9690

ITEM	QTY	MATERIAL	NAME
1	2	BUSHING	205219-10
2	8	POLYURETHANE GROMMET	205381-00
3	2	3/8" SPACER	205514-00
4	4	3/8" X 1 1/2" BOLT	350057-80
5	2	3/8" NYLOCK NUT	350255-00
6	4	3/8" CLIPPED FLAT WASHER	350304-30
7	2	3/8" X 5 1/2" BOLT	350621-00
8	8	CUP WASHER	357434-00
9	1	1 3/8" SWAY BAR	580012-00
10	2	SADDLE BRACKET	B140
11	1	AQUALUBE	400011-30
12	1	THREADLOCKER	200544-00

Important: All illustrations and specifications contained herein are based on the latest information available at the time of publication approval. ROADMASTER, INC. reserves the right to make changes at any time without notice in material, specification and models or to discontinue models.



Front Anti-Sway Bar Kit INSTALLATION INSTRUCTIONS

KIT# 1109-131

06/25
RS

ROADMASTER, Inc. 6110 NE 127th Ave. Vancouver, WA 98682 360-896-0407 www.RoadmasterInc.com

Installation:

1. (Optional) Use a floor jack to raise the vehicle. Shift the vehicle into neutral. Place the jack under the frame and lift until the tires are off the ground. If the vehicle is being raised to install the anti-sway bar, always support it with jack stands positioned under both frame rails or at the rear axle. Ensure the stands are securely placed and rated to support the full weight of the vehicle. Place the jack stands under the front A-frames to keep the suspension loaded during installation. Check the stability by pushing on the vehicle body to ensure it is secure before working underneath.

2. Unbolt the end links first, followed by the saddle brackets. Due to the size and weight of the bar, a second person is recommended to assist with removal of the final brackets.

3. Apply the provided grease to the inside of each polyurethane bushing (Fig.1). Slide the bushings onto the new anti-sway bar in locations matching the original bar. Push the saddle brackets over the bushings.

4. With the help of a second person, lift the anti-sway bar into position. Rest the ends on the tie rods, then raise the center of the bar and start the bolts into the existing frame holes.

5. Assemble the end links as shown in the parts diagram. Install the end link assemblies through the outer holes of the original A-arm brackets. Start the nuts on the end links. Center the anti-sway bar side-to-side. Tighten all fasteners. Do not overtighten the grommets. If using a torque wrench, tighten the saddle bracket bolts to 25 ft-lbs.

6. Raise the vehicle slightly with the floor jack and remove the jack stands. Lower the vehicle to the ground.

7. Test drive the vehicle. Recheck all fasteners and listen for any unusual noises. Torque bolts as needed after initial drive.

Figure 1

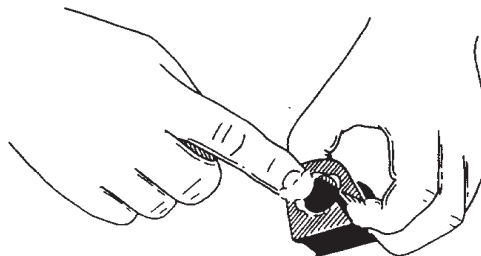
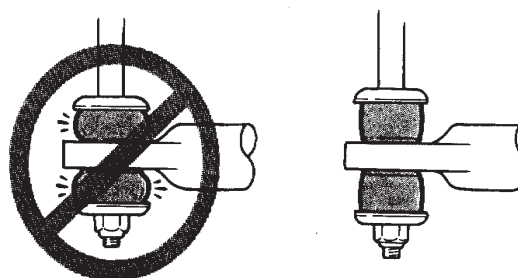

Figure 2



WARNING

After road testing, re-check all fasteners for proper tightness – if a fastener has worked loose or fallen off, re-tighten or replace it. Without all kit components properly tightened or in place, the anti-sway bar will not stabilize the vehicle at full capacity, which may cause reduced cornering ability or other reductions in vehicle handling or performance.

Failure to follow these instructions may cause property damage, personal injury or even death.

WARNING

The anti-sway bar is not a load-bearing component!

Do not tow or hoist the vehicle using the anti-sway bar or its mounting brackets as attachment points. The anti-sway bar is not designed to carry the weight of the vehicle and may collapse, which will damage the anti-sway bar components, the suspension, or other components. The vehicle will detach or fall, which may cause severe personal injury.

Failure to follow the instructions in this packet and the warnings therein may result in property damage, personal injury or even death.

WARNING

The anti-sway bar is heavy, and may cause property damage or personal injury if it falls on equipment, engine components or any part of your body. Ensure that the anti-sway bar is supported and that you are out of the way when removing the brackets.

Failure to follow these instructions may cause property damage, personal injury or even death.