



Installation Instructions

Thank you for purchasing our anti-sway bar kit. Please read through these instructions before installation.

Front Anti-Sway Bar Kit for Chevy Suburban/Pick up 1992-on

part #1109-137
1-3/8" diameter

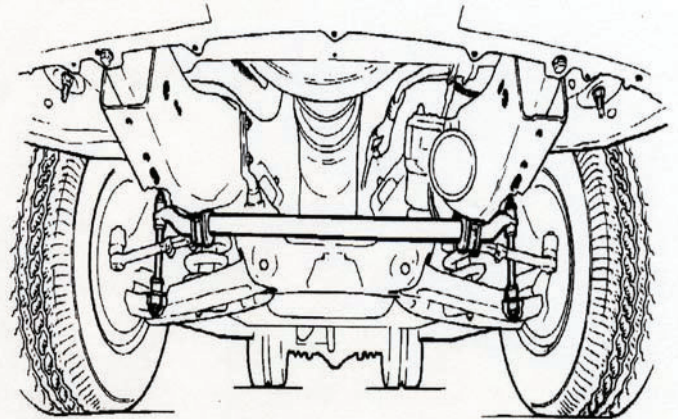

INTRODUCTION

Thank you for purchasing this anti-sway bar kit. This kit is designed to improve the handling characteristics of your Chevy truck by reducing the body roll and balancing the weight transfer during cornering. The anti-sway bar kit is engineered for long life and trouble-free performance. For maximum suspension control, use this kit along with our rear anti-sway bar kit.

All the hardware needed for installation is included in this kit. Refer to the PARTS LIST in these instructions to identify the parts.

SUGGESTED TOOLS

The following tools are suggested to complete the installation procedures:

- 9/16" Open/box wrench
- Ratchet wrench
- 9/16" Socket
- Jack & jack stands (optional)

WARNING

- If raising the vehicle to install the anti-sway bar, always support the vehicle with jack stands at both frame rails or at the rear axle before working underneath. Ensure that the jack stands are securely positioned, and are rated at or above the weight of the vehicle.
- The installer must read the instructions and use all bolts and parts supplied. Use only the parts supplied by ROADMASTER to install this kit.
- Minor modifications are sometimes necessary due to slight vehicle variations, even for the same year, make and model.
- If running changes were made by the manufacturer after this kit was designed, there may be weldments, braces, gussets, or other structural items which interfere with the installation. It is the installer's responsibility to allow for these running changes without sacrificing the structural integrity of the anti-sway bar. Failure to securely fasten the anti-sway bar could result in property damage, personal injury or even death.
- ROADMASTER will not be responsible for any damage or injury resulting from any modification or alteration.
- Check ALL the fasteners for tightness before and after road testing the vehicle.
- Do not use this document for custom fabrication, as it may not show all parts or structural components.
- Do not use an air impact wrench when re-installing bolts, as stripped threads may result.
- This anti-sway bar is only warranted for the original installation. Installing a used anti-sway bar on another vehicle is not recommended and will void the warranty.

WARNING

Failure to follow these instructions can result in property damage, personal injury or even death.

PARTS LIST

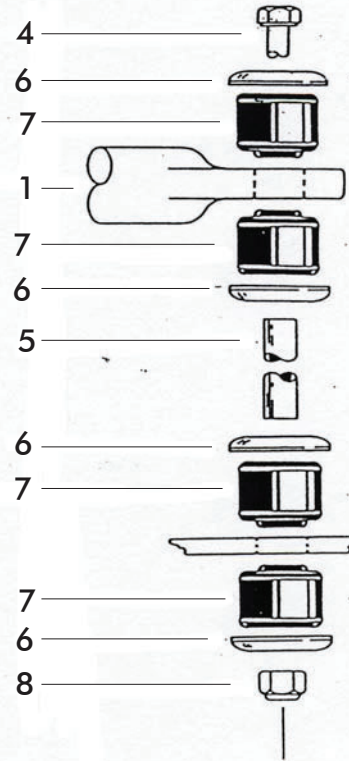
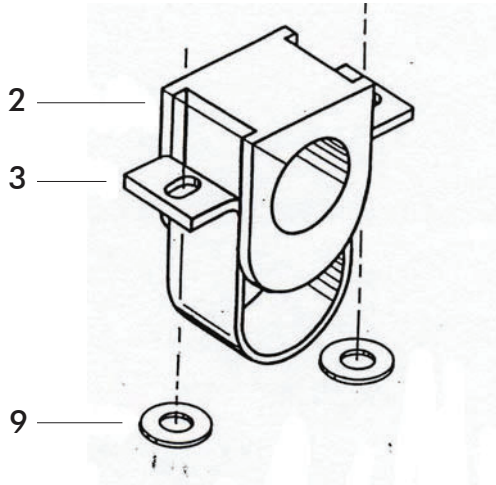

Part #1109-137

Part #	Description	Qty	Part #	Description	Qty
1. 580060-00	Swaybar 1-3/8" diameter	1	6. 357432-00	Washer, cup	8
2. 205219-10	Bushings, split poly	2	7. 205381-00	Grommet, poly	8
3. B140	Bracket, Saddle	2	8. 350255-00	Locknut, 3/8" NC	2
4. 350069-00	Bolt, 3/8" x 9-1/2" NC	2	9. 350304-00	Washer, 5/16" cut	4
5. 205509-00	Spacer tube, 4-1/2"	2	10. 400011-30	AQUALUBE Grease	1

INSTALLATION

The following instructions must be followed in the order listed to ensure a proper installation and to preserve the ROADMASTER warranty.

1. Support the vehicle and remove the rear wheels (optional).

2. Use a floor jack to raise the vehicle.

Put the vehicle in neutral. Put a floor jack under the frame and raise the vehicle so that the tires are off the ground.

! WARNING

If raising the vehicle to install the anti-sway bar, always support the vehicle with jack stands at both frame rails or at the rear axle before working underneath. Ensure that the jack stands are securely positioned, and are rated at or above the weight of the vehicle.

3. Put the jack stands under the A arms.

Place the jack stands under the front A arms to correctly support the vehicle. It's also easier to install the new anti-sway bar if the suspension is loaded. Lower the vehicle onto the jack stands. Push the side of the body to make sure that the vehicle is stable.

4. Remove the factory anti-sway bar.

Unbolt the end links and then unbolt the saddle brackets. Since the bar is large and heavy, it is best to have a helper when removing the final two saddle brackets. Reuse the old fasteners from saddle brackets. New washers are provided to use with the new saddle brackets.

! WARNING

Removing the brackets will release the anti-sway bar. The anti-sway bar is heavy, and may cause property damage or personal injury if it falls on equipment, engine components or any part of your body. Ensure that the anti-sway bar is supported and that you are out of the way when removing the brackets.

Failure to follow these instructions may cause property damage, personal injury or even death.

5. Prepare the anti-sway bar for installation.

Lubricate the bushings with the provided grease (Figure 1). Put a thorough coat of grease on the inside of each bushing. Place the bushing on the anti-sway bar. Use the factory anti-sway bar to determine the proper location for the polybushings. Push the saddle brackets over the bushings.

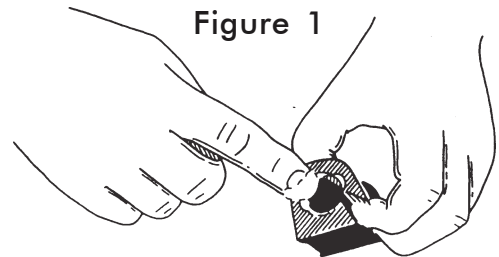

Figure 1

INSTALLATION

6. Install the anti-sway bar.

Lift the anti-sway bar into place, setting the ends on the tie rods. Then, lift the center into place and start the bolts into the frame holes.

7. Assemble the end links and install.

Refer to the parts explosion if there are any questions on the order of the end link assembly. Start nuts on the end links. If you have a torque wrench, tighten saddle brackets to 25 ft.-lbs.

8. Center the bar.

Once the bar is centered side-to-side, finish tightening all the fasteners. **DO NOT** overtighten end link grommets (Figure 3).

WARNING

Over-tightening the grommets may cause premature failure of the grommets and/or the end links. If the grommets fail, the anti-sway bar will not stabilize the vehicle at full capacity, which may cause reduced cornering ability or other reductions in vehicle handling or performance.

Failure to follow these instructions may result in property damage, personal injury or even death.

9. Lower the vehicle (if jack stands were used).

Jack up the vehicle and remove the jack stands.

10. Road test. Listen for noise.

WARNING

After road testing, re-check all fasteners for proper tightness — if a fastener has worked loose or fallen off, re-tighten or replace it. Without all kit components properly tightened or in place, the anti-sway bar will not stabilize the vehicle at full capacity, which may cause reduced cornering ability or other reductions in vehicle handling or performance.

Failure to follow these instructions may result in property damage, personal injury or even death.

WARNING

The anti-sway bar is not a load-bearing component

Do not tow or hoist the vehicle using the anti-sway bar or its mounting brackets as attachment points. The anti-sway bar is not designed to carry the weight of the vehicle and may collapse, which will damage the anti-sway bar components, the suspension, or other components. The vehicle will detach or fall, which may cause severe personal injury.

Failure to follow these instructions may result in property damage, personal injury or even death.

Overview

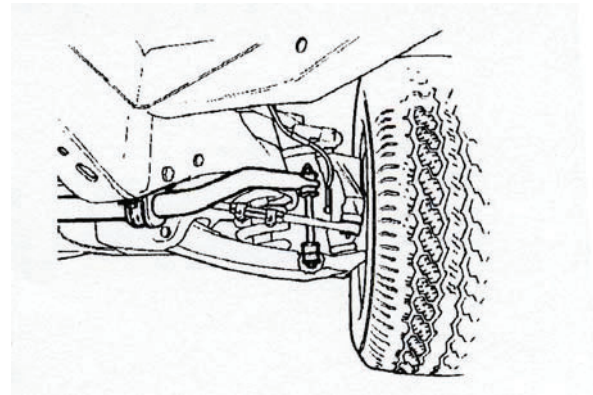

Figure 3

