



Rear Anti-Sway Bar Kit INSTALLATION INSTRUCTIONS

KIT# 1129-122

09/25
RS

ROADMASTER, Inc.

6110 NE 127th Ave.

Vancouver, WA 98682

360-896-0407

www.RoadmasterInc.com

For Dodge
2500 / 3500 ('96-'02)

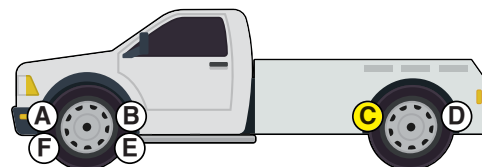

WARNING

Failure to follow these instructions can result in property damage, personal injury or even death.

- If raising the vehicle to install the anti-sway bar, always support the vehicle with jack stands at both frame rails or at the rear axle before working underneath. Ensure that the jack stands are securely positioned, and are rated at or above the weight of the vehicle.
- The installer must read the instructions and use all bolts and parts supplied. Use only the parts supplied by ROADMASTER to install this kit.
- Minor modifications are sometimes necessary due to slight vehicle variations, even for the same year, make and model.
- Regardless of year, make and model, a wide range of options for specific applications may or may not interfere with the installation. It is the installer's responsibility to make certain that equipment is not damaged once the suspension solution travels through the full range of motion. Failure to ensure adequate clearance could result in non-warranty property damage, personal injury or even death.

- If running changes were made by the manufacturer after this kit was designed, there may be weldments, braces, gussets, or other structural items which interfere with the installation. It is the installer's responsibility to allow for these running changes without sacrificing the structural integrity of the anti-sway bar. Failure to securely fasten the anti-sway bar could result in property damage, personal injury or even death.
- ROADMASTER will not be responsible for any damage or injury resulting from any modification or alteration.
- Check ALL the fasteners for tightness before and after road testing the vehicle.
- Do not use this document for custom fabrication, as it may not show all parts or structural components.
- Do not use an air impact wrench when re-installing bolts, as stripped threads may result.
- This anti-sway bar is only warranted for the original installation. Installing a used anti-sway bar on another vehicle is not recommended and will void the warranty.

Information:

Thank you for purchasing this rear anti-sway bar kit. This kit is designed to improve the handling characteristics of the truck; by reducing the body roll and balancing the weight transfer during cornering.

The anti-sway bar kit is engineered for long life and trouble-free performance. For maximum suspension control, use this kit along with our shock absorbers and our front anti-sway bar kit. All the hardware needed for installation is included in this kit. Refer to the *PARTS LIST* in these instructions to identify the parts.

Before starting the installation, lay out the kit components in order, as they will be used. This will give you a visual idea of how the components work, and will also confirm that everything is present and accounted for.

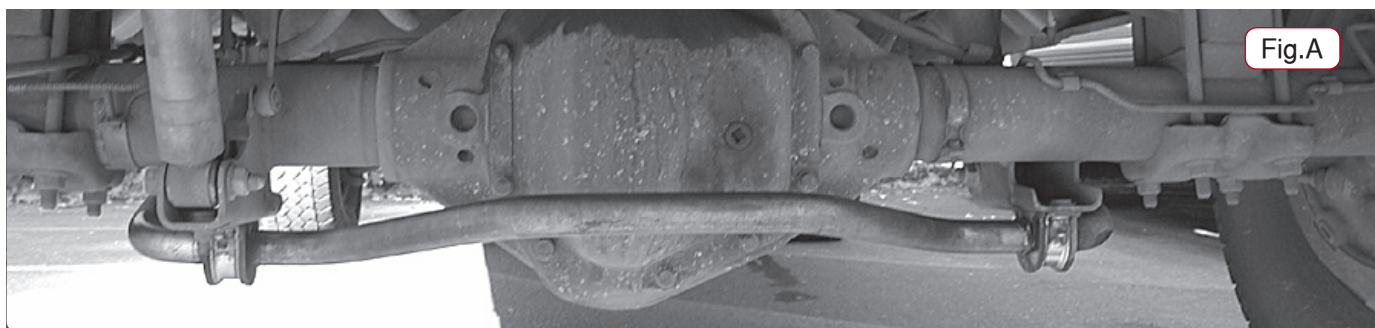

BOLT TORQUE REQUIREMENTS

Note: The torque values represented below are intended as general guidelines. Torque requirements for specific applications may vary. Roadmaster does not warrant this information to be accurate for all applications and disclaims all liability for any claims or damages which may result from its use.

STANDARD BOLTS

Thread Size	Grade	Torque
5/16-18	5	13 ft./lb.
3/8-16	5	23 ft./lb.
7/16-14	5	37 ft./lb.
1/2-13	5	57 ft./lb.
5/8-11	5	112 ft./lb.

METRIC BOLTS

Thread Size	Grade	Torque
6mm-1.0	8.8	6 ft./lb.
8mm-1.0	8.8	18 ft./lb.
8mm-1.25	8.8	16 ft./lb.
10mm-1.25	8.8	36 ft./lb.
10mm-1.5	8.8	31 ft./lb.

METRIC BOLTS

Thread Size	Grade	Torque
12mm-1.25	8.8	64 ft./lb.
12mm-1.5	8.8	60 ft./lb.
12mm-1.75	8.8	55 ft./lb.
14mm-2.0	8.8	88 ft./lb.



Rear Anti-Sway Bar Kit

INSTALLATION INSTRUCTIONS

KIT# 1129-122

09/25
RS

ROADMASTER, Inc.

6110 NE 127th Ave.

Vancouver, WA 98682

360-896-0407

www.RoadmasterInc.com

What You'll Need

- Sockets and Wrench
- General Hand tools
- Allen Wrench
- Electric Drill
- Second Person to Help

About this kit

1-1/4" Diameter

Need Help? Call Toll-Free
 1-800-669-9690

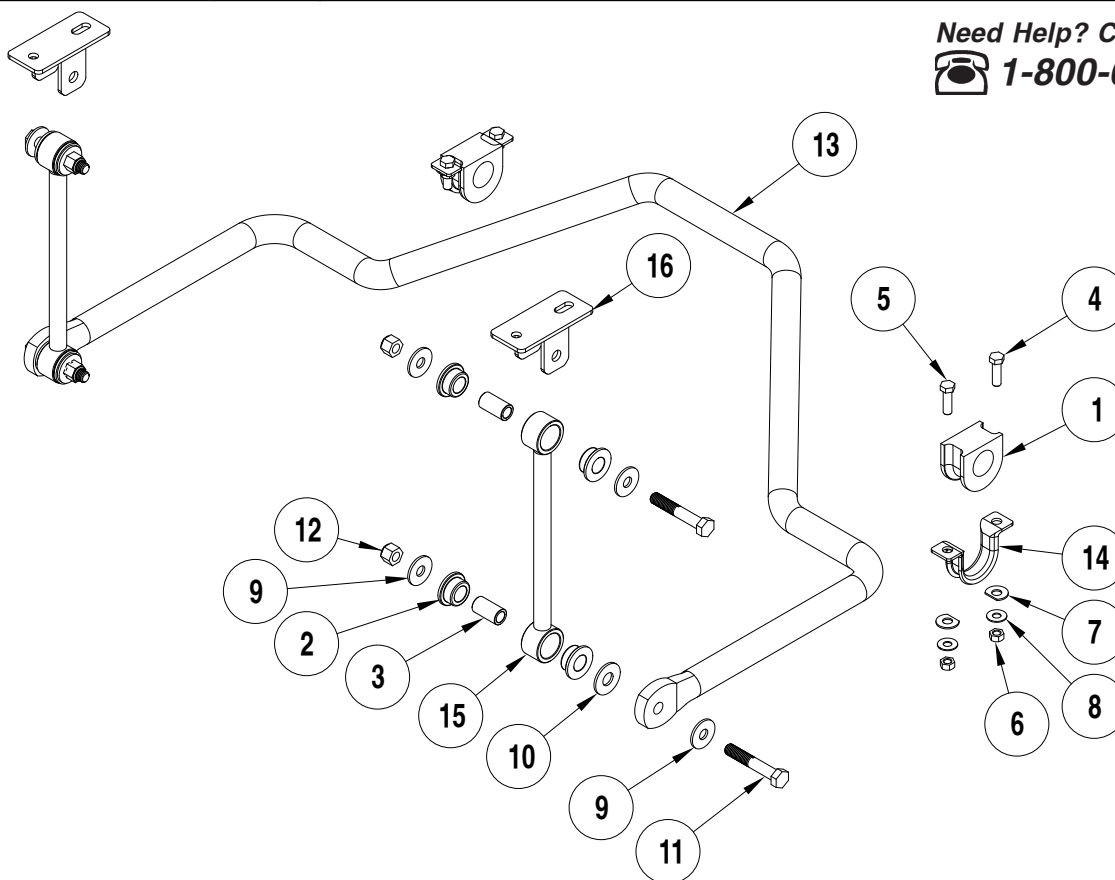

ITEM	QTY.	DESCRIPTION	PART
1	2	BUSHING	205215-10
2	8	BUSHING	205223-50
3	4	BUSHING SLEEVE	205522-00
4	2	3/8-16 x 1 1/4" SOCKET HEAD SCREW - GRADE 8	350056-20
5	2	3/8-16 BOLT - GRADE 8	350056-80
6	4	3/8 LOCK NUT	350272-00
7	4	3/8" D - WASHER	350304-30
8	4	3/8" HARDENED WASHER	350304-80
9	8	1/2" FLAT WASHER	350308-00
10	2	9/16" FLAT WASHER	350347-00
11	4	1/2-13 x 3" BOLT - GRADE 8	350706-00
12	4	1/2-13 NYLON INSERT LOCK NUT	350735-00
13	1	ANTI-SWAY BAR	580019-00
14	2	BUSHING CLAMP	B142
15	2	END LINK	B315
16	2	FRAME BRACKET	B316
17	1	AQUALUBE	400011-30
18	1	THREADLOCKER	200544-00

Important: All illustrations and specifications contained herein are based on the latest information available at the time of publication approval. ROADMASTER, INC. reserves the right to make changes at any time without notice in material, specification and models or to discontinue models.



Rear Anti-Sway Bar Kit INSTALLATION INSTRUCTIONS

KIT# 1129-122

09/25
RS

ROADMASTER, Inc.

6110 NE 127th Ave.

Vancouver, WA 98682

360-896-0407

www.RoadmasterInc.com

Installation:

1. Support the rear axle; Place jack stands under the rear axle housing to correctly locate the mounting points for the links. Lower the axle housing onto the jack stands. Push the side of the body to make sure that the vehicle is stable.

2. Insert the saddle bracket bolts into the shock brackets.

Note: the rear shock lower mount may need to be removed to permit this. Place washers on the bolts and proceed. Use a button head bolt in the hole closest to the shock. Use a 3/8" bolt in the other hole.

3. Grease the inside of the bushings; Use the provided grease to grease the inside of the bushings. After greasing, place the bushings over the anti-sway bar.

4. Push the saddle brackets over the bushings; You may need a soft hammer to squeeze the brackets over the bushings.

5. Install sway bar to rear axle.

Note: the center bend in the anti-sway bar should go up Use the D-shaped washers and nuts to secure. The bar is not centered front to rear on the brackets, but is centered with respect to the axle.

6. Assemble the end bushings onto endlink. Push the poly bushings onto the endlinks. Push one of each size sleeve into the two endlinks. The one with the smaller ID is the top. Refer to the parts page.

7. Attach the upper mounting bracket to the endlink; Use the supplied 7/16" bolts to attach the upper mounting brackets to the endlinks. The flat tab of the bracket goes toward the front of the truck. Finger-tighten.

8. Use the supplied 1/2" bolts to attach each endlink to the inside of both anti-sway bar arms. Refer to the parts page to see where the washers go.

Note: these pictures show the anti-sway bar using the factory endlink.

⚠ WARNING

The anti-sway bar is heavy, and may cause property damage or personal injury if it falls on equipment, engine components or any part of your body. Ensure that the anti-sway bar is supported and that you are out of the way when removing the brackets.

Failure to follow these instructions may cause property damage, personal injury or even death.

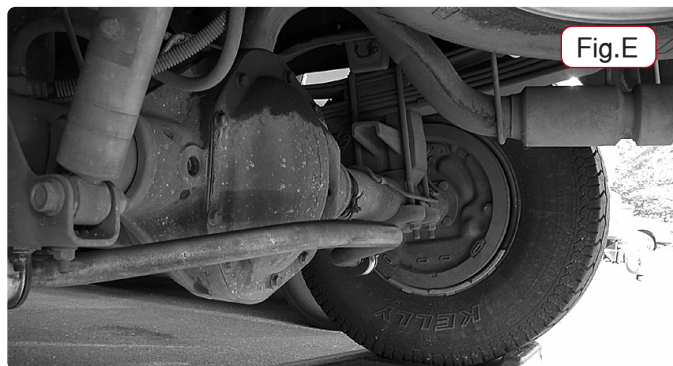
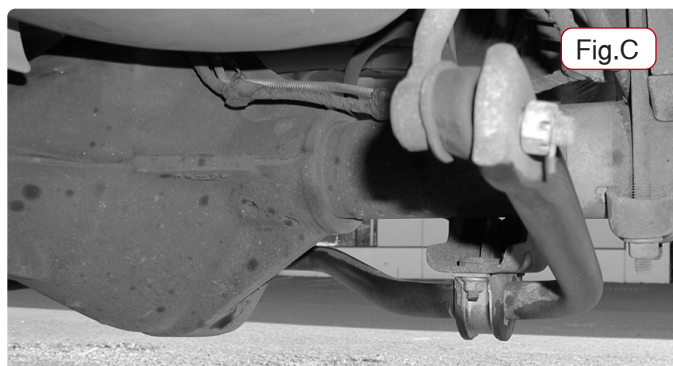
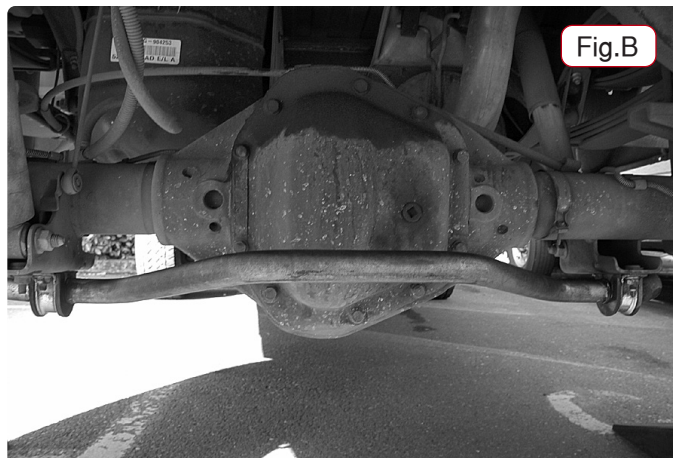



Rear Anti-Sway Bar Kit INSTALLATION INSTRUCTIONS

KIT# 1129-122

09/25
RS

ROADMASTER, Inc.

6110 NE 127th Ave.

Vancouver, WA 98682

360-896-0407

www.RoadmasterInc.com

9. On some models, there are already two holes that you can use to attach the upper mounting brackets. If holes are present, skip to Step 11. If the holes are not present, see Step 10.

10. Swing each endlink up to determine where to drill the holes. The end links should be roughly perpendicular to the ground.

11. Mark the frame rails and punch marks with a center punch. Drill a 1/8" pilot hole and then follow up with a 3/8" drill bit.

12. Tighten all fasteners. Reattach the lower shock mounts and tighten those fasteners.

13. Test drive the vehicle. Recheck all fasteners and listen for any unusual noises. Torque bolts as needed after initial drive.

WARNING

After road testing, re-check all fasteners for proper tightness – if a fastener has worked loose or fallen off, re-tighten or replace it. Without all kit components properly tightened or in place, the anti-sway bar will not stabilize the vehicle at full capacity, which may cause reduced cornering ability or other reductions in vehicle handling or performance.

Failure to follow these instructions may cause property damage, personal injury or even death.

WARNING

The anti-sway bar is not a load-bearing component!

Do not tow or hoist the vehicle using the anti-sway bar or its mounting brackets as attachment points. The anti-sway bar is not designed to carry the weight of the vehicle and may collapse, which will damage the anti-sway bar components, the suspension, or other components. The vehicle will detach or fall, which may cause severe personal injury.

Failure to follow the instructions in this packet and the warnings therein may result in property damage, personal injury or even death.