

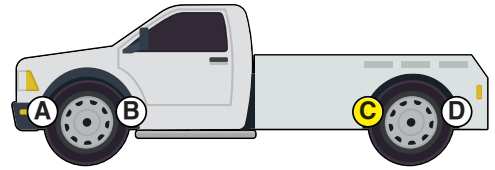

# Installation Instructions



## Rear Anti-Sway Bar Kit Ford F250-F350 Pickup SRW 1999-on (single rear wheel)

part # 1139-153  
1-3/8" diameter

**Thank you for purchasing our anti-sway bar kit. Please read through these instructions before installation.**

**\* If a 4" lift kit is installed, you will need the 590039-00 endlink kit.**

### INTRODUCTION

Thank you for purchasing the rear anti-sway bar kit. This kit is designed to improve the handling characteristics of your Ford F350 by reducing the body roll and balancing the weight transfer during cornering. The anti-sway bar kit is engineered for long life and trouble-free performance.

All the hardware needed for installation is included in this kit. Refer to the PARTS LIST in these instructions to identify the parts.

### SUGGESTED TOOLS

The following tool are suggested to complete the installation procedure:

- Sockets and Wrench
- General Hand Tools
- Jack Stands
- Second Person to Help

#### **WARNING**

**Failure to follow these instructions can result in property damage, personal injury or even death.**

- If raising the vehicle to install the anti-sway bar, always support the vehicle with jack stands at both frame rails or at the rear axle before working underneath. Ensure that the jack stands are securely positioned, and are rated at or above the weight of the vehicle.
- The installer must read the instructions and use all bolts and parts supplied. Use only the parts supplied by ROADMASTER to install this kit.
- Minor modifications are sometimes necessary due to slight vehicle variations, even for the same year, make and model.
- Regardless of year, make and model, a wide range of options for specific applications may or may not interfere with the installation. It is the installer's responsibility to make certain that equipment is not damaged once the suspension solution travels through the full range of motion. Failure to ensure adequate clearance could result in non-warranty property damage, personal injury or even death.

- If running changes were made by the manufacturer after this kit was designed, there may be weldments, braces, gussets, or other structural items which interfere with the installation. It is the installer's responsibility to allow for these running changes without sacrificing the structural integrity of the anti-sway bar. Failure to securely fasten the anti-sway bar could result in property damage, personal injury or even death.
- ROADMASTER will not be responsible for any damage or injury resulting from any modification or alteration.
- Check ALL the fasteners for tightness before and after road testing the vehicle.
- Do not use this document for custom fabrication, as it may not show all parts or structural components.
- Do not use an air impact wrench when re-installing bolts, as stripped threads may result.
- This anti-sway bar is only warranted for the original installation. Installing a used anti-sway bar on another vehicle is not recommended and will void the warranty.

# PARTS LIST

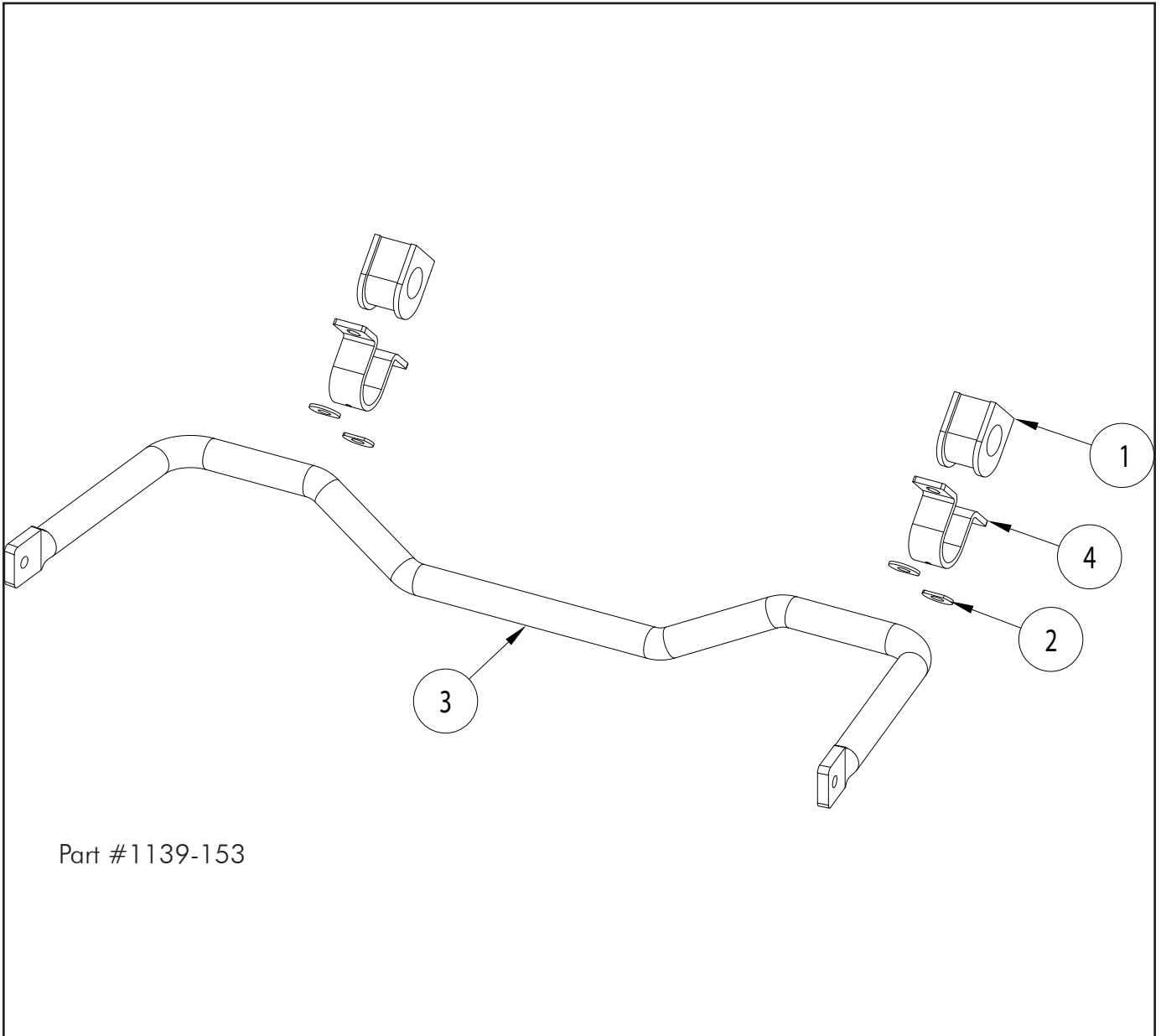

Part #1139-153

ITEM.....	QTY .....	DESCRIPTION .....	PART .....
1.....	2.....	BUSHING .....	205219-10
2.....	4.....	CLIPPED WASHER.....	350308-40
3.....	1.....	ANTI-SWAY BAR.....	580154-00
4.....	2.....	BUSHING CLAMP .....	B141
5.....	1.....	LOCTITE .....	200544-00
6.....	1.....	AQUALUBE .....	400011-30

# INSTALLATION

The following instructions must be followed in the order listed to ensure a proper installation and to preserve the **ROADMASTER** warranty.

Done with the vehicle on the ground

## 1. Remove factory anti-sway bar.

Undo the nut on each side attaching end links to ends of the anti-sway bar. Remove 2 clamps that hold the anti-sway bar to rear axle. Remove anti-sway bar from vehicle.

### **WARNING**

Removing the clamps will release the anti-sway bar. The anti-sway bar is heavy, and may cause property damage or personal injury if it falls on equipment, engine components or any part of your body. Ensure that the anti-sway bar is supported and that you are out of the way when removing the brackets. Failure to follow these instructions may cause property damage personal injury or even death.

2. Connect factory endlinks to bar and torque to factory specs (Figure 2).

3. Prepare for installation.

The anti-sway bar mounts to the forward side of the shock absorber mounts. Remove the lower shock mounting bolt, and position the shocks out of the way. Remove the 2 nuts on the shock mount. Lubricate the inside of the bushings with the provided grease and position them on the anti-sway bar aligned with the shock mounts. Install brackets over bushings (Figure 3).

4. Install anti-sway bar with dip in center going down (under axle). Lift bar into place (this is easier with 2 people). Secure using provided washers and factory nuts. Note: Make sure shock mount is aligned with locating pin on axle. Tighten to factory specifications. Reinstall lower shock mounting bolts (Figure 4).

5. Road test - Listen for noises.

6. Re-inspect installation and retighten if necessary.

### **WARNING**

After road testing, re-check all fasteners for proper tightness — if a fastener has worked loose or fallen off, re-tighten or replace it. Without all kit components properly tightened or in place, the anti-sway bar will not stabilize the vehicle at full capacity, which may cause reduced cornering ability or other reductions in vehicle handling or performance.

Failure to follow these instructions may result in property damage, personal injury or even death.

**Figure 2**



**Figure 3**

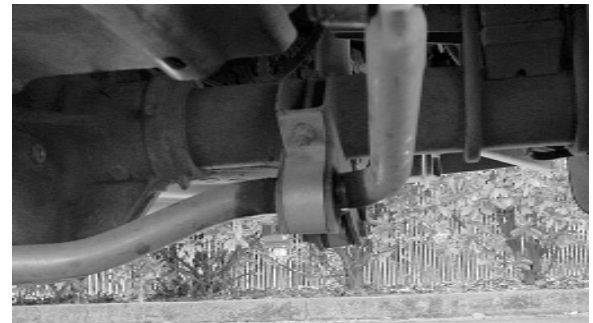

**Figure 4**

