



# Installation Instructions

Thank you for purchasing this anti-sway bar kit. Please read through these instructions before installation.

## Rear Anti-Sway Bar Kit for the Ford F350

part #1139-170  
1-3/8" diameter

**\* If a 4" lift kit is installed, you will need the 590045-00 endlink kit.**

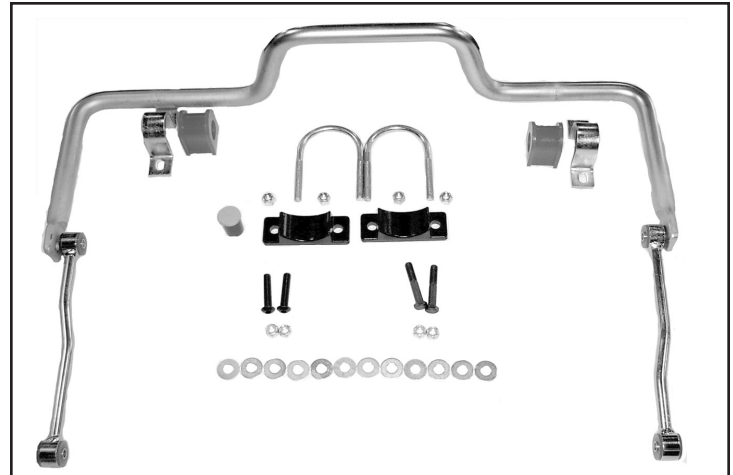

## INTRODUCTION

Thank you for purchasing this anti-sway bar kit. This kit is designed to improve the handling characteristics of your Ford F350 by reducing the body roll and balancing the weight transfer during cornering. The anti-sway bar kit is engineered for long life and trouble-free performance. For maximum suspension control, use this kit along with our front anti-sway bar kit.

All the hardware needed for installation is included in this kit. Refer to the PARTS LIST in these instructions to identify the parts.

## SUGGESTED TOOLS

The following tools are suggested to complete the installation procedures:

- General hand tools

### **WARNING**

**Failure to follow these instructions can result in property damage, personal injury or even death.**

- If raising the vehicle to install the anti-sway bar, always support the vehicle with jack stands at both frame rails or at the rear axle before working underneath. Ensure that the jack stands are securely positioned, and are rated at or above the weight of the vehicle.
- The installer must read the instructions and use all bolts and parts supplied. Use only the parts supplied by ROADMASTER to install this kit.
- Minor modifications are sometimes necessary due to slight vehicle variations, even for the same year, make and model.
- Regardless of year, make and model, a wide range of options for specific applications may or may not interfere with the installation. It is the installer's responsibility to make certain that equipment is not damaged once the suspension solution travels through the full range of motion. Failure to ensure adequate clearance could result in non-warranty property damage, personal injury or even death.

- If running changes were made by the manufacturer after this kit was designed, there may be weldments, braces, gussets, or other structural items which interfere with the installation. It is the installer's responsibility to allow for these running changes without sacrificing the structural integrity of the anti-sway bar. Failure to securely fasten the anti-sway bar could result in property damage, personal injury or even death.
- ROADMASTER will not be responsible for any damage or injury resulting from any modification or alteration.
- Check ALL the fasteners for tightness before and after road testing the vehicle.
- Do not use this document for custom fabrication, as it may not show all parts or structural components.
- Do not use an air impact wrench when re-installing bolts, as stripped threads may result.
- This anti-sway bar is only warranted for the original installation. Installing a used anti-sway bar on another vehicle is not recommended and will void the warranty.

# PARTS LIST

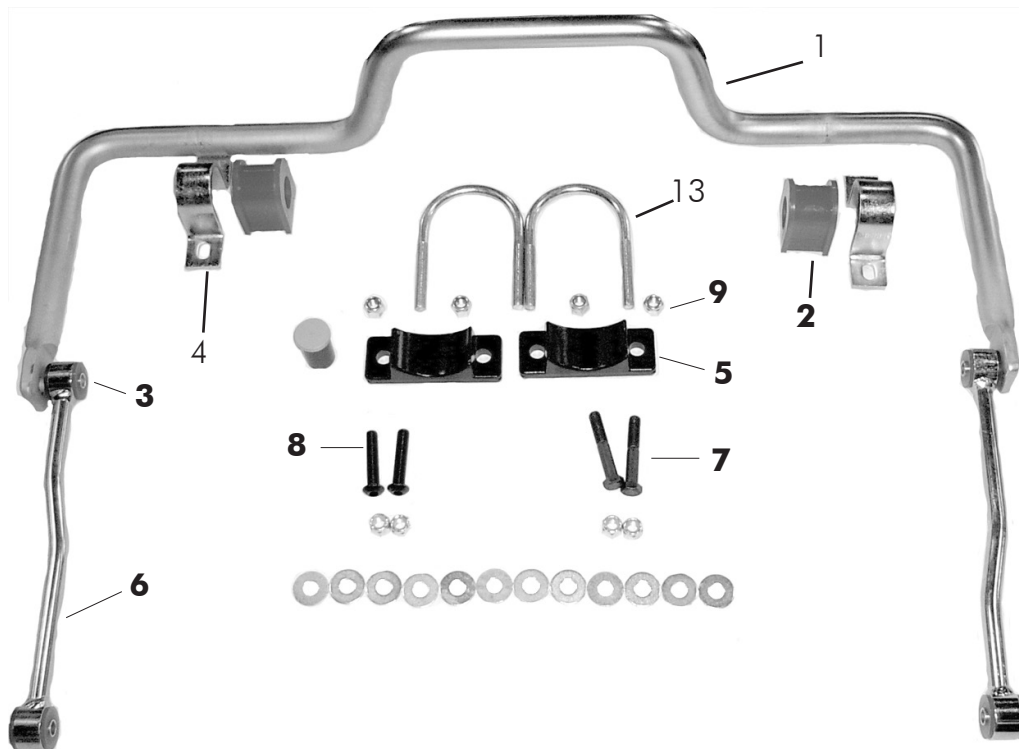

## Part #1139-170

Part #	Description	Qty	Part #	Description	Qty
1. 580061-00	Sway bar 1 -3/8"	1	8. 350099-80	Bolt, 1/2"	2
2. 205219-10	Bushing, split	2	9. 350259-01	Locknut 1/2"	4
3. 205223-00	Bushing, poly hat	8	10. 350259-00	Locknut 1/2"	4
4. B141	Bushing clamp	2	11. 205501-00	Sleeve	4
5. 480013	Axle bracket	2	12. 350308-00	1/2" Cut washer	12
6. B355	End link assembly	2	13. 357359-00	U-bolt 1/2"	2
7. 350101-80	Bolt, 1/2" x 3" NC	2	14. 400011-30	AQUALUBE Grease	1

# INSTALLATION

The following instructions must be followed in the order listed to ensure a proper installation and to preserve the ROADMASTER warranty.

1. Remove the factory anti-sway bar, if your vehicle is so equipped.

## WARNING

The anti-sway bar is heavy, and may cause property damage or personal injury if it falls on equipment, engine components or any part of your body. Ensure that the anti-sway bar is supported and that you are out of the way when removing the brackets.

Failure to follow these instructions may cause property damage, personal injury or even death.

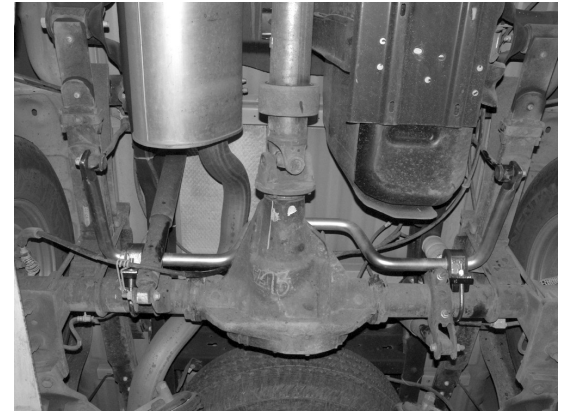

Figure 1

2. Install the U-bolts and the axle brackets to the axle tube.

Gently pry the brake line away from the axle tube to allow clearance for the U-bolts. Install the U-bolts and axle brackets. HINT: two large rubber bands, stretched over the axle tube, are helpful in holding the axle clamps together while the sway bar is being installed (Figure 1, 2).

## WARNING

The brake line will need to be pried away from the axle tubes. DO NOT clamp over the brake line. Also DO NOT kink brake line. If brake line is clamped, or kinked, the vehicle brakes may fail. Failure to follow these instructions can result in property damage, personal injury or even death.

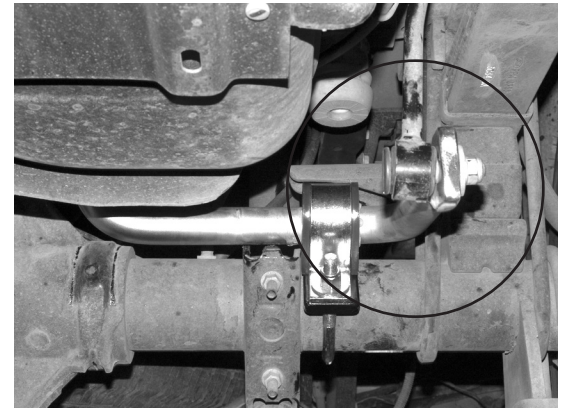

Figure 2

3. Attach the split bushings over the anti-sway bar.

Using the lubricant provided, grease the inside of the split bushings (Figure 3). Place the bushings onto the center section of the anti-sway bar. Push the large-size bushing clamp over the bushings.

4. With the bar under the vehicle, lift the center section into place.

Align the bushings and u-brackets with the u-bolt/bracket assembly on the axle tube. Lift the anti-sway bar into position (Figure 1, 2).

5. Screw the 1/2" locknuts onto the u-bolts.

Put washers and fine thread locknuts onto u-bolts and thread them up. DO NOT tighten locknuts at this time.

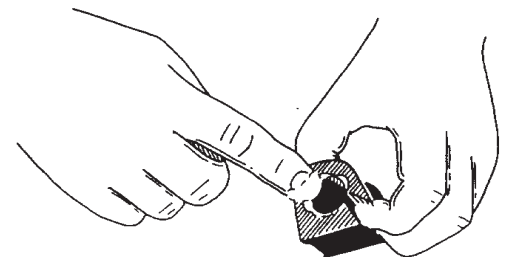

Figure 3

# INSTALLATION

## 6. Connect end link to bar.

Assemble the poly hat bushings, sleeves, and washers (Figure 4). Attach the endlinks to the inside of the bar (Figure 3). Using longer bolts, assemble the lower link bolts finger tight for now. *Note:* the longer bolts go on the anti-sway bar endlinks, while the shorter bolts go on top through the frame rail.

## 7. Mount the endlink to the frame rail using the hole in Figure 5.

Assemble the link, referring to Figure 4 for the proper order. Mount the end link to the frame using shorter bolt washers on the outside of the end link. Use a washer on the inside of the frame rail. Secure in place using the provided nut. Tighten the upper and lower link bolts to 45-55 ft.-lbs. Tighten the u-bolt nuts to 70 ft.lbs.

## 8. After road testing, re-check all fasteners for proper tightness.

### **WARNING**

After road testing, re-check all fasteners for proper tightness — if a fastener has worked loose or fallen off, re-tighten or replace it. Without all kit components properly tightened or in place, the anti-sway bar will not stabilize the vehicle at full capacity, which may cause reduced cornering ability or other reductions in vehicle handling or performance.

Failure to follow these instructions may result in property damage, personal injury or even death.

### **WARNING**

#### **The anti-sway bar is not a load-bearing component**

Do not tow or hoist the vehicle using the anti-sway bar or its mounting brackets as attachment points. The anti-sway bar is not designed to carry the weight of the vehicle and may collapse, which will damage the anti-sway bar components, the suspension, or other components. The vehicle will detach or fall, which may cause severe personal injury.

Failure to follow these instructions may result in property damage, personal injury or even death.

**Figure 4**



**Figure 5**

