



# BASEPLATE KIT INSTALLATION INSTRUCTIONS

**KIT# 1163-1**

07/19/04

ROADMASTER, Inc. 6110 NE 127th Ave. Vancouver, WA 98682 360-896-0407 fax 360-735-9300 www.roadmasterinc.com

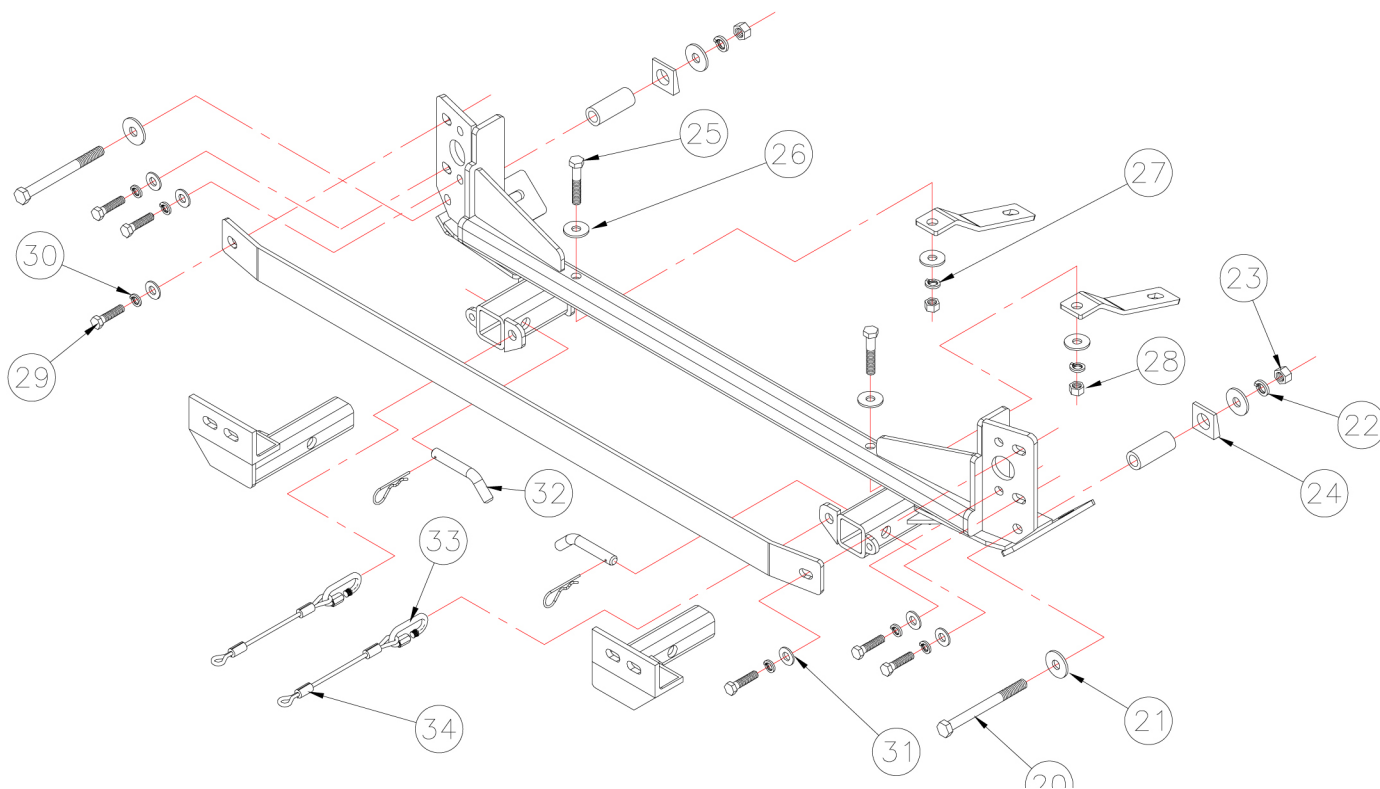

Item	Qty	Length	Width	Hardware	Part No.
20	2	6 1/2"	1/2"	1/2" x 6 1/2" BOLT	350110-00
21	4		1/2"	1/2" FLAT WASHER	350308-00
22	2		1/2"	LOCK WASHER	350309-00
23	2		1/2"	1/2" NUT	350258-00
24	2		3/4"	3/4" BEVELED WASHER	350349-00
25	2	2 1/4"	7/16"	7/16" x 2 1/4" BOLT	350079-00
26	4		7/16"	7/16" FLAT WASHER	350306-00
27	2		7/16"	7/16" LOCK WASHER	350307-00
28	2		7/16"	7/16" NUT	350256-00
29	6	35mm	10mm	10mm x 1.25 x 35mm BOLT	356202-00
30	6		10mm	10mm LOCK WASHER	355715-00
31	6		10mm	10mm FLAT WASHER	355710-00
32	2			DRAW PIN/SPRING PIN	357035-00
33	2			CABLE CONNECTOR	200008-00
34	2	8"		SAFETY CABLE	500646-08

ROADMASTER, INC.



# BASEPLATE KIT INSTALLATION INSTRUCTIONS

**KIT# 1163-1**

07/19/04

ROADMASTER, Inc. 6110 NE 127th Ave. Vancouver, WA 98682 360-896-0407 fax 360-735-9300 www.roadmasterinc.com

ROADMASTER, INC.

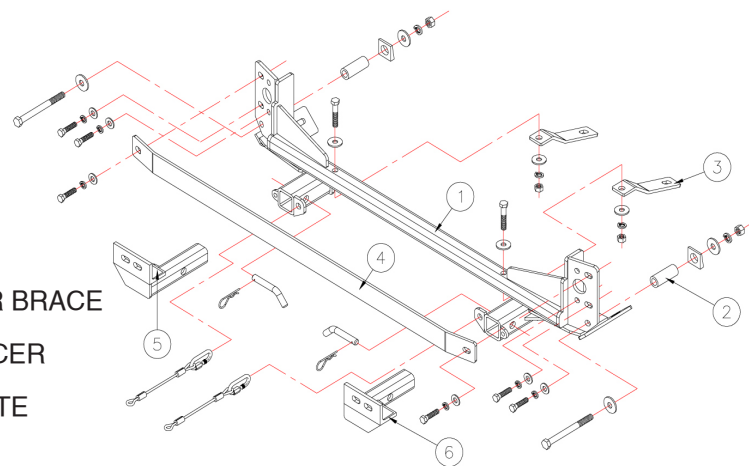

Item	Qty	Part No.	Assembly
1	1	C-000212	MAIN RECEIVER BRACE
2	2	A-000082	2 1/2" PIPE SPACER
3	2	B-000168	MOUNTING PLATE
4	1	B-000188	CROSS BAR
5	1	C-000214	PASSENGER SIDE ARM BRACE WELDMENT
6	1	C-000213	DRIVER SIDE ARM BRACE WELDMENT

**IMPORTANT:** All baseplates *must* be assembled with all the bolts left loose for final adjustment and positioning (before tightening) unless otherwise instructed. All bolts *must* be torqued for proper strength. If more than one bolt is used per fastening point, the diagram may only show one.

- Use flat washers over all slotted holes
- Use lock washers on all fasteners

## WARNING

Failure to follow the below warnings and the installation instructions may result in voiding your warranty, property damage, the loss of your towed vehicle, personal injury or even death.

- We strongly recommend professional installation.
- The installer must read the instructions and use all bolts and parts supplied.
- Use Loctite® Red on all bolts used to secure this baseplate. Torque all bolts to the specifications found at the end of these instructions. Do not over-torque the bolts or failure may occur.
- Every 3,000 miles, the owner must inspect the fasteners for proper torque, according to the bolt torque requirements chart on the last page of these instructions. The owner must also inspect all mounting points for cracks or other signs of fatigue every 3,000 miles.
- The owner must check the vehicle manufacturer's instructions for the proper procedure(s) to prepare the vehicle for towing. Some vehicles must be equipped with a transmission lube pump, an axle disconnect, driveline disconnect or free-wheeling hubs before they can be towed. Failure to properly equip the vehicle will cause severe damage to the transmission.
- Do not weld. This baseplate is designed to be bolted to the vehicle. Welding will void the warranty.
- Do not use this document for custom fabrication, as it may not show all parts or structural components could result in loss of the towed vehicle.
- If the towed vehicle has been in an accident, it must be properly repaired before attaching the baseplate. Do not install the baseplate if any structural frame damage is found.
- If running changes were made by the vehicle manufacturer after this kit was designed, some bolts or other fasteners in the hardware pack may no longer be the correct size. It is the installer's responsibility to verify this kit is securely fastened to the vehicle and fitted with the correct hardware to account for these changes.
- Roadmaster manufactures many styles of baseplates. If your baseplate has removable arms, they must be removed before driving the vehicle, unless the arms can be pinned or padlocked in place. If not secured, the arms could vibrate out.
- Some motorhome chassis have such a tight turning radius that you can damage your motorhome, towed vehicle, tow bar or baseplate while turning sharply. Before getting on the road, test your turning radius in an empty parking lot. Turning too sharply could result in non-warranty damage to towing system, motorhome and/or towed vehicle.
- Do not back up with the towed vehicle attached or non-warranty damage will occur to your towing system, motorhome and/or towed vehicle.
- The safety cables must connect the towing vehicle to the towed vehicle frame to frame, with the cables crossed, with enough slack for sharp turns. Refer to the cable instructions for proper routing. Failure to leave enough slack in the safety cables, or failure to connect the safety cables frame to frame, will result in the loss of the towed vehicle.
- This kit is designed for use with ROADMASTER tow bars and ROADMASTER adapters only. Using this kit with other brands, without an approved ROADMASTER adapter, may result in non-warranty damage or injury.
- Upon final installation, the installer must inspect the baseplate to ensure adequate clearance, particularly around hoses, air conditioner lines, radiators, etc.
- This baseplate is only warranted for the original installation. Installing a used baseplate on another vehicle is not recommended and will void the warranty.



# BASEPLATE KIT INSTALLATION INSTRUCTIONS

**KIT# 1163-1**

07/19/04

ROADMASTER, Inc. 6110 NE 127th Ave. Vancouver, WA 98682 360-896-0407 fax 360-735-9300 www.roadmasterinc.com

1. This is one of our XL bracket series, which allows the visible front portion of the brackets to be easily removed from the front of the vehicle. The bracket kit consists of a main receiver brace, two front braces and a hardware pack. The rear receiver brace mounts to the front and bottom of the frame and protrude through the lower grill below the bumper. The front braces insert into the rear receiver tubes and are pinned in place. The lower bumper fascia will have to be trimmed slightly to fit around the rear portion of the main receiver braces. The bumper core will be replaced with the receiver brace and the lower splash shield will be removed then reinstalled. Before starting the installation, lay out the kit components as it is illustrated. This will give you a visual idea of how the components work and also confirm that everything is present and accounted for.
2. **Important: please use all supplied bolts and parts and read all instructions carefully before beginning this installation. The majority of questions you may have can be answered within the text, and proper installation will ensure safe and secure travel.** Now, begin the installation by removing the lower center gravel guard (10 fasteners). This will provide access to the sub frame mounting area.
3. Remove the front fascia, starting with two screws in the fender wells (Note: Later models have two plastic fasteners in the fender wells and a additional screw behind the grille.) then four plastic fasteners on the top between the headlights. Once all the fasteners are out, squeeze and push out a square plastic clip fastener for the grille located between the headlight housing and the radiator support frame on each side. Note: The battery may have to be loosened and pushed to the side to gain access on the driver's side.
4. Pull forward on the fascia and remove the fog light connectors on each side, then set aside. Now, remove the Styrofoam bumper core facing.
5. Remove three bumper bolts on each side then remove the bumper core. *Note:* the bumper core and foam will not be reinstalled.
6. Locate and remove two suspension bolts per side (14mm head).
7. Each side has a alignment stud for the bumper core. Cut these studs flush with the bumper core mounting area.
8. Mount the main receiver brace in place of the bumper core with two of the supplied 10mm x 1.25 x 35mm bolts, flat washers and lock washers per side. Leave the top mounting holes open for now. Align the receiver brace with the side mounting plates sandwiched between the frame and the suspension brace on each side.
9. Hold the cross brace in position over the remaining upper mounting hole on each side and bolt through it and the receiver brace with two more 10mm x 1.25 x 35 mm bolts, lock washers and flat washers.
10. Bolt the lower braces (one on each side) to the receiver brace with 7/16" x 2 1/4" bolts, flat washers, lock washers and nuts. Sandwich the end of the lower braces between the suspension frames and the frame then bolt in position using bolts removed in step 6.
11. Using the front lower mounting holes as a drill guide, drill one 17/32" hole through the lower front frame.
12. Bolt through the main receiver brace on each side with two 1/2" x 6 1/2" bolts, pipe spacers, beveled washers, (use beveled washers behind the frame under the flat washers) flat washers, lock washers and nuts. Be sure to insert the pipe spacers between the receiver brace and the frame. Tighten these bolts to 50-ft. lbs.
13. Tighten all mounting bolts to the torque specifications below.
14. Reinstall the fascia, reversing steps 3 and 4. Two bottom fastener holes will be secured to the splash panels with the included nylon cable ties. *Note:* 04 and later vehicles will require trimming the outer grille openings to fit the receivers.
15. Reinstall the bottom splash shield-reversing step 2.
16. Install the front braces by inserting and pinning with 5/8" draw pins and 3/16" spring pins.
17. Replace the lower splash shields on each side.



# BASEPLATE KIT INSTALLATION INSTRUCTIONS

**KIT# 1163-1**

07/19/04

ROADMASTER, Inc. 6110 NE 127th Ave. Vancouver, WA 98682 360-896-0407 fax 360-735-9300 www.roadmasterinc.com

- Mount the tow bar following the manufacturer's instructions then attach one end of the 8" safety cables to the receiver brace with the included cable connectors, attach the other end to the tow vehicle's safety cables and the tow bar.

## BOLT TORQUE REQUIREMENTS

Note: The torque values represented below are intended as general guidelines. Torque requirements for specific applications may vary. Roadmaster does not warrant this information to be accurate for all applications and disclaims all liability for any claims or damages which may result from its use.

STANDARD BOLTS			METRIC BOLTS			METRIC BOLTS		
Thread Size	Grade	Torque	Thread Size	Grade	Plated / Unplated	Thread Size	Grade	Plated / Unplated
5/16.....	5.....	13 ft./lb.	8mm-1.0 .....	8.8 .....	20 ft./lb. 18 ft./lb.	12mm-1.25 .....	8.8 .....	70 ft./lb. 65 ft./lb.
3/8.....	5.....	23 ft./lb.	8mm-1.25 .....	8.8 .....	19 ft./lb. 18 ft./lb.	12mm-1.5 .....	8.8 .....	66 ft./lb. 61 ft./lb.
7/16.....	5.....	37 ft./lb.	10mm-1.25 .....	8.8 .....	38 ft./lb. 36 ft./lb.	12mm-1.75 .....	8.8 .....	65 ft./lb. 60 ft./lb.
1/2.....	5.....	56 ft./lb.	10mm-1.5 .....	8.8 .....	37 ft./lb. 35 ft./lb.	14mm-2.0 .....	8.8 .....	104 ft./lb. 97 ft./lb.
5/8.....	5.....	150 ft./lb.						

All illustrations and specifications contained herein are based on the latest information available at the time of publication approval. ROADMASTER, INC. reserves the right to make changes at any time without notice in material, specification and models or to discontinue models.

ROADMASTER, INC.