

# BASEPLATE KIT INSTALLATION INSTRUCTIONS

ROADMASTER, Inc. 6110 NE 127th Ave. Vancouver, WA 98682 360-896-0407 fax 360-735-9300 www.roadmasterinc.com

**KIT NO. 246-6**

## PARTS LIST:

- 1- FRONT BRACE (A) - Passenger side C001874
- 1- FRONT BRACE (B) - Driver's side C001873
- 1- MAIN RECEIVER BRACE (C) -
- 1- REAR MOUNTING BRACE (D) - Passenger side
- 1- REAR MOUNTING BRACE (E) - Driver's side

## Important

Note: this bracket will not accommodate the Guardian rock shield, some models of the Tow Defender, Stowaway or the StowMaster and StowMaster All Terrain tow bars.

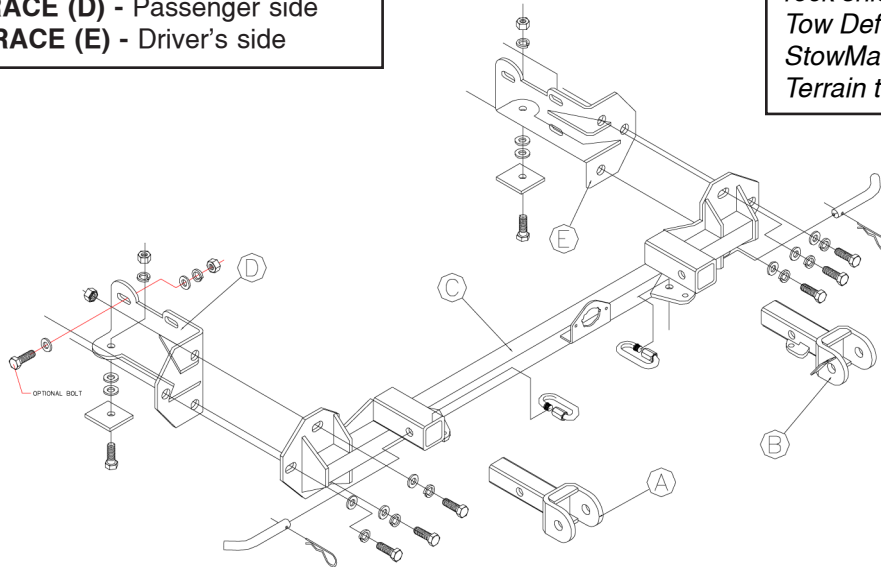

08-17-09

**IMPORTANT:** All baseplates **must** be assembled with all the bolts left loose for final adjustment and positioning (before tightening) unless otherwise instructed. All bolts **must** be torqued for proper strength. If more than one bolt is used per fastening point, the diagram may only show one. Use flat washers over all slotted holes and lock washers on all fasteners.

## WARNING

Failure to heed these warnings or follow the installation instructions may result in a voided warranty, loss of towed vehicle, personal injury or death.

- Do not weld or modify this baseplate or its components. Welding or modification will void the warranty.
- Do not use this document as a basis to design/fabricate a baseplate, as it may not show all parts or structural components.
- We strongly recommend professional installation.
- If the towed vehicle has been in an accident, it must be properly repaired before attaching the baseplate. Do not install the baseplate if any structural frame damage is found.
- The installer must use all bolts and parts supplied. If running changes were made by the vehicle manufacturer after this kit was designed, some bolts or other fasteners may no longer be the correct size. It is the installer's responsibility to verify this kit is securely fastened to the vehicle.
- Use Loctite® Red on all bolts used to secure this baseplate. Torque all bolts to the specifications found at the end of these instructions. Do not over-torque the bolts or failure may occur.
- The installer must inspect the baseplate to ensure adequate clearance, particularly around hoses, air conditioner lines, radiators, etc. or non-warranty failure may result.
- Roadmaster manufactures many styles of baseplates. If your baseplate has removable arms, they must be removed before driving the vehicle, unless the arms can be pinned or padlocked in place. If not secured, the arms could vibrate out.
- Some motorhome chassis have such a tight turning radius that you can damage your motorhome, towed vehicle, tow bar or baseplate while turning sharply. Before getting on the road, test your turning radius in

an empty parking lot. Turning too sharply could result in non-warranty damage to your towing system, motorhome and/or towed vehicle.

- Do not back up with the towed vehicle attached or non-warranty damage will occur to your towing system or vehicles.
- The safety cables must connect the towing vehicle to the towed vehicle frame to frame, with the cables crossed, with enough slack for sharp turns. See cable instructions for proper routing. Failure to do so will result in non-warranty damage and/or the loss of the towed vehicle.
- This kit is designed for use with ROADMASTER tow bars and ROADMASTER adapters only. Using this kit with other brands, without an approved ROADMASTER adapter, may result in non-warranty damage or injury.
- Receiver extensions and out-of-level towing situations of 3 inches or more. This can cause the system to swing much higher and lower, causing excessive strain on the tow bar, baseplate and frame. That can cause the towing system to fail, causing property damage, personal injury or even death. If you must use a receiver extension or drop hitch to tow, it will reduce your receiver's weight capacity by 1/3 to avoid damaging your system. Never use more than one extension and/or drop hitch, as this will void your warranty.
- Every 3,000 miles, the owner must inspect all mounting points for cracks or fatigue, and check the fasteners for proper torque, according to the bolt torque requirements chart on the last page of these instructions.
- The owner must follow the vehicle manufacturer's instructions to prepare the vehicle for towing. Failure to do so may cause severe damage to the vehicle.
- This baseplate is only warranted for the original installation. Installing a used baseplate on another vehicle is not recommended and will void the warranty.

# BASEPLATE KIT INSTALLATION INSTRUCTIONS

ROADMASTER, Inc. 6110 NE 127th Ave. Vancouver, WA 98682 360-896-0407 fax 360-735-9300 www.roadmasterinc.com

## KIT NO. 246-6

1. **Important:** please use all supplied bolts and parts and read all instructions carefully before beginning this installation. The majority of questions you may have can be answered within the text, and proper installation will ensure safe and secure travel. Now, begin the installation. This bracket kit is one of our **MX Series** brackets. The kit consists of two rear mounting braces which mount inside the front frame tubes, a main receiver brace and the removable front braces. Everything but the front braces install behind the bumper. The front bumper will have to be removed for the installation.
2. Remove four bolts, two on the top of each frame tube. Now, remove two bolts on the bumper side braces on each side. These are located on the sides of the frame tubes.
3. Use two screw drivers to pop the plastic fasteners loose on the radiator flap and pull free.
4. Mark the frame where the bumper brackets are located so that the bumper can be repositioned to the same spot. Remove the shoulder nuts inside each frame tube holding the bumper brackets. This is where the new rear braces will be mounted.
5. Insert the rear brace into the front of each frame tube over the bumper bracket mounting bolts. The bracket will have to be pushed partly out to allow this. *Note:* the rear braces are slotted to move forward if necessary to clear oil coolers on vehicles with heavy duty towing packages. If the vehicle needs additional clearance the front bumper mounts will also have to be notched for clearance.
6. Align the bumper brace where previously positioned and reinstall the shoulder bolts over the rear braces and tighten. Some models will only have two shoulder bolts on the passenger side bumper bracket. If so, use the supplied 1/2" x 1 1/4" bolt, lock washer, two flat washers, and nut in remaining hole on bracket. A small clip-nut may need to be removed from the existing hole to complete the step.
7. Now, check the rear of the brace and notice the lower mounting tabs. Line a backing plate up with the front of the mounting tab. Mark the center of the hole then drill up through the frame and the mounting tab inside with a 17/32" drill bit.
8. Now, use the supplied flat washers to shim as needed between the frame and the bottom of the rear brace, then bolt through with a 1/2" x 1 3/4" bolt, lock washer, and nut.
9. Torque these bolts to the torque specifications below.
10. Take the receiver brace and position in front of the braces with the receiver tubes on top of the cross tube.

8-17-09

### BOLT TORQUE REQUIREMENTS

Note: The torque values represented below are intended as general guidelines. Torque requirements for specific applications may vary. Roadmaster does not warrant this information to be accurate for all applications and disclaims all liability for any claims or damages which may result from its use.

STANDARD BOLTS			METRIC BOLTS			METRIC BOLTS		
Thread Size	Grade	Torque	Thread Size	Grade	Plated / Unplated	Thread Size	Grade	Plated / Unplated
5/16.....	5.....	13 ft./lb.	8mm-1.0.....	8.8.....	20 ft./lb. 18 ft./lb.	12mm-1.25.....	8.8.....	70 ft./lb. 65 ft./lb.
3/8.....	5.....	23 ft./lb.	8mm-1.25.....	8.8.....	19 ft./lb. 18 ft./lb.	12mm-1.5.....	8.8.....	66 ft./lb. 61 ft./lb.
7/16.....	5.....	37 ft./lb.	10mm-1.25.....	8.8.....	38 ft./lb. 36 ft./lb.	12mm-1.75.....	8.8.....	65 ft./lb. 60 ft./lb.
1/2.....	5.....	56 ft./lb.	10mm-1.5.....	8.8.....	37 ft./lb. 35 ft./lb.	14mm-2.0.....	8.8.....	104 ft./lb. 97 ft./lb.
5/8.....	5.....	150 ft./lb.						

All illustrations and specifications contained herein are based on the latest information available at the time of publication approval.  
ROADMASTER, INC. reserves the right to make changes at any time without notice in material, specification and models or to discontinue models.

# BASEPLATE KIT INSTALLATION INSTRUCTIONS

ROADMASTER, Inc. 6110 NE 127th Ave. Vancouver, WA 98682 360-896-0407 fax 360-735-9300 www.roadmasterinc.com

Continued from last page

**KIT NO. 246-6**

11. Bolt the receiver brace to the side braces with three 1/2" x 1 1/2" bolts, flat washers, and lock washers per side. Torque to the specifications listed below.
12. Remove the side braces from the bumper. This will allow you to slide the bumper over the braces. *Note:* if additional clearance in step 5 was needed, the lower back side of the bumper fascia will need to be trimmed for proper fit around the receivers.
13. Bolt the four top bumper bolts back in place, then reinstall the side brackets and finish bolting in place.
14. Reinstall the bottom plastic fasteners in the rubber bumper deflector.
15. Insert the front braces and pin with 5/8" draw pins and safety pins
16. Install the tow bar according to the manufacturer's instructions.
17. Attach the safety cables to the main receiver brace.

**Hardware:**

- 6- 1/2" x 1-1/2" bolts
- 2- 1/2" x 1-3/4" bolts
- 9- 1/2" lock washers
- 12-1/2" flat washers
- 3- 1/2" nuts
- 2- 1/4" x 2-3/8" x 2-1/2" backing plates
- 2- 5/8" draw pins
- 2- 1/8" spring pins
- 2- cable connectors
- 1- 1/2" x 1 1/4" bolt

**8-17-09**

**BOLT TORQUE REQUIREMENTS**

Note: The torque values represented below are intended as general guidelines. Torque requirements for specific applications may vary. Roadmaster does not warrant this information to be accurate for all applications and disclaims all liability for any claims or damages which may result from its use.

STANDARD BOLTS			METRIC BOLTS			METRIC BOLTS		
Thread Size	Grade	Torque	Thread Size	Grade	Plated / Unplated	Thread Size	Grade	Plated / Unplated
5/16.....	5.....	13 ft./lb.	8mm-1.0 .....	8.8 .....	20 ft./lb. 18 ft./lb.	12mm-1.25 .....	8.8 .....	70 ft./lb. 65 ft./lb.
3/8.....	5.....	23 ft./lb.	8mm-1.25 .....	8.8 .....	19 ft./lb. 18 ft./lb.	12mm-1.5 .....	8.8 .....	66 ft./lb. 61 ft./lb.
7/16.....	5.....	37 ft./lb.	10mm-1.25 .....	8.8 .....	38 ft./lb. 36 ft./lb.	12mm-1.75 .....	8.8 .....	65 ft./lb. 60 ft./lb.
1/2.....	5.....	56 ft./lb.	10mm-1.5 .....	8.8 .....	37 ft./lb. 35 ft./lb.	14mm-2.0 .....	8.8 .....	104 ft./lb. 97 ft./lb.
5/8.....	5.....	150 ft./lb.						

All illustrations and specifications contained herein are based on the latest information available at the time of publication approval.  
ROADMASTER, INC. reserves the right to make changes at any time without notice in material, specification and models or to discontinue models.