



BASEPLATE KIT INSTALLATION INSTRUCTIONS

KIT# 277-1

03/07/10
KS

ROADMASTER, Inc. 6110 NE 127th Ave. Vancouver, WA 98682 1-800-669-9690 fax 360-735-9300 www.roadmasterinc.com

Important
Note: this bracket will not accommodate the Guardian rock shield, Stowaway or the StowMaster and StowMaster All Terrain tow bars.

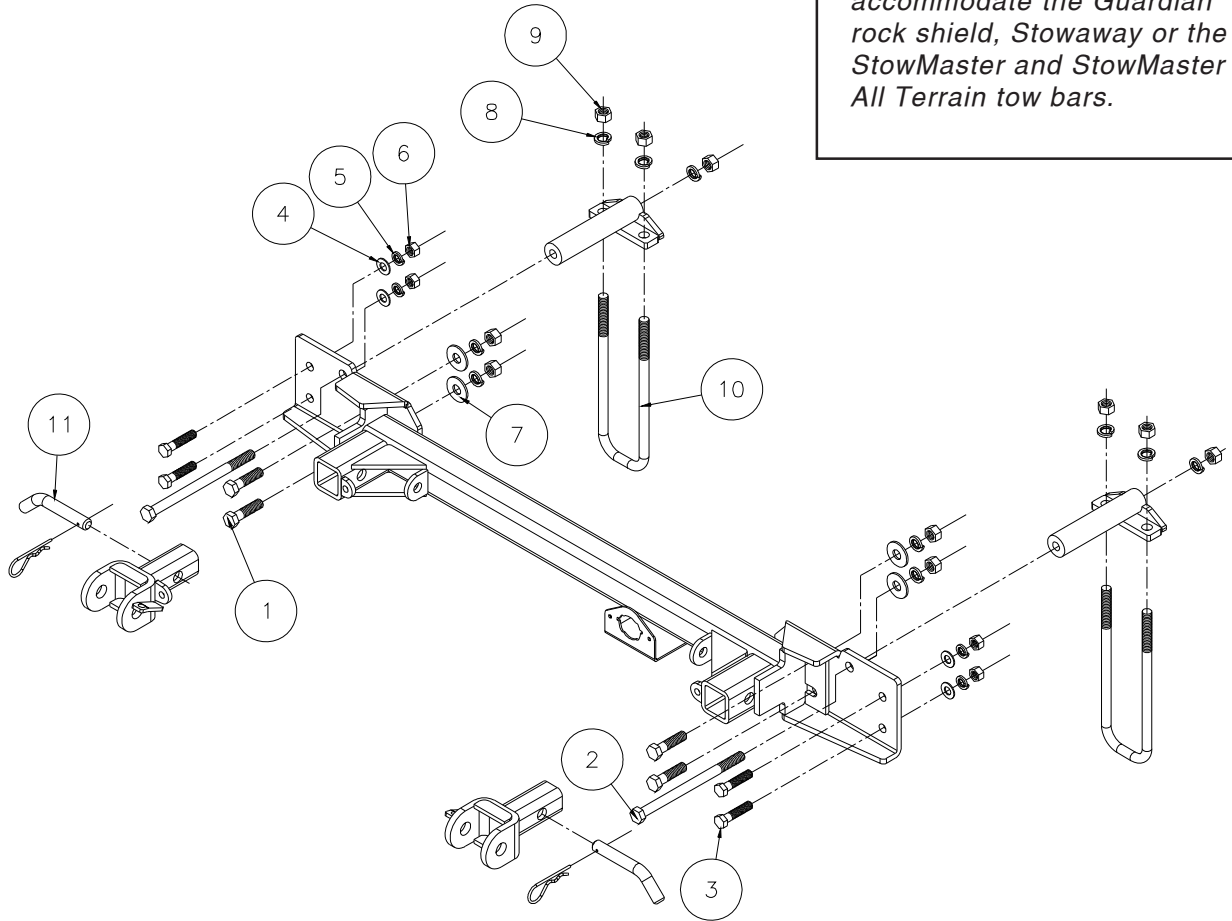

Item	Qty.	Length	Width	Description	Part #
1	4	2"	1/2"	BOLT	350097-00
2	2	7 1/2"	1/2"	BOLT	350112-00
3	4	1 1/2"	7/16"	BOLT	350074-00
4	4		7/16"	FLAT WASHER	350306-00
5	4		7/16"	LOCK WASHER	350307-00
6	4		7/16"	NUT	350256-00
7	4		1/2"	FLAT WASHER	350308-00
8	10		1/2"	LOCK WASHER	350309-00
9	10		1/2"	NUT	350258-00
10	2	9 1/2"	3"	1/2" x 3" O.C. x 9 1/2" U-BOLT	357301-00
11	2			DRAW PIN/SPRING PIN	357035-00

ROADMASTER, INC.



BASEPLATE KIT INSTALLATION INSTRUCTIONS

KIT# 277-1

03/07/10
KS

ROADMASTER, Inc.

6110 NE 127th Ave.

Vancouver, WA 98682

1-800-669-9690

www.roadmasterinc.com

IMPORTANT: All brackets **must** be assembled with all the bolts left loose for final adjustment & positioning (before tightening) unless otherwise instructed. All bolts **must** be torqued for proper strength. If more than one bolt is used per fastening point, the diagram may only show one.

- Use flat washers over all slotted holes
- Use lock washers on all fasteners

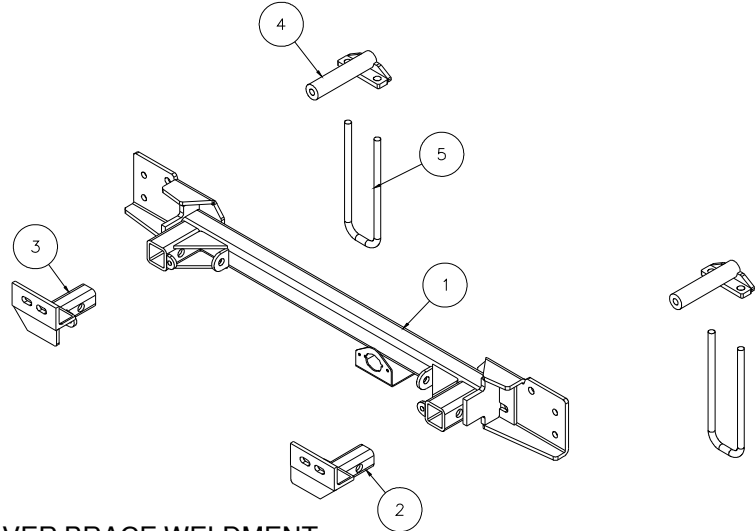

Item	Qty.	Part #	Assembly
1	1	C-001124	MAIN RECEIVER BRACE WELDMENT
2	1	C-001125	DRIVER SIDE ARM BRACE WELDMENT
3	1	C-001126	PASSENGER SIDE ARM BRACE WELDMENT
4	2	C-000519	REAR SUPPORT BRACE WELDMENT
5	2	357301-00	2 1/2" X 9 1/2" U-BOLT

WARNING

Failure to follow these instructions can result in property damage, personal injury or even death.

- **Installation of most mounting brackets requires moderate mechanical aptitude and skills.** We strongly recommend professional installation by an experienced installer.
- **The installer must read the instructions and use all bolts and parts supplied.** When the instructions require the reuse of factory bolts, thread lock and/or lock washers must also be used. Failure to securely fasten the bracket could result in loss of the towed vehicle.
- **Do not use this document for custom fabrication,** as it may not show all parts or structural components. Custom fabrication or an attempt to copy this bracket design could result in loss of the towed vehicle.
- **Every 3,000 miles, the owner must inspect the fasteners** for proper torque, according to the bolt torque requirements chart on the last page of these instructions. **The owner must also inspect all mounts and brackets for cracks or other signs of fatigue every 3,000 miles.** Failure to do so could result in loss of the towed vehicle.
- **The owner must check the vehicle manufacturer's instructions for the proper procedure(s) to prepare the vehicle for towing.** Some vehicles must be equipped with a transmission lube pump, an axle disconnect, driveline disconnect or free-wheeling hubs before they can be towed. Failure to properly equip the vehicle will cause severe damage to the transmission.
- **If running changes were made** by the vehicle manufacturer after this bracket was designed, some bolts or other fasteners in the hardware pack may no longer be the correct size. **It is the installer's responsibility** to verify that the bracket is securely fastened to the vehicle and fitted with the correct hardware to account for these changes. Failure to

- securely fasten the bracket could result in loss of the towed vehicle.
- If the towed vehicle has been in an accident, it must be properly repaired before attaching the bracket. **Do not install the bracket if any structural frame damage is found.** Failure to repair the damage could result in the loss of the towed vehicle.
- Some motorhome chassis have such a tight turning radius that you can damage your motorhome, towed vehicle, tow bar or bracket while turning sharply. **Before getting on the road, test your turning radius in an empty parking lot.** Turning too sharply could result in non-warranty damage to towing system, motorhome and/or towed vehicle.
- **Do not back up with the towed vehicle attached** or non-warranty damage will occur to your towing system, motorhome and/or towed vehicle.
- **The safety cables must connect the towing vehicle to the towed vehicle frame to frame, with the cables crossed, with enough slack for sharp turns.** Refer to the cable instructions for proper routing. Failure to leave enough slack in the safety cables, or failure to connect the safety cables frame to frame, will result in the loss of the towed vehicle.
- This bracket is designed for use with ROADMASTER tow bars and ROADMASTER adaptors only. **Using this bracket with other brands, without an approved ROADMASTER adaptor, may result in non-warranty damage or injury.**
- Upon final installation, **the installer must inspect the bracket to ensure adequate clearance, particularly around hoses, air conditioner lines, radiators, etc.,** or non-warranty damage to the towed vehicle will result.
- **This bracket is only warranted for the original installation.** Installing a used bracket on another vehicle is not recommended and will void the warranty.



BASEPLATE KIT INSTALLATION INSTRUCTIONS

KIT# 277-1

03/07/10
KS

ROADMASTER, Inc. 6110 NE 127th Ave. Vancouver, WA 98682 1-800-669-9690 fax 360-735-9300 www.roadmasterinc.com

1. This is one of our MX series brackets, which allows the visible front portion of the brackets to be easily removed from the front of the vehicle (Fig.A and Fig.B). The bracket consists of a front receiver brace, two rear braces, two removable front bracket arms, and a hardware pack.

Before starting the installation, lay out the kit components in order, starting with step 2. This will give you a visual idea of how the components work, and will also confirm that everything is present and accounted for.

2. Important: please use all supplied bolts and parts and read all instructions carefully before beginning this installation. The majority of questions you may have can be answered within the text, and proper installation will ensure safe and secure travel. Now, begin the installation. **For 2010 Dodge RAM 2500 and 3500 models:** see the supplemental instructions at the end of this document for direction on how to remove the grille and bumper.



3. Start by removing the front bumper. Remove the six bolts attaching the bumper to the vehicle, two on top and four on the bottom. *Note:* before removing the bumper, unplug the fog lamps, if the vehicle is so equipped.

4. Next, remove the tow hooks on each side by removing the four bolts that attach each tow hook to the end of the frame (Fig.C).

5. Once the tow hooks are removed, hold the front receiver brace against both ends of the frame, aligning the holes at each end of the brace with the tow hook bolt holes in the frame. Bolt the brace in place, using the supplied washers and nuts. The inside holes at each side require $\frac{1}{2}$ " x 2" bolts, while the outside holes take $\frac{7}{16}$ " x $1\frac{1}{2}$ " bolts. *Note:* the existing holes may have to be enlarged. Tighten the bolts to the torque specifications found at the end of these instructions.

6. Once the brace is in position, use the remaining two holes (one on the top on each side) as templates and drill through the end of the frame, using a $\frac{17}{32}$ " drill bit (Fig.D).

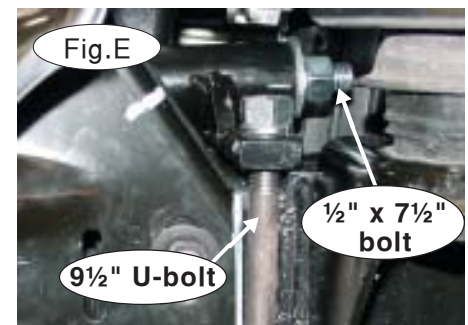
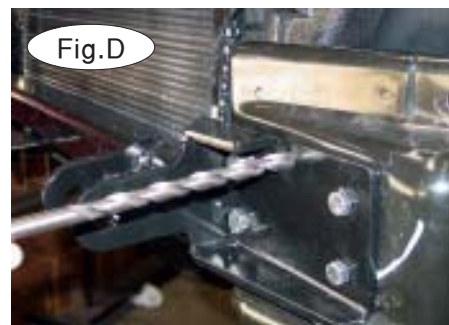
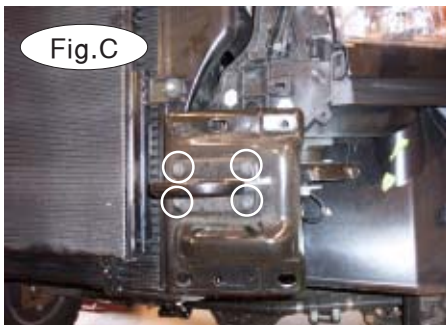

7. Place one of the rear braces behind one of the holes you drilled in step six, with the mounting plate resting on top of the frame tube (Fig.E). Then, bolt through the drilled hole and through the tube of the rear brace with a $\frac{1}{2}$ " x $7\frac{1}{2}$ " bolt, $\frac{1}{2}$ " lock washer and nut. Repeat on the other side. Finger-tighten only at this time.

8. Install one of the $9\frac{1}{2}$ " U-bolts, pointing upward, under the frame tube (Fig.E). Bolt through the mounting plate on the rear brace with a $\frac{1}{2}$ " lock washer and nut. Repeat on the other side.

9. On both sides, tighten the $7\frac{1}{2}$ " bolts and then the U-bolts to the torque specifications at the bottom of these instructions.

10. Reattach the bumper by reversing step 2.



BASEPLATE KIT INSTALLATION INSTRUCTIONS

KIT# 277-1

03/07/10
KS

ROADMASTER, Inc. 6110 NE 127th Ave. Vancouver, WA 98682 1-800-669-9690 fax 360-735-9300 www.roadmasterinc.com

11. The bumper insert will either need to be removed or trimmed to allow clearance for the quick link hooks and light plugs (Fig.F). *Note:* if removed, retain the bumper insert and attachment hardware for replacement in case the bracket is ever removed.

12. Fit the front bracket arms into the front receiver braces, and secure them in place with the supplied 5/8" draw pins and spring pins.

13. Install the tow bar to the mounting bracket according to the manufacturer's instructions. Attach the safety cables to the main receiver brace.



BOLT TORQUE REQUIREMENTS

Note: The torque values represented below are intended as general guidelines. Torque requirements for specific applications may vary. Roadmaster does not warrant this information to be accurate for all applications and disclaims all liability for any claims or damages which may result from its use.

STANDARD BOLTS

Thread Size	Grade	Torque
5/16	5	13 ft./lb.
3/8	5	23 ft./lb.
7/16	5	37 ft./lb.
1/2	5	56 ft./lb.
5/8	5	150 ft./lb.

METRIC BOLTS

Thread Size	Grade	Plated / Unplated
8mm-1.0	8.8	20 ft./lb. 18 ft./lb.
8mm-1.25	8.8	19 ft./lb. 18 ft./lb.
10mm-1.25	8.8	38 ft./lb. 36 ft./lb.
10mm-1.5	8.8	37 ft./lb. 35 ft./lb.

METRIC BOLTS

Thread Size	Grade	Plated / Unplated
12mm-1.25	8.8	70 ft./lb. 65 ft./lb.
12mm-1.5	8.8	66 ft./lb. 61 ft./lb.
12mm-1.75	8.8	65 ft./lb. 60 ft./lb.
14mm-2.0	8.8	104 ft./lb. 97 ft./lb.

All illustrations and specifications contained herein are based on the latest information available at the time of publication approval. ROADMASTER, INC. reserves the right to make changes at any time without notice in material, specification and models or to discontinue models.



BASEPLATE KIT INSTALLATION INSTRUCTIONS

KIT# 277-1

03/07/10
KS

ROADMASTER, Inc. 6110 NE 127th Ave. Vancouver, WA 98682 1-800-669-9690 fax 360-735-9300 www.roadmasterinc.com

Supplemental instructions for removal of grille and bumper on 2010 Dodge RAM 2500 and 3500 models



1. On each side, remove two plastic fasteners attaching the radiator cover to the core support (Fig.A – driver's side).
2. Remove four 10mm (head) bolts attaching the top of the grille to the core support (Fig.B).

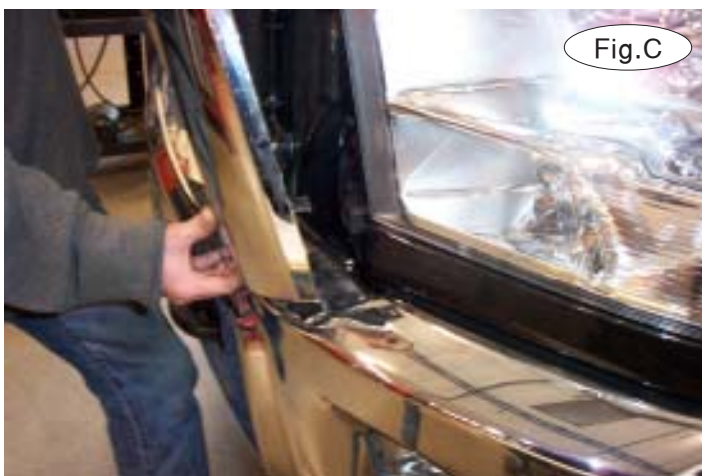

3. Pull out on each side of the grille to remove it (Fig.C).
4. On each side, remove the two 18mm upper mounting nuts (Fig.D – driver's side).
5. Unplug the wiring harness located on the inside of the bumper core on the driver's side (Fig.E).





BASEPLATE KIT INSTALLATION INSTRUCTIONS

KIT# 277-1

03/07/10
KS

ROADMASTER, Inc. 6110 NE 127th Ave. Vancouver, WA 98682 1-800-669-9690 fax 360-735-9300 www.roadmasterinc.com



6. Remove four plastic fasteners attaching the center splash shield to the bottom of the radiator (Fig.F).
7. Remove the two lower 18mm bumper mounting nuts (Fig.G).
8. Now, return to step 3 in the main instructions to finish the installation.