



BASEPLATE KIT INSTALLATION INSTRUCTIONS

KIT# 283-1

10/17/07
KS

ROADMASTER, Inc. 6110 NE 127th Ave. Vancouver, WA 98682 1-800-669-9690 fax 360-735-9300 www.roadmasterinc.com

ROADMASTER, INC.

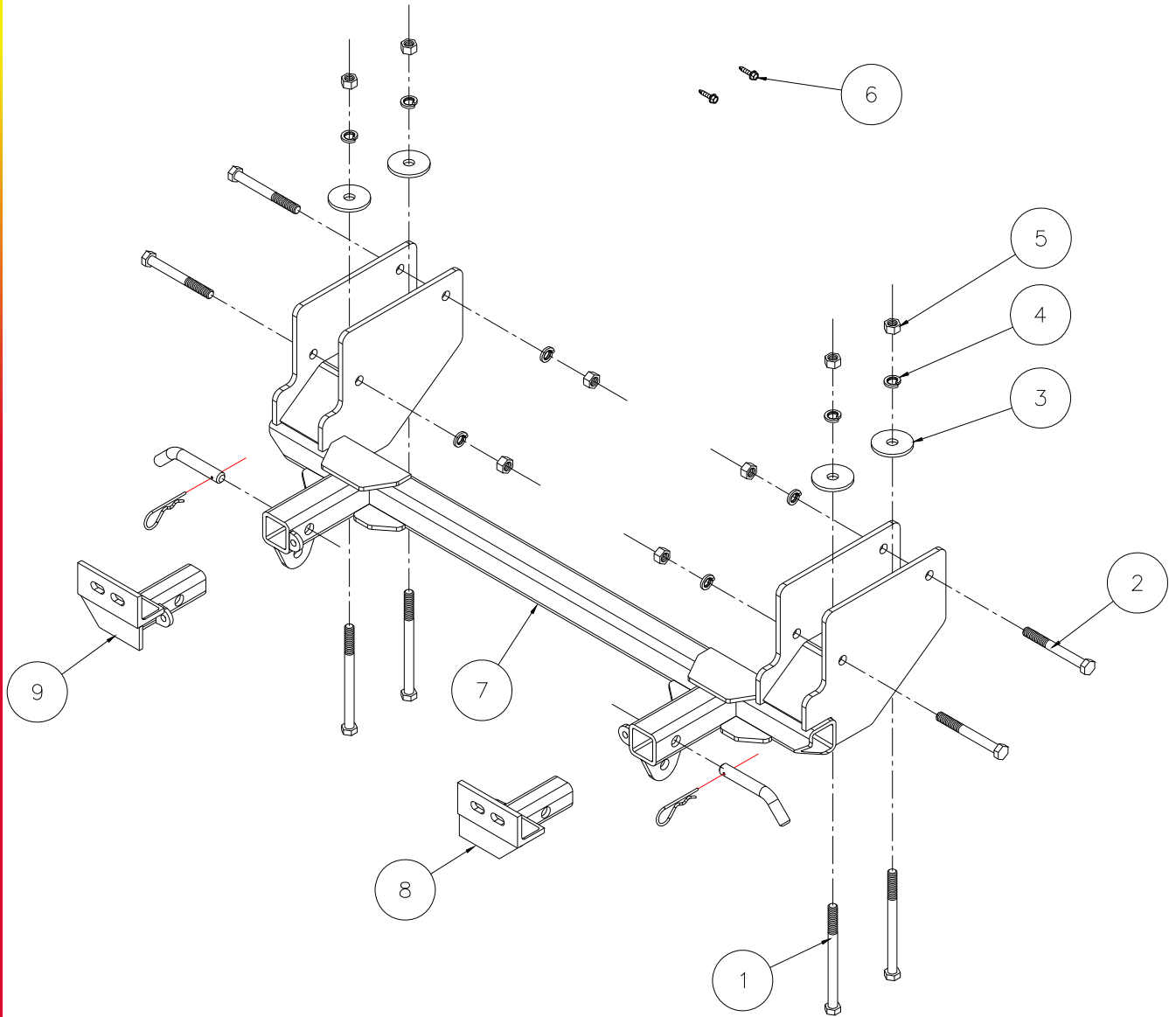

ITEM	QTY	NAME	MATERIAL
1	4	1/2" x 6 1/2" BOLT	350110-00
2	4	1/2" x 4 1/2" BOLT	350106-00
3	4	1/2" PLATE WASHER	A003086
4	8	1/2" LOCK WASHER	350309-00
5	8	1/2" HEX NUT	350258-00
6	2	1/4" x 3/4" SELF TAPPING SCREW	350271-00
7	1	MAIN RECEIVER	C-001593
8	1	DRIVER SIDE ARM	C-001594
9	1	PASSENGER SIDE ARM	C-001595



BASEPLATE KIT INSTALLATION INSTRUCTIONS

KIT# 283-1

10/17/07
KS

ROADMASTER, Inc. 6110 NE 127th Ave. Vancouver, WA 98682 1-800-669-9690 fax 360-735-9300 www.roadmasterinc.com

This is one of our XL series brackets, which allows the visible front portion of the bracket to be easily removed from the front of the vehicle (Fig.A and Fig.B). The bracket consists of a main receiver brace, two removable front braces and a hardware pack.

The main receiver brace mounts to the frame rails. The removable front braces install in the main receiver brace.

Before starting the installation, lay out the kit components in order, as they will be used. This will give you a visual idea of how the components work, and will also confirm that everything is present and accounted for.



IMPORTANT: All baseplates **must** be assembled with all the bolts left loose for final adjustment and positioning (before tightening) unless otherwise instructed. All bolts **must** be torqued for proper strength. If more than one bolt is used per fastening point, the diagram may only show one. Use flat washers over all slotted holes and lock washers on all fasteners.

WARNING

Failure to heed these warnings or follow the installation instructions may result in a voided warranty, loss of towed vehicle, personal injury or death.

- Do not weld or modify this baseplate or its components. Welding or modification will void the warranty.
- Do not use this document as a basis to design/fabricate a baseplate, as it may not show all parts or structural components.
- We strongly recommend professional installation.
- If the towed vehicle has been in an accident, it must be properly repaired before attaching the baseplate. Do not install the baseplate if any structural frame damage is found.
- The installer must use all bolts and parts supplied. If running changes were made by the vehicle manufacturer after this kit was designed, some bolts or other fasteners may no longer be the correct size. It is the installer's responsibility to verify this kit is securely fastened to the vehicle.
- Use Loctite® Red on all bolts used to secure this baseplate. Torque all bolts to the specifications found at the end of these instructions. Do not over-torque the bolts or failure may occur.
- The installer must inspect the baseplate to ensure adequate clearance, particularly around hoses, air conditioner lines, radiators, etc. or non-warranty failure may result.
- Roadmaster manufactures many styles of baseplates. If your baseplate has removable arms, they must be removed before driving the vehicle, unless the arms can be pinned or padlocked in place. If not secured, the arms could vibrate out.
- Some motorhome chassis have such a tight turning radius that you can damage your motorhome, towed vehicle, tow bar or baseplate while turning sharply. Before getting on the road, test your turning radius in an empty parking lot. Turning too sharply could result in non-warranty damage to your towing system, motorhome and/or towed vehicle.
- Do not back up with the towed vehicle attached or non-warranty damage will occur to your towing system or vehicles.
- The safety cables must connect the towing vehicle to the towed vehicle frame to frame, with the cables crossed, with enough slack for sharp turns. See cable instructions for proper routing. Failure to do so will result in non-warranty damage and/or the loss of the towed vehicle.
- This kit is designed for use with ROADMASTER tow bars and ROADMASTER adapters only. Using this kit with other brands, without an approved ROADMASTER adapter, may result in non-warranty damage or injury.
- Receiver extensions and out-of-level towing situations of 3 inches or more. This can cause the system to swing much higher and lower, causing excessive strain on the tow bar, baseplate and frame. That can cause the towing system to fail, causing property damage, personal injury or even death. If you must use a receiver extension or drop hitch to tow, it will reduce your receiver's weight capacity by 1/3 to avoid damaging your system. Never use more than one extension and/or drop hitch, as this will void your warranty.
- Every 3,000 miles, the owner must inspect all mounting points for cracks or fatigue, and check the fasteners for proper torque, according to the bolt torque requirements chart on the last page of these instructions.
- The owner must follow the vehicle manufacturer's instructions to prepare the vehicle for towing. Failure to do so may cause severe damage to the vehicle.
- This baseplate is only warranted for the original installation. Installing a used baseplate on another vehicle is not recommended and will void the warranty.



BASEPLATE KIT INSTALLATION INSTRUCTIONS

KIT# 283-1

10/17/07
KS

ROADMASTER, Inc. 6110 NE 127th Ave. Vancouver, WA 98682 1-800-669-9690 fax 360-735-9300 www.roadmasterinc.com

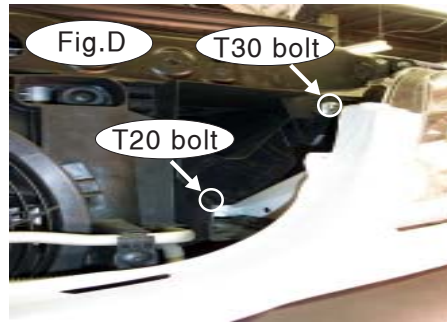

1. **Important:** please use all supplied bolts and parts and read all instructions carefully before beginning this installation. The majority of questions you may have can be answered within the text, and proper installation will ensure safe and secure travel. Now, begin the installation. Remove four T25 Torx bolts attaching the top of the grille to the core support (Fig.C). Lift up on the grille to remove it.
2. On both sides, remove two Torx bolts attaching the center grille to the core support. The top bolt is T30 and the bottom is T20 (Fig.D).
3. Pull forward on the outside edge of the center grille to remove it (Fig.E).

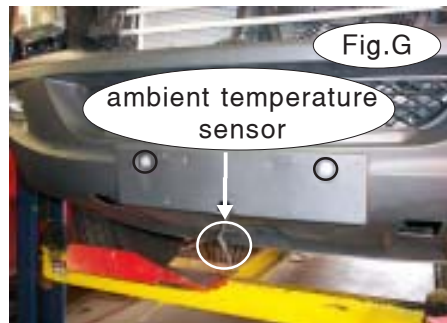
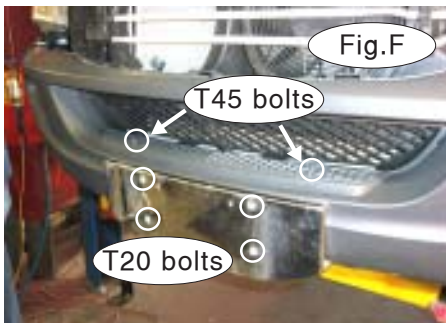

4. Remove two T45 Torx bolts attaching the bottom of the grille opening to the bumper core (Fig.F).
5. Remove four T20 Torx bolts attaching the license plate holder to the fascia (Fig.F), then disconnect the ambient temperature sensor from the back of the license plate holder (Fig.G).
6. Remove two 13mm (head) bolts attaching the fascia to the front of the bumper (Fig.G).
7. On both sides, remove three plastic fasteners attaching the fender liner to the side of the fascia and fender junction (Fig.H).

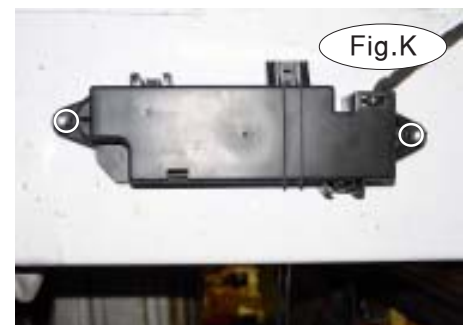

8. On both sides, remove two plastic fasteners attaching the fender liner to the bottom of the fascia (Fig.I).
9. Disconnect the fog lights, if the vehicle is so equipped. Then, pull forward on the fascia to remove it (Fig.J).
10. On the passenger's side, remove two 10mm plastic nuts attaching the electrical box to the frame rail (Fig.K).



BASEPLATE KIT INSTALLATION INSTRUCTIONS

KIT# 283-1

10/17/07
KS

ROADMASTER, Inc. 6110 NE 127th Ave. Vancouver, WA 98682 1-800-669-9690 fax 360-735-9300 www.roadmasterinc.com

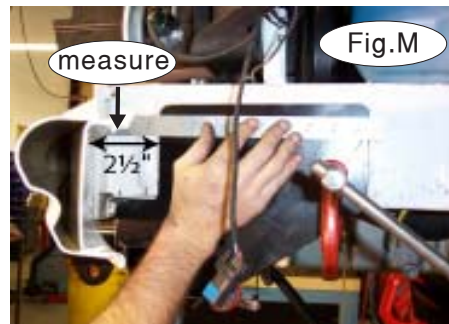
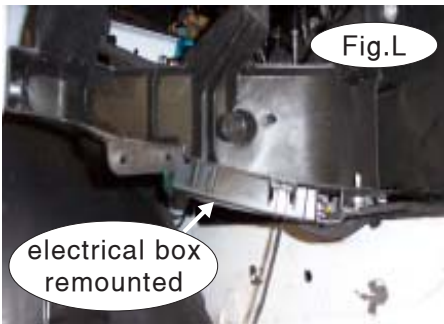

11. After removing the electrical box, cut the remaining two studs from the side of the frame rail. Using the two supplied $\frac{1}{4}$ " x $\frac{3}{4}$ " self-tapping screws, remount the electrical box to the bottom of the headlight support (Fig.L).

12. Slide the main receiver brace over the bottom of the frame rails until the bottom inside plate of the brace lies flush with the bottom of the frame rails.

13. Slide the main receiver brace forward and measure from the back of the bumper core to the brace. This measurement must be $2\frac{1}{2}$ " (Fig.M). Once it has been positioned, clamp the main receiver brace to the frame rail (Fig.M).

14. Using the pre-drilled holes in the main receiver brace as a template, drill four $\frac{1}{2}$ " holes on each side of the brace. The pre-drilled holes are on the bottom, both sides and the top. While drilling, keep a piece of scrap metal on the opposite side of the frame rail to protect the engine components. *Note:* keep the drill as straight as possible. If the holes aren't straight, the plate washers in Step 15 may need to be trimmed with a metal grinder, shear or saw.

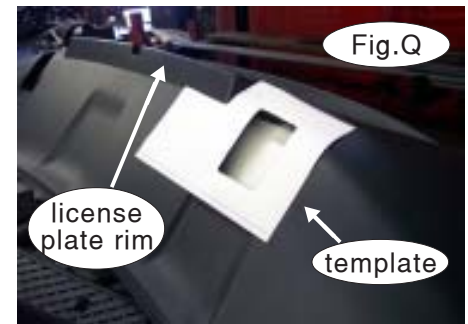
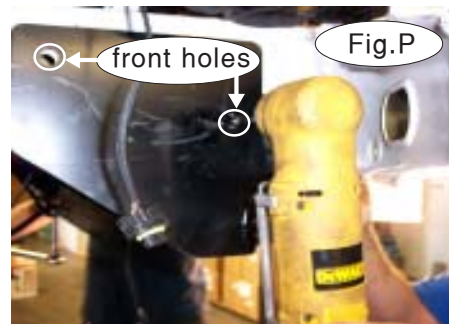

15. Bolt the main receiver brace to the frame rails using the four supplied $\frac{1}{2}$ " x $6\frac{1}{2}$ " bolts, plate washers, lock washers and nuts. The plate washers must be on the top side of the frame rail (Fig.O). Torque the bolts to the specifications listed at the end of these instructions.

16. Using the pre-drilled holes in the main receiver brace as a template, drill $\frac{1}{2}$ " holes through the two side holes in the frame rail on each side (Fig.P). While drilling, keep a piece of scrap metal on the opposite side of the frame rail to protect the engine components. *Note:* a 90-degree angle drill will be required to drill these holes (Fig.P).

Bolt the main receiver brace to the frame rails using the supplied $\frac{1}{2}$ " x $4\frac{1}{2}$ " bolts.

17. Cut out the template provided on the last page of these instructions and align it with the edge of the license plate rim on the fascia (Fig.Q). Using a marker, trace out the rectangular opening and trim (Fig.Q).

18. Reassemble the fascia by reversing steps 1 through 9. Tighten all bolts to the torque specifications listed at the end of these instructions.



BASEPLATE KIT INSTALLATION INSTRUCTIONS

KIT# 283-1

10/17/07
KS

ROADMASTER, Inc. 6110 NE 127th Ave. Vancouver, WA 98682 1-800-669-9690 fax 360-735-9300 www.roadmasterinc.com

19. Insert the removable front bracket arms into the front receiver braces, and secure them in place with the supplied 5/8" draw pins and spring pins.

20. Install the tow bar to the mounting bracket according to the manufacturer's instructions.

Note: this bracket does not use short safety cables. It requires 10,000-pound rated safety cables that attach to the main receiver brace on the towing vehicle.

BOLT TORQUE REQUIREMENTS

Note: The torque values represented below are intended as general guidelines. Torque requirements for specific applications may vary. Roadmaster does not warrant this information to be accurate for all applications and disclaims all liability for any claims or damages which may result from its use.

STANDARD BOLTS

Thread Size	Grade	Torque
5/16	5	13 ft./lb.
3/8	5	23 ft./lb.
7/16	5	37 ft./lb.
1/2	5	56 ft./lb.
5/8	5	150 ft./lb.

METRIC BOLTS

Thread Size	Grade	Plated / Unplated
8mm-1.0	8.8	20 ft./lb. 18 ft./lb.
8mm-1.25	8.8	19 ft./lb. 18 ft./lb.
10mm-1.25	8.8	38 ft./lb. 36 ft./lb.
10mm-1.5	8.8	37 ft./lb. 35 ft./lb.

METRIC BOLTS

Thread Size	Grade	Plated / Unplated
12mm-1.25	8.8	70 ft./lb. 65 ft./lb.
12mm-1.5	8.8	66 ft./lb. 61 ft./lb.
12mm-1.75	8.8	65 ft./lb. 60 ft./lb.
14mm-2.0	8.8	104 ft./lb. 97 ft./lb.

All illustrations and specifications contained herein are based on the latest information available at the time of publication approval. ROADMASTER, INC. reserves the right to make changes at any time without notice in material, specification and models or to discontinue models.

KIT# 283-1

10/17/07
KS

**Template for
fascia trimming**

