



# BASEPLATE KIT INSTALLATION INSTRUCTIONS

**KIT# 3142-1**

12/20/05  
KB

ROADMASTER, Inc. 6110 NE 127th Ave. Vancouver, WA 98682 1-800-669-9690 fax 360-735-9300 www.roadmasterinc.com

ROADMASTER, INC.

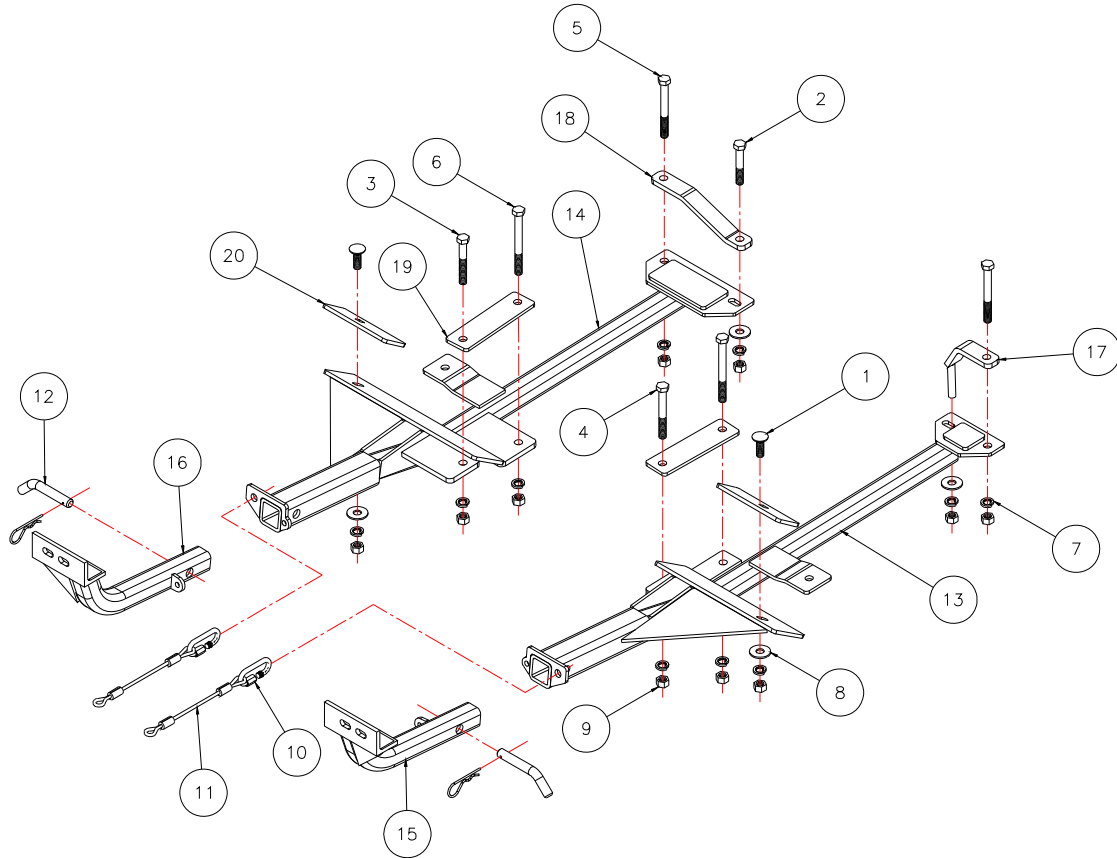

Item	Qty.	Length	Width	Description	Part#
1	2	1 1/2"	1/2"	CARRIAGE BOLT	350362-00
2	1	3"	1/2"	BOLT	350101-00
3	1	3 1/2"	1/2"	BOLT	350103-00
4	1	4"	1/2"	BOLT	350105-00
5	2	4 1/2"	1/2"	BOLT	350106-00
6	2	5"	1/2"	BOLT	350107-00
7	10		1/2"	LOCK WASHER	350309-00
8	4		1/2"	FLAT WASHER	350308-20
9	10		1/2"	NUT	350258-00
10	2			CABLE CONNECTOR	200008-00
11	2	10"		SAFETY CABLE	500646-10
12	2		5/8"	DRAW PINS, SPRING PINS	357035-00
13	1			DRIVER SIDE RECEIVER BRACE WELDMENT	C-001362
14	1			PASSENGER SIDE RECEIVER BRACE WELDMENT	C-001363
15	1			DRIVER SIDE ARM WELDMENT	C-001364
16	1			PASSENGER SIDE ARM WELDMENT	C-001365
17	1			PASSENGER SIDE REAR CLAMP WELDMENT	C-001336
18	1			PASSENGER SIDE REAR PLATE	B-000921
19	2			1/4" X 2" X 7" TWO HOLE BACKING PLATE	A-001967
20	2			1/4" x 2 1/2" x 6" PLATE WITH SQ. HOLE	A-002186



# BASEPLATE KIT INSTALLATION INSTRUCTIONS

**KIT# 3142-1**

12/20/05  
KB

ROADMASTER, Inc. 6110 NE 127th Ave. Vancouver, WA 98682 1-800-669-9690 fax 360-735-9300 www.roadmasterinc.com

This is one of our XL series brackets, which allows the visible front portion of the bracket to be easily removed from the front of the vehicle (Fig.A and Fig.B). The bracket kit consists of a passenger's and driver's side main receiver brace, two rear backing plates, four front backing plates, two removable front braces and a hardware pack. The main receiver brace mounts to the sub frame. The rear driver's and passenger's side backing plates mount to the main receiver brace. Two of the front driver and passenger's side backing plates mount to the sub frame and two of them mount to the main receiver brace. The removable front braces install in the main receiver braces.

Before starting the installation, lay out the kit components in order, as they will be used. This will give you a visual idea of how the components work, and will also confirm that everything is present and accounted for.



Fig.A



Fig.B

**IMPORTANT:** All baseplates **must** be assembled with all the bolts left loose for final adjustment and positioning (before tightening) unless otherwise instructed. All bolts **must** be torqued for proper strength. If more than one bolt is used per fastening point, the diagram may only show one.

- Use flat washers over all slotted holes
- Use lock washers on all fasteners

## WARNING

Failure to follow the below warnings and the installation instructions may result in voiding your warranty, property damage, the loss of your towed vehicle, personal injury or even death.

- Installation of most baseplates requires moderate mechanical aptitude and skills. We strongly recommend professional installation by an experienced installer.
- The installer must read the instructions and use all bolts and parts supplied.
- Use Loctite® Red on all bolts used for mounting this baseplate.
- Every 3,000 miles, the owner must inspect the fasteners for proper torque, according to the bolt torque requirements chart on the last page of these instructions. The owner must also inspect all mounting points for cracks or other signs of fatigue every 3,000 miles.
- The owner must check the vehicle manufacturer's instructions for the proper procedure(s) to prepare the vehicle for towing. Some vehicles must be equipped with a transmission lube pump, an axle disconnect, driveline disconnect or free-wheeling hubs before they can be towed. Failure to properly equip the vehicle will cause severe damage to the transmission.
- Do not weld. This baseplate is designed to be bolted to the vehicle. Welding will void the warranty.
- Do not use this document for custom fabrication, as it may not show all parts or structural components could result in loss of the towed vehicle.
- If the towed vehicle has been in an accident, it must be properly repaired before attaching the baseplate. Do not install the baseplate if any structural frame damage is found.
- If running changes were made by the vehicle manufacturer after this kit was designed, some bolts or other fasteners in the hardware pack may no longer be the correct size. It is the installer's responsibility to verify this kit is securely fastened to the vehicle and fitted with the correct hardware to account for these changes.
- Roadmaster manufactures many styles of baseplates. If your baseplate has removable arms, they must be removed before driving the vehicle, unless the arms can be pinned or padlocked in place. If not secured, the arms could vibrate out.
- Some motorhome chassis have such a tight turning radius that you can damage your motorhome, towed vehicle, tow bar or baseplate while turning sharply. Before getting on the road, test your turning radius in an empty parking lot. Turning too sharply could result in non-warranty damage to towing system, motorhome and/or towed vehicle.
- Do not back up with the towed vehicle attached or non-warranty damage will occur to your towing system, motorhome and/or towed vehicle.
- The safety cables must connect the towing vehicle to the towed vehicle frame to frame, with the cables crossed, with enough slack for sharp turns. Refer to the cable instructions for proper routing. Failure to leave enough slack in the safety cables, or failure to connect the safety cables frame to frame, will result in the loss of the towed vehicle.
- This kit is designed for use with ROADMASTER tow bars and ROADMASTER adapters only. Using this kit with other brands, without an approved ROADMASTER adapter, may result in non-warranty damage or injury.
- Upon final installation, the installer must inspect the baseplate to ensure adequate clearance, particularly around hoses, air conditioner lines, radiators, etc.
- This baseplate is only warranted for the original installation. Installing a used baseplate on another vehicle is not recommended and will void the warranty.



# BASEPLATE KIT INSTALLATION INSTRUCTIONS

**KIT# 3142-1**

12/20/05  
KB

ROADMASTER, Inc. 6110 NE 127th Ave. Vancouver, WA 98682 1-800-669-9690 fax 360-735-9300 www.roadmasterinc.com



1. **Important:** please use all supplied bolts and parts and read all instructions carefully before beginning this installation. The majority of questions you may have can be answered within the text, and proper installation will ensure safe and secure travel. Now, begin the installation. Before installation, the splash panel will need to be trimmed to allow for clearance of the passenger and driver's side main receiver braces. Hold the braces in place and mark the area to be trimmed. Refer to the yellow marker line in Figure C for correct trimming.

2. On both sides, remove the T55 Torx front "A" arm suspension bolt (Fig.D).

3. Starting with the driver's side, lift one of the main receiver braces into place. Bolt into place using the T55 Torx suspension bolt you removed in the previous step (Fig.E). Repeat for the passenger's side.



4. On the driver's side, insert the  $\frac{1}{4}$ " x  $2\frac{1}{2}$ " x 6" backing plate and the  $\frac{1}{2}$ " x  $1\frac{1}{2}$ " carriage bolt into the end of the opening in the sub frame (Fig.F). Bolt through the existing hole in the frame and the main receiver brace (Fig.G). Repeat for the passenger's side.

5. For the driver's side rear mounting point, place the backing plate with the attached stud over the frame (Fig.H). Making sure that the stud is facing towards the inside of the vehicle, place the stud into the slotted hole (Fig.I). Next, place a  $\frac{1}{2}$ " x  $4\frac{1}{2}$ " bolt through the backing plate and outside hole in the main receiver brace. Bolt into to place using a  $\frac{1}{2}$ " lock washers and nuts. *Note:* the inside slotted hole also uses a flat washer (Fig.J).

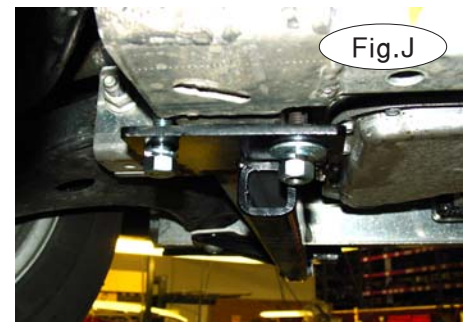
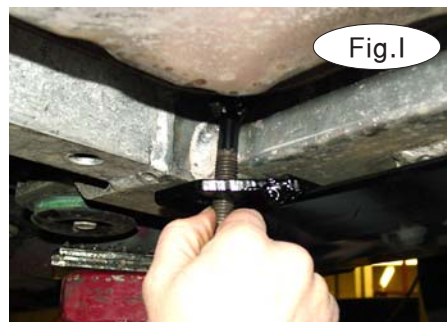



# BASEPLATE KIT INSTALLATION INSTRUCTIONS

**KIT# 3142-1**

12/20/05  
KB

ROADMASTER, Inc. 6110 NE 127th Ave. Vancouver, WA 98682 1-800-669-9690 fax 360-735-9300 www.roadmasterinc.com



Fig.K



Fig.L

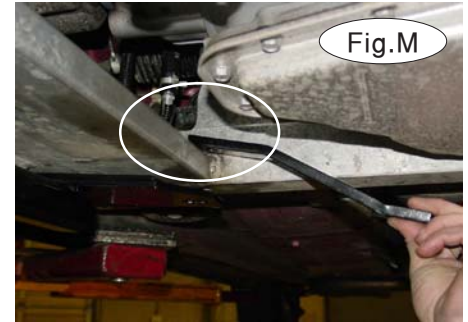

Fig.M

6. For the driver's side front mounting point, insert the 1/4" x 2" x 7" backing plate over the top of the sub frame (Fig.K). Bolt through the backing plate and the main receiver brace (Fig.L). The rear hole uses a 1/2" x 5" bolt and the front uses a 1/2" x 4" bolt. Finish with 1/2" lock washers and nuts.

7. For the passenger's side rear mounting point, place the 1 1/4" x 9" backing plate (with two 9/16" holes) over the top of the sub frame (Fig.M). Bolt into place using a 1/2" x 4 1/2" bolt on the outside and a 1/2" x 3" bolt on the inside. Finish with 1/2" lock washers and nuts (Fig.N). Note: the inside slot also uses a flat washer.

8. For the passenger's side front mounting point, place 1/4" x 2 1/2" x 6" backing plate over the top of the sub frame. Note: make sure to slide the backing plate under any tubing or wiring harness (Fig.O). Bolt into place using 1/2" x 5 1/2" bolt for the rear and a 1/2" x 3 1/2" bolt for the front. Finish with 1/2" lock washers and nuts.

9. Tighten all bolts to the torque specifications listed at the end of these instructions.

10. Fit the front bracket arms into the front receiver braces, and secure them in place with the supplied 5/8" draw pins and spring pins (Fig.P).

11. Attach the 10" safety cables with the cable connectors (Q-links) to the front of the receiver braces (Fig.P).

12. Attach the ends of the safety cables to the tow vehicle's safety cables and tow bar.

13. Install the tow bar to the mounting bracket according to the manufacturer's instructions.

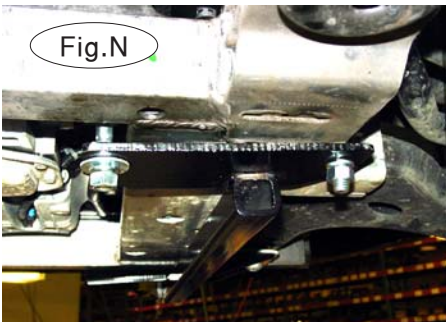

Fig.N



Fig.O

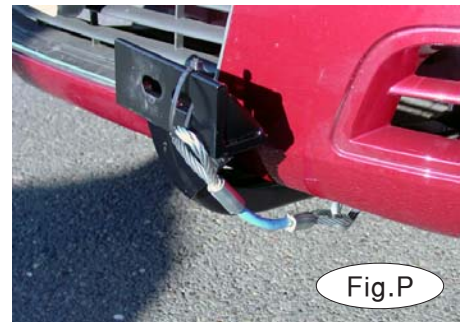

Fig.P

## BOLT TORQUE REQUIREMENTS

Note: The torque values represented below are intended as general guidelines. Torque requirements for specific applications may vary. Roadmaster does not warrant this information to be accurate for all applications and disclaims all liability for any claims or damages which may result from its use.

### STANDARD BOLTS

Thread Size	Grade	Torque
5/16	5	13 ft./lb.
3/8	5	23 ft./lb.
7/16	5	37 ft./lb.
1/2	5	56 ft./lb.
5/8	5	150 ft./lb.

### METRIC BOLTS

Thread Size	Grade	Plated / Unplated
8mm-1.0	8.8	20 ft./lb. 18 ft./lb.
8mm-1.25	8.8	19 ft./lb. 18 ft./lb.
10mm-1.25	8.8	38 ft./lb. 36 ft./lb.
10mm-1.5	8.8	37 ft./lb. 35 ft./lb.

### METRIC BOLTS

Thread Size	Grade	Plated / Unplated
12mm-1.25	8.8	70 ft./lb. 65 ft./lb.
12mm-1.5	8.8	66 ft./lb. 61 ft./lb.
12mm-1.75	8.8	65 ft./lb. 60 ft./lb.
14mm-2.0	8.8	104 ft./lb. 97 ft./lb.

All illustrations and specifications contained herein are based on the latest information available at the time of publication approval. ROADMASTER, INC. reserves the right to make changes at any time without notice in material, specification and models or to discontinue models.