



# BASEPLATE KIT INSTALLATION INSTRUCTIONS

**KIT# 495-1**

12/14/07  
KS

ROADMASTER, Inc. 6110 NE 127th Ave. Vancouver, WA 98682 1-800-669-9690 fax 360-735-9300 www.roadmasterinc.com

ROADMASTER, INC.

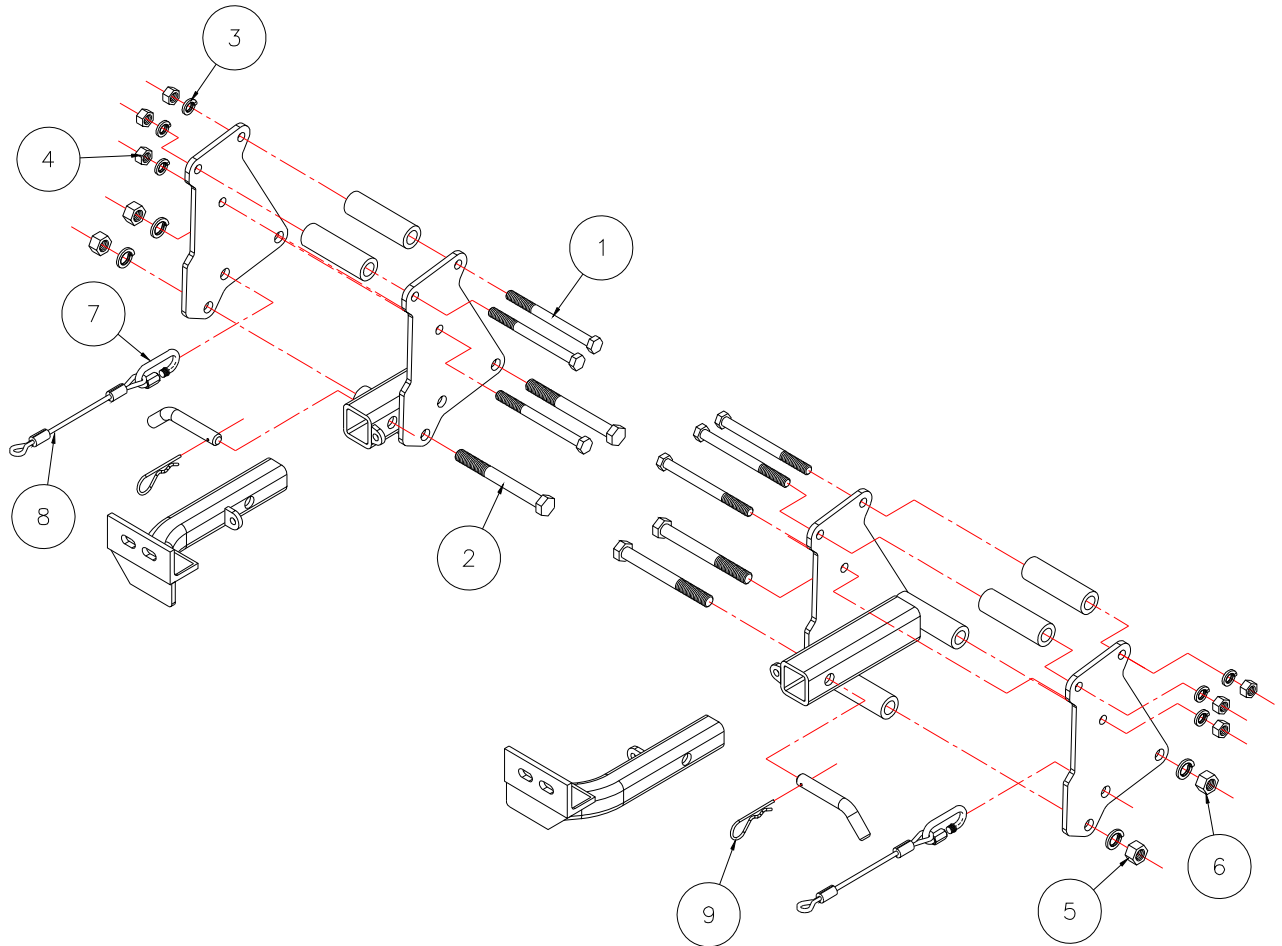

Item	Qty	Length	Width	Hardware	Part No.
1	6	6"	1/2"	BOLT	350109-00
2	4	6"	5/8"	BOLT	350162-00
3	6	1/2"		LOCK WASHER	350309-00
4	6	1/2"		NUT	350258-00
5	4	5/8"		LOCK WASHER	350313-00
6	4	5/8"		NUT	350262-00
7	2			CABLE CONNECTOR	200008-00
8	2	15"		CABLE, 8,000 lb. rated	650648-15
9	2			DRAW PIN/SPRING PIN	357035-00



# BASEPLATE KIT INSTALLATION INSTRUCTIONS

**KIT# 495-1**

12/14/07  
KS

ROADMASTER, Inc. 6110 NE 127th Ave. Vancouver, WA 98682 1-800-669-9690 fax 360-735-9300 www.roadmasterinc.com

**IMPORTANT:** All brackets **must** be assembled with all the bolts left loose for final adjustment & positioning (before tightening) unless otherwise instructed. All bolts **must** be torqued for proper strength. If more than one bolt is used per fastening point, the diagram may only show one.

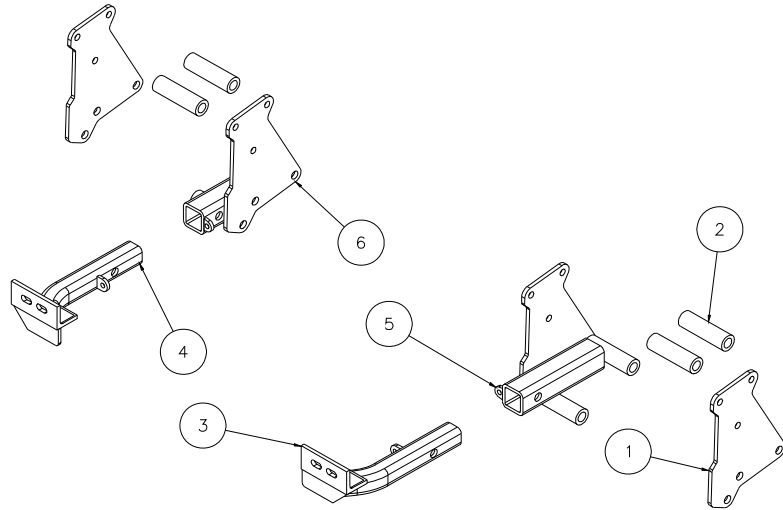

Item	Qty	Part No.	Assembly
1	2	A-001277	.. MAIN MOUNTING PLATE
2	4	A-001278	.. 1 1/4" O.D. x 4 1/4" TUBE SPACER
3	1	C-000764	.. DRIVER SIDE ARM WELDMENT
4	1	C-000765	.. PASSENGER SIDE ARM WELDMENT
5	1	C-000766	.. DRIVER SIDE RECEIVER BRACE WELDMENT
6	1	C-000767	.. PASSENGER SIDE RECEIVER BRACE WELDMENT

## WARNING

Failure to follow these instructions can result in property damage, personal injury or even death.

- **Installation of most mounting brackets requires moderate mechanical aptitude and skills.** We strongly recommend professional installation by an experienced installer.
- **The installer must read the instructions and use all bolts and parts supplied.** When the instructions require the reuse of factory bolts, thread lock and/or lock washers must also be used. Failure to securely fasten the bracket could result in loss of the towed vehicle.
- **Do not use this document for custom fabrication,** as it may not show all parts or structural components. Custom fabrication or an attempt to copy this bracket design could result in loss of the towed vehicle.
- **Every 3,000 miles, the owner must inspect the fasteners** for proper torque, according to the bolt torque requirements chart on the last page of these instructions. **The owner must also inspect all mounts and brackets for cracks or other signs of fatigue every 3,000 miles.** Failure to do so could result in loss of the towed vehicle.
- **The owner must check the vehicle manufacturer's instructions for the proper procedure(s) to prepare the vehicle for towing.** Some vehicles must be equipped with a transmission lube pump, an axle disconnect, driveline disconnect or free-wheeling hubs before they can be towed. Failure to properly equip the vehicle will cause severe damage to the transmission.
- **If running changes were made** by the vehicle manufacturer after this bracket was designed, some bolts or other fasteners in the hardware pack may no longer be the correct size. **It is the installer's responsibility** to verify that the bracket is securely fastened to the vehicle and fitted with the correct hardware to account for these changes. Failure to securely fasten the bracket could result in loss of the towed vehicle.
- If the towed vehicle has been in an accident, it must be properly repaired before attaching the bracket. **Do not install the bracket if any structural frame damage is found.** Failure to repair the damage could result in the loss of the towed vehicle.
- Some motorhome chassis have such a tight turning radius that you can damage your motorhome, towed vehicle, tow bar or bracket while turning sharply. **Before getting on the road, test your turning radius in an empty parking lot.** Turning too sharply could result in non-warranty damage to towing system, motorhome and/or towed vehicle.
- **Do not back up with the towed vehicle attached** or non-warranty damage will occur to your towing system, motorhome and/or towed vehicle.
- **The safety cables must connect the towing vehicle to the towed vehicle frame to frame, with the cables crossed, with enough slack for sharp turns.** Refer to the cable instructions for proper routing. Failure to leave enough slack in the safety cables, or failure to connect the safety cables frame to frame, will result in the loss of the towed vehicle.
- This bracket is designed for use with ROADMASTER tow bars and ROADMASTER adaptors only. **Using this bracket with other brands, without an approved ROADMASTER adaptor, may result in non-warranty damage or injury.**
- Upon final installation, **the installer must inspect the bracket to ensure adequate clearance, particularly around hoses, air conditioner lines, radiators, etc.,** or non-warranty damage to the towed vehicle will result.
- **This bracket is only warranted for the original installation.** Installing a used bracket on another vehicle is not recommended and will void the warranty.



# BASEPLATE KIT INSTALLATION INSTRUCTIONS

**KIT# 495-1**

12/14/07  
KS

ROADMASTER, Inc. 6110 NE 127th Ave. Vancouver, WA 98682 1-800-669-9690 fax 360-735-9300 www.roadmasterinc.com

This bracket kit is one of our XL series, which allows you to remove the most visual portion of the bracket (Fig.A). The kit consists of two receiver braces, two front braces and a hardware pack. The receiver braces are designed to mount to the frame tubes on each side in place of the existing tow hooks. Start by laying out the kit as illustrated to check parts and placement of parts.

For 2004-08 Ford F150 models without tow hooks, follow steps 1 through 3, then on to step 7. For sport models, start with step 4, then on to step 7. If your vehicle is equipped with tow hooks, start with step 5. For the 2006 Lincoln Mark LT, refer to Figures T and U on page 5 for the fascia trimming only, then on to step 7.

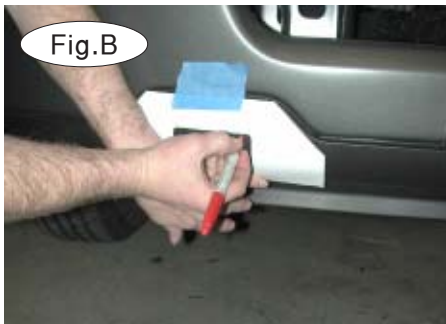

1. Cut out the provided F-150 template on the second to last page of these instructions.
2. Tape the template to the fascia, referring to Figure B for correct placement. Now, trace the opening as a guide for correct trimming.
3. Using a reciprocating saw or die grinder, cut along the line you marked in the previous step (Fig.C). Proceed to step 6 to complete the installation.

*Note:* you will need pliers to insert the spring pin (Fig.D), or you can cut the hole in the lower fascia larger to allow access to the pin without the pliers.

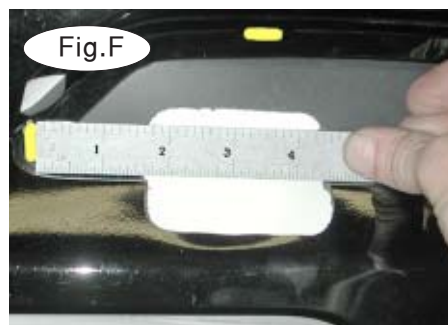
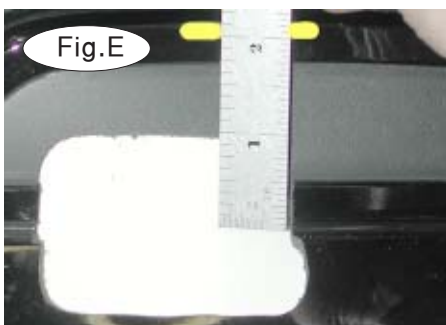

4. On each side, measure approximately 2" down from the top of the trim line (Fig.E), and 3 1/4" from the side (Fig.F), using the yellow marker lines as a reference. Drill a 1/2" pilot hole at this point. Enlarge the opening with a die grinder, using the receiver brace directly below as a reference, until the opening is large enough for the removable front brace (Fig.G).



# BASEPLATE KIT INSTALLATION INSTRUCTIONS

**KIT# 495-1**

12/14/07  
KS

ROADMASTER, Inc. 6110 NE 127th Ave. Vancouver, WA 98682 1-800-669-9690 fax 360-735-9300 www.roadmasterinc.com



5. Remove the tow hooks on each side by removing two front bolts and loosening the rear bolts (Fig.H). Slide the hooks back off the rear bolt (Fig.I). *Note:* on models without tow hooks, there will be no front bolts to replace in step 5.

6. Now put the front bolts back in and tighten down (Fig.J), then remove the rear bolt on each side (Fig.K).



7. Working on one side at a time, find the hole in the frame located above the tow hook mounting area and put a 1/2" x 6" bolt through the brace and the frame from the inside of the frame (Fig.L,M,N).

8. Put two bolts over the top of the frame then follow with two 4 1/2" pipe spacers (Fig.O).



9. Position the outside plate (Fig.P) over the three bolts and two top spacers then secure with 1/2" lock washers and nuts (Fig.Q).

10. Follow with two more 5/8" x 6" bottom bolts, lock washers and nuts (Fig.R).

11. Repeat steps 7 through 10 for the remaining side.

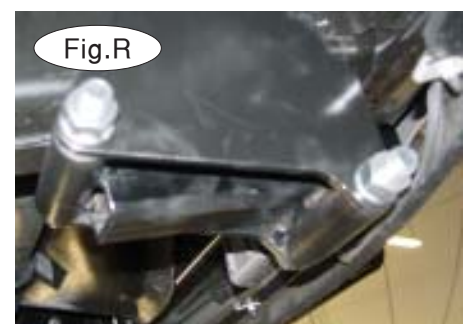



# BASEPLATE KIT INSTALLATION INSTRUCTIONS

**KIT# 495-1**

12/14/07  
KS

ROADMASTER, Inc. 6110 NE 127th Ave. Vancouver, WA 98682 1-800-669-9690 fax 360-735-9300 www.roadmasterinc.com

12. Insert the front braces into the receiver braces and secure with 5/8" draw pins and 3/16" safety pins (Fig.S).

13. Align the braces with each other then torque all mounting bolts to the specifications below.

14. Install the tow bar according to the manufacturer's instructions and torque all mounting bolts to the specifications below.

15. Attach one end of the included 15" safety cables to the lower front hole in the side mounting plate on each side of the receiver brace with the included cable connectors (quick links). Connect the other end to the tow vehicle's safety cables and the tow bar (Fig.S).



## For fascia trimming on the 2006 Lincoln Mark LT, see the instructions below.

1. Cut out the provided template on the last page of these instructions.

2. Tape the template to the fascia, referring to Figure T for correct placement. Now, trace the opening as a guide for correct trimming.

3. Using a reciprocating saw or die grinder, cut along the line you marked in the previous step (Fig.U).



**Now, return to step 7 to finish the installation.**

### BOLT TORQUE REQUIREMENTS

Note: The torque values represented below are intended as general guidelines. Torque requirements for specific applications may vary. Roadmaster does not warrant this information to be accurate for all applications and disclaims all liability for any claims or damages which may result from its use.

#### STANDARD BOLTS

Thread Size	Grade	Torque
5/16	5	13 ft./lb.
3/8	5	23 ft./lb.
7/16	5	37 ft./lb.
1/2	5	56 ft./lb.
5/8	5	150 ft./lb.

#### METRIC BOLTS

Thread Size	Grade	Plated / Unplated
8mm-1.0	8.8	20 ft./lb. 18 ft./lb.
8mm-1.25	8.8	19 ft./lb. 18 ft./lb.
10mm-1.25	8.8	38 ft./lb. 36 ft./lb.
10mm-1.5	8.8	37 ft./lb. 35 ft./lb.

#### METRIC BOLTS

Thread Size	Grade	Plated / Unplated
12mm-1.25	8.8	70 ft./lb. 65 ft./lb.
12mm-1.5	8.8	66 ft./lb. 61 ft./lb.
12mm-1.75	8.8	65 ft./lb. 60 ft./lb.
14mm-2.0	8.8	104 ft./lb. 97 ft./lb.

All illustrations and specifications contained herein are based on the latest information available at the time of publication approval. ROADMASTER, INC. reserves the right to make changes at any time without notice in material, specification and models or to discontinue models.



# BASEPLATE KIT INSTALLATION INSTRUCTIONS

**KIT# 495-1**  
12/14/07  
KS

ROADMASTER, Inc. 6110 NE 127th Ave. Vancouver, WA 98682 1-800-669-9690 fax 360-735-9300 www.roadmasterinc.com

Template for  
Ford F-150  
fascia trimming

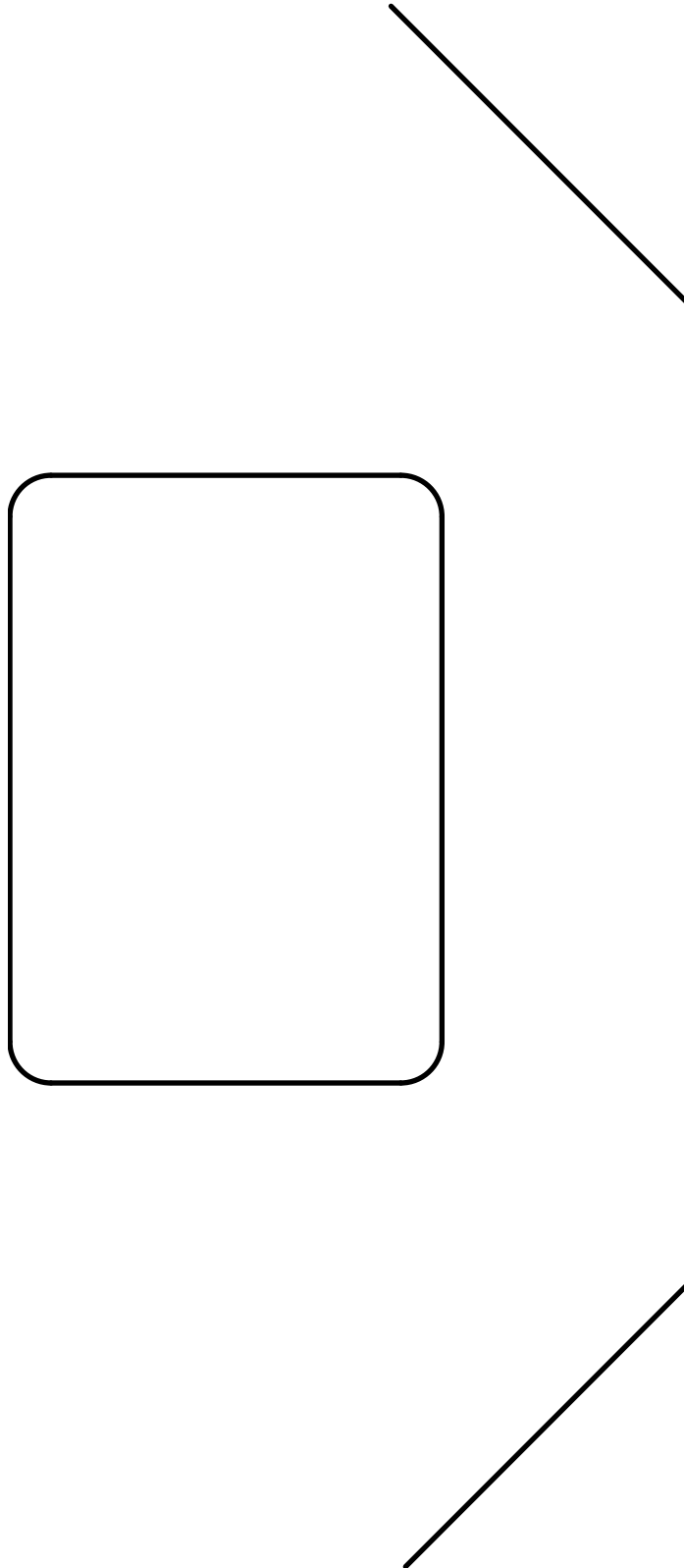

Template for Lincoln  
Mark LT fascia  
trimming

