



# BASEPLATE KIT INSTALLATION INSTRUCTIONS

**KIT# 523157-1**

04/01/10  
KS

ROADMASTER, Inc. 6110 NE 127th Ave. Vancouver, WA 98682 360-896-0407 fax 360-735-9300 www.roadmasterinc.com

*fits Pontiac G5 and Chevrolet Cobalt AJ/AK body style*

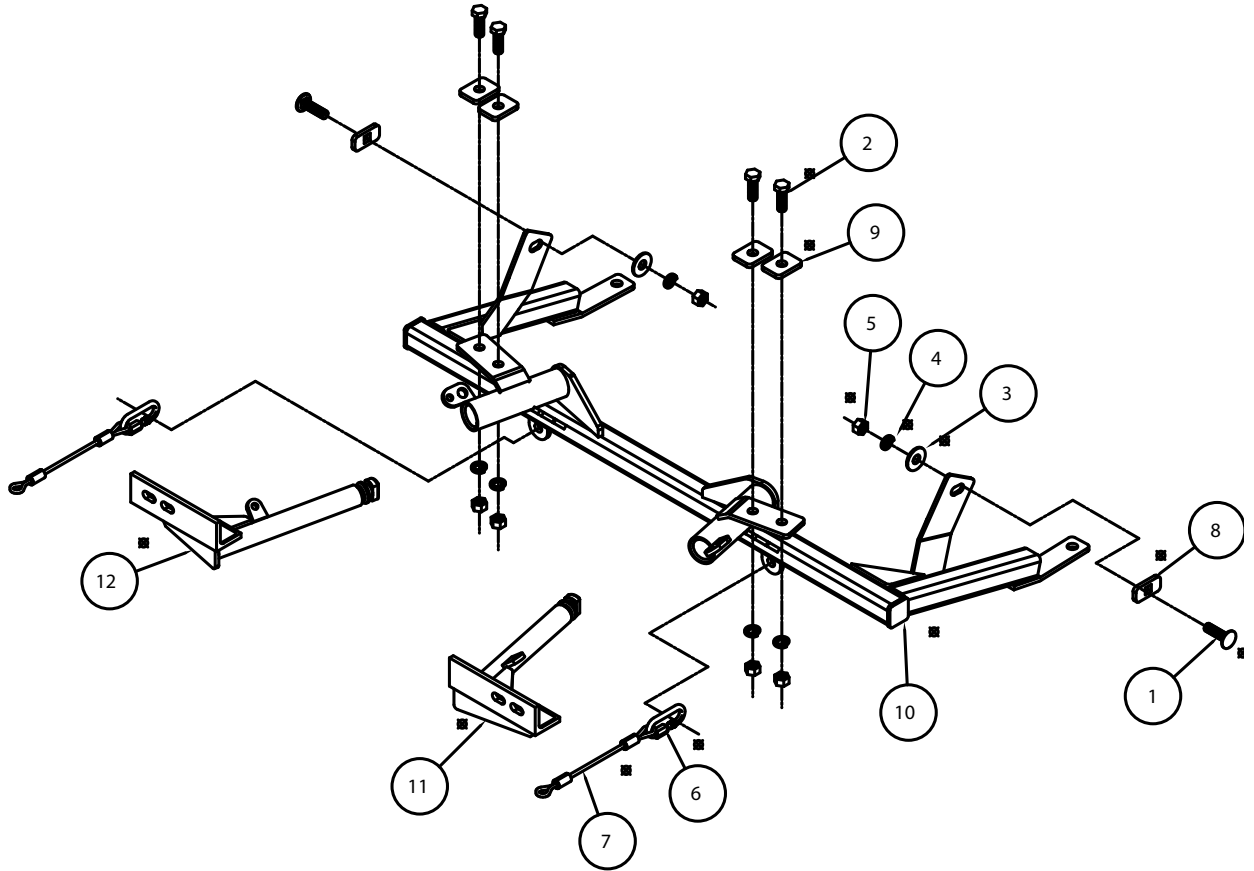

ITEM	QTY	NAME	MATERIAL
1.....	2.....	1/2" x 1 3/4" CARRIAGE BOLT.....	350363-00
2.....	4.....	1/2" x 1 1/2" BOLT.....	350095-00
3.....	2.....	1/2" FLAT WASHER.....	350308-00
4.....	6.....	1/2" LOCK WASHER.....	350309-00
5.....	6.....	1/2" HEX NUT.....	350258-00
6.....	2.....	QUICK LINK.....	200008-00
7.....	2.....	SAFETY CABLE 14".....	500646-14
8.....	2.....	1/4" x 1" x 2" SQ. HOLE BACKING PLATE.....	A-000040
9.....	4.....	1/4" x 1 1/2" x 2" ROUND HOLE BACKING PLATE.....	A-000122
10.....	1.....	MAIN RECEIVER.....	C-001686
11.....	1.....	DRIVER SIDE ARM.....	C-001687
12.....	1.....	PASSENGER SIDE ARM.....	C-001688

ROADMASTER, INC.



# BASEPLATE KIT INSTALLATION INSTRUCTIONS

**KIT# 523157-1**

04/01/10  
KS

ROADMASTER, Inc. 6110 NE 127th Ave. Vancouver, WA 98682 360-896-0407 fax 360-735-9300 www.roadmasterinc.com

This is one of our EZ2 series brackets, which allows the visible front portion of the bracket to be easily removed from the front of the vehicle (Fig.A and Fig.B). The bracket consists of a main receiver brace, two removable front braces, and a hardware pack.

The main receiver brace mounts to the frame rails and the bumper core. The removable front braces install in the main receiver brace.

Before starting the installation, lay out the kit components in order, as they will be used. This will give you a visual idea of how the components work, and will also confirm that everything is present and accounted for.



**IMPORTANT:** All baseplates **must** be assembled with all the bolts left loose for final adjustment and positioning (before tightening) unless otherwise instructed. All bolts **must** be torqued for proper strength. If more than one bolt is used per fastening point, the diagram may only show one. Use flat washers over all slotted holes and lock washers on all fasteners.

## WARNING

Failure to heed these warnings or follow the installation instructions may result in a voided warranty, loss of towed vehicle, personal injury or death.

- Do not weld or modify this baseplate or its components. Welding or modification will void the warranty.
- Do not use this document as a basis to design/fabricate a baseplate, as it may not show all parts or structural components.
- We strongly recommend professional installation.
- If the towed vehicle has been in an accident, it must be properly repaired before attaching the baseplate. Do not install the baseplate if any structural frame damage is found.
- The installer must use all bolts and parts supplied. If running changes were made by the vehicle manufacturer after this kit was designed, some bolts or other fasteners may no longer be the correct size. It is the installer's responsibility to verify this kit is securely fastened to the vehicle.
- Use Loctite® Red on all bolts used to secure this baseplate. Torque all bolts to the specifications found at the end of these instructions. Do not over-torque the bolts or failure may occur.
- The installer must inspect the baseplate to ensure adequate clearance, particularly around hoses, air conditioner lines, radiators, etc. or non-warranty failure may result.
- Roadmaster manufactures many styles of baseplates. If your baseplate has removable arms, they must be removed before driving the vehicle, unless the arms can be pinned or padlocked in place. If not secured, the arms could vibrate out.
- Some motorhome chassis have such a tight turning radius that you can damage your motorhome, towed vehicle, tow bar or baseplate while turning sharply. Before getting on the road, test your turning radius in an empty parking lot. Turning too sharply could result in non-warranty damage to your towing system, motorhome and/or towed vehicle.
- Do not back up with the towed vehicle attached or non-warranty damage will occur to your towing system or vehicles.
- The safety cables must connect the towing vehicle to the towed vehicle frame to frame, with the cables crossed, with enough slack for sharp turns. See cable instructions for proper routing. Failure to do so will result in non-warranty damage and/or the loss of the towed vehicle.
- This kit is designed for use with ROADMASTER tow bars and ROADMASTER adapters only. Using this kit with other brands, without an approved ROADMASTER adapter, may result in non-warranty damage or injury.
- Receiver extensions and out-of-level towing situations of 3 inches or more. This can cause the system to swing much higher and lower, causing excessive strain on the tow bar, baseplate and frame. That can cause the towing system to fail, causing property damage, personal injury or even death. If you must use a receiver extension or drop hitch to tow, it will reduce your receiver's weight capacity by 1/3 to avoid damaging your system. Never use more than one extension and/or drop hitch, as this will void your warranty.
- Every 3,000 miles, the owner must inspect all mounting points for cracks or fatigue, and check the fasteners for proper torque, according to the bolt torque requirements chart on the last page of these instructions.
- The owner must follow the vehicle manufacturer's instructions to prepare the vehicle for towing. Failure to do so may cause severe damage to the vehicle.
- This baseplate is only warranted for the original installation. Installing a used baseplate on another vehicle is not recommended and will void the warranty.



# BASEPLATE KIT INSTALLATION INSTRUCTIONS

**KIT# 523157-1**

04/01/10  
KS

ROADMASTER, Inc. 6110 NE 127th Ave. Vancouver, WA 98682 360-896-0407 fax 360-735-9300 www.roadmasterinc.com

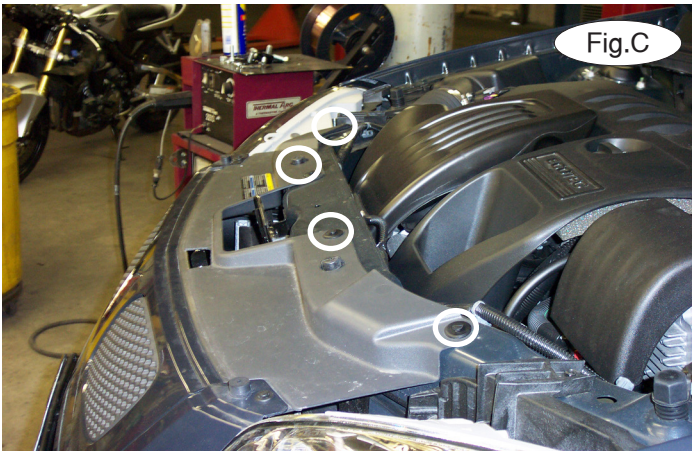

1. **Important:** please use all supplied bolts and parts and read all instructions carefully before beginning this installation. The majority of questions you may have can be answered within the text, and proper installation will ensure safe and secure travel. Now, begin the installation. Remove four plastic fasteners attaching the radiator cover to the core support (Fig.C).

2. On each side, remove eight 7mm (head) screws and one plastic fastener attaching the fender to the fascia (Fig.D,E – driver's side).



3. On each side, pull back the fender liner and remove one 10mm (head) bolt attaching the corner of the fender to the fascia (Fig.F).

4. Remove two plastic fasteners attaching the fascia to the bumper core (Fig.G). *Note:* they are located behind the grille.





# BASEPLATE KIT INSTALLATION INSTRUCTIONS

**KIT# 523157-1**

04/01/10  
KS

ROADMASTER, Inc. 6110 NE 127th Ave. Vancouver, WA 98682 360-896-0407 fax 360-735-9300 www.roadmasterinc.com

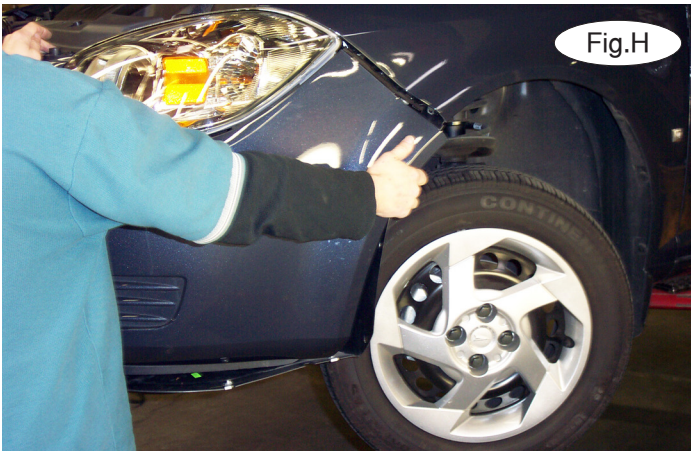

Fig.H



Fig.I

5. Pull out and forward on the corners of the fascia to remove it (Fig.H).
6. On the driver's side, remove two plastic fasteners located along the inside lower edge of the splash shield (Fig.I). On the passenger side, remove three plastic fasteners located along the inside lower edge of the splash shield (Fig.J).



Fig.J

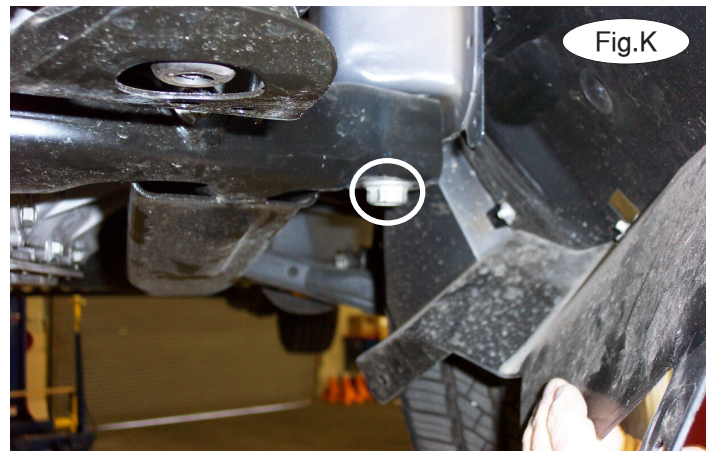

Fig.K

7. On each side, support the subframe and remove the front 21mm (head) subframe bolt (Fig.K – driver's side).
8. Position the main receiver brace underneath the vehicle so that the pre-drilled holes at the rear mounting points align with the holes for the subframe bolts you removed in the previous step. Bolt through the rear mounting points with the subframe bolts (Fig.L). *Note: use thread lock on the bolts.*



Fig.L



# BASEPLATE KIT INSTALLATION INSTRUCTIONS

**KIT# 523157-1**

04/01/10  
KS

ROADMASTER, Inc. 6110 NE 127th Ave. Vancouver, WA 98682 360-896-0407 fax 360-735-9300 www.roadmasterinc.com

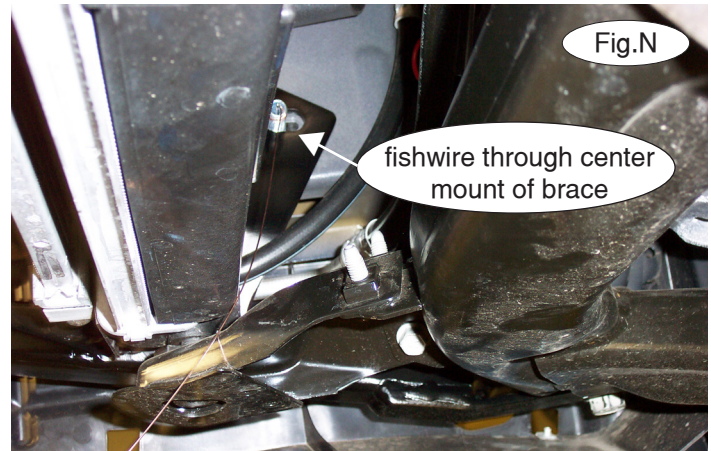
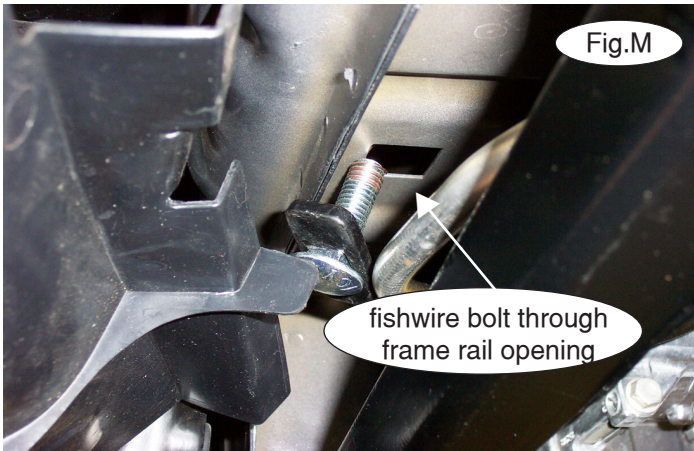

9. Clamp the main receiver brace to the bumper core so the upper mounting points are flush against the bottom of the bumper core.

10. On each side, fishwire a  $\frac{1}{2}$ " x  $1\frac{3}{4}$ " carriage bolt and a  $\frac{1}{4}$ " x 1" x 2" backing plate through the existing square hole in the side of the frame (Fig.M), through the bottom of the frame rail and through the center mounting point of the main receiver brace (Fig.N). Secure the attachment with a  $\frac{1}{2}$ " flat washer, lock washer and nut.



11. Using the pre-existing upper mounting points of the main receiver brace as templates, drill four  $\frac{1}{2}$ " holes through the bottom of the bumper core (Fig.O).

12. Place a  $\frac{1}{2}$ " x  $1\frac{1}{2}$ " bolt through a  $\frac{1}{4}$ " x  $1\frac{1}{2}$ " x 2" backing plate and place it through the back of the bumper core, through the first hole you drilled, and through the upper mounting point. Secure the attachment with a  $\frac{1}{2}$ " lock washer and nut (Fig.P). Repeat the process for each of the remaining three holes you drilled in the previous step (Fig.Q).

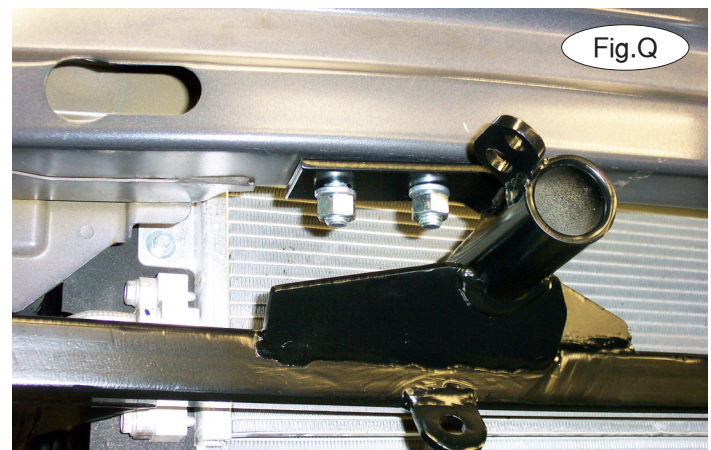



# BASEPLATE KIT INSTALLATION INSTRUCTIONS

**KIT# 523157-1**

04/01/10  
KS

ROADMASTER, Inc. 6110 NE 127th Ave. Vancouver, WA 98682 360-896-0407 fax 360-735-9300 www.roadmasterinc.com

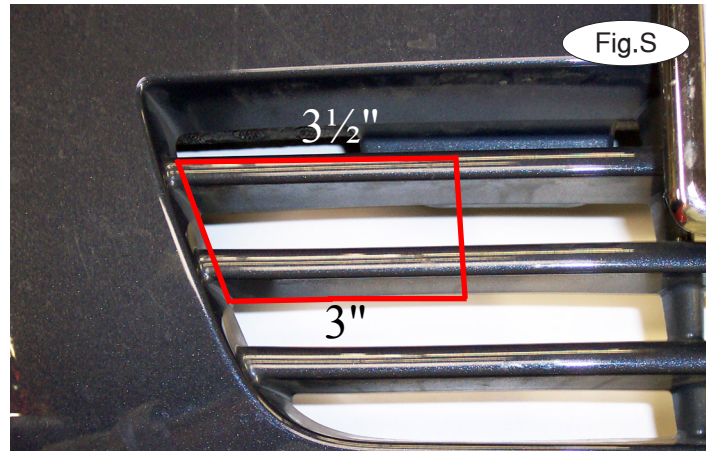
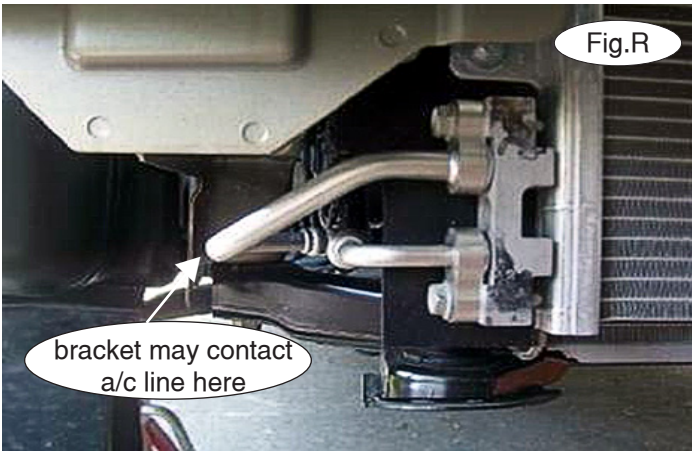

13. Tighten all bolts to the bolt torque requirements found at the end of this document. Remove the clamp. *Note:* on some models, the air conditioning lines may contact the top of the main receiver bracket, on the rear passenger side brace (Fig.R). If this is the case, once you have torqued the subframe bolts into place, use a pry bar or screwdriver to bend the air conditioning line approximately a half inch up to clear the rear passenger side brace.

14. On each side, trim the top two outside horizontal grille ribs using the red lines in Figure S as a guide. *Note:* measure 3½" from the side for the top rib, and 3" from the side for the second rib.

15. Reassemble the fascia, reversing steps 1 through 5.

16. Insert the removable front bracket arms into the front receiver braces, and twist each one 90 degrees to lock.

17. Attach the 12" safety cables with the cable connectors (Q-Links) to bottom cross bar of the main brace (Fig.T).

18. Attach the ends of the safety cables to the tow vehicle's safety cables.

19. Install the tow bar to the mounting bracket according to the manufacturer's instructions.



## BOLT TORQUE REQUIREMENTS

Note: The torque values represented below are intended as general guidelines. Torque requirements for specific applications may vary. Roadmaster does not warrant this information to be accurate for all applications and disclaims all liability for any claims or damages which may result from its use.

### STANDARD BOLTS

Thread Size	Grade	Torque
5/16	5	13 ft./lb.
3/8	5	23 ft./lb.
7/16	5	37 ft./lb.
1/2	5	56 ft./lb.
5/8	5	150 ft./lb.

### METRIC BOLTS

Thread Size	Grade	Plated / Unplated
8mm-1.0	8.8	20 ft./lb. 18 ft./lb.
8mm-1.25	8.8	19 ft./lb. 18 ft./lb.
10mm-1.25	8.8	38 ft./lb. 36 ft./lb.
10mm-1.5	8.8	37 ft./lb. 35 ft./lb.

### METRIC BOLTS

Thread Size	Grade	Plated / Unplated
12mm-1.25	8.8	70 ft./lb. 65 ft./lb.
12mm-1.5	8.8	66 ft./lb. 61 ft./lb.
12mm-1.75	8.8	65 ft./lb. 60 ft./lb.
14mm-2.0	8.8	104 ft./lb. 97 ft./lb.

All illustrations and specifications contained herein are based on the latest information available at the time of publication approval. ROADMASTER, INC. reserves the right to make changes at any time without notice in material, specification and models or to discontinue models.