



BASEPLATE KIT INSTALLATION INSTRUCTIONS

KIT# 523232-5

11/25
MS

ROADMASTER, Inc.

6110 NE 127th Ave.

Vancouver, WA 98682

360-896-0407

www.RoadmasterInc.com

What You'll Need

A second person to help
Panel tool
Reciprocating Saw
2 3/4 Hole Saw
Ratchet

3/4, 14, 17 mm Wrenches
10, 14, 17 mm Socket
Tape Measure
Torque wrench

Needle Nose Pliers
3/4 Socket
Threadlocker
Marker or paint pen

IMPORTANT:

This baseplate is made to accommodate the Guardian XL (#4100). It will not accommodate the Guardian (#4000), some models of the Tow Defender, or StowMaster tow bars.

Need Help? Call Toll-Free

1-800-669-9690

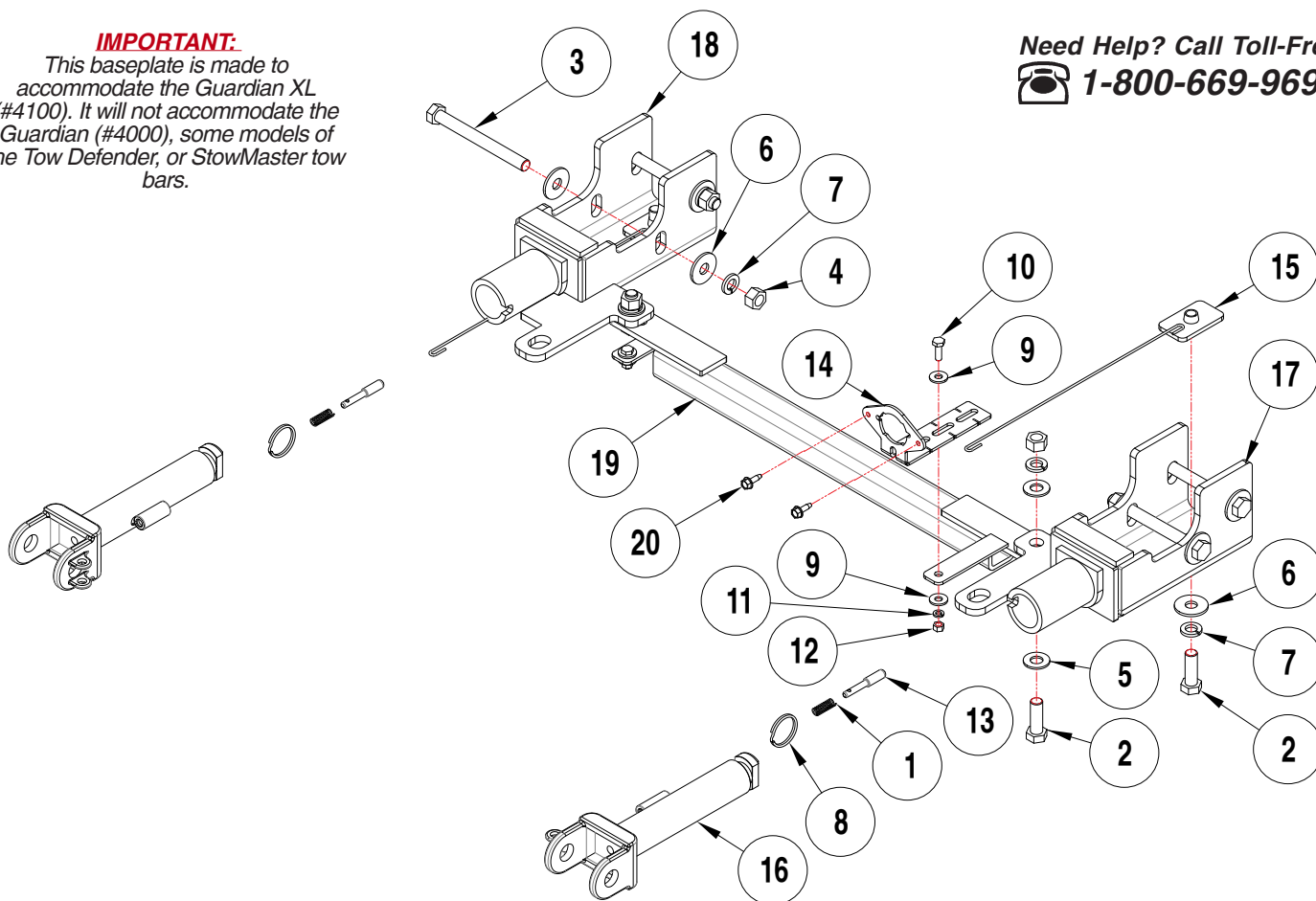

ITEM	QTY	DESCRIPTION	PART
1	2	SPRING	200146-00
2	4	1/2" x 1 1/2" BOLT	350095-00
3	4	1/2" x 5" BOLT	350107-00
4	6	1/2" HEX NUT	350258-00
5	4	1/2" SAE WASHER	350308-20
6	10	1/2" FLAT WASHER	350308-00
7	8	1/2" LOCK WASHER	350309-00
8	2	RING	350520-00
9	4	M6 FLAT WASHER	355742-00
10	2	M6 x 1.00 x 20mm BOLT	355751-20
11	2	M6 LOCK WASHER	355761-00
12	2	M6 x 1.00 HEX NUT	355890-00
13	2	LOCK PIN	A000008
14	1	WIRE PLUG PLATE	A006808
15	2	1 1/2" x 2 1/2" THREADED BACKING PLATE w/ 12" ROD	C001572
16	2	ARM	C002383
17	1	DRIVER SIDE RECEIVER	C003862
18	1	PASSENGER SIDE RECEIVER	C003863
19	1	CROSS BRACE	C003864
20	2	1/4" X 3/4" SELF DRILLING SCREW	357250-00



BASEPLATE KIT INSTALLATION INSTRUCTIONS

KIT# 523232-5

11/25
MS

ROADMASTER, Inc.

6110 NE 127th Ave.

Vancouver, WA 98682

360-896-0407

www.RoadmasterInc.com

IMPORTANT: All baseplates **must** be assembled with all the bolts left loose for final adjustment and positioning (before tightening) unless otherwise instructed. All bolts **must** be torqued for proper strength. If more than one bolt is used per fastening point, the diagram may only show one. Use flat washers over all slotted holes and lock washers on all fasteners.

WARNING

Failure to heed these warnings or follow the installation instructions may result in a voided warranty, loss of towed vehicle, personal injury or death.

- Do not weld or modify this baseplate or its components. Welding or modification will void the warranty.
- Do not use this document as a basis to design/fabricate a baseplate, as it may not show all parts or structural components.
- We strongly recommend professional installation.
- If the towed vehicle has been in an accident, it must be properly repaired before attaching the baseplate. Do not install the baseplate if any structural frame damage is found.
- The installer must use all bolts and parts supplied. If running changes were made by the vehicle manufacturer after this kit was designed, some bolts or other fasteners may no longer be the correct size. It is the installer's responsibility to verify this kit is securely fastened to the vehicle.
- Use Threadlocker Red on all bolts used to secure this baseplate. Torque all bolts to the specifications found at the end of these instructions. Do not over-torque the bolts or failure may occur.
- The installer must inspect the baseplate to ensure adequate clearance, particularly around hoses, air conditioner lines, radiators, etc. or non-warranty failure may result.
- Roadmaster manufactures many styles of baseplates. If your baseplate has removable arms, they must be removed before driving the vehicle, unless the arms can be pinned or padlocked in place. If not secured, the arms could vibrate out.
- Some motorhome chassis have such a tight turning radius that you can damage your motorhome, towed vehicle, tow bar or baseplate while turning sharply. Before getting on the road, test your turning radius in an empty parking lot. Turning too sharply could result in non-warranty damage to your towing system, motorhome and/or towed vehicle.
- Do not back up with the towed vehicle attached or non-warranty damage will occur to your towing system or vehicles.
- The safety cables must connect the towing vehicle to the towed vehicle frame to frame, with the cables crossed, with enough slack for sharp turns. See cable instructions for proper routing. Failure to do so will result in non-warranty damage and/or the loss of the towed vehicle.
- This kit is designed for use with ROADMASTER tow bars and ROADMASTER adapters only. Using this kit with other brands, without an approved ROADMASTER adapter, may result in non-warranty damage or injury.
- Receiver extensions and out-of-level towing situations of 3" or more can cause the system to swing much higher and lower, causing excessive strain on the tow bar, baseplate and frame. That can cause the towing system to fail, causing property damage, personal injury or even death. If you must use a receiver extension or drop hitch to tow, it will reduce your receiver's the towing system's capacity by 1/3 to avoid damaging your system. Never use more than one extension and/or drop hitch, as this will void your warranty.
- Every 3,000 miles, the owner must inspect all mounting points for cracks or fatigue, and check the fasteners for proper torque, according to the bolt torque requirements chart on the last page of these instructions.
- The owner must check and follow the vehicle manufacturer's instructions to prepare the vehicle for towing. Failure to do so may cause severe damage to the vehicle.
- This baseplate is only warranted for the original installation. Installing a used baseplate on another vehicle is not recommended and will void the warranty.

About this kit:

This is one of our direct connect-style series, which allows the visible front portion of the baseplate to be easily removed from the front of the vehicle (Fig.A and Fig.B).

Before starting the installation, lay out the kit components in order, as they will be used. This will give you a visual idea of how the components work, and will also confirm that everything is present and accounted for.

Important: All illustrations and specifications contained herein are based on the latest information available at the time of publication approval. ROADMASTER, INC. reserves the right to make changes at any time without notice in material, specification and models or to discontinue models.





BASEPLATE KIT INSTALLATION INSTRUCTIONS

KIT# 523232-5

11/25
MS

ROADMASTER, Inc.

6110 NE 127th Ave.

Vancouver, WA 98682

360-896-0407

www.RoadmasterInc.com

Important: Please use all supplied hardware and read through these instructions carefully before beginning this installation. The majority of questions you may have can be answered within the text, and proper installation will ensure safe and secure travel.

1. From the top center of the fascia, remove two T-15 screws attaching a hood latch extension to the hood latch, place the hood latch extension and screws aside for now (Fig.C).

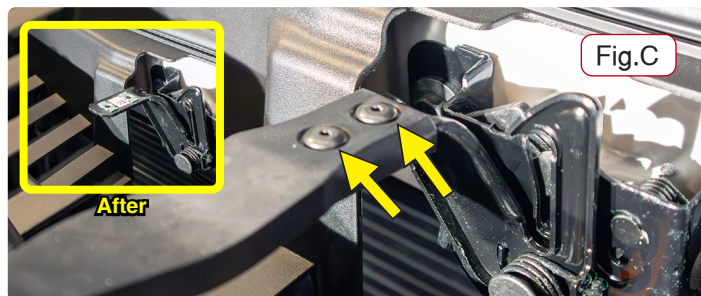

2. Along the top rim remove 9 plastic clips, 3 on each side and 3 along the back (Fig.D), from the fascia guide.

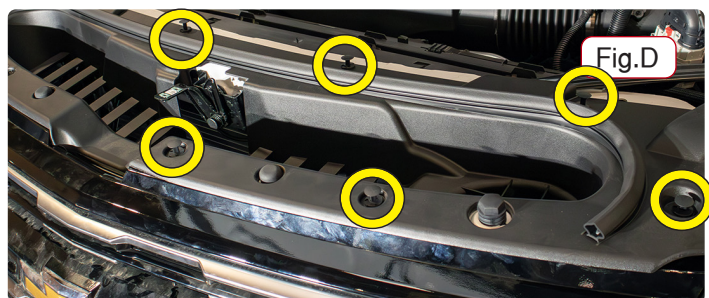

3. Pull up and pop out the plastic guide from atop the fascia to reveal the frame and bumper (Fig.E).



4. On each side, remove three 10mm bolts from along top of the fascia (Fig.F).

5. Starting on the passenger's side; remove five T15 screws from along the inner wheel well (Fig.GA & Fig.GB).

6. Peel back the wheel house trim to reveal and then remove a recessed 7mm bolt (Fig.HA) and a 10mm bolt (Fig.HB) that are attaching the fascia to the frame.

7. From inside the wheel house, push outward on the fascia to loosen it.

8. Repeat steps 4, 6, and 7 for the driver's side.

9. On the passenger's side; disconnect the wire harness from behind the wheel house trim. Push in the red tab then

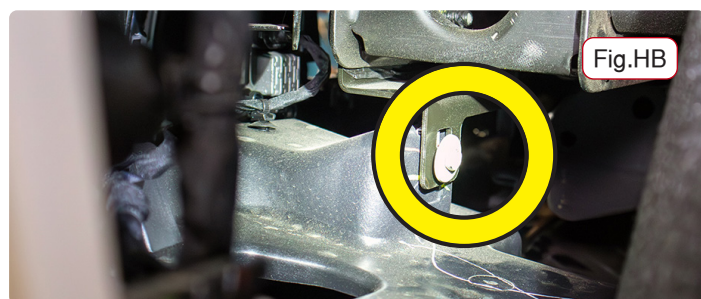



BASEPLATE KIT INSTALLATION INSTRUCTIONS

KIT# 523232-5

11/25
MS

ROADMASTER, Inc.

6110 NE 127th Ave.

Vancouver, WA 98682

360-896-0407

www.RoadmasterInc.com

pull down on the grey sheath to release the plug of the wire harness (Fig.I).

10. Then unplug a smaller black wire harness from behind the larger one that was just unplugged (Fig.I Inset).

11. **For '25 Yukon only;** On the driver's side, uncouple three wire connectors by pulling on the red tabs to release the clip, and disconnect the washer hose at the coupler. (See Fig.YA, YB, & YC, supplemental.)

12. From the bottom of the fascia, remove twelve T15 screws from the middle section (Fig.J Circles).

13. On each side, remove three 7mm bolts as indicated along the bottom sides of the fascia (Fig.K, Fig.J Triangles).

14. On each side, grab the front side of the fascia and pull it forward (Fig.L).

15. Pull up on the plastic tabs on top of the fascia (Fig.M).

16. **For '25 Yukon only;** Uncouple the cable running to the fascia, for the lit GMC emblem (Fig.YD, supplemental).

17. Fully remove and set aside the fascia, it may need to be pull from different spots to loose all of the connections.

18. Along side the inner part of the fascia, pop out four white clips and remove six 7mm screws (eight clips and four screws on the Yukon), to allow for the removal of the inner plastic plate. Set aside the plate for future reinstallation if desired. The plate may be kept in, but a 3/4s of an inch would need to be trimmed from along the outer edges to accommodate the baseplate (Fig.N).

19. If present, remove the small plastic boxes below the frame horns.

20. **For non-Yukon:** As indicated, trim the inner fascia about 3 1/2" inward along the inner plastic segment (Fig.O).

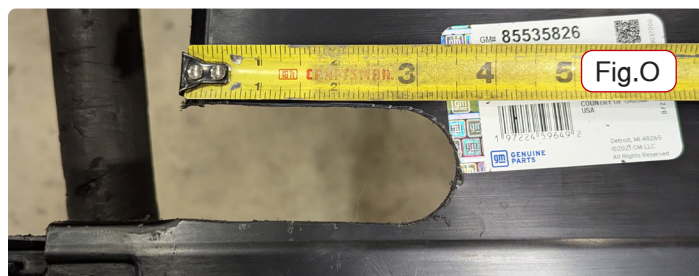
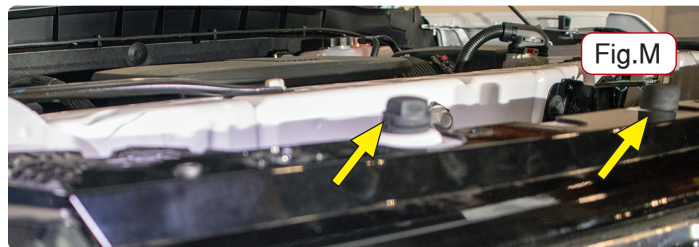
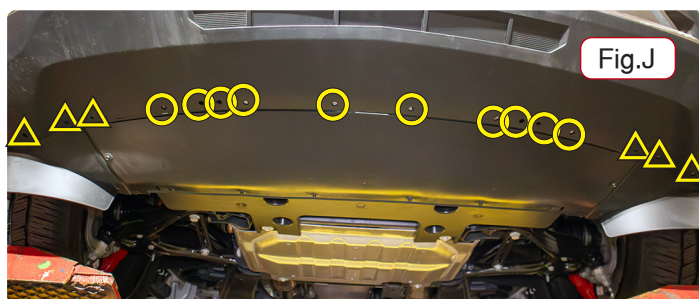
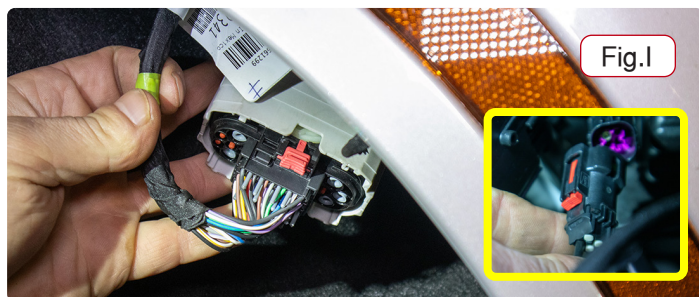



BASEPLATE KIT INSTALLATION INSTRUCTIONS

KIT# 523232-5

11/25
MS

ROADMASTER, Inc.

6110 NE 127th Ave.

Vancouver, WA 98682

360-896-0407

www.RoadmasterInc.com



Fig.PA



Fig.PB



Fig.Q



Fig.R

21. For '25 Yukon only; Trim the fascia and fascia backing plate as indicated in Figures YE,YF,YG; supplemental. Trim on both sides of the fascia to allow clearance for the baseplate arms.

22. On the front frame horns, trim them as indicated to make clearance (Fig.PA & PB).

23. Now, place the receivers onto the horns and insert two 1/2 x 5" bolts and washer in through the sides of the horns capping them off with a lock washer and 1/2" nut. Make a mark of where the hole along the bottom of the receiver is on the horn. Leave the bolts loose for now (Fig.Q).

24. In the marked holes, drill them out with a 9/16th bit (Fig.R).

25. Insert through the receiver and horn the backing plate for the nut, as indicated (Fig.S)

26. On each side; insert a 1/2 x 1 1/2" bolt and washer into the bottom hole then apply threadlocker to all of the bolts, finally torque the bolt into position, then torque the side bolts (Fig.T)

27. Attach the cross brace between the receiver tabs using, on each side, a 1/2 x 1 1/2" bolt and washer capped off with a lock washer and 1/2" nut. Apply threadlocker and then torque (Fig.U).

28. Install the breakway tab with a bolt, washer, capped off with a lock washer and 1/2" nut, as indicated on the front page.

29. Reinstall the fascia by reversing several of the steps above.

30. Bend the wire plug at the proper angle and install as needed.

Important: Please note, it is the owner's responsibility to ensure the locking of the pins before towing. Otherwise, failure of the towing system will result.



Fig.S

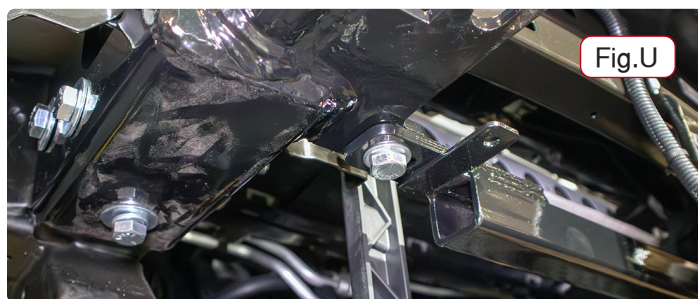

Fig.U



BASEPLATE KIT INSTALLATION INSTRUCTIONS

KIT# 523232-5

11/25
MS

ROADMASTER, Inc.

6110 NE 127th Ave.

Vancouver, WA 98682

360-896-0407

www.RoadmasterInc.com

IMPORTANT!

Safety cables are required by law. When towing, connect safety cables to the safety cable tabs illustrated on the separate insert with the drawing and parts list and in Figure Y. Make certain there is adequate slack in the cables to allow a full turning radius; otherwise, damage will result. If necessary, longer cables or cable extensions are available.

WARNING!

If you do not use Threadlocker Red on all bolts in this kit and torque to the specified values, it could cause failure of the towing system.

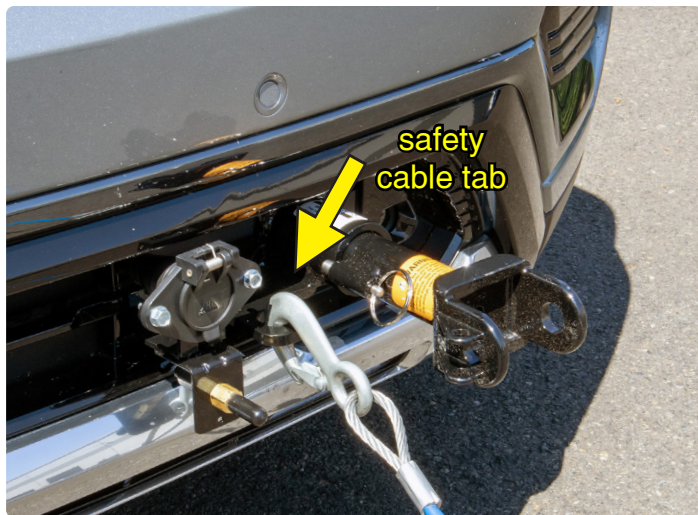

BOLT TORQUE REQUIREMENTS

Note: The torque values represented below are intended as general guidelines. Torque requirements for specific applications may vary. Roadmaster does not warrant this information to be accurate for all applications and disclaims all liability for any claims or damages which may result from its use.

STANDARD BOLTS

Thread Size	Grade	Torque
5/16-18	5	13 ft./lb.
3/8-16	5	23 ft./lb.
7/16-14	5	37 ft./lb.
1/2-13	5	57 ft./lb.
5/8-11	5	112 ft./lb.

METRIC BOLTS

Thread Size	Grade	Torque
6mm-1.0	8.8	6 ft./lb.
8mm-1.0	8.8	18 ft./lb.
8mm-1.25	8.8	16 ft./lb.
10mm-1.25	8.8	36 ft./lb.
10mm-1.5	8.8	31 ft./lb.

METRIC BOLTS

Thread Size	Grade	Torque
12mm-1.25	8.8	64 ft./lb.
12mm-1.5	8.8	60 ft./lb.
12mm-1.75	8.8	55 ft./lb.
14mm-2.0	8.8	88 ft./lb.

Three options for attaching the wiring plug to the main receiver brace:

For six-wire plugs: Use the two supplied 3/4" self-tapping screws to attach the electrical plug directly to the rods on the front of the main receiver brace.

For four-wire round plugs: Attach to the plug mounting plate and then use the two supplied 3/4" self-tapping screws to attach the mounting plate to the rods on the front of the main receiver brace.

For four-wire flat plugs: Place the plug through the mounting plug plate, and then secure it using the supplied zip tie on the front of the plug (Fig.aa). Use the two supplied 3/4" self-tapping screws to attach the mounting plate to the rods on the front of the main receiver brace.

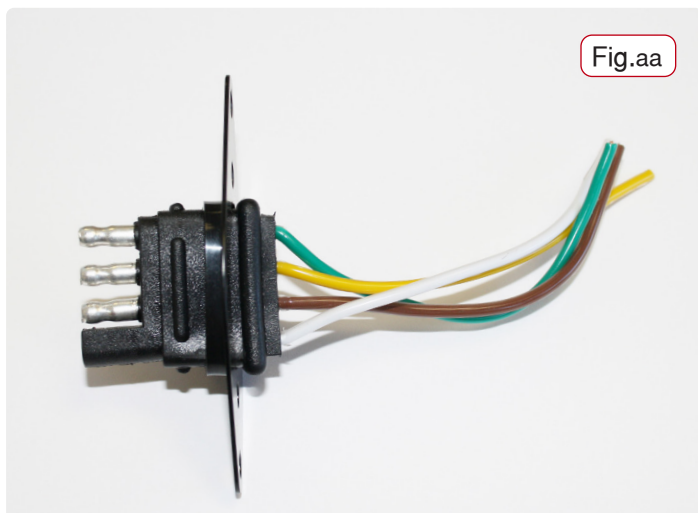



BASEPLATE KIT INSTALLATION INSTRUCTIONS

KIT# 523232-5

11/25
MS

ROADMASTER, Inc.

6110 NE 127th Ave.

Vancouver, WA 98682

360-896-0407

www.RoadmasterInc.com

'25 Yukon Supplemental

IMPORTANT!

This supplemental set of instructions only applies to the Yukon series of vehicles.

